

PROFILE SURVEYED BY: DATE:  
 PLOTTED CHECKED BY:  
 NOTE BOOK NO. STRUCTURE NOTATIONS CHRD  
 NO.

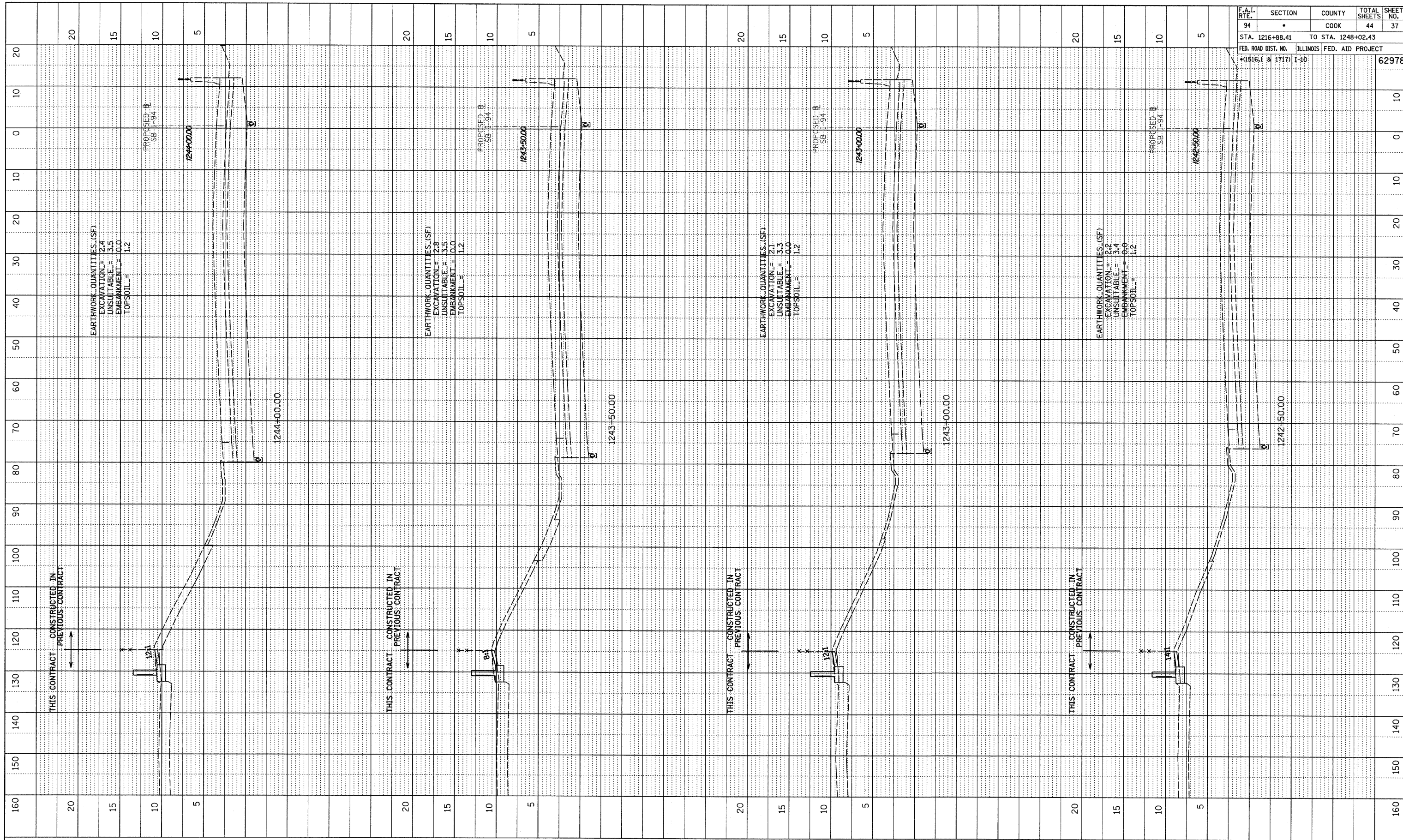

F.A.T. RTE.	SECTION	COUNTY	TOTAL SHEETS	SHEET NO.
94		COOK	44	37
STA. 1216+88.41		TO STA. 1248+02.43		
FED. ROAD DIST. NO. 1516.1 & 1717		ILLINOIS FED. AID PROJECT		62978

TYLIN INTERNATIONAL



SB I-94 (DAN RYAN EXPRESSWAY)  
 STA. 1242+50 TO STA. 1244+00

1/15/2009 12:02:35 PM P:\0237\3\road\266\ngk\266xss187.dgn