

PROFILE	SUBMITTED	BY	DATE
NOTE BOOK	DESIGNED		
NO.	CHECKED		
	S.A. NOTED		
	STRUCTURE NOTATIONS CHRD		

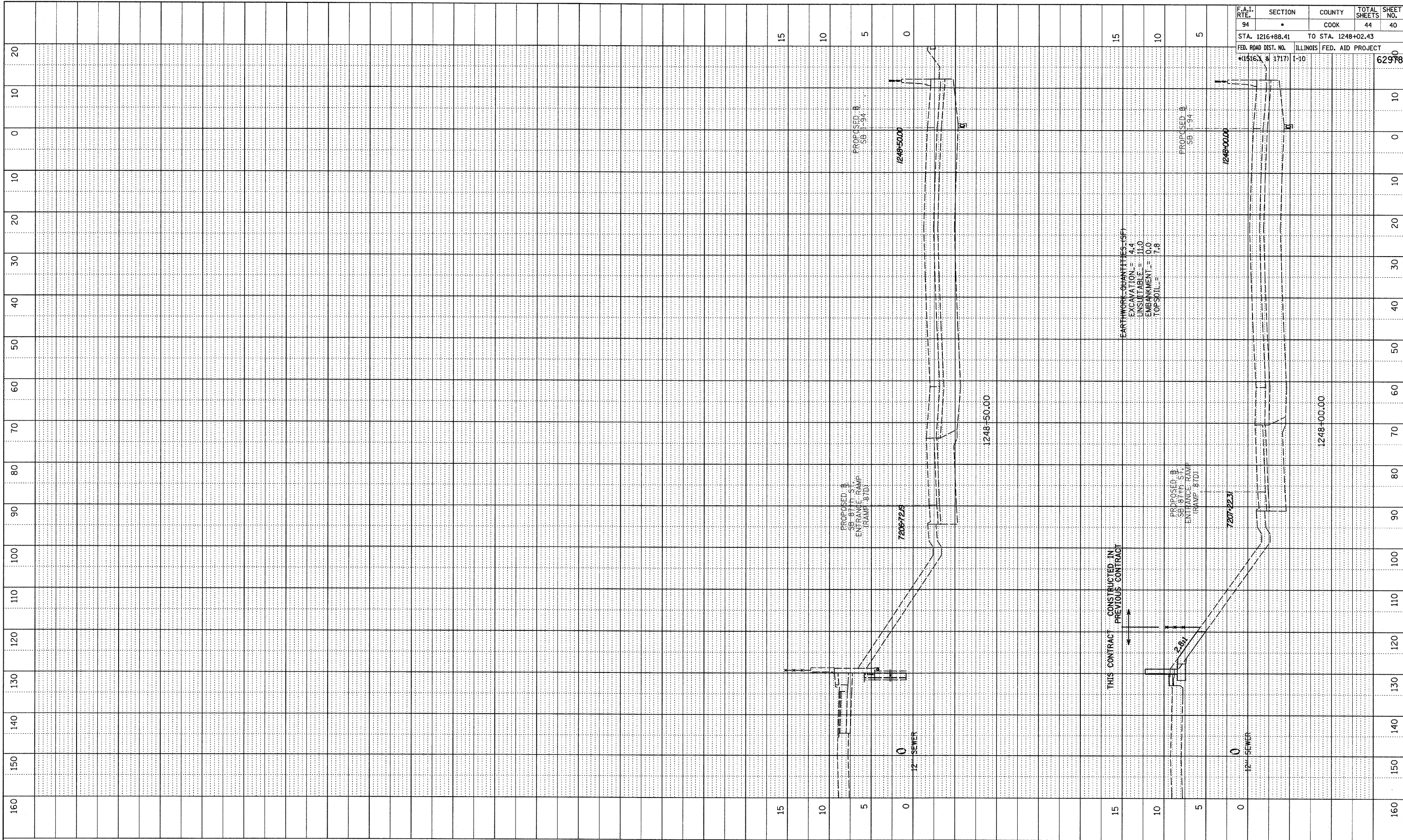

F.A.I. RTE.	SECTION	COUNTY	TOTAL SHEETS	SHEET NO.
94	•	COOK	44	40
STA. 1216+88.41		TO STA. 1248+02.43		
FED. ROAD DIST. NO.		ILLINOIS FED. AID PROJECT		
*(1516) & (1717) I-10		62978		

TYLIN INTERNATIONAL

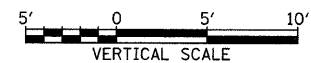

SB I-94 (DAN RYAN EXPRESSWAY)
STA. 1248+00 TO STA. 1248+50

1/15/2009 12:02:36 PM P:\0237\road\266\gk\266\sb94.dwg