

PROFILE SURVEYED BY DATE  
 GRADES CHECKED BY  
 NOTE BOOK NO. BY  
 SIGNATURE NOTATIONS CHWD

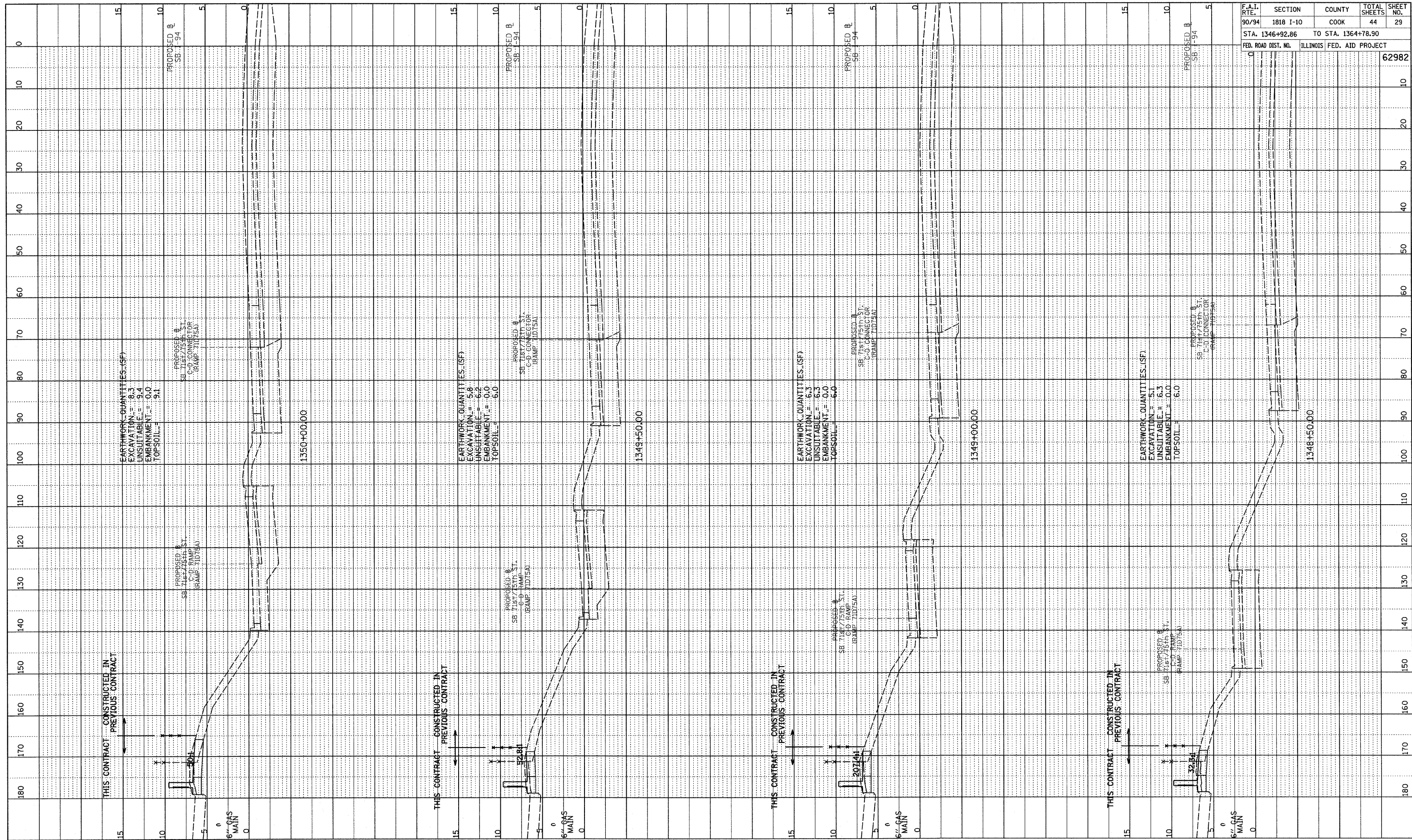

| F.A.I. RTE.         | SECTION                   | COUNTY             | TOTAL SHEETS | SHEET NO. |
|---------------------|---------------------------|--------------------|--------------|-----------|
| 90/94               | 1818 I-10                 | COOK               | 44           | 29        |
| STA. 1346+92.86     |                           | TO STA. 1364+78.90 |              |           |
| FED. ROAD DIST. NO. | ILLINOIS FED. AID PROJECT |                    | 62982        |           |

TYLIN INTERNATIONAL

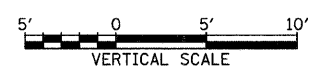
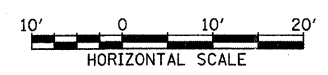

SB I-94 (DAN RYAN EXPRESSWAY)  
 STA. 1348+50 TO STA. 1350+00

P:\02373\Road\26\Fig\pk26F.yes\IT15.dgn