

PROFILE	REVIEWED	BY	DATE
NOTE BOOK	NOTES CHECKED		
	B.M. NOTED		
	STRUCTURE NOTATIONS CIPED		

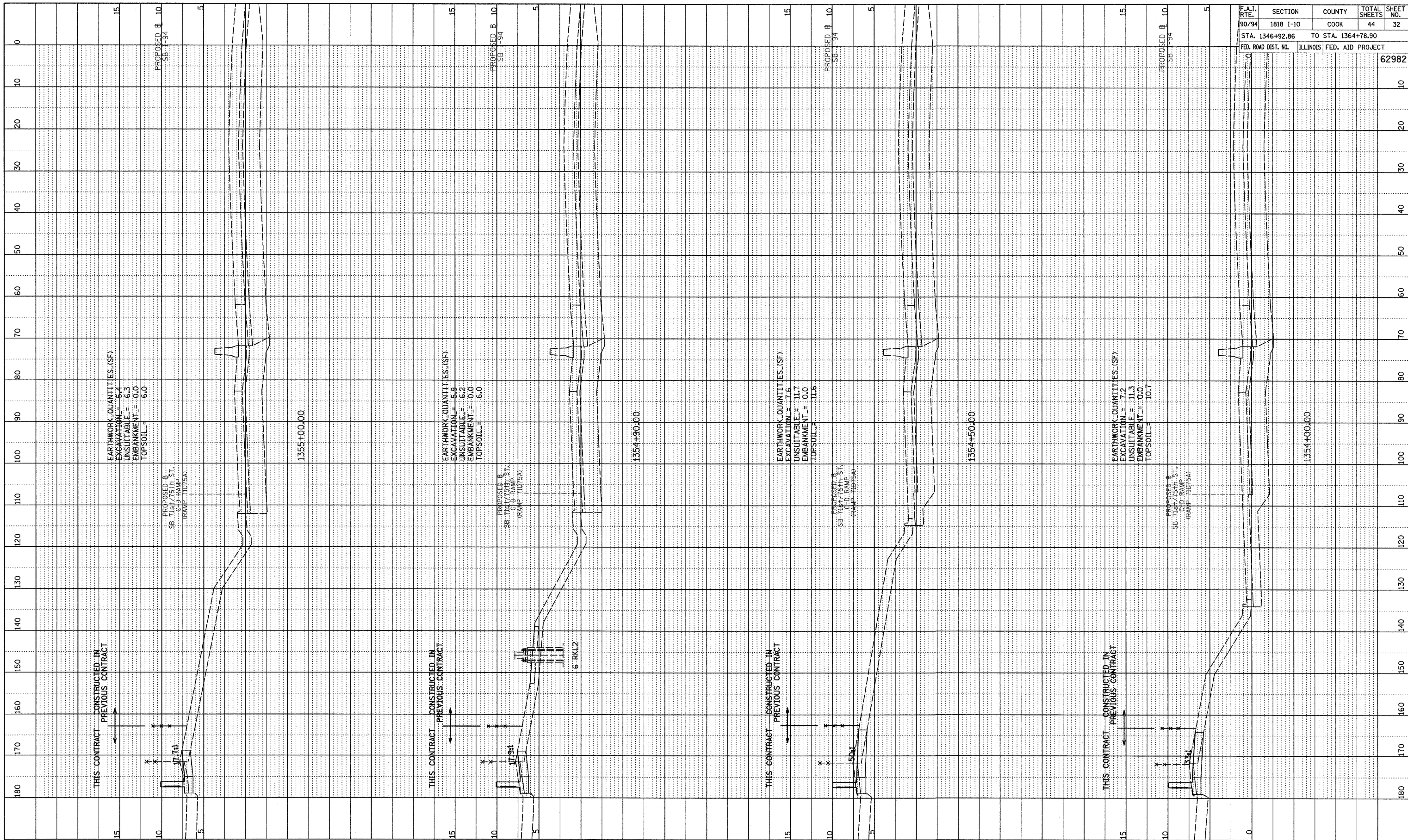

TYLIN INTERNATIONAL

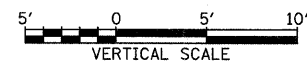

SB I-94 (DAN RYAN EXPRESSWAY)
 STA. 1354+00 TO STA. 1355+00

F.A.I. RTE.	SECTION	COUNTY	TOTAL SHEETS	SHEET NO.
90/94	1818 I-10	COOK	44	32
STA. 1346+92.86 TO STA. 1364+78.90				
FED. ROAD DIST. NO.		ILLINOIS FED. AID PROJECT		62982

P:\0231\Road\26\Fig\26F.asst\15.dgn