

PROFILE SURVEYED BY DATE  
 GRADES CHECKED  
 B.M. NOTED  
 NO. STRUCTURE NOTATIONS SHOWN

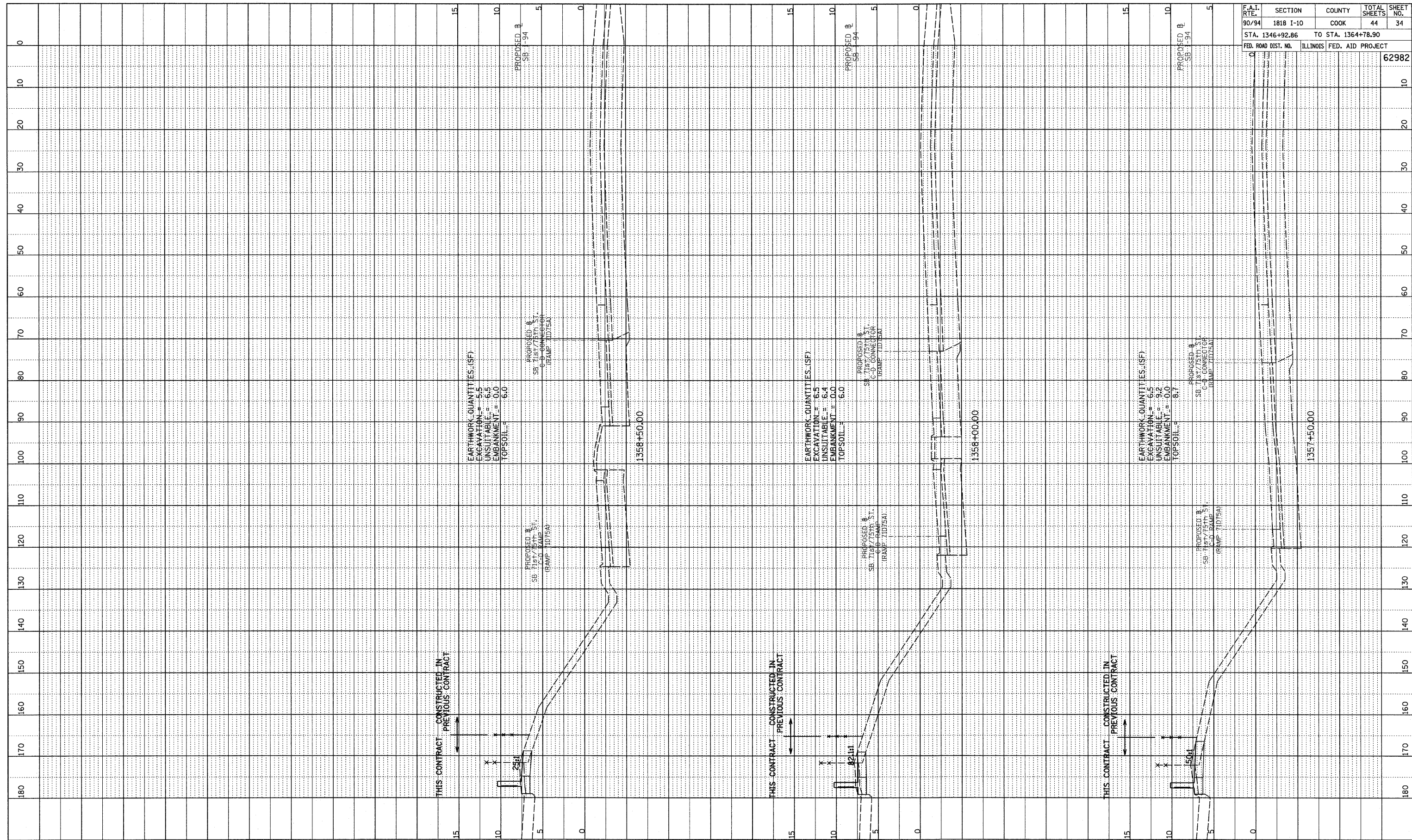

F.A.I. RTE.	SECTION	COUNTY	TOTAL SHEETS	SHEET NO.
90/94	1818 I-10	COOK	44	34
STA. 1346+92.86		TO STA. 1364+78.90		
FED. ROAD DIST. NO.	ILLINOIS FED. AID PROJECT		62982	

TYLIN INTERNATIONAL

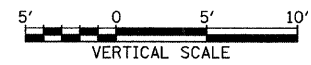
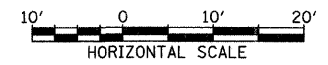

SB I-94 (DAN RYAN EXPRESSWAY)  
 STA. 1357+50 TO STA. 1358+50

1802373/ROAD/2261/94K26/94K26P.XSS/175.dgn