

PROFILE SURVEYED BY DATE
 GRADES CHECKED BY
 NOTE BOOK NO. DATE NOTATIONS CHD

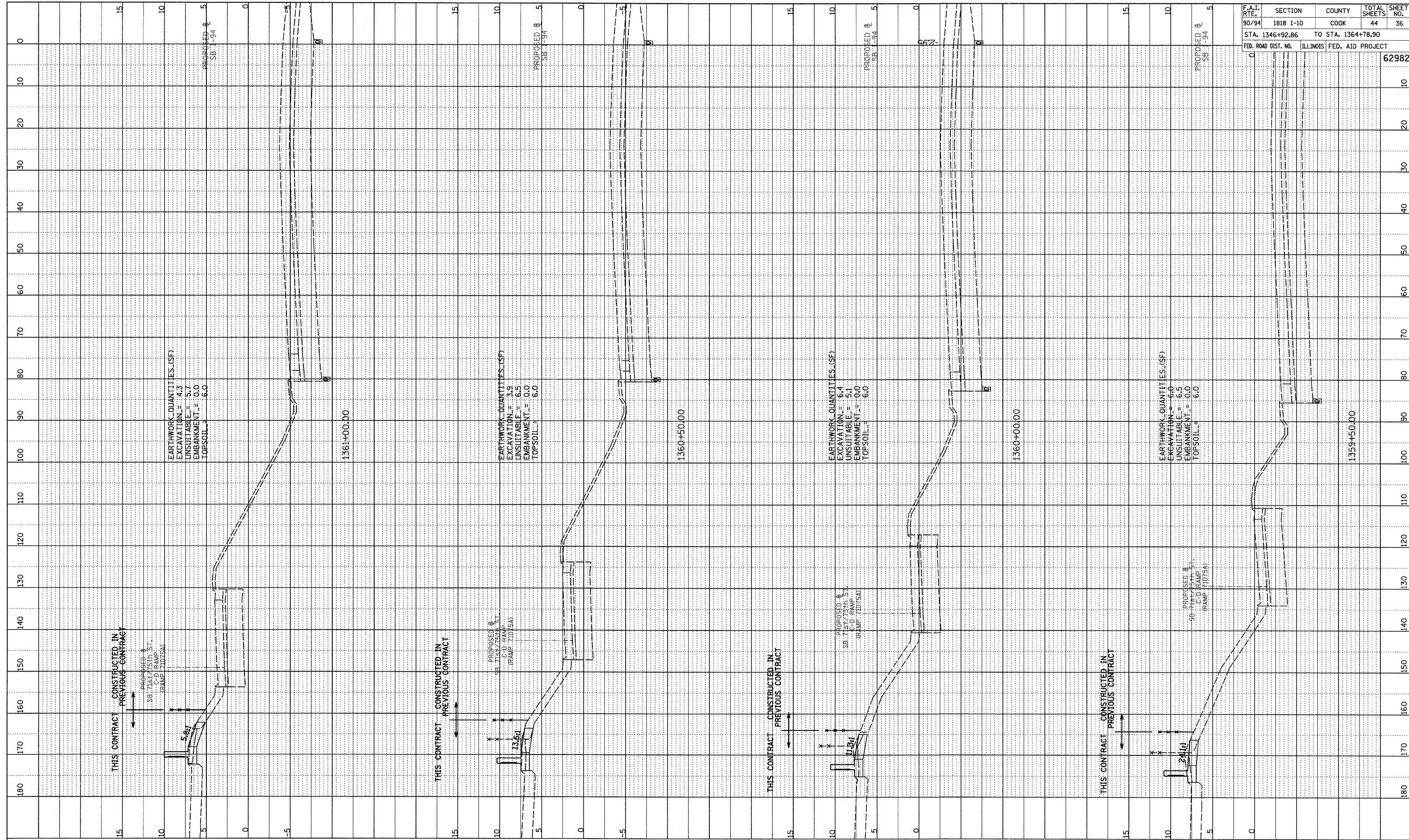

F.A.I. RTE.	SECTION	COUNTY	TOTAL SHEETS	SHEET NO.
90/94	1818 I-10	COOK	44	36
STA. 1346+92.86 TO STA. 1364+78.90		ILLINOIS FED. AID PROJECT		
FED. ROAD DIST. NO.		62982		

TYLIN INTERNATIONAL

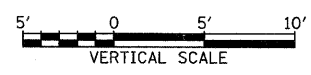
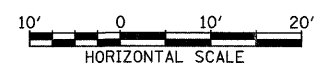

SB I-94 (DAN RYAN EXPRESSWAY)
 STA. 1359+50 TO STA. 1361+00

P:\02373\Road\226\gpr\251\Asst\T15.dgn