

F.A.U. RTE.	SECTION	COUNTY	TOTAL SHEETS	SHEET NO.
1578	*	WILL	155	48
STA. 104+70		TO STA. 110+00		
FED. ROAD DIST. NO.		ILLINOIS	FED. AID PROJECT	
* 06-00046-00-PV				

**NOTES:**

- SEE "REMOVAL AND ADJUSTMENT PLANS" FOR REMOVAL OF EXISTING ITEMS.
- CONTRACTOR SHALL MAINTAIN ACCESS TO ALL SIDE ROADS AND ENTRANCES AT ALL TIMES.
- THE CONTRACTOR SHALL APPLY TYPE III PAVEMENT MARKING TAPE AS DIRECTED BY THE ENGINEER. THIS ITEM SHALL BE INCLUDED IN THE COST OF TEMPORARY PAVEMENT MARKINGS.

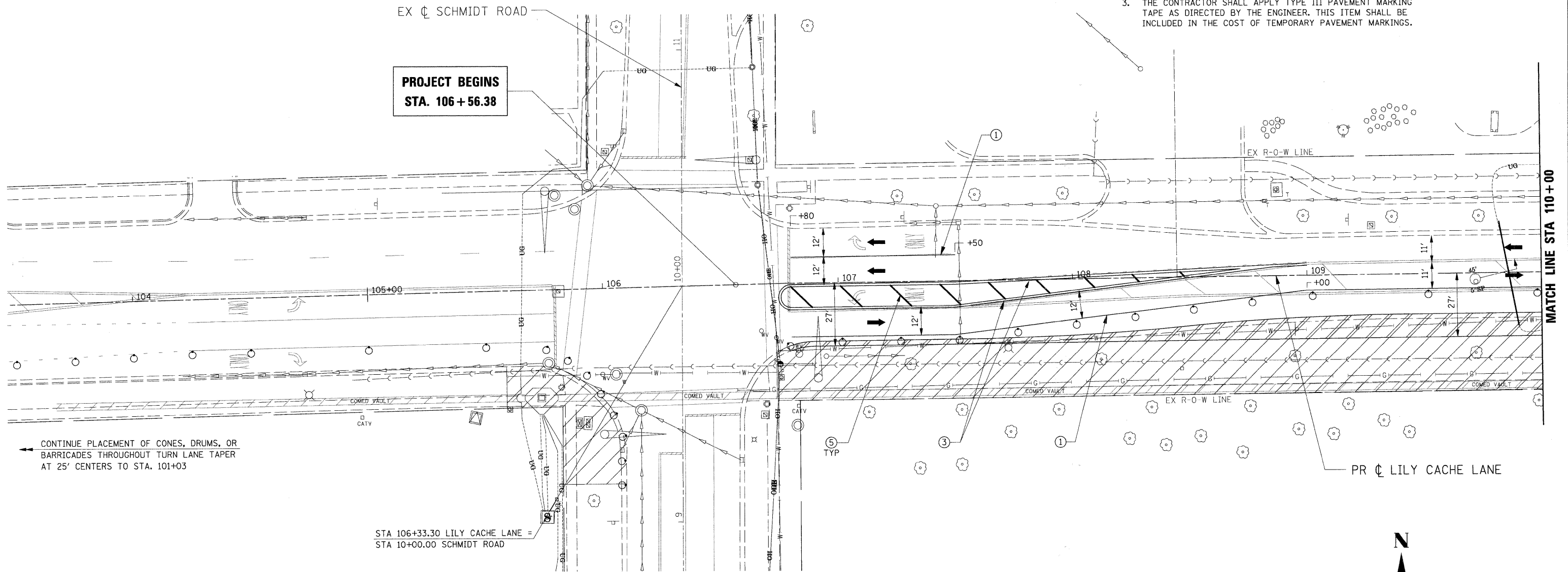

**STAGE 1  
SEQUENCE OF CONSTRUCTION:**

- CONTRACTOR SHALL PLACE ALL ADVANCED WARNING SIGNAGE PRIOR TO BEGINNING ANY CONSTRUCTION IN ACCORDANCE WITH STANDARD 701326.
- CONTRACTOR SHALL REMOVE ALL CONFLICTING PAVEMENT MARKINGS AND PLACE ALL TEMPORARY PAVEMENT MARKINGS AS SHOWN ON THE PLANS.
- TRAFFIC WILL BE SHIFTED TO TWO 11' LANES ON THE NORTH SIDE OF EXISTING PAVEMENT.
- CONTRACTOR SHALL PROVIDE AND MAINTAIN TEMPORARY ENTRANCES WHERE REQUIRED DURING CONSTRUCTION.
- REMOVE EXISTING CURB AND GUTTER AND CONSTRUCT THE PROPOSED TEMPORARY WIDENING AS SHOWN ON THE PLANS.
- TRAFFIC CONTROL AT SCHMIDT ROAD AND CANTERBURY LANE WILL REMAIN THE SAME AS THE EXISTING CONDITION.

**LEGEND**

- ➔ DIRECTION OF TRAFFIC
- CONE, DRUM, OR BARRICADE
- ⊥ TYPE III BARRICADE
- ➔ TEMPORARY STAGE DRAINAGE FLOW
- ▨ STAGE CONSTRUCTION LIMITS
- ▨ TEMPORARY PAVEMENT
- ▨ TEMPORARY PAVEMENT REMOVAL
- ① TEMP. PAINT PAVEMENT MARKING - LINE 4" (WHITE)
- ② TEMP. PAINT PAVEMENT MARKING - LINE 4" (YELLOW)
- ③ TEMP. PAINT PAVEMENT MARKING - LINE 4" (DOUBLE YELLOW)
- ④ TEMP. PAINT PAVEMENT MARKING - LINE 6" (WHITE)
- ⑤ TEMP. PAINT PAVEMENT MARKING - LINE 12" (YELLOW)
- ⑥ TEMP. PAINT PAVEMENT MARKING - LINE 24" (WHITE)
- ⑦ TEMP. PAINT PAVEMENT MARKING - LETTERS & SYMBOLS

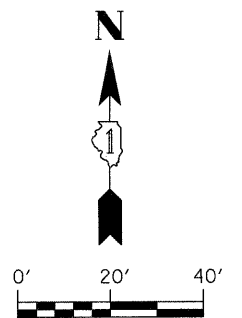

REVISIONS	
NAME	DATE

ILLINOIS DEPARTMENT OF TRANSPORTATION  
**MAINTENANCE OF TRAFFIC**  
**STAGE 1**  
**STA 104+70 TO STA 110+00**

SCALE: 1" = 20'  
 DATE: APRIL 9, 2009  
 DRAWN BY: JEB  
 CHECKED BY: CMS

PLOT DATE = #DATE\$  
 FILE NAME = #FILE\$  
 PLOT SCALE = #SCALE\$  
 USER NAME = #USER\$

#FILES\$