

F.A.U. RTE.	SECTION	COUNTY	TOTAL SHEETS	SHEET NO.
1578	*	WILL	155	61
STA. 104+70		TO STA. 110+00		
FED. ROAD DIST. NO.		ILLINOIS	FED. AID PROJECT	
* 06-00046-00-PV				

- NOTES:**
- SEE "REMOVAL AND ADJUSTMENT PLANS" FOR REMOVAL OF EXISTING ITEMS.
 - CONTRACTOR SHALL MAINTAIN ACCESS TO ALL SIDE ROADS AND ENTRANCES AT ALL TIMES.
 - THE CONTRACTOR SHALL APPLY TYPE III PAVEMENT MARKING TAPE AS DIRECTED BY THE ENGINEER. THIS ITEM SHALL BE INCLUDED IN THE COST OF TEMPORARY PAVEMENT MARKINGS.

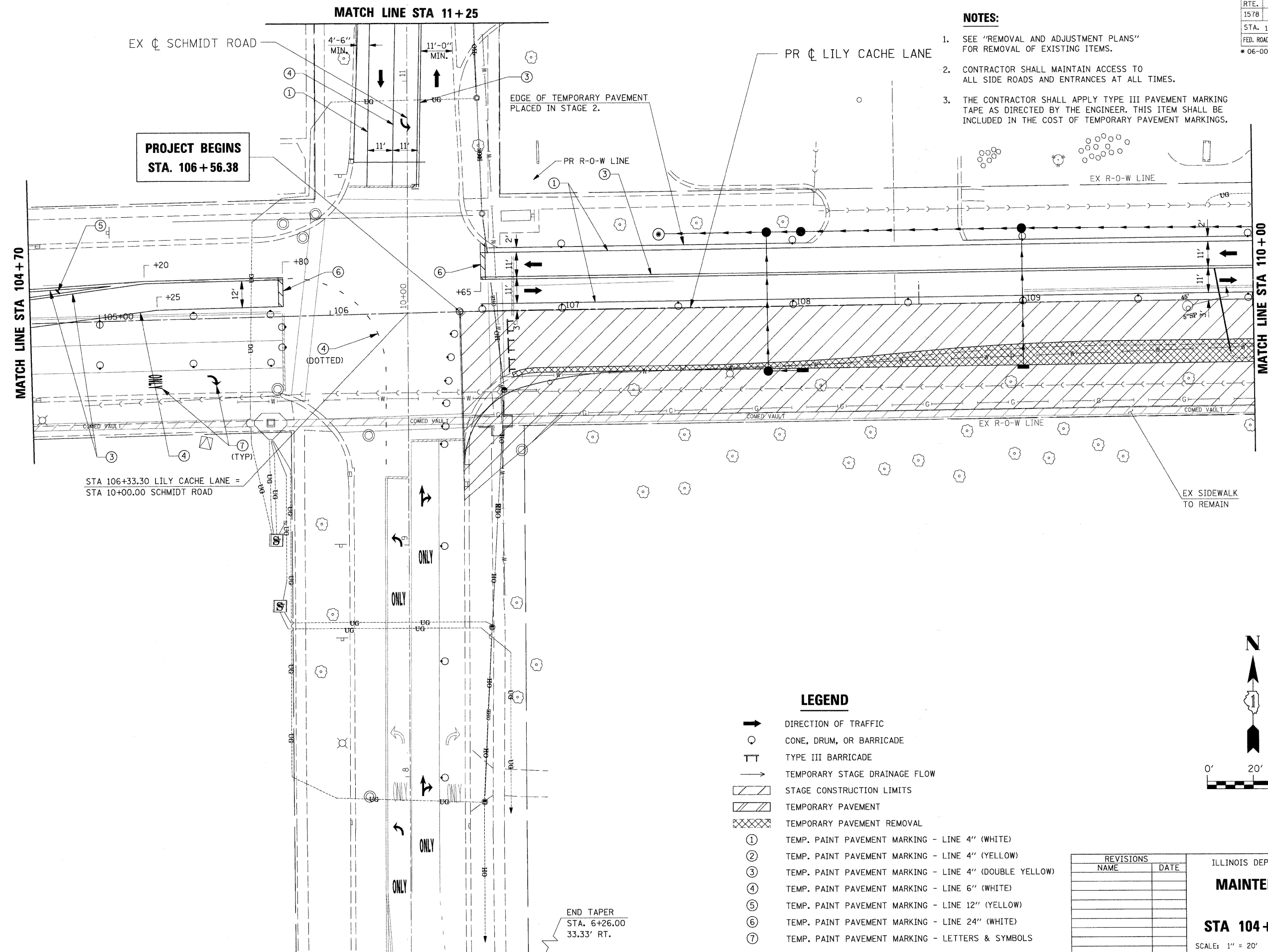

**PROJECT BEGINS
STA. 106+56.38**

STA 106+33.30 LILY CACHE LANE =
STA 10+00.00 SCHMIDT ROAD

END TAPER
STA. 6+26.00
33.33' RT.

- LEGEND**
- ➔ DIRECTION OF TRAFFIC
 - CONE, DRUM, OR BARRICADE
 - TT TYPE III BARRICADE
 - ➔ TEMPORARY STAGE DRAINAGE FLOW
 - ▨ STAGE CONSTRUCTION LIMITS
 - ▨ TEMPORARY PAVEMENT
 - ▨ TEMPORARY PAVEMENT REMOVAL
 - ① TEMP. PAINT PAVEMENT MARKING - LINE 4" (WHITE)
 - ② TEMP. PAINT PAVEMENT MARKING - LINE 4" (YELLOW)
 - ③ TEMP. PAINT PAVEMENT MARKING - LINE 4" (DOUBLE YELLOW)
 - ④ TEMP. PAINT PAVEMENT MARKING - LINE 6" (WHITE)
 - ⑤ TEMP. PAINT PAVEMENT MARKING - LINE 12" (YELLOW)
 - ⑥ TEMP. PAINT PAVEMENT MARKING - LINE 24" (WHITE)
 - ⑦ TEMP. PAINT PAVEMENT MARKING - LETTERS & SYMBOLS

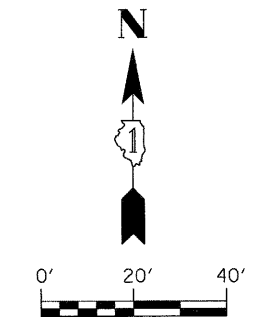

REVISIONS	
NAME	DATE

ILLINOIS DEPARTMENT OF TRANSPORTATION
**MAINTENANCE OF TRAFFIC
STAGE 3
STA 104+70 TO STA 110+00**
SCALE: 1" = 20'
DATE: APRIL 9, 2009
DRAWN BY: JEB
CHECKED BY: CMS

PLOT DATE = #DATE#
FILE NAME = #FILE#
PLOT SCALE = #SCALE#
USER NAME = #USER#