

F.A.U. RTE.	SECTION	COUNTY	TOTAL SHEETS	SHEET NO.
1578	*	WILL	155	70

STA. 104+70	TO STA. 110+00
FED. ROAD DIST. NO.	ILLINOIS FED. AID PROJECT

\*06-00046-00-PV

**NOTES:**

- SEE "REMOVAL AND ADJUSTMENT PLANS" FOR REMOVAL OF EXISTING ITEMS.
- CONTRACTOR SHALL MAINTAIN ACCESS TO ALL SIDE ROADS AND ENTRANCES AT ALL TIMES.
- THE CONTRACTOR SHALL APPLY TYPE III PAVEMENT MARKING TAPE AS DIRECTED BY THE ENGINEER. THIS ITEM SHALL BE INCLUDED IN THE COST OF TEMPORARY PAVEMENT MARKINGS.

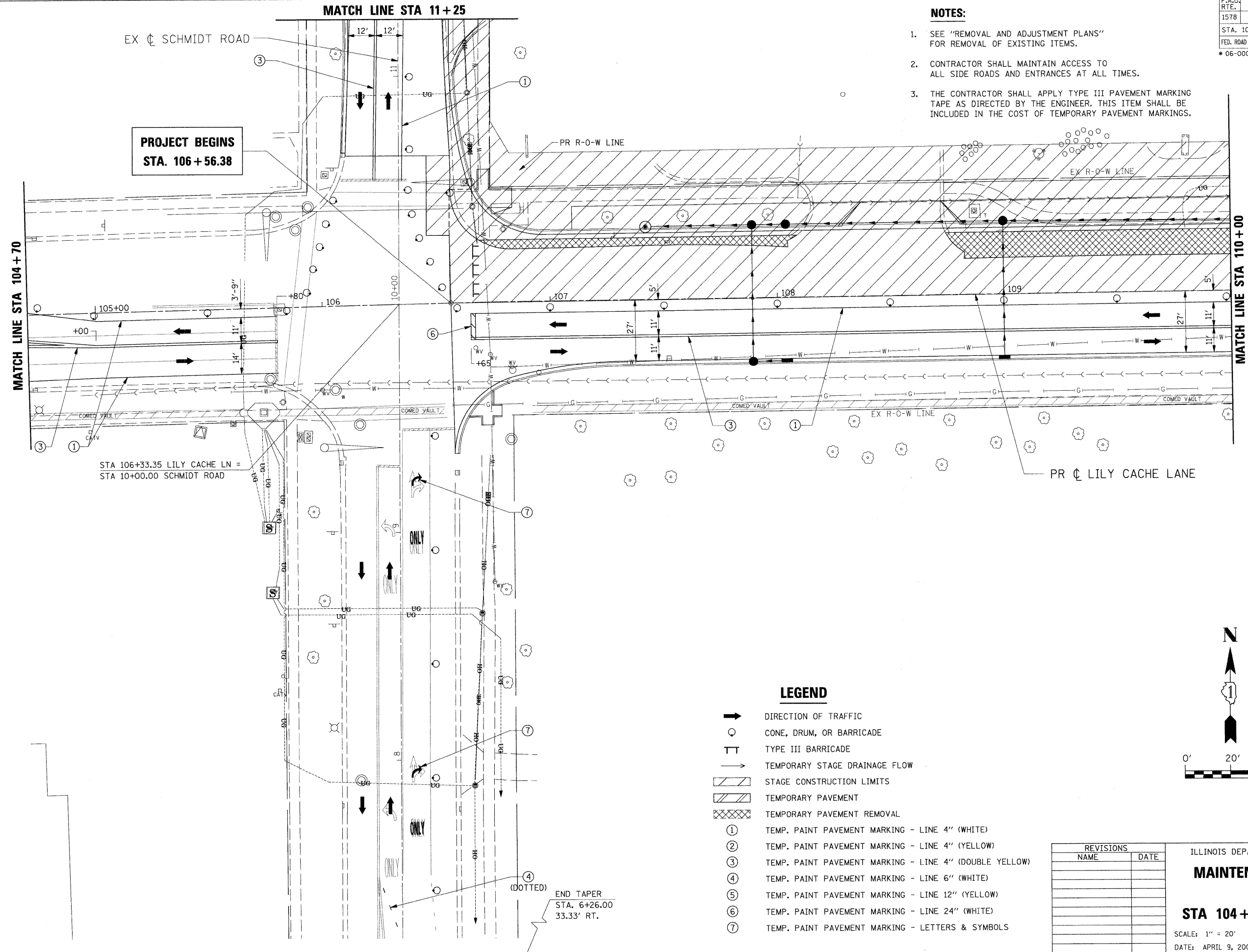

**PROJECT BEGINS  
STA. 106+56.38**

STA 106+33.35 LILY CACHE LN =  
STA 10+00.00 SCHMIDT ROAD

END TAPER  
STA. 6+26.00  
33.33' RT.

**LEGEND**

- ➔ DIRECTION OF TRAFFIC
- CONE, DRUM, OR BARRICADE
- ⊥ TYPE III BARRICADE
- ➔ TEMPORARY STAGE DRAINAGE FLOW
- ▨ STAGE CONSTRUCTION LIMITS
- ▨ TEMPORARY PAVEMENT
- ▨ TEMPORARY PAVEMENT REMOVAL
- ① TEMP. PAINT PAVEMENT MARKING - LINE 4" (WHITE)
- ② TEMP. PAINT PAVEMENT MARKING - LINE 4" (YELLOW)
- ③ TEMP. PAINT PAVEMENT MARKING - LINE 4" (DOUBLE YELLOW)
- ④ TEMP. PAINT PAVEMENT MARKING - LINE 6" (WHITE)
- ⑤ TEMP. PAINT PAVEMENT MARKING - LINE 12" (YELLOW)
- ⑥ TEMP. PAINT PAVEMENT MARKING - LINE 24" (WHITE)
- ⑦ TEMP. PAINT PAVEMENT MARKING - LETTERS & SYMBOLS

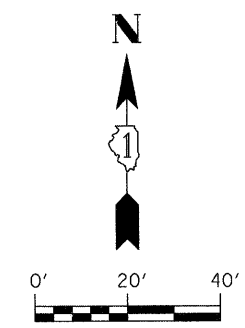

REVISIONS	
NAME	DATE

ILLINOIS DEPARTMENT OF TRANSPORTATION  
**MAINTENANCE OF TRAFFIC  
 STAGE 4  
 STA 104+70 TO STA 110+00**  
 SCALE: 1" = 20'  
 DATE: APRIL 9, 2009  
 DRAWN BY: JEB  
 CHECKED BY: CMS

PLOT DATE = #DATE#  
 PLOT SCALE = #SCALE#  
 PLOT USER = #USER#

#FILES#