

F.A. RTE.	SECTION	COUNTY	TOTAL SHEETS	SHEET NO.
1503	08-00260-01-PV	KANE	176	67
STA. 62+00		TO STA. 68+00		
FED. ROAD DIST. NO.	ILLINOIS	FED. AID PROJECT		

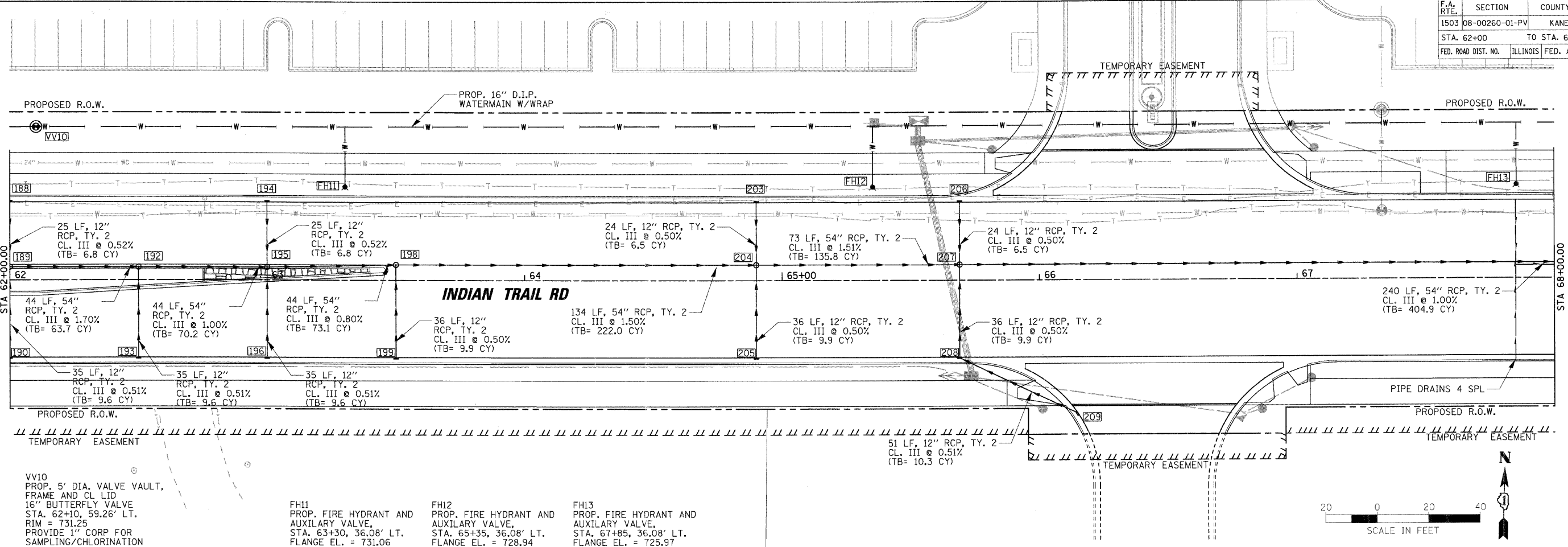

VV10
PROP. 5' DIA. VALVE VAULT,
FRAME AND CL LID
16" BUTTERFLY VALVE
STA. 62+10, 59.26' LT.
RIM = 731.25
PROVIDE 1" CORP FOR
SAMPLING/CHLORINATION

FH11
PROP. FIRE HYDRANT AND
AUXILIARY VALVE,
STA. 63+30, 36.08' LT.
FLANGE EL. = 731.06

FH12
PROP. FIRE HYDRANT AND
AUXILIARY VALVE,
STA. 65+35, 36.08' LT.
FLANGE EL. = 728.94

FH13
PROP. FIRE HYDRANT AND
AUXILIARY VALVE,
STA. 67+85, 36.08' LT.
FLANGE EL. = 725.97

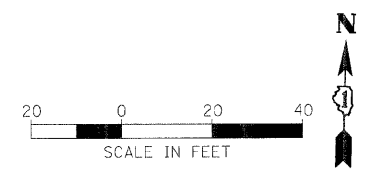

DATE: _____ BY: _____
 SURVEYED: _____
 PLAN: _____
 NOTE BOOK NO.: _____
 ALIGNMENT CHECKED: _____
 PAID FILE NAME: _____

DATE: _____ BY: _____
 SURVEYED: _____
 PROFILE: _____
 NOTE BOOK NO.: _____
 GRADES CHECKED: _____
 B.M. NOTED: _____
 PROSPECTIVE NOTATIONS OK'D:

PLOT DATE = 1/5/2009
 FILE NAME = H:\Aurora\120809_11PH1A\Civil\Sheet\URN.IT.dgn
 PLOT SCALE = 1"=20'
 USER NAME = JUSCL

