

F.A. RTE.	SECTION	COUNTY	TOTAL SHEETS	SHEET NO.
1503	08-00260-01-PV	KANE	176	82
STA. 50+00		TO STA. 62+00		
FED. ROAD DIST. NO.		ILLINOIS FED. AID PROJECT		

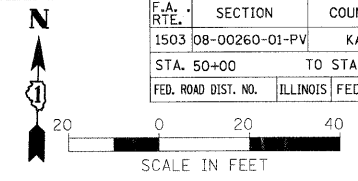

LEGEND

- SODDING, SALT TOLERANT
- SEEDING, CLASS 2A
- TEMPORARY DITCH CHECK
- SEDIMENT CONTROL, SILT FENCE
- DITCH FLOW ARROW
- SEEDING, CLASS 5 (MODIFIED) WET TO MESIC PRAIRIE
- INLET AND PIPE PROTECTION
- TREE
- SHRUB
- TREE ROOT PRUNING AND TREE TRUNK PROTECTION

- NOTES:**
1. TEMPORARY EROSION CONTROL SEEDING SHALL BE USED AT ALL DISTURBED AREAS.
 2. EROSION CONTROL BLANKET SHALL BE USED WITH PERMANENT SEEDING.

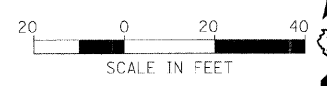
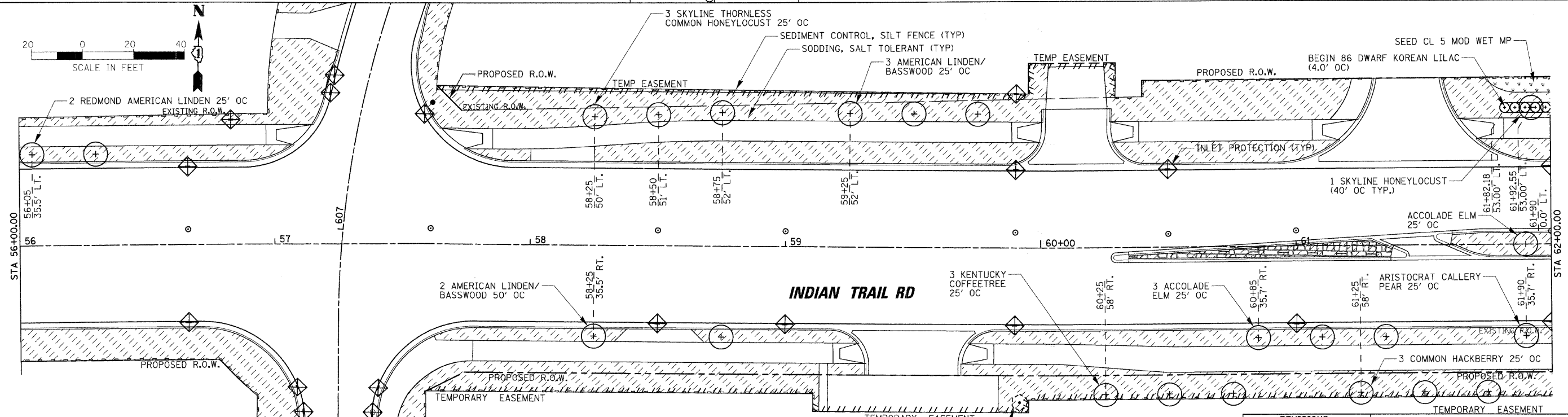
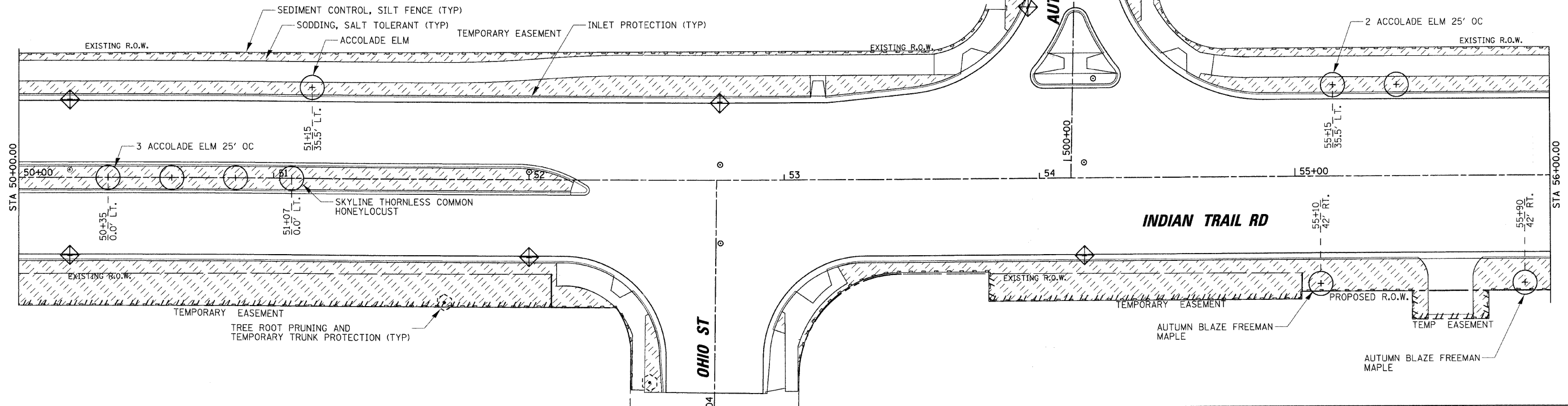

REVISIONS	
NAME	DATE

ILLINOIS DEPARTMENT OF TRANSPORTATION

LANDSCAPING AND EROSION CONTROL
INDIAN TRAIL ROAD
SHEET 3 OF 5

SCALE: VERT. 1" = 20'
DATE: 1/7/09

DRAWN BY: TC
CHECKED BY: TC/SBP



PLOT DATE = 1/5/2009
 FILE NAME = H:\A\p\08-00260-01-PV\1503\INDIAN TRAIL RD\LANDSCAPING.LT_5.dgn
 PLOT SCALE = 1" = 20'
 USER NAME = USER