

MATCH LINE STA. 149+00

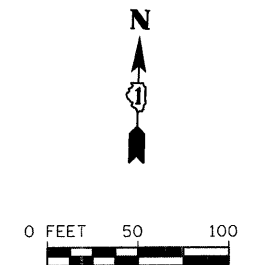
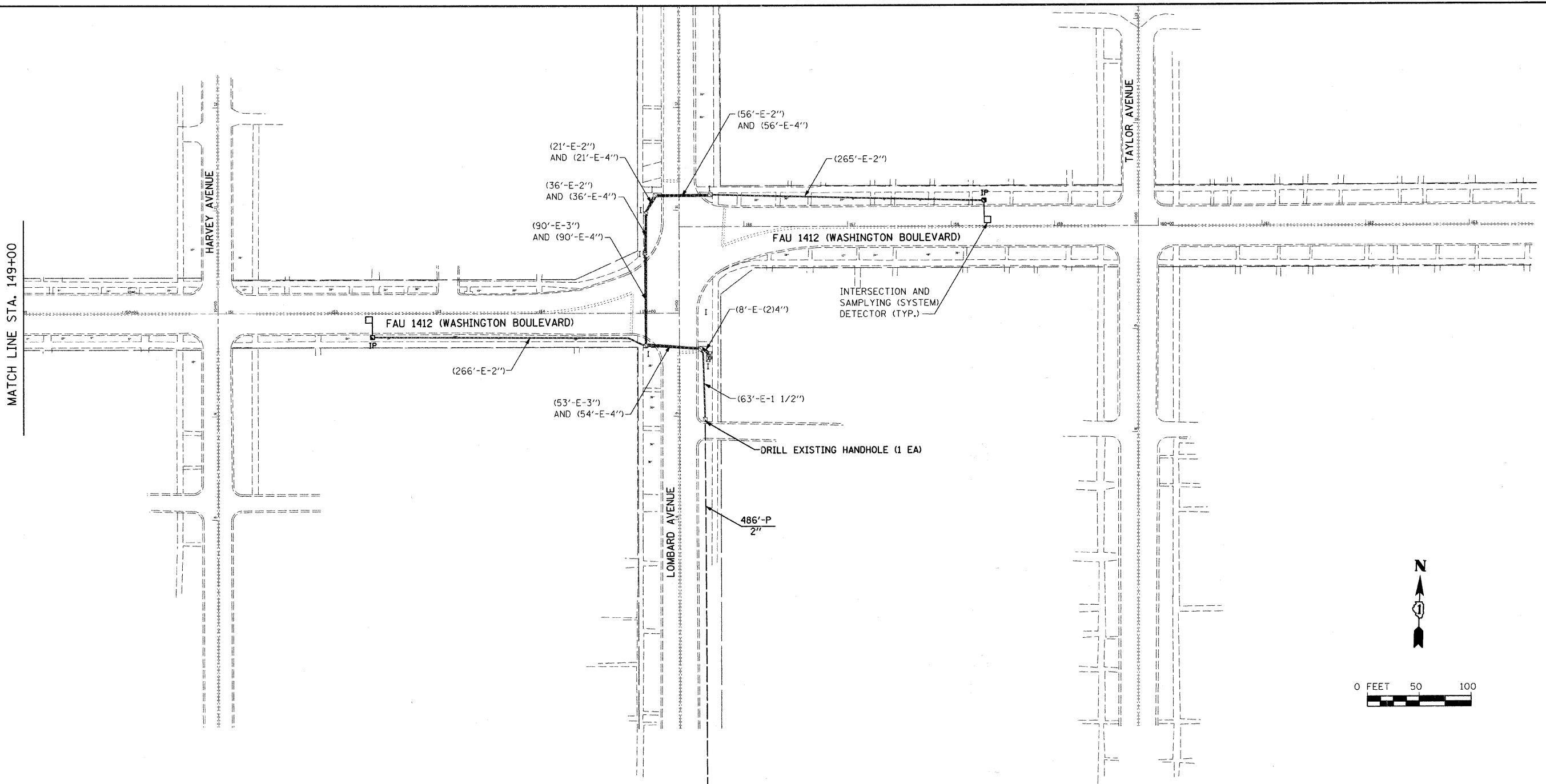

**TRAFFIC SIGNAL LEGEND**

	PROPOSED	EXISTING
CONTROLLER		
HANDHOLE		
HEAVY DUTY HANDHOLE		
DOUBLE HANDHOLE		
G. S. CONDUIT IN GROUND (CIG)		
DETECTOR LOOP		
UNIT DUCT	UD	
SYSTEM	S	
INTERSECTION	IP	I
STAINLESS STEEL JUNCTION BOX		

SEE SHEETS 23 THRU 25 FOR INFORMATION ON THE EXISTING INTERCONNECT ALONG MADISON STREET

**RESTORATION OF WORK AREA**  
 RESTORATION OF THE TRAFFIC SIGNAL WORK AREA SHALL BE INCIDENTAL TO THE RELATED PAY ITEM SUCH AS CONTROLLER, CONDUIT, HANDHOLE, TRENCH AND BACKFILL, ETC., AND NO EXTRA COMPENSATION SHALL BE ALLOWED. ALL ROADWAY SURFACES SUCH AS SHOULDERS, MEDIANS, SIDEWALKS, BRICK PAVER, PAVEMENT, ETC., SHALL BE REPLACED IN KIND. ALL DAMAGE TO MOWED LAWNS SHALL BE REPLACED WITH AN APPROVED SOD, IN ACCORDANCE WITH STANDARD SPECIFICATION.

FILE NAME = s:\j\157209-6799\6784\089\micro\Interconnect Sheets\Washington-3.dgn



USER NAME = adamn	DESIGNED -	REVISED -
PLOT SCALE = 50.0000' / IN.	DRAWN -	REVISED -
PLOT DATE = 5/26/2009	CHECKED -	REVISED -
	DATE -	REVISED -

**STATE OF ILLINOIS  
 DEPARTMENT OF TRANSPORTATION**

**WASHINGTON BOULEVARD INTERCONNECT PLAN**

SCALE: AS SHOWN SHEET NO. OF SHEETS STA. TO STA.

F.A.U. RTE. 1412	SECTION 07-00245-00-TL	COUNTY COOK	TOTAL SHEETS 64	SHEET NO. 21
FED. ROAD DIST. NO. ILLINOIS			FED. AID PROJECT	
CONTRACT NO. 63112				