

STATE OF ILLINOIS
DEPARTMENT OF TRANSPORTATION
DIVISION OF HIGHWAYS

**PROPOSED
HIGHWAY PLANS**

FAI ROUTE 57
SECTION D5 PATCHING 2010-1

PAVEMENT PATCHING
0.3 MIN OF US 36 TO SADORUS RD
DOUGLAS AND CHAMPAIGN COUNTIES

C-95-048-09 3RD P.M.
R8E R9E

F.A.I. RTE.	SECTION	COUNTY	TOTAL SHEETS	SHEET NO.
57	D5 PATCHING 2010-1	ILLINOIS	12	1
ILLINOIS			CONTRACT NO. 70815	

D-95-048-09

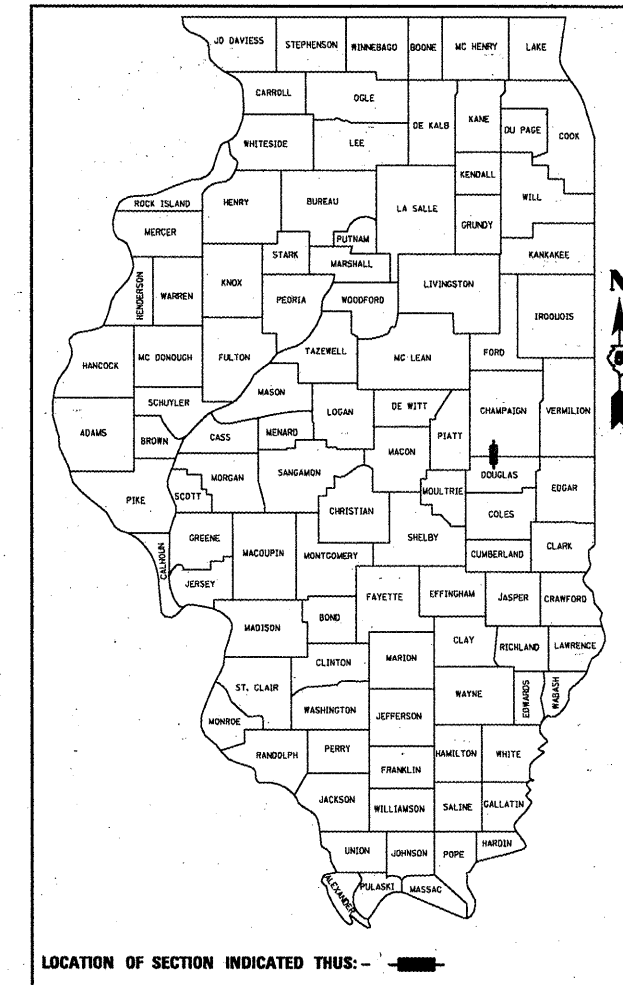

FOR INDEX OF SHEETS, SEE SHEET NO. 2

PROJECT OMISSIONS:

- STA. 553+92.10 TO STA. 556+91.10 - NB STR. 021-2008 OVER UP RR & CSX RR
- STA. 553+92.10 TO STA. 556+91.10 - SB STR. 021-2009 OVER UP RR & CSX RR
- STA. 560+12.60 TO STA. 563+29.70 - NB STR. 021-2010 OVER HAYES BRANCH
- STA. 560+63.40 TO STA. 563+82.10 - SB STR. 021-2011 OVER HAYES BRANCH
- STA. 937+27.50 TO STA. 942+92.60 - NB STR. 010-0200 OVER IC RR & TR 132
- STA. 936+60.40 TO STA. 942+25.50 - SB STR. 010-0201 OVER IC RR & TR 132
- STA. 117+43.70 TO STA. 119+47.00 - NB STR. 010-0198 OVER US 45 (FAS 529)
- STA. 117+51.40 TO STA. 119+54.80 - SB STR. 010-0199 OVER US 45 (FAS 529)

ADT: 20,350 (2009)
PC: 13,197 (64.9%)
SU: 997 (4.9%)
MU: 6,156 (30.2%)

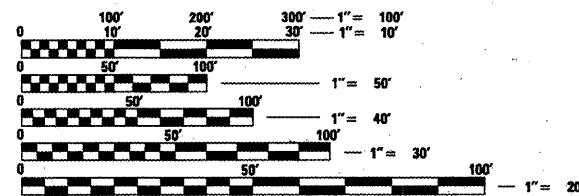

FULL SIZE PLANS HAVE BEEN PREPARED USING STANDARD ENGINEERING SCALES. REDUCED SIZED PLANS WILL NOT CONFORM TO STANDARD SCALES. IN MAKING MEASUREMENTS ON REDUCED PLANS, THE ABOVE SCALES MAY BE USED.

J.U.L.I.E.
JOINT UTILITY LOCATION INFORMATION FOR EXCAVATION
1-800-892-0123 PESOTUM TOWNSHIP (CHAMPAIGN CO.)
OR 811 TUSCOLA TOWNSHIP (DOUGLAS CO.)

PROJECT ENGINEER: KEVIN TRAPP
PROJECT MANAGER: RUSTIN KEYS

CONTRACT NO. 70815

STATION EQUATION
STATION 945+52.78 (BK) =
STATION 104+50.00 (AH)

STATION EQUATION
STATION 881+68.05 (BK) =
STATION 881+68.75 (AH)

STATION EQUATION
STATION 843+84.01 (BK) =
STATION 843+85.95 (AH)

STATION EQUATION
STATION 791+00.00 (BK) =
STATION 791+02.19 (AH)

STATION EQUATION
STATION 736+24.61 (BK) =
STATION 736+26.44 (AH)

STATION EQUATION
STATION 687+00.00 (BK) =
STATION 687+03.30 (AH)

STATION EQUATION
STATION 575+43.68 (BK) =
STATION 575+43.98 (AH)

STATION EQUATION
STATION 547+00.00 (BK) =
STATION 547+01.25 (AH)

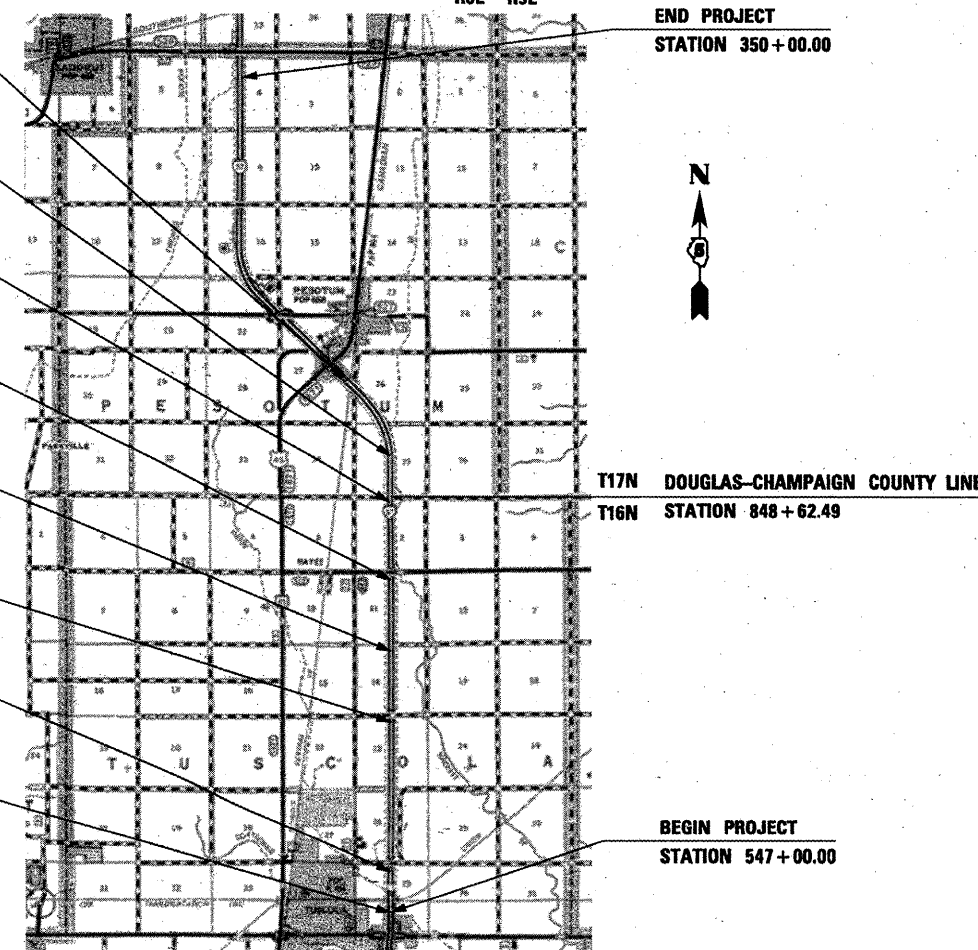

GROSS LENGTH = 64,391.27 FT. = 12.195 MILES
NET LENGTH = 63,005.95 FT. = 11.933 MILES

STATE OF ILLINOIS
DEPARTMENT OF TRANSPORTATION
DIVISION OF HIGHWAYS

SUBMITTED 5/13 20 09

Joseph E. Gove
DEPUTY DIRECTOR OF HIGHWAYS, REGION ENGINEER

June 26, 20 09
Charles J. Dransoll
ENGINEER OF DESIGN AND ENVIRONMENT

June 26, 20 09
Christine M. Reed
DIRECTOR OF HIGHWAYS, CHIEF ENGINEER

PRINTED BY THE AUTHORITY
OF THE STATE OF ILLINOIS