

**STATE OF ILLINOIS**  
**DEPARTMENT OF TRANSPORTATION**  
**DIVISION OF HIGHWAYS**  
**PROPOSED**  
**CONTRACT MAINTENANCE**

F.A.I. RTE.	SECTION	COUNTY	TOTAL SHEETS	SHEET NO.
I-55	54-4 INT-RS	LOGAN	6	1
ILLINOIS			72C95	

FOR INDEX OF SHEETS, SEE SHEET NO. 2

- 1 COVER SHEET
- 2 GENERAL NOTES
- 3 SUMMARY OF QUANTITIES
- 4 TYPICAL SECTIONS
- 5 SUMMARY SHEET
- 6 DETAILS

**HIGHWAY STANDARDS**

- 701101-02
- 701400-03
- 701406-05
- 701411-05
- 701426-03
- 701901-01
- 780001-02
- 781001-03
- 000001-05

**FAI ROUTE 55 (I-55)**  
**SECTION 54-4 INT-RS**

**LOGAN COUNTY**

C-96-090-09

D-96-090-09



ADT'S : 19,500 (SOUTH OF BL-55)  
 21,300 (NORTH OF BL-55)

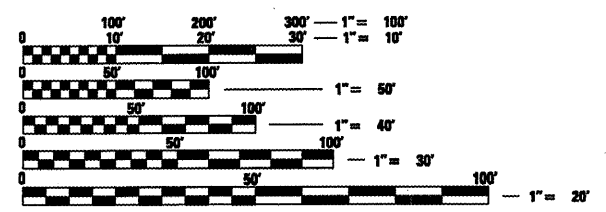

FULL SIZE PLANS HAVE BEEN PREPARED USING STANDARD ENGINEERING SCALES. REDUCED SIZED PLANS WILL NOT CONFORM TO STANDARD SCALES. IN MAKING MEASUREMENTS ON REDUCED PLANS, THE ABOVE SCALES MAY BE USED.

J.U.L.I.E.  
 JOINT UTILITY LOCATION INFORMATION FOR EXCAVATION  
 1-800-892-0123  
 OR 811

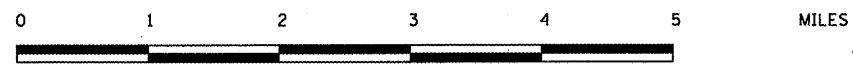
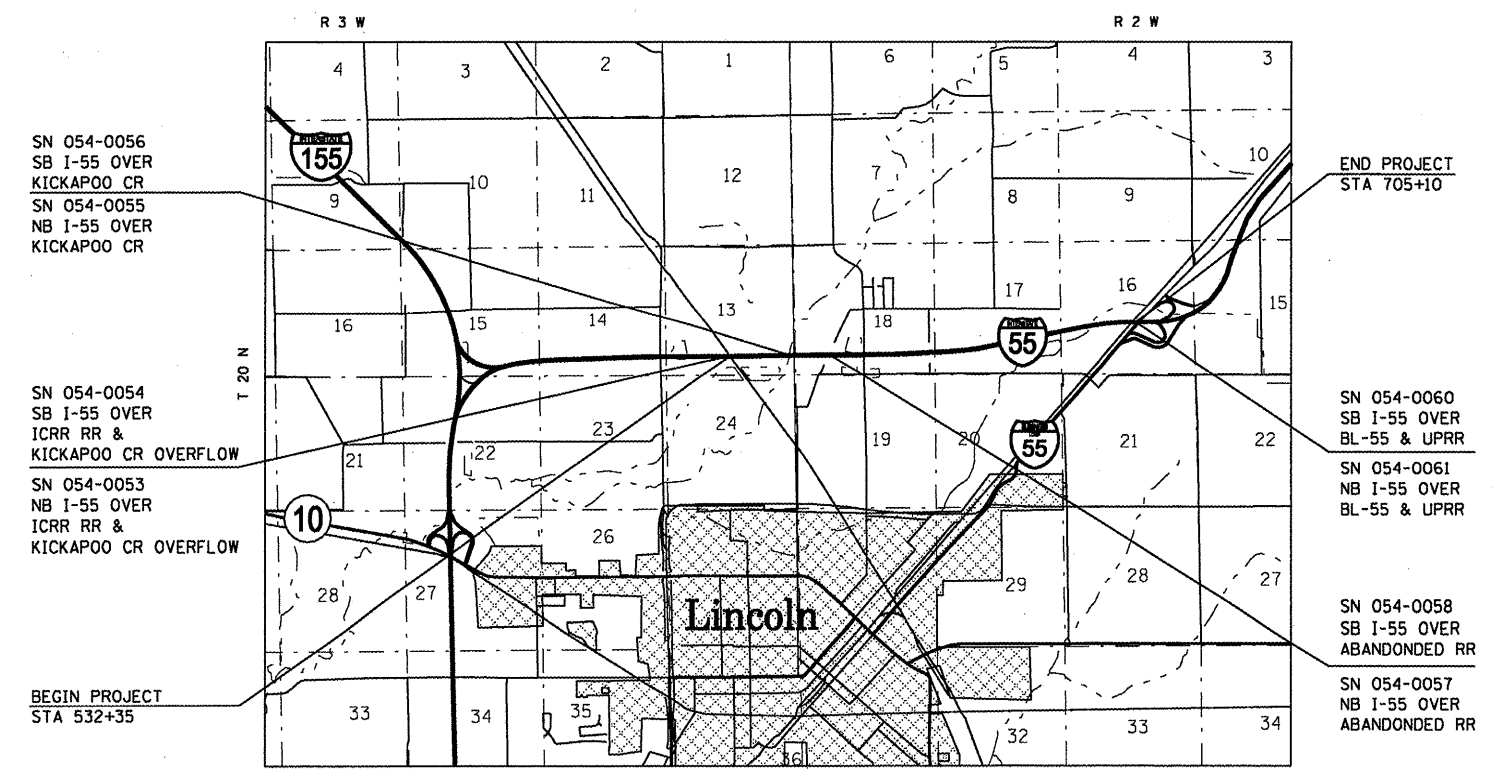

SCALE

GROSS LENGTH = 17,275 FT. = 3.27 MILE  
 NET LENGTH = 2,400 FT. = 0.45 MILE

**PROJECT ENGINEER: SAL MADONIA 217-782-4761**  
**SQUAD LEADER: JEFFREY P. MYERS 217-524-7940**

**CONTRACT NO. 72C95**

**STATE OF ILLINOIS**  
**DEPARTMENT OF TRANSPORTATION**  
**DIVISION OF HIGHWAYS**

SUBMITTED May 14 2009  
Rose Z. Dushoff  
 DEPUTY DIRECTOR OF HIGHWAYS, REGION ENGINEER

June 26, 2009  
Charles J. Ingersoll  
 ENGINEER OF DESIGN AND ENVIRONMENT

June 26, 2009  
Christine M. Reed  
 DIRECTOR OF HIGHWAYS, CHIEF ENGINEER

**PRINTED BY THE AUTHORITY**  
**OF THE STATE OF ILLINOIS**