

F.A.P. RTE.	SECTION	COUNTY	TOTAL SHEETS	SHEET NO.
311	04-00094-01-SW	DU PAGE	9	1
FEDERAL RD. DIST. NO.		ILLINOIS FEDERAL AID PROJECT		
CONTRACT NO.: 83997				

STATE OF ILLINOIS
DEPARTMENT OF TRANSPORTATION
DIVISION OF HIGHWAYS

PLANS FOR PROPOSED FEDERAL AID HIGHWAY

FAP ROUTE 311/US 34 (OGDEN AVENUE) SIDEWALK IMPROVEMENTS

PROJECT NO.: M-9003(280)
SECTION NO.: 04-00094-01-SW
VILLAGE OF DOWNERS GROVE
DU PAGE COUNTY
JOB NO.: C-91-489-09

INDEX OF SHEETS

- COVER SHEET
- LEGEND, GENERAL NOTES & SUMMARY OF QUANTITIES
- EXISTING AND PROPOSED TYPICAL SECTIONS
- DETAILS
- PLAN AND PROFILE STA 0+77 TO STA 5+65
- PLAN AND PROFILE STA 5+65 TO STA 11+30
- PLAN AND PROFILE STA 11+30 TO STA 16+50
- PLAN AND PROFILE STA 16+50 TO STA 21+50
- PLAN AND PROFILE STA 41+50 TO STA 46+50
- PLAN AND PROFILE STA 46+50 TO STA 51+50
- PLAN AND PROFILE STA 51+50 TO STA 56+50
- PLAN AND PROFILE STA 56+50 TO STA 61+50
- PLAN AND PROFILE STA 66+50 TO STA 71+50
- PLAN AND PROFILE STA 71+50 TO STA 76+50
- PLAN AND PROFILE STA 76+50 TO STA 81+50
- TRAFFIC CONTROL & PROTECTION FOR SIDE ROADS, INTERSECTIONS AND DRIVEWAYS
- DISTRICT ONE TYPICAL PAVEMENT MARKINGS
- DRIVEWAY DETAILS DISTANCE BETWEEN ROW AND FACE OF CURB <15'(4.5 M) BD-01
- DRIVEWAY DETAILS - DISTANCE BETWEEN ROW AND FACE OF CURB & EDGE OF SHOULDER >= 15'(4.5m) BD-02

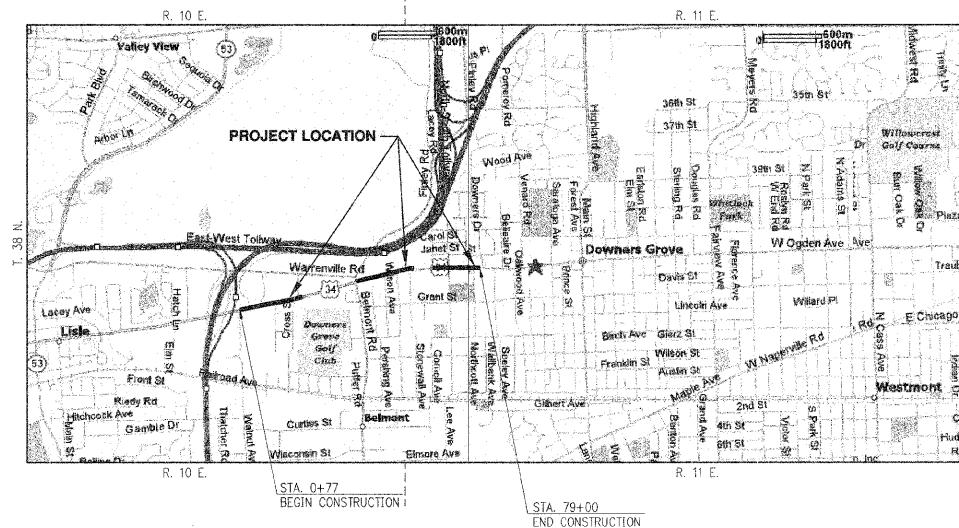
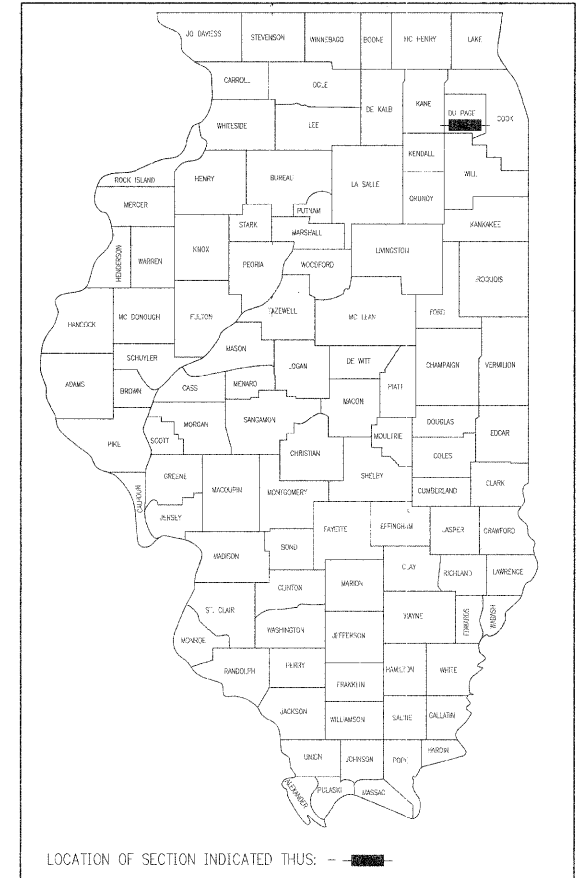

STATE STANDARDS

- 000001-05 STANDARD SYMBOL, ABBREVIATIONS AND PATTERNS
- 424001-05 CURB RAMPS FOR SIDEWALKS
- 606001-04 CONCRETE CURB AND COMB. CONCRETE CURB AND GUTTER
- 701606-06 URBAN LANE CLOSURE, MULTILANE 2W WITH MOUNTABLE MEDIAN
- 701801-04 LANE CLOSURE, MULTILANE, 1W OR 2W CROSSWALK OR SIDEWALK CLOSURE
- 701901-01 TRAFFIC CONTROL DEVICES
- 780001-02 TYPICAL PAVEMENT MARKINGS



LENGTH OF PROJECT
GROSS PROJECT LENGTH= 18,655 FEET (3.53 MILES)
NET PROJECT LENGTH= 3,170 FEET (0.60 MILES)

DESIGN DESIGNATION

OGDEN AVENUE (ADT-2001) 36,400
SPEED LIMIT 35 MPH

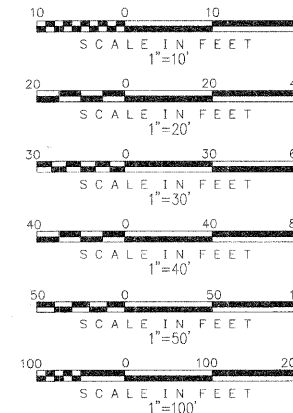

WARNING



CALL
J.U.L.I.E.
BEFORE YOU DIG
1-800-892-0123

CONTRACT NO.: 83997

CONTACT

VILLAGE OF DOWNERS GROVE
ENGINEERING DIVISION
CONTACT: BRIAN PARKS
OFFICE: 630-434-6822
FAX: 630-434-5495

BURNS & MCDONNELL
CONTACT: ANTHONY BRYANT
OFFICE: 630-724-3200
FAX: 630-724-3201

IDOT
CONTACT: MARILYN SOLOMON
OFFICE: 847-705-4407
FAX: 847-705-4203

DUDOI
CONTACT: ROBERT KOLAR
OFFICE: 630-407-6900
FAX: 630-407-6901

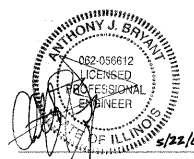

ANTHONY J. BRYANT, P.E.
NO. 082-056612
EXP. DATE: 11/30/2009

FULL SIZE PLANS HAVE BEEN PREPARED USING STANDARD ENGINEERING SCALES, REDUCED SIZED PLANS WILL NOT CONFORM TO STANDARD SCALES, IN MAKING MEASUREMENT ON REDUCED PLANS, THE ABOVE SCALES MAY BE USED.

STATE OF ILLINOIS
DEPARTMENT OF TRANSPORTATION
DIVISION OF HIGHWAYS

Approved: *Michael D. Mullett*
Village Engineer
Local Agency, Position

Passed: *MAY 29, 2009*
C. H. H. C. H. H. C. H. H.
District # Engineer of Local Roads & Streets

Releasing for Bid
Based on Limited
Review: *MAY 29, 2009*
Diane M. O'Hara
Deputy of Highways, Region # Engineer

**PRINTED BY THE AUTHORITY
OF THE STATE OF ILLINOIS**



IL DESIGN FIRM NO.
184-001310