

HORIZONTAL & VERTICAL CONTROL

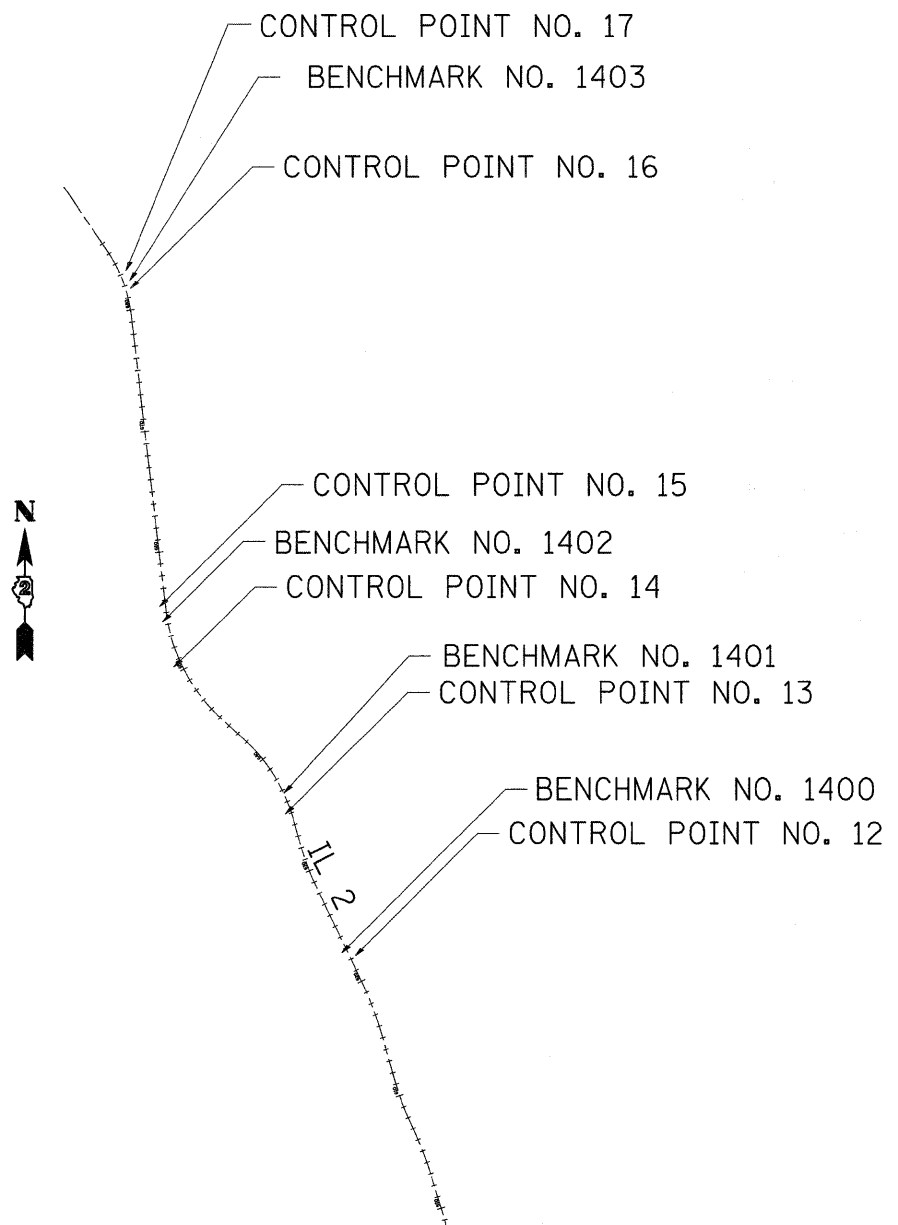

CURVE POINT NUMBERS					
CHAIN	CURVE	PI	CC	PC	PT
EXIL2	200	200	201	202	203
EXIL2	210	210	211	212	213
EXIL2	220	220	221	222	223
EXIL2	230	230	231	232	233
EXIL2	240	240	241	242	243
EXIL2	250	250	251	252	253
EXIL2	260	260	261	262	263
EXIL2	270	270	271	272	273

Chain EXIL2 contains:
 60 CUR 200 CUR 210 CUR 220 CUR 230 CUR 240 CUR 250 CUR 260 CUR 270 CUR 280 CUR-
 290 CUR 300 CUR 310 CUR 320 CUR 330 CUR 340 CUR 350 CUR 360 CUR 370 CUR 380 CU-
 R 390 CUR 400 CUR 410 CUR 420 CUR 430 CUR 440 CUR 450 CUR 460 CUR 470 CUR 480 C-
 UR 490 114

Beginning chain EXIL2 description
 =====

Point 60 N 1,945,719.68 E 726,654.57 Sta 538+74.25

Course from 60 to PC 200 0° 53' 05.31" Dist 5,814.61'

Curve Data

Curve 200
 P.I. Station 598+16.73 N 1,951,661.45 E 726,746.33
 Delta = 17° 45' 27.23" (LT)
 Degree = 7° 00' 00.03"
 Tangent = 127.86'
 Length = 253.68'
 Radius = 818.51'
 External = 9.93'
 Long Chord = 252.67'
 Mid. Ord. = 9.81'
 P.C. Station 596+88.86 N 1,951,533.60 E 726,744.36
 P.T. Station 599+42.54 N 1,951,783.81 E 726,709.22
 C.C. N 1,951,546.24 E 725,925.95

Course from PT 200 to PC 210 343° 07' 38.08" Dist 359.08'

Curve Data

Curve 210
 P.I. Station 604+39.28 N 1,952,259.16 E 726,565.04
 Delta = 6° 52' 28.13" (LT)
 Degree = 2° 30' 00.00"
 Tangent = 137.65'
 Length = 274.98'
 Radius = 2,291.83'
 External = 4.13'
 Long Chord = 274.81'
 Mid. Ord. = 4.12'
 P.C. Station 603+01.62 N 1,952,127.43 E 726,605.00
 P.T. Station 605+76.60 N 1,952,385.16 E 726,509.61
 C.C. N 1,951,462.24 E 724,411.82

Course from PT 210 to PC 220 336° 15' 09.95" Dist 216.99'

Curve Data

Curve 220
 P.I. Station 609+49.15 N 1,952,726.17 E 726,359.58
 Delta = 7° 45' 57.61" (RT)
 Degree = 2° 30' 00.00"
 Tangent = 155.56'
 Length = 310.64'
 Radius = 2,291.83'
 External = 5.27'
 Long Chord = 310.40'
 Mid. Ord. = 5.26'
 P.C. Station 607+93.60 N 1,952,583.78 E 726,422.22
 P.T. Station 611+04.24 N 1,952,875.72 E 726,316.75
 C.C. N 1,953,506.71 E 728,520.01

Course from PT 220 to PC 230 344° 01' 07.55" Dist 409.84'

Curve Data

Curve 230
 P.I. Station 617+60.09 N 1,953,506.22 E 726,136.18
 Delta = 9° 48' 58.62" (LT)
 Degree = 2° 00' 00.00"
 Tangent = 246.01'
 Length = 490.81'
 Radius = 2,864.79'
 External = 10.54'
 Long Chord = 490.21'
 Mid. Ord. = 10.50'
 P.C. Station 615+14.08 N 1,953,269.72 E 726,203.91
 P.T. Station 620+04.89 N 1,953,727.71 E 726,029.12
 C.C. N 1,952,480.98 E 723,449.84

Course from PT 230 to PC 240 334° 12' 08.93" Dist 865.22'

Curve Data

Curve 240
 P.I. Station 630+51.33 N 1,954,669.86 E 725,573.72
 Delta = 10° 14' 29.72" (RT)
 Degree = 2° 49' 59.99"
 Tangent = 181.22'
 Length = 361.47'
 Radius = 2,022.21'
 External = 8.10'
 Long Chord = 360.99'
 Mid. Ord. = 8.07'
 P.C. Station 628+70.11 N 1,954,506.70 E 725,652.59
 P.T. Station 632+31.58 N 1,954,844.43 E 725,525.12
 C.C. N 1,955,386.75 E 727,473.25

Course from PT 240 to PC 250 344° 26' 38.65" Dist 200.34'

Curve Data

Curve 250
 P.I. Station 638+41.48 N 1,955,431.99 E 725,361.56
 Delta = 31° 54' 49.09" (LT)
 Degree = 3° 59' 59.99"
 Tangent = 409.56'
 Length = 797.84'
 Radius = 1,432.40'
 External = 57.40'
 Long Chord = 787.57'
 Mid. Ord. = 55.19'
 P.C. Station 634+31.31 N 1,955,037.43 E 725,471.40
 P.T. Station 642+29.75 N 1,955,708.85 E 725,059.74
 C.C. N 1,954,653.29 E 724,091.47

Course from PT 250 to PC 260 312° 31' 49.56" Dist 258.24'

Curve Data

Curve 260
 P.I. Station 650+19.25 N 1,956,242.54 E 724,477.95
 Delta = 40° 41' 54.26" (RT)
 Degree = 3° 59' 59.99"
 Tangent = 531.26'
 Length = 1,017.46'
 Radius = 1,432.40'
 External = 95.35'
 Long Chord = 996.20'
 Mid. Ord. = 89.39'
 P.C. Station 644+88.00 N 1,955,883.42 E 724,869.44
 P.T. Station 655+05.46 N 1,956,770.09 E 724,415.31
 C.C. N 1,956,938.98 E 725,837.71

Course from PT 260 to PC 270 353° 13' 43.82" Dist 2,440.91'

Curve Data

Curve 270
 P.I. Station 682+46.40 N 1,959,491.92 E 724,092.14
 Delta = 27° 27' 51.62" (LT)
 Degree = 4° 40' 00.00"
 Tangent = 300.03'
 Length = 588.52'
 Radius = 1,227.77'
 External = 36.13'
 Long Chord = 582.90'
 Mid. Ord. = 35.09'
 P.C. Station 679+46.37 N 1,959,193.98 E 724,127.52
 P.T. Station 685+34.89 N 1,959,739.96 E 723,923.35
 C.C. N 1,959,049.22 E 722,908.31

Course from PT 270 to PC 280 325° 45' 52.20" Dist 626.27'