

STAGE 2

STA. 673+00 - 680+00

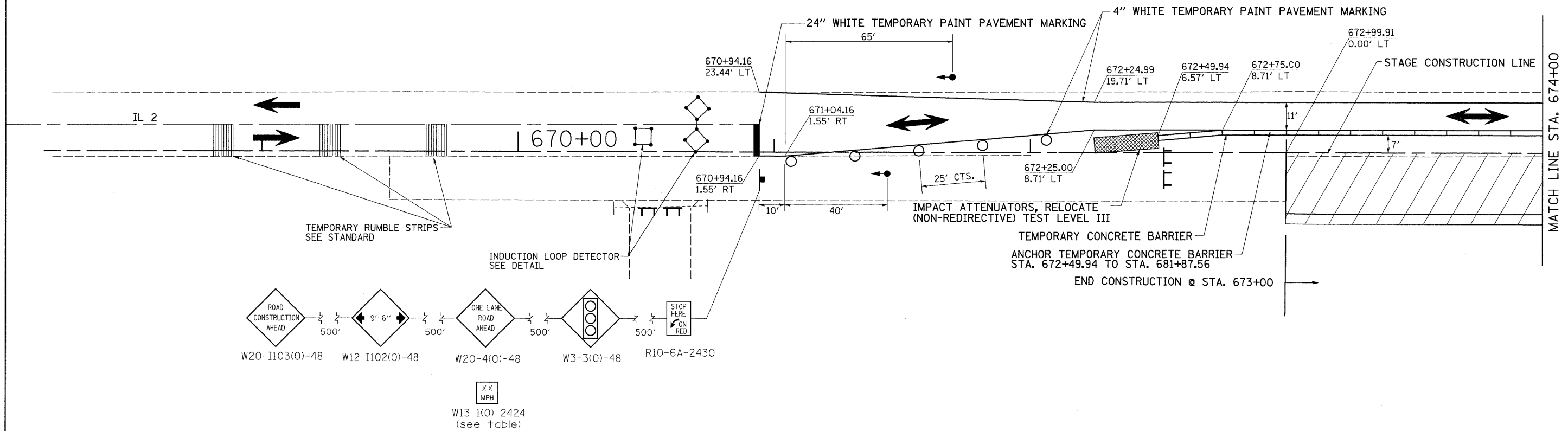

STAGE 2 NOTES

1. USE STANDARD 701321. SEE STANDARDS FOR ADDITIONAL SIGNING AND DEVICES NOT SHOWN IN DETAILS.
2. REMOVAL OF GUARDRAIL AT RT. STA. 677+19 TO 678+70.
3. REMOVAL OF EXISTING PAVEMENT FROM STA. 673+00 TO STA. 680+00 TO THE STAGE CONSTRUCTION LINE.
4. PLACE TEMPORARY SHEET PILING.
5. CONSTRUCT DOWNSTREAM END OF CAST-IN-PLACE DOUBLE 7' X 3' BOX CULVERT.
6. REMOVAL OF DOWNSTREAM PORTION OF EXISTING 12' X 3' BOX CULVERT, (MAINTAIN EXISTING FLOW).
7. CONSTRUCT SUB-BASE GRANULAR MATERIAL, TYPE A.
8. CONSTRUCT PCC PAVEMENT (JOINTED) & PCC SHOULDERS.
9. INSTALL STEEL PLATE BEAM GUARDRAIL, TYPE A AT RT. STA. 676+59 TO 680+00.
10. RELOCATE IMPACT ATTENUATOR FROM STA. 680+00 TO 672+50.
11. INSTALL IMPACT ATTENUATOR AT STA. 681+88.

	= WORK AREA
	= TYPE III BARRICADE WITH FLASHING LIGHTS
	= SIGN
	= BARRICADE, OR DRUM WITH STEADY BURNING LIGHTS
	= INDUCTION LOOP DETECTOR
	= TRAFFIC SIGNAL
	= TEMPORARY RUMBLE STRIPS

FILE NAME =	USER NAME = cushmanbw	DESIGNED -	REVISED -	STATE OF ILLINOIS DEPARTMENT OF TRANSPORTATION	STAGE 2	F.A.P. RTE. 742	SECTION 37RS-3	COUNTY OGLE	TOTAL SHEETS 345	SHEET NO. 68
al\pw_work\PWIDOT\CUSHMANBW\dms34123\dms34123.dwg	6486stg69.dgn	DRAWN -	REVISED -							
	PLOT SCALE = 20.0000' / IN.	CHECKED -	REVISED -							
	PLOT DATE = Fri May 01 07:29:43 2009	DATE -	REVISED -							
						SCALE:	SHEET NO.	OF	SHEETS	STA. TO STA.
						CONTRACT NO. 84788				
						FED. ROAD DIST. NO. ILLINOIS FED. AID PROJECT				