

STAGE 2

STA. 673+00 - 680+00

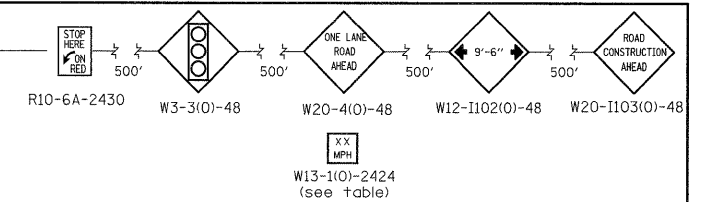
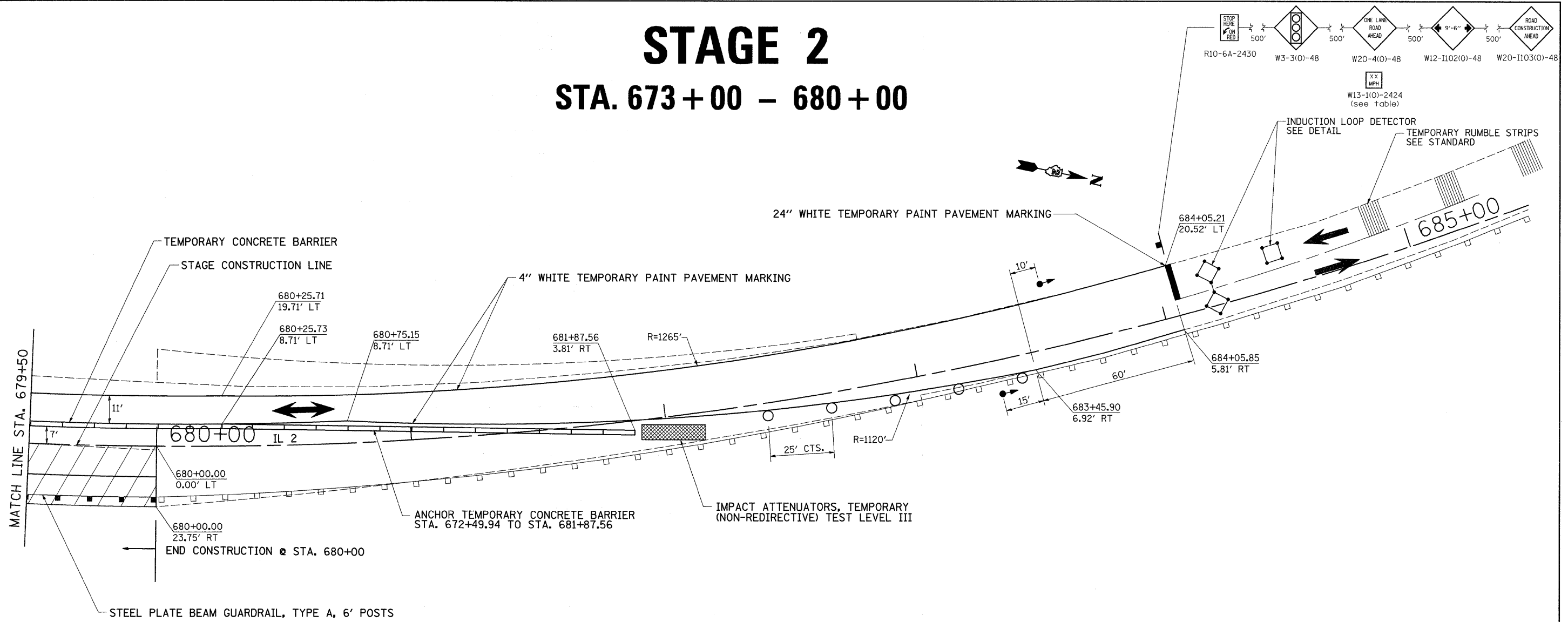

STAGE 2 NOTES

1. USE STANDARD 701321. SEE STANDARDS FOR ADDITIONAL SIGNING AND DEVICES NOT SHOWN IN DETAILS.
2. REMOVAL OF GUARDRAIL AT RT. STA. 677+19 TO 678+70.
3. REMOVAL OF EXISTING PAVEMENT FROM STA. 673+00 TO STA. 680+00 TO THE STAGE CONSTRUCTION LINE.
4. PLACE TEMPORARY SHEET PILING.
5. CONSTRUCT DOWNSTREAM END OF CAST-IN-PLACE DOUBLE 7' X 3' BOX CULVERT.
6. REMOVAL OF DOWNSTREAM PORTION OF EXISTING 12' X 3' BOX CULVERT, (MAINTAIN EXISTING FLOW).
7. CONSTRUCT SUB-BASE GRANULAR MATERIAL, TYPE A.
8. CONSTRUCT PCC PAVEMENT (JOINTED) & PCC SHOULDERS.
9. INSTALL STEEL PLATE BEAM GUARDRAIL, TYPE A AT RT. STA. 676+59 TO 680+00.
10. RELOCATE IMPACT ATTENUATOR FROM STA. 680+00 TO 672+50.
11. INSTALL IMPACT ATTENUATOR AT STA. 681+88.

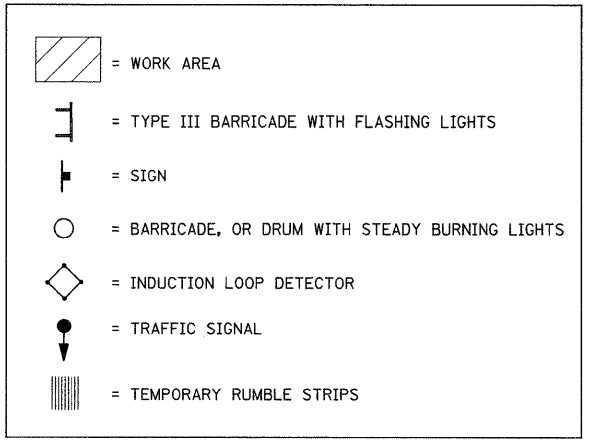

| | | | | | | | | | | | |
|--|-----------------------|------------|-----------|---|----------------|---|---------|--------|--------------|-----------|--|
| FILE NAME = | USER NAME = cushmanbw | DESIGNED - | REVISED - | STATE OF ILLINOIS DEPARTMENT OF TRANSPORTATION | STAGE 2 | F.A.P. RTE. | SECTION | COUNTY | TOTAL SHEETS | SHEET NO. | |
| ci:\pw_work\PIWIDOT\CUSHMANBW\dms34123\6486atg69.dgn | 6486atg69.dgn | DRAWN - | REVISED - | | | 742 | 37RS-3 | OGLE | 345 | 70 | |
| PLOT SCALE = 20,0000' / IN. | CHECKED - | REVISED - | REVISED - | | | CONTRACT NO. 84788 | | | | | |
| PLOT DATE = Fri May 01 07:30:08 2009 | DATE - | REVISED - | REVISED - | | | FED. ROAD DIST. NO. ILLINOIS FED. AID PROJECT | | | | | |