

# STAGE 3

## STA. 673+00 - 680+00

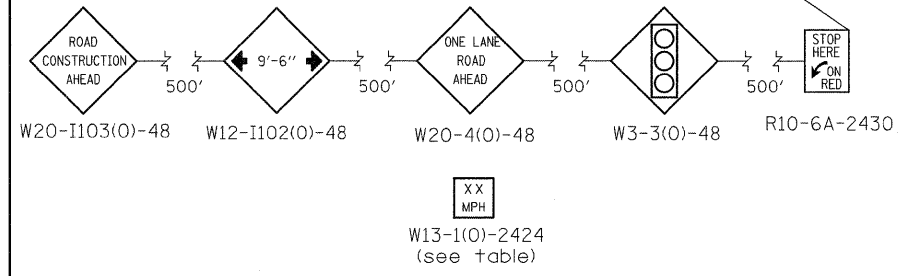
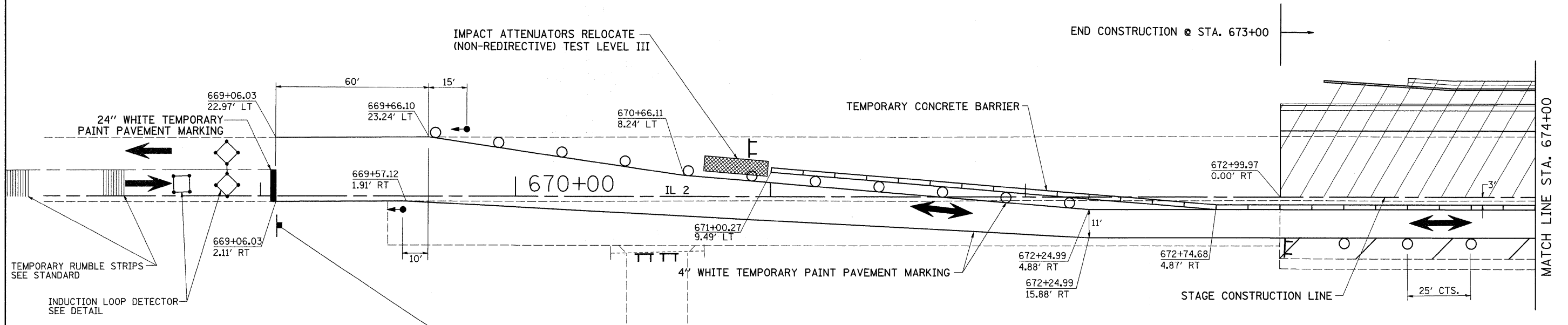

### STAGE 3 NOTES

1. USE STANDARD 701321. SEE STANDARDS FOR ADDITIONAL SIGNING AND DEVICES NOT SHOWN IN DETAILS.
2. REMOVAL OF GUARDRAIL @ LT STA. 677+34 TO 678+58.
3. CONSTRUCT UPSTREAM END OF CAST-IN-PLACE DOUBLE 7' X 3' BOX CULVERT.
4. REMOVAL OF REMAINING UPSTREAM PORTION OF EXISTING 12' X 3' BOX CULVERT.
5. CONSTRUCT SUB-BASE GRANULAR MATERIAL, TYPE A.
6. CONSTRUCT STORM SEWER, INLETS, COMBINATION CONCRETE CURB & GUTTER, RETAINING WALL AND TYPE A GUTTER.
7. CONSTRUCT PCC PAVEMENT (JOINTED) & PCC SHOULDERS.
8. CONSTRUCT TRANSITION AND BUTT JOINT FROM STA. 680+00 TO STA. 683+00.

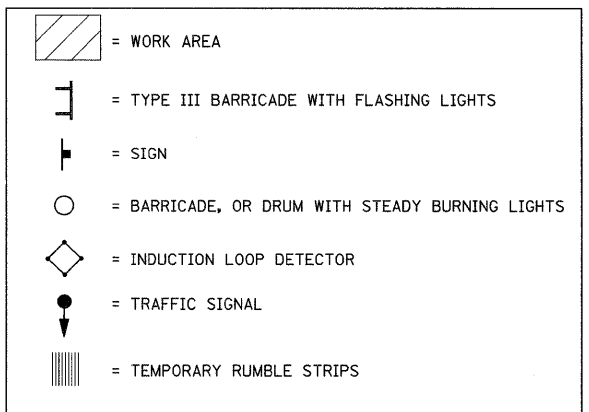

FILE NAME =	USER NAME = cushmanbw	DESIGNED -	REVISED -	<b>STATE OF ILLINOIS DEPARTMENT OF TRANSPORTATION</b>	<b>STAGE 3</b>	F.A.P. RTE. 742	SECTION 37RS-3	COUNTY OGLE	TOTAL SHEETS 345	SHEET NO. 71		
ci:\pw_work\PIWIDOT\CUSHMANBW\dms34123\6486stg69.dgn	6486stg69.dgn	DRAWN -	REVISED -			SCALE:	SHEET NO. OF SHEETS	STA. TO STA.	CONTRACT NO. 84788			
PLOT SCALE = 20,0000' / IN.		CHECKED -	REVISED -						FED. ROAD DIST. NO. [ILLINOIS] FED. AID PROJECT			
PLOT DATE = Fri May 01 07:30:19 2009		DATE -	REVISED -									