

STAGE 3

STA. 673+00 - 680+00

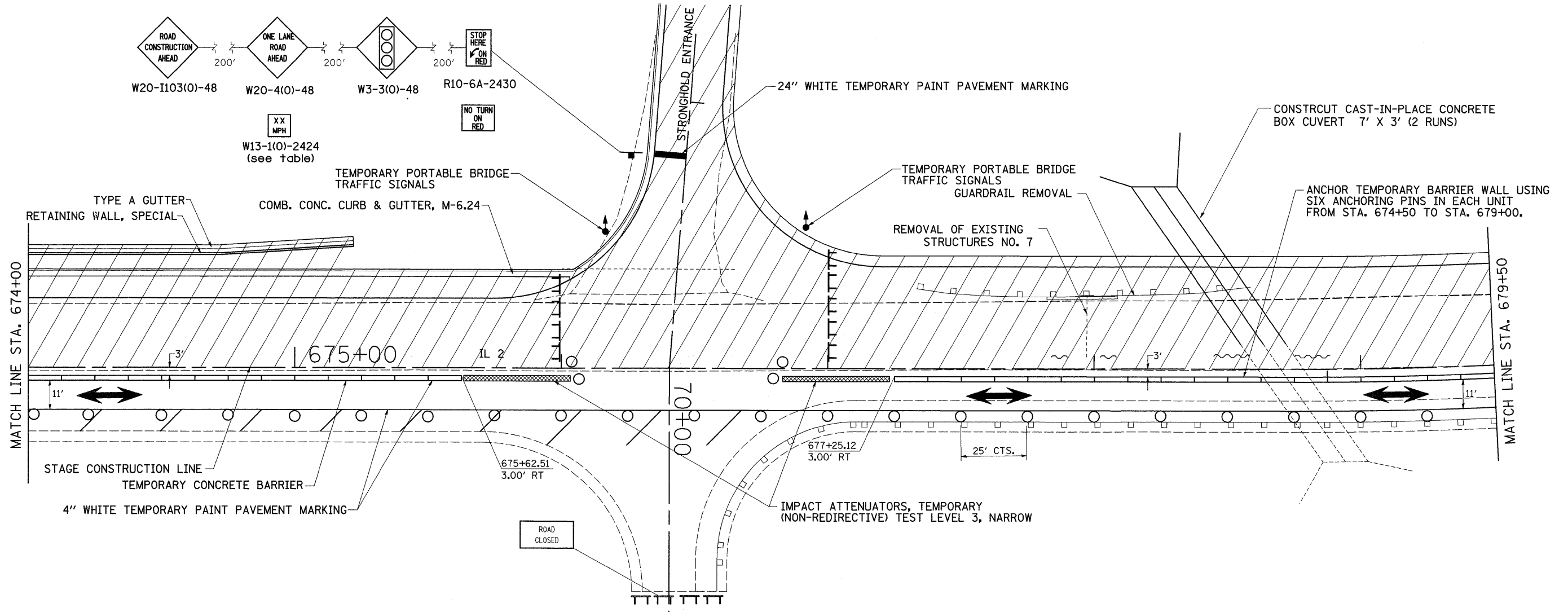

STAGE 3 NOTES

1. USE STANDARD 701321. SEE STANDARDS FOR ADDITIONAL SIGNING AND DEVICES NOT SHOWN IN DETAILS.
2. REMOVAL OF GUARDRAIL @ LT STA. 677+34 TO 678+58.
3. CONSTRUCT UPSTREAM END OF CAST-IN-PLACE DOUBLE 7' X 3' BOX CULVERT.
4. REMOVAL OF REMAINING UPSTREAM PORTION OF EXISTING 12' X 3' BOX CULVERT.
5. CONSTRUCT SUB-BASE GRANULAR MATERIAL, TYPE A.
6. CONSTRUCT STORM SEWER, INLETS, COMBINATION CONCRETE CURB & GUTTER, RETAINING WALL AND TYPE A GUTTER.
7. CONSTRUCT PCC PAVEMENT (JOINTED) & PCC SHOULDERS.
8. CONSTRUCT TRANSITION AND BUTT JOINT FROM STA. 680+00 TO STA. 683+00.

| | |
|--|---|
| | = TEMPORARY SHEET PILING |
| | = WORK AREA |
| | = TYPE III BARRICADE WITH FLASHING LIGHTS |
| | = SIGN |
| | = BARRICADE, OR DRUM WITH STEADY BURNING LIGHTS |
| | = INDUCTION LOOP DETECTOR |
| | = TRAFFIC SIGNAL |
| | = TEMPORARY RUMBLE STRIPS |

| | | | | | | | | | | | |
|--|-----------------------|------------|-----------|---|----------------|---|---------|--------|--------------|-----------|--|
| FILE NAME = | USER NAME = cushmanbw | DESIGNED - | REVISED - | STATE OF ILLINOIS DEPARTMENT OF TRANSPORTATION | STAGE 3 | F.A.P. RTE. | SECTION | COUNTY | TOTAL SHEETS | SHEET NO. | |
| ci:\pw_work\PIWIDOT\CUSHMANBW\dms34123\6486atg69.dgn | | DRAWN - | REVISED - | | | 742 | 37RS-3 | OGLE | 345 | 72 | |
| PLOT SCALE = 20,0000' / IN. | | CHECKED - | REVISED - | | | CONTRACT NO. 84788 | | | | | |
| PLOT DATE = Fri May 01 07:30:31 2009 | | DATE - | REVISED - | | | FED. ROAD DIST. NO. ILLINOIS FED. AID PROJECT | | | | | |