

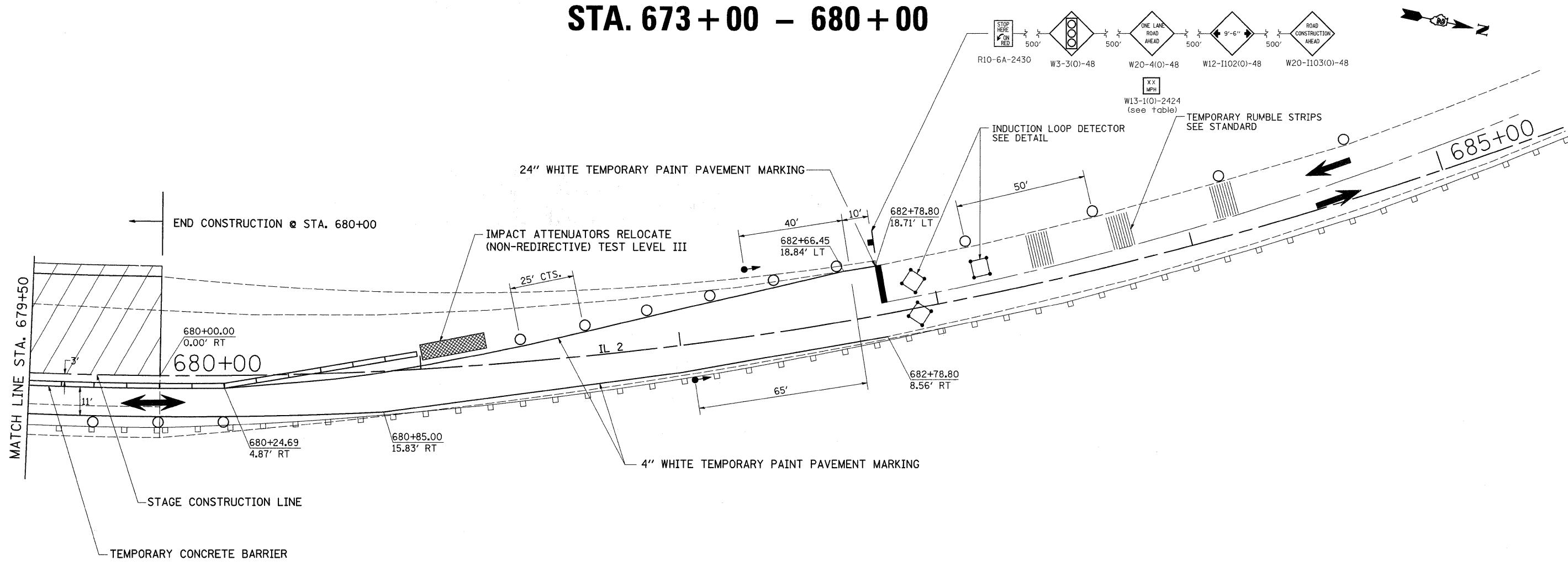





STAGE 3

STA. 673+00 - 680+00

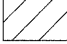

STAGE 3 NOTES

1. USE STANDARD 701321. SEE STANDARDS FOR ADDITIONAL SIGNING AND DEVICES NOT SHOWN IN DETAILS.
2. REMOVAL OF GUARDRAIL @ LT STA. 677+34 TO 678+58.
3. CONSTRUCT UPSTREAM END OF CAST-IN-PLACE DOUBLE 7' X 3' BOX CULVERT.
4. REMOVAL OF REMAINING UPSTREAM PORTION OF EXISTING 12' X 3' BOX CULVERT.
5. CONSTRUCT SUB-BASE GRANULAR MATERIAL, TYPE A.
6. CONSTRUCT STORM SEWER, INLETS, COMBINATION CONCRETE CURB & GUTTER, RETAINING WALL AND TYPE A GUTTER.
7. CONSTRUCT PCC PAVEMENT (JOINTED) & PCC SHOULDERS.
8. CONSTRUCT TRANSITION AND BUTT JOINT FROM STA. 680+00 TO STA. 683+00.

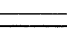
	= WORK ZONE
	= TYPE III BARRICADE WITH FLASHING LIGHTS
	= SIGN
	= BARRICADE, OR DRUM WITH STEADY BURNING LIGHTS
	= INDUCTION LOOP DETECTOR
	= TRAFFIC SIGNAL
	= TEMPORARY RUMBLE STRIPS

FILE NAME =	USER NAME = cushmanbw	DESIGNED -	REVISED -
ct:\pw_work\PIWIDOT\CUSHMANBW\dms34123\6486atg6R.dgn		DRAWN -	REVISED -
PLOT SCALE = 20.0000" / IN.		CHECKED -	REVISED -
PLOT DATE = Fri May 01 07:30:44 2009		DATE -	REVISED -

**STATE OF ILLINOIS
DEPARTMENT OF TRANSPORTATION**

STAGE 3			
SCALE:	SHEET NO. OF SHEETS	STA. TO STA.	

F.A.P. RTE. 742	SECTION 37RS-3	COUNTY OGLE	TOTAL SHEETS 345	SHEET NO. 73
CONTRACT NO. 84788				
FED. ROAD DIST. NO. ILLINOIS FED. AID PROJECT				