

STAGE 5

STA. 603+08 - 611+00

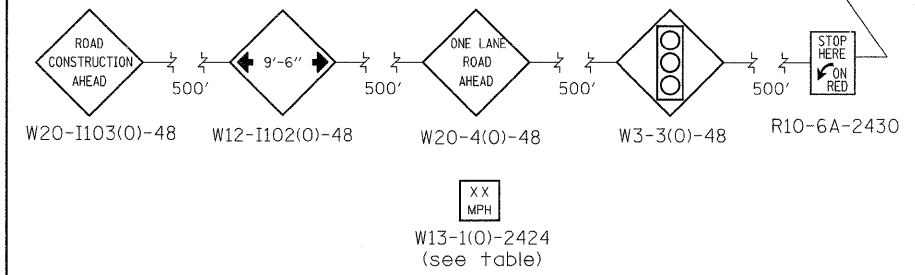
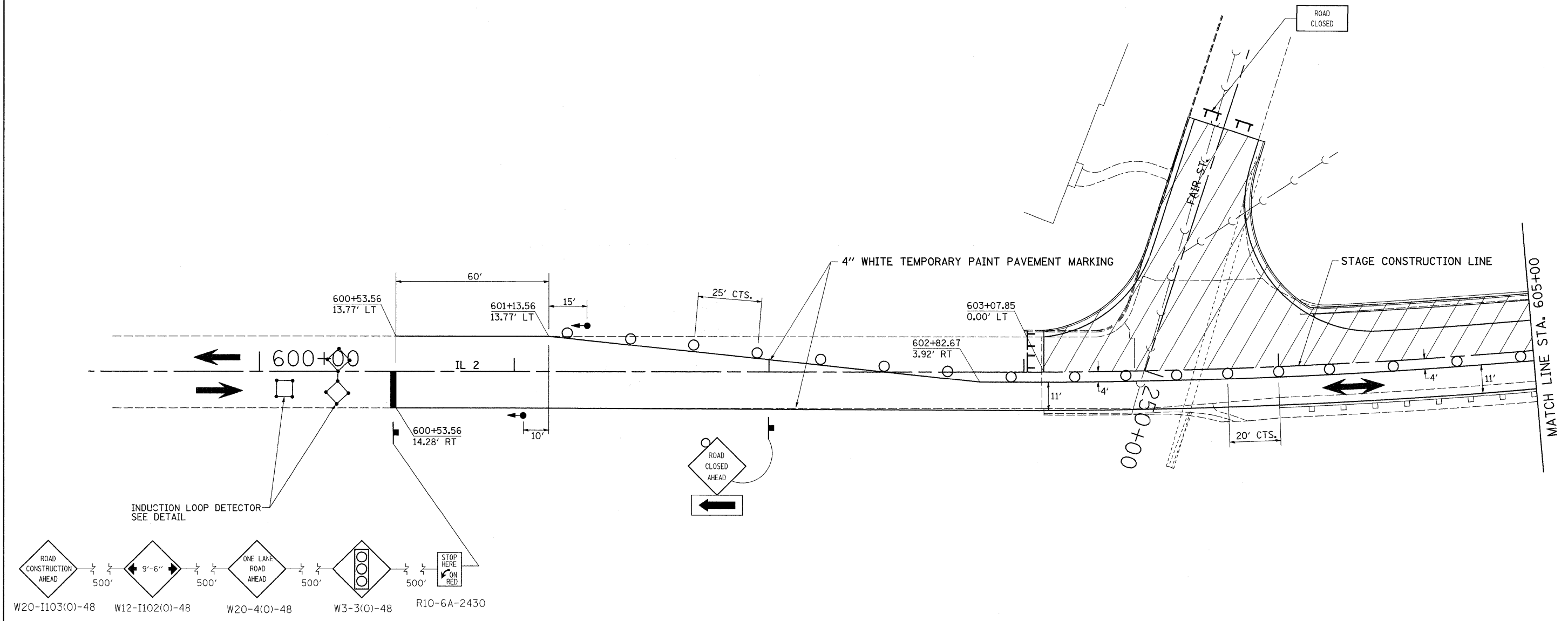

STAGE 5 NOTES

1. USE STANDARD 701316. SEE STANDARDS FOR ADDITIONAL SIGNING AND DEVICES NOT SHOWN IN DETAILS.
2. CLOSE SIDEROAD "FAIR ST."
3. REMOVAL OF EXISTING PAVEMENT FROM STA. 603+08 TO STA. 611+00 TO THE STAGE CONSTRUCTION LINE.
4. CONSTRUCT SUB-BASE GRANULAR MATERIAL, TYPE "A."
5. CONSTRUCT STORM SEWER, INLETS, AND COMBINATION CONCRETE CURB & GUTTER.
6. CONSTRUCT PCC PAVEMENT (JOINTED) & PCC SHOULDERS.

