

STAGE 5

STA. 603+08 - 611+00

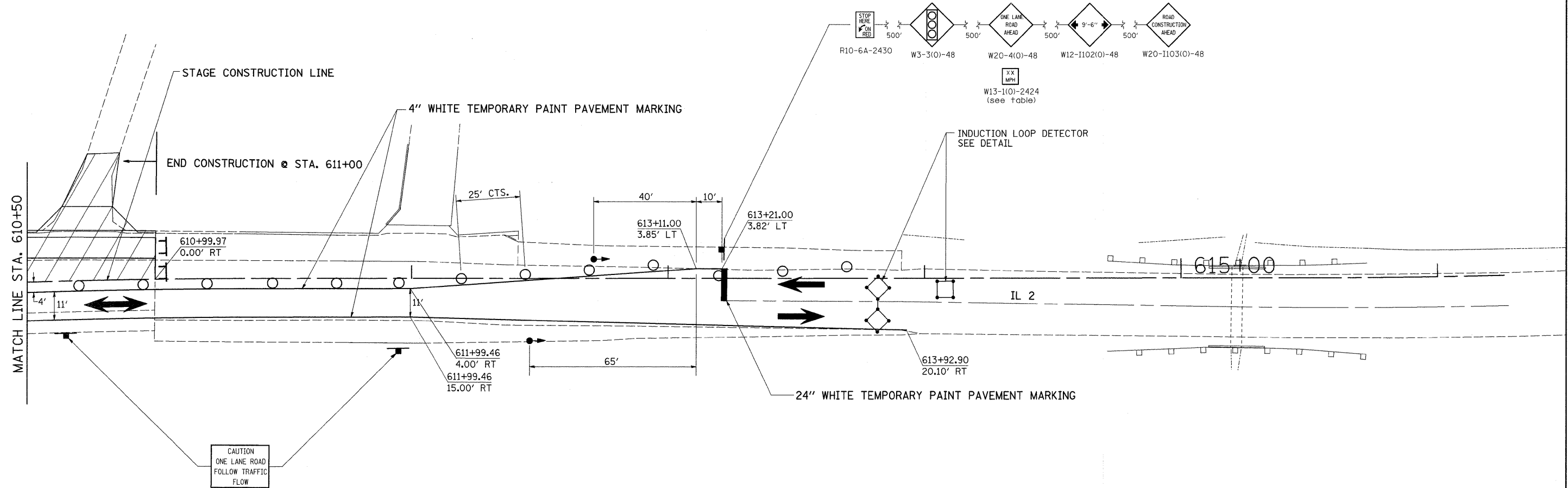

STAGE 5 NOTES

1. USE STANDARD 701316. SEE STANDARDS FOR ADDITIONAL SIGNING AND DEVICES NOT SHOWN IN DETAILS.
2. CLOSE SIDEROAD "FAIR ST."
3. REMOVAL OF EXISTING PAVEMENT FROM STA. 603+08 TO STA. 611+00 TO THE STAGE CONSTRUCTION LINE.
4. CONSTRUCT SUB-BASE GRANULAR MATERIAL, TYPE "A."
5. CONSTRUCT STORM SEWER, INLETS, AND COMBINATION CONCRETE CURB & GUTTER.
6. CONSTRUCT PCC PAVEMENT (JOINTED) & PCC SHOULDERS.

	= WORK AREA
	= TYPE III BARRICADE WITH FLASHING LIGHTS
	= SIGN
	= BARRICADE, OR DRUM WITH STEADY BURNING LIGHTS
	= INDUCTION LOOP DETECTOR
	= TRAFFIC SIGNAL

FILE NAME =	USER NAME = cushmanbw	DESIGNED -	REVISED -
c:\pw_work\PWIDOT\CUSHMANBW\dss34123\06485stg69.dgn		DRAWN -	REVISED -
	PLOT SCALE = 20.0000' / IN.	CHECKED -	REVISED -
	PLOT DATE = Fri May 01 07:32:36 2009	DATE -	REVISED -

STATE OF ILLINOIS
DEPARTMENT OF TRANSPORTATION

STAGE 5

SCALE: SHEET NO. OF SHEETS STA. TO STA.

F.A.P. RTE.	SECTION	COUNTY	TOTAL SHEETS	SHEET NO.
742	37RS-3	OGLE	345	80
CONTRACT NO. 84788				
FED. ROAD DIST. NO. ILLINOIS FED. AID PROJECT				