

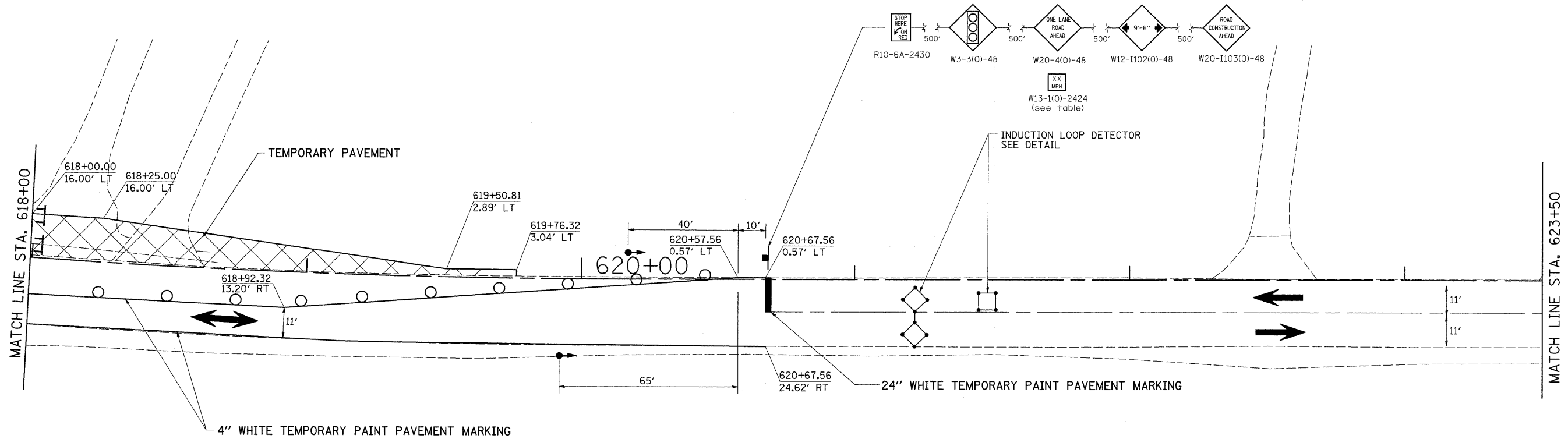





STAGE 6

STA. 611 + 00 - 618 + 00

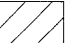

STAGE 6 NOTES

1. USE STANDARD 701321. SEE STANDARDS FOR ADDITIONAL SIGNING AND DEVICES NOT SHOWN IN DETAILS.
2. REMOVAL OF EXISTING PAVEMENT FROM STA. 611+00 TO 618+00.
3. PLACE TEMPORARY SHEET PILING.
4. REMOVAL OF UPSTREAM PORTION OF EXISTING 4' X 4' BOX CULVERT. (MAINTAIN EXISTING FLOW.)
5. CONSTRUCT UPSTREAM END OF PRECAST DOUBLE 6' X 3' BOX CULVERT AT STA. 615+22.
6. CONSTRUCT SUB-BASE GRANULAR MATERIAL TYPE A.
7. CONSTRUCT COMBINATION CONCRETE CURB & GUTTER AND CLASS SI CONCRETE (OUTLET).
8. CONSTRUCT PCC PAVEMENT (JOINTED) & PCC SHOULDERS.
9. USE STANDARD 701326 TO CONSTRUCT TEMPORARY PAVEMENT FROM STA. 618+00 TO 619+77 LT.

	= WORK AREA
	= TYPE III BARRICADE WITH FLASHING LIGHTS
	= SIGN
	= BARRICADE, OR DRUM WITH STEADY BURNING LIGHTS
	= INDUCTION LOOP DETECTOR
	= TRAFFIC SIGNAL

FILE NAME =	USER NAME = cushmanbw	DESIGNED -	REVISED -	STATE OF ILLINOIS DEPARTMENT OF TRANSPORTATION	STAGE 6	F.A.P. RTE.	SECTION	COUNTY	TOTAL SHEETS	SHEET NO.	
cd\pw_work\PWIDOT\CUSHMANBW\dms34123\dms34123.dwg	6488stg69.dgn	DRAWN -	REVISED -			742	37RS-3	OGLE	345	83	
PLOT SCALE = 28.0000' / IN.	CHECKED -	REVISED -	REVISED -			CONTRACT NO. 84788					
PLOT DATE = Fri May 01 07:33:23 2009	DATE -	REVISED -	REVISED -			FED. ROAD DIST. NO. ILLINOIS FED. AID PROJECT					