

STAGE 7

STA. 611 + 00 - 618 + 00

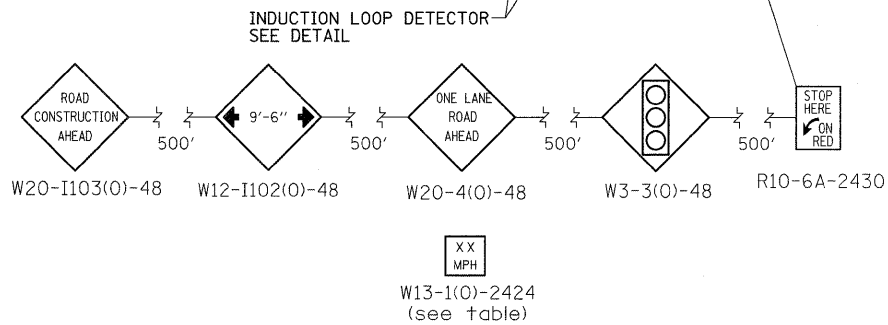
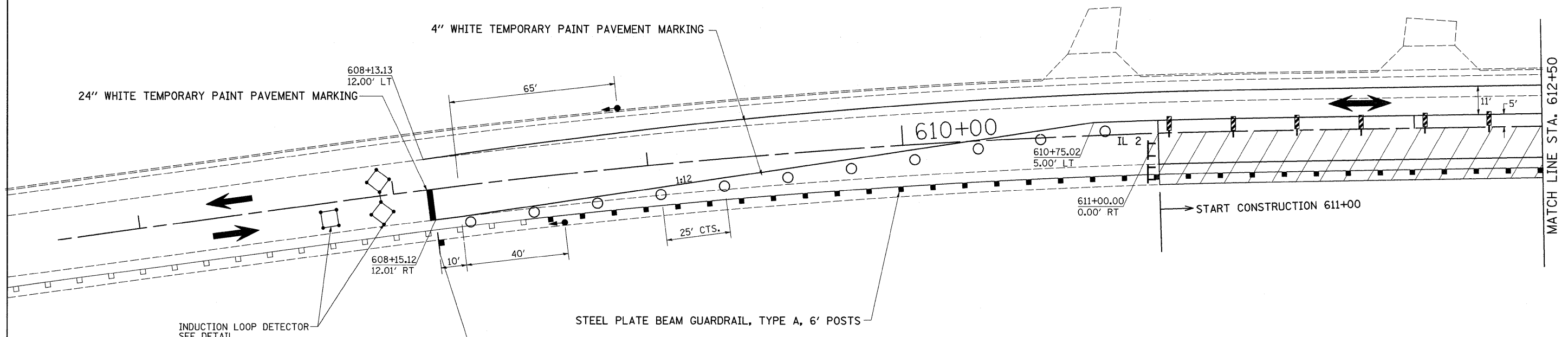

STAGE 7 NOTES

1. USE STANDARD 701321. SEE STANDARDS FOR ADDITIONAL SIGNING AND DEVICES NOT SHOWN IN DETAILS.
2. REMOVAL OF REMAINING EXISTING PAVEMENT FROM STA. 611+00 TO 618+00.
3. REMOVAL OF DOWNSTREAM PORTION OF EXISTING 4' X 4' BOX CULVERT. (MAINTAIN EXISTING FLOW.)
4. CONSTRUCT DOWNSTREAM END OF PRECAST DOUBLE 6' X 3' BOX CULVERT AT STA. 615+22.
5. CONSTRUCT SUB-BASE GRANULAR MATERIAL TYPE A.
6. CONSTRUCT PCC PAVEMENT (JOINTED) & PCC SHOULDERS.
7. INSTALL STEEL PLATE BEAM GUARDRAIL, TYPE A, 6' POSTS FROM STA. 608+50 TO 615+50.
8. RELOCATE TEMPORARY IMPACT ATTENUATOR FROM STA. 608+50 TO 615+50.
9. USE STANDARD 701326 TO CONSTRUCT TEMPORARY PAVEMENT FROM STA. 617+12 TO 618+00 RT.

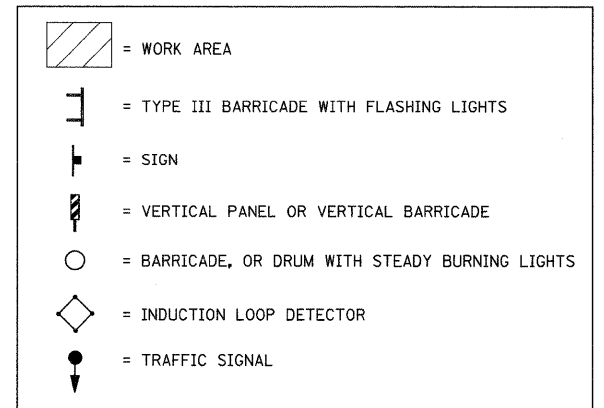

FILE NAME =	USER NAME = cushmanbw	DESIGNED -	REVISED -	STATE OF ILLINOIS DEPARTMENT OF TRANSPORTATION		STAGE 7		F.A.P. RTE.	SECTION	COUNTY	TOTAL SHEETS	SHEET NO.
ct\pw_work\VPWIDOT\CUSHMANBW\dms34123\066486stg69.dgn		DRAWN -	REVISED -					742	37RS-3	OGLE	345	84
PLOT SCALE = 20.0000' / IN.		CHECKED -	REVISED -					CONTRACT NO. 84788				
PLOT DATE = Fri May 01 07:33:53 2009		DATE -	REVISED -					FED. ROAD DIST. NO. ILLINOIS FED. AID PROJECT				
				SCALE:	SHEET NO.	OF	SHEETS	STA.	TO STA.			