

STAGE 8

STA. 618 + 00 - 628 + 29

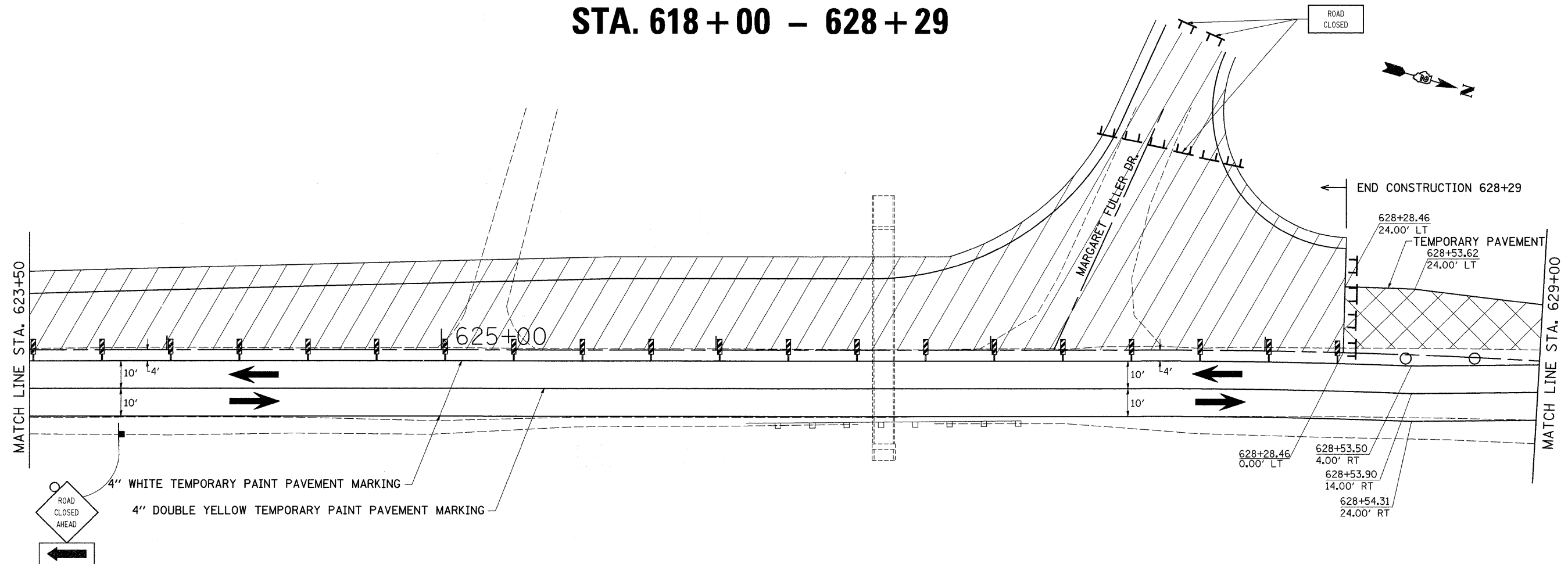

STAGE 8 NOTES

1. USE STANDARD 701331. SEE STANDARDS FOR ADDITIONAL SIGNING AND DEVICES NOT SHOWN IN DETAILS.
3. CLOSE SIDEROAD "MARGARET FULLER RD." AS SHOWN.
4. REMOVAL OF EXISTING PAVEMENT FROM STA. 618+00 - 628+29.
5. REMOVAL OF EXISTING STRUCTURE AT STA. 618+62.
6. CONSTRUCT SUB-BASE GRANULAR MATERIAL, TYPE A.
7. CONSTRUCT PCC PAVEMENT (JOINTED) & PCC SHOULDERS.
8. USE STANDARD 701326 TO CONSTRUCT TEMPORARY PAVEMENT FROM STA. 615+35 TO 621+80 AND STA. 628+29 - 630+97 LT.

	= WORK AREA
	= TYPE III BARRICADE WITH FLASHING LIGHTS
	= SIGN
	= VERTICAL PANEL OR VERTICAL BARRICADE
	= BARRICADE, OR DRUM WITH STEADY BURNING LIGHTS
	= INDUCTION LOOP DETECTOR
	= TRAFFIC SIGNAL

FILE NAME =	USER NAME = cushmanbw	DESIGNED -	REVISED -	STATE OF ILLINOIS DEPARTMENT OF TRANSPORTATION	STAGE 8	F.A.P. RTE.	SECTION	COUNTY	TOTAL SHEETS	SHEET NO.
c:\pw_work\PWIDOT\CUSHMANBW\dms34123\6486stg69.dgn	6486stg69.dgn	DRAWN -	REVISED -			742	37RS-3	OGLE	345	89
PLOT SCALE = 20.0000' / IN.	CHECKED -	REVISED -				CONTRACT NO. 84788				
PLOT DATE = Fri May 01 07:35:13 2009	DATE -	REVISED -				SCALE:	SHEET NO. OF SHEETS	STA. TO STA.	FED. ROAD DIST. NO.	ILLINOIS FED. AID PROJECT