

# STAGE 12

STA. 628+29 - 673+00

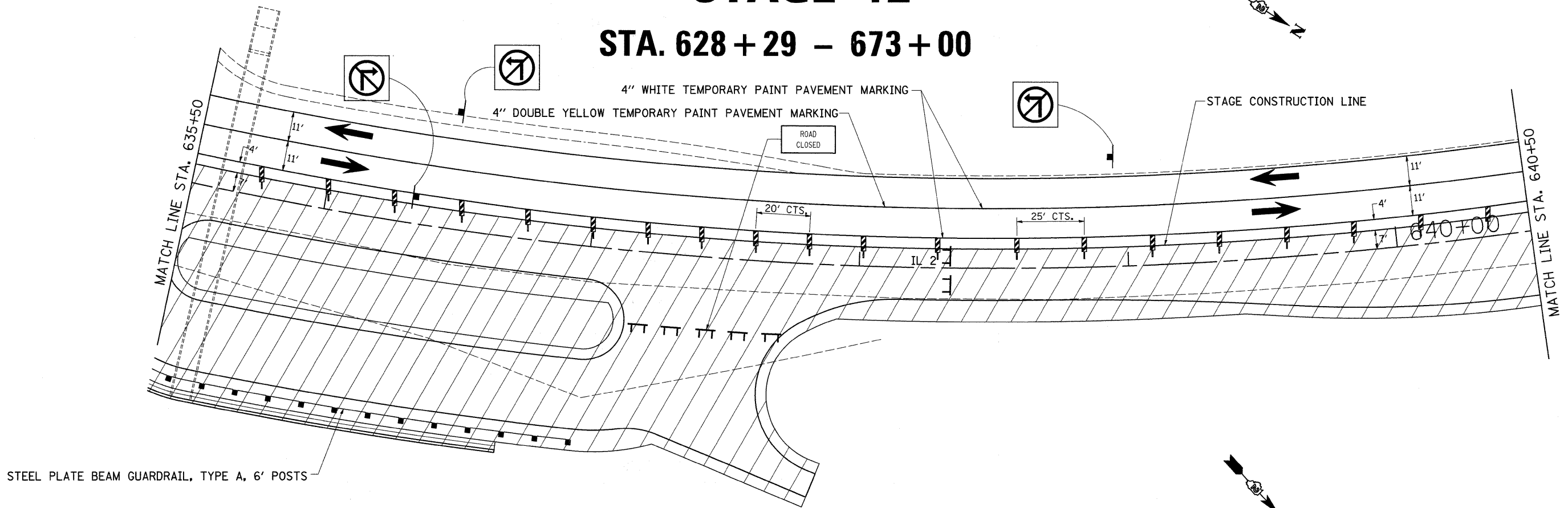

STEEL PLATE BEAM GUARDRAIL, TYPE A, 6' POSTS

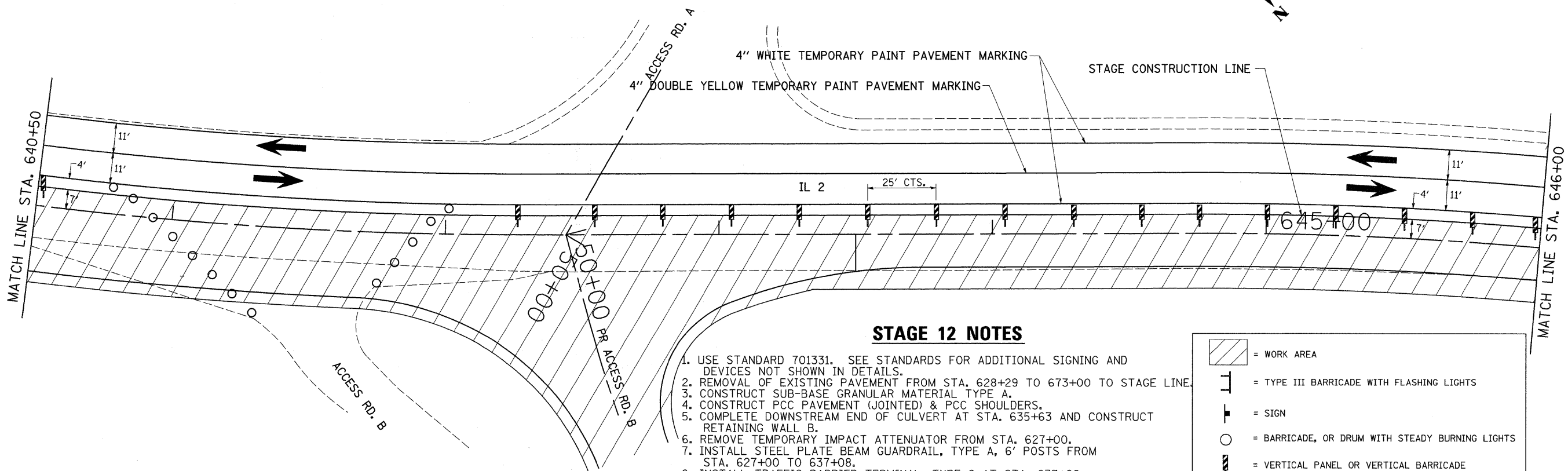

### STAGE 12 NOTES

1. USE STANDARD 701331. SEE STANDARDS FOR ADDITIONAL SIGNING AND DEVICES NOT SHOWN IN DETAILS.
2. REMOVAL OF EXISTING PAVEMENT FROM STA. 628+29 TO 673+00 TO STAGE LINE.
3. CONSTRUCT SUB-BASE GRANULAR MATERIAL TYPE A.
4. CONSTRUCT PCC PAVEMENT (JOINTED) & PCC SHOULDERS.
5. COMPLETE DOWNSTREAM END OF CULVERT AT STA. 635+63 AND CONSTRUCT RETAINING WALL B.
6. REMOVE TEMPORARY IMPACT ATTENUATOR FROM STA. 627+00.
7. INSTALL STEEL PLATE BEAM GUARDRAIL, TYPE A, 6' POSTS FROM STA. 627+00 TO 637+08.
8. INSTALL TRAFFIC BARRIER TERMINAL, TYPE 2 AT STA. 637+08.

	= WORK AREA
	= TYPE III BARRICADE WITH FLASHING LIGHTS
	= SIGN
	= BARRICADE, OR DRUM WITH STEADY BURNING LIGHTS
	= VERTICAL PANEL OR VERTICAL BARRICADE

FILE NAME =	USER NAME = cushmanbw	DESIGNED -	REVISED -
ct:\pw_work\PW\DOT\CUSHMANBW\dms34123\066486stg69.dgn		DRAWN -	REVISED -
PLOT SCALE = 20,0000' / IN.		CHECKED -	REVISED -
PLOT DATE = Fri May 01 07:38:55 2009		DATE -	REVISED -

STATE OF ILLINOIS  
DEPARTMENT OF TRANSPORTATION

## STAGE 12

SCALE: SHEET NO. OF SHEETS STA. TO STA.

F.A.P. RTE. 742	SECTION 37RS-3	COUNTY OGLE	TOTAL SHEETS 345	SHEET NO. 108
CONTRACT NO. 84788				
FED. ROAD DIST. NO. ILLINOIS FED. AID PROJECT				