

Benchmark: Cross-cut in Headwall Sta. 635+49.93, 28.32' Rt. Elev. = 680.1680  
Existing Structure: None

STATE OF ILLINOIS  
DEPARTMENT OF TRANSPORTATION

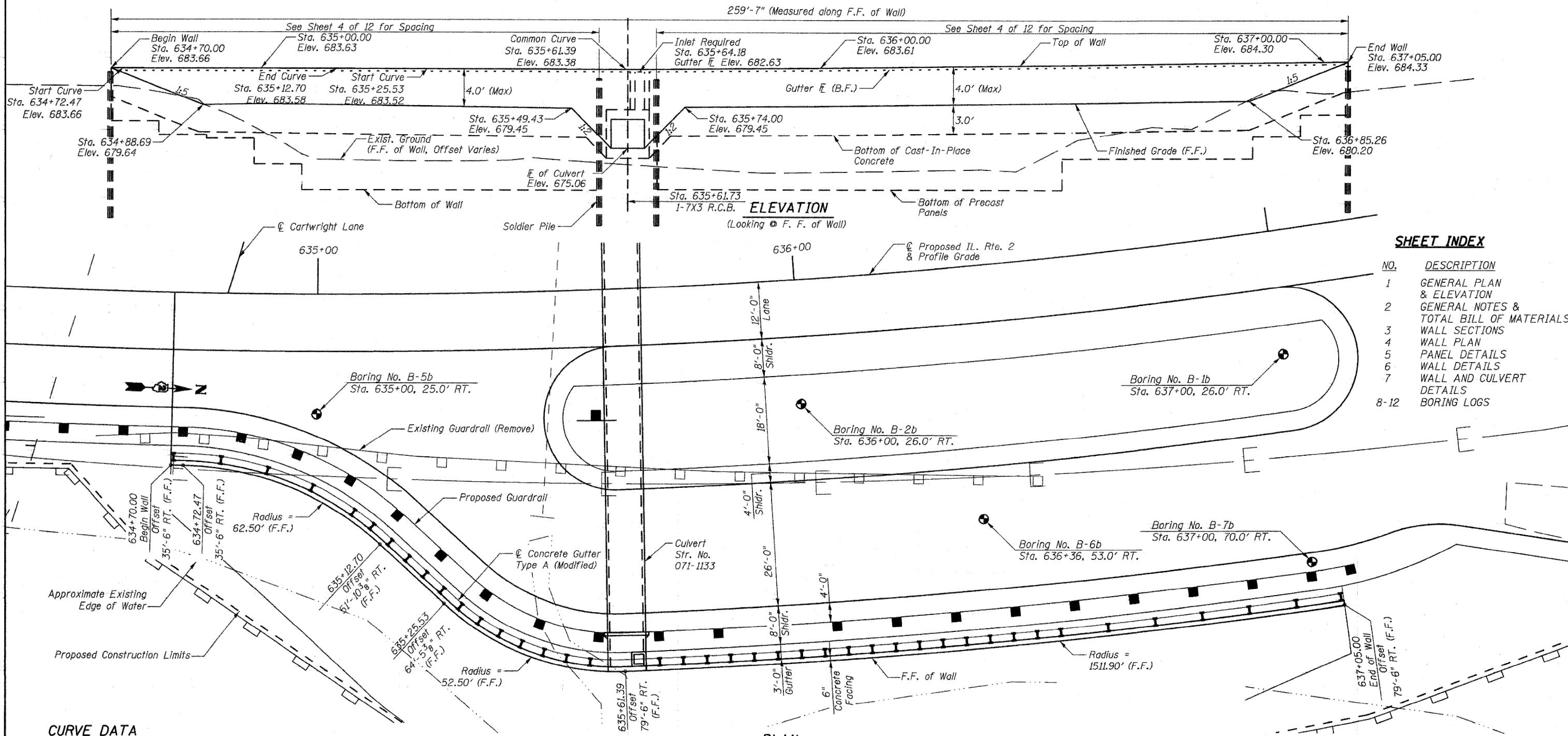

**SHEET INDEX**

NO.	DESCRIPTION
1	GENERAL PLAN & ELEVATION
2	GENERAL NOTES & TOTAL BILL OF MATERIALS
3	WALL SECTIONS
4	WALL PLAN
5	PANEL DETAILS
6	WALL DETAILS
7	WALL AND CULVERT DETAILS
8-12	BORING LOGS

**CURVE DATA**  
(IL. Rte. 2)

P.I. STA = 638+41.23  
Δ = 31° 54' 45.88" (LT.)  
D = 3° 59' 59.99"  
R = 1,432.40'  
T = 409.55'  
L = 797.82'  
E = 57.40'  
P.C. STA = 634+31.68  
P.T. STA = 642+29.50

DESIGNED	DFM
CHECKED	DSG
DRAWN	EBS
CHECKED	DFM



*David F. Maxwell*  
David F. Maxwell, S.E.  
Date: 3/25/09  
My registration expires November 30, 2010.

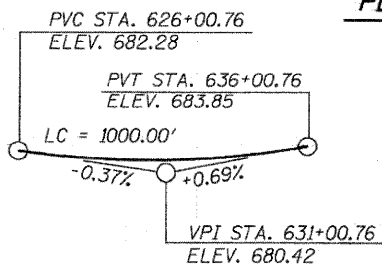

**PROFILE GRADE**  
(Along @ Proposed IL. Rte. 2)

Howard R. Green Company

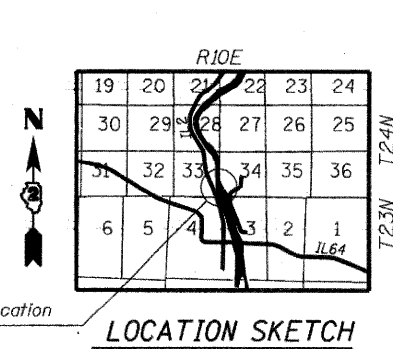

**NOTES**

Offsets are measured from the @ IL. Rte. 2 to the front face of wall.  
See Sheet 2 of 12 for General Notes & Total Bill of Materials.  
F.F. = Front Face  
B.F. = Back Face

**GENERAL PLAN & ELEVATION**  
**IL. RTE. 2**  
**RETAINING WALL B**  
**STA. 634+70.00 TO STA. 637+05.00**

SHEET NO. 1	F.A.P. RTE. 742	SECTION 37 R-3	COUNTY OGLE	TOTAL SHEETS 345	SHEET NO. 161
12 SHEETS	SN 071-7002		CONTRACT NO. 84788		
FED. ROAD DIST. NO. 7 ILLINOIS FED. AID PROJECT					