

F.A.U. RTE.	SECTION	COUNTY	TOTAL SHEETS	SHEET NO.
6093	09-00041-00-RS	LASALLE	3	1
		ILLINOIS	CONTRACT NO. 87426	

INDEX OF SHEETS

- 1.) COVER SHEET, SUMMARY OF QUANTITIES
- 2.) PLAN SHEET
- 3.) PLAN SHEET, TYPICAL SECTION

STANDARDS

TRAFFIC CONTROL AND PROTECTION, STANDARD 701306
 STANDARD SYMBOLS, ABBREVIATIONS AND PATTERNS, STANDARD 000001-05
 HMA SHLD. STRIPS/SHLDS. WITH RESURFACING OR WIDENING AND RESURFACING PROJECTS, STANDARD 482011-03
 LANE CLOSURE, 2L, 2W, SLOW MOVING OPERATIONS DAY ONLY, FOR SPEEDS > 45 MPH, STANDARD 701306-02
 TRAFFIC CONTROL DEVICES, STANDARD 701901-01
 TYPICAL PAVEMENT MARKINGS, STANDARD 780001-02

SUMMARY OF QUANTITIES

1 000

PAY ITEM NO.	PAY ITEM	QTY.	UNIT
40600982	HOT MIX ASPHALT SURFACE REMOVAL-BUTT JOINT	317	SY
78300200	RAISED REFLECTIVE PAVEMENT MARKER REMOVAL	80	EA
70300100	SHORT-TERM PAVEMENT MARKING	250	FT
78300105	PAVEMENT MARKING REMOVAL	250	FT
67100100	MOBILIZATION	1	L SUM
40600100	BITUMINOUS MATERIALS (PRIME COAT)	1000	GAL
40600300	AGGREGATE (PRIME COAT)	10	TON
40600625	LEVELING BINDER (MACHINE METHOD), N50	600	TON
40603310	HOT-MIX ASPHALT SURFACE COURSE, MIX "C", N50	1000	TON
48203100	HOT-MIX ASPHALT SHOULDER	200	TON
48102100	AGGREGATE WEDGE SHOULDER, TYPE B	250	TON
* 78000200	THERMOPLASTIC PAVEMENT MARKING-LINE 4"	9000	FT
* 78000500	THERMOPLASTIC PAVEMENT MARKING-LINE 8"	800	FT
* 78000600	THERMOPLASTIC PAVEMENT MARKING-LINE 12"	500	FT
* 78000650	THERMOPLASTIC PAVEMENT MARKING-LINE 24"	100	FT
* 78000100	THERMOPLASTIC PAVEMENT MARK-LETTERS & SYMBOLS	90	SF
70100460	TRAFFIC CONTROL AND PROTECTION, STANDARD 701306	1	L SUM

* SPECIALTY ITEMS

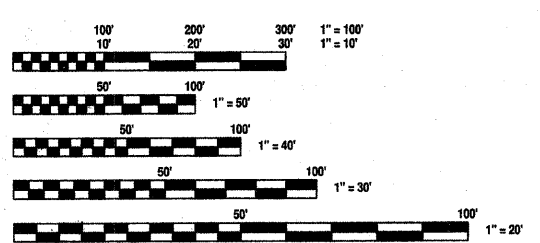

FULL SIZE PLANS HAVE BEEN PREPARED USING STANDARD ENGINEERING SCALES. REDUCED SIZED PLANS WILL NOT CONFORM TO STANDARD SCALES. IN MAKING MEASUREMENTS ON REDUCED PLANS, THE ABOVE SCALES MAY BE USED.

J.U.L.I.E.
 JOINT UTILITY LOCATION INFORMATION FOR EXCAVATION
 1-800-892-0123
 OR 811

CONTRACT NO. 87426

STATE OF ILLINOIS
 DEPARTMENT OF TRANSPORTATION
 DIVISION OF HIGHWAYS

**PROPOSED
 HIGHWAY PLANS**
AMERICAN RECOVERY AND REINVESTMENT ACT

F.A.U. ROUTE 6093
 SECTION 09-00041-00-RS
 PROJECT ARA-5036(025)
 LA SALLE COUNTY
 C-93-155-09
 CITY OF OGLESBY

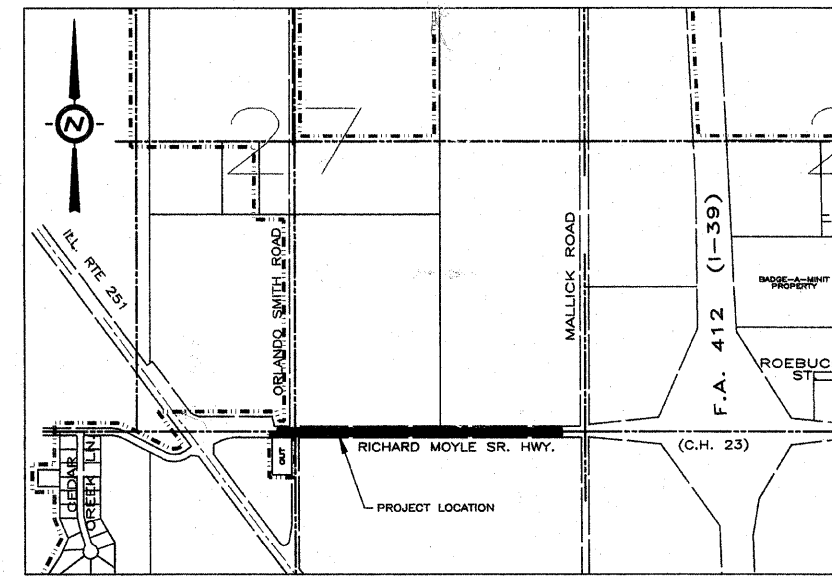
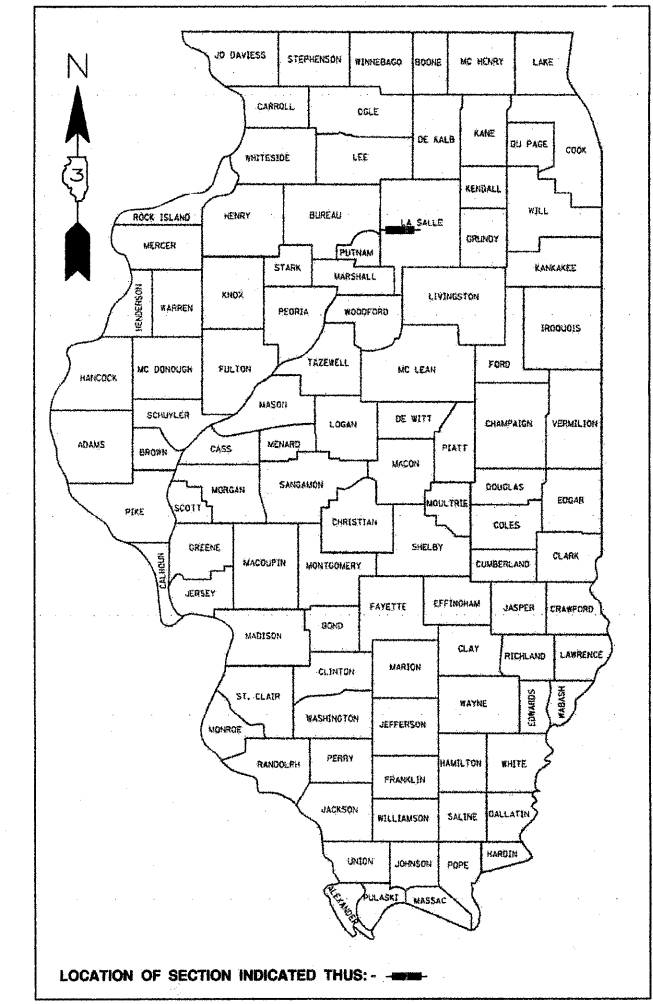

LOCATION MAP
 NOT TO SCALE

GROSS LENGTH = 2522 FT. = 0.48 MILE
 NET LENGTH = 2522 FT. = 0.48 MILE

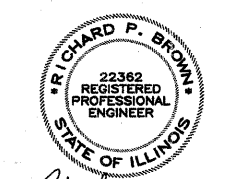

Richard P. Brown
 11/30/2009
 5/14/2009

FUNCTIONAL CLASSIFICATION
 URBAN COLLECTOR
 ADT = 6100
 LAPP DESIGN POLICY: CATEGORICAL EXCLUSION

STATE OF ILLINOIS
 DEPARTMENT OF TRANSPORTATION
 DIVISION OF HIGHWAYS

APPROVED 5/15 2009
Anthony Davis
 LOCAL AGENCY REPRESENTATIVE

PASSED 5-26 2009
Harold L. Long
 DISTRICT 3 ENGINEER OF LOCAL ROADS AND STREETS

RELEASING FOR BID BASED ON LIMITED REVIEW 5-26 2009
George E. Ryan
 DEPUTY DIRECTOR OF HIGHWAYS / REGION 2 ENGINEER

**PRINTED BY THE AUTHORITY
 OF THE STATE OF ILLINOIS**

ILLINOIS ROUTE 251

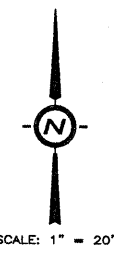
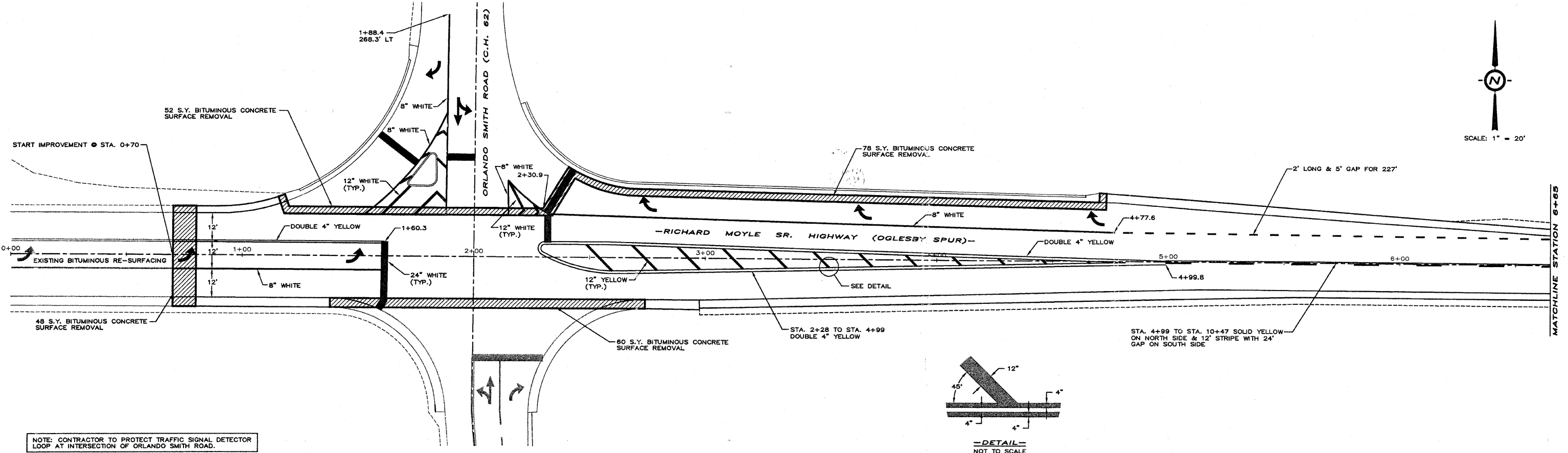

NOTE: CONTRACTOR TO PROTECT TRAFFIC SIGNAL DETECTOR LOOP AT INTERSECTION OF ORLANDO SMITH ROAD.

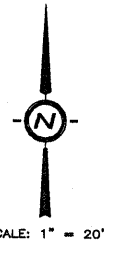
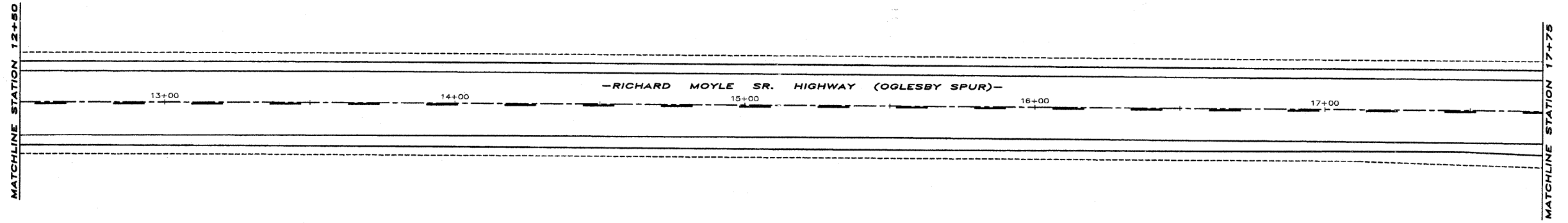
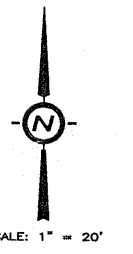
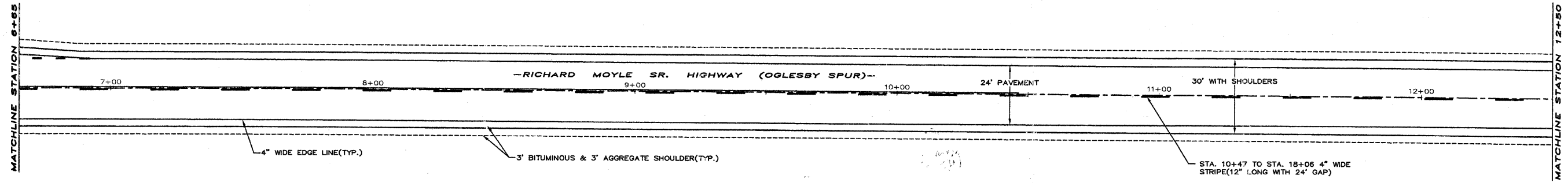

DRAWN BY: D.E.Z.
DESIGNED BY: R.P.B.
HORIZONTAL SCALE: 1" = 20'
VERTICAL SCALE: N.A.

RICHARD MOYLE SR. HIGHWAY
(FAU RT. 6093) IMPROVEMENTS
CITY OF OGLESBY, ILLINOIS

PLAN VIEW
STATIONS: 0+00 - 17+75



ADVANCED ENGINEERING ASSOCIATES INC.
1714 FOURTH STREET
PERU, ILLINOIS 61354
E-MAIL ADDRESS: AEA@AENG1.COM

DATE: 5/15/09
SHEET: 2 OF: 3
AutoCAD DRAWING: OGLE0803.DWG
PROJECT NO.: OGLE0803

CONTRACT 87426

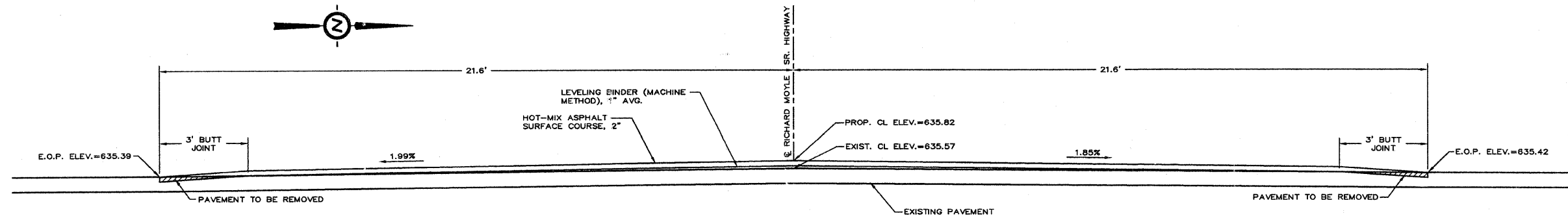
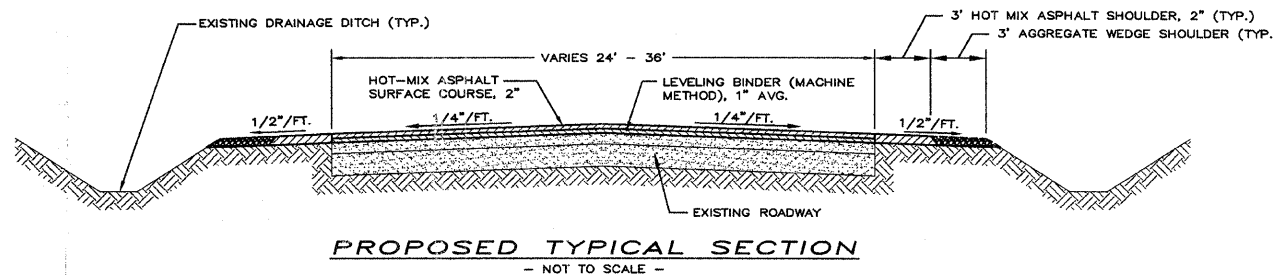
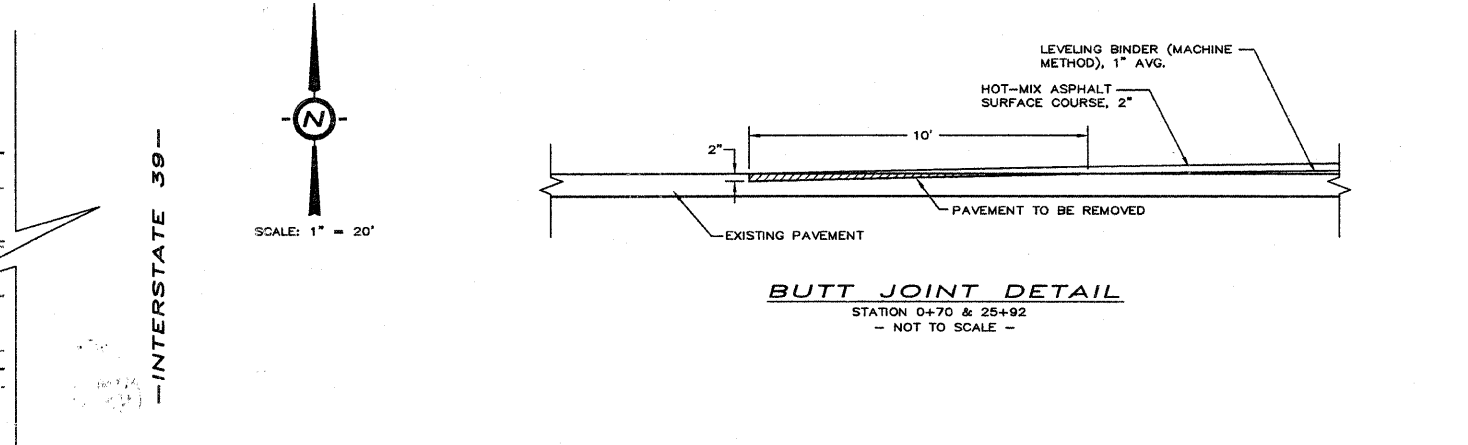
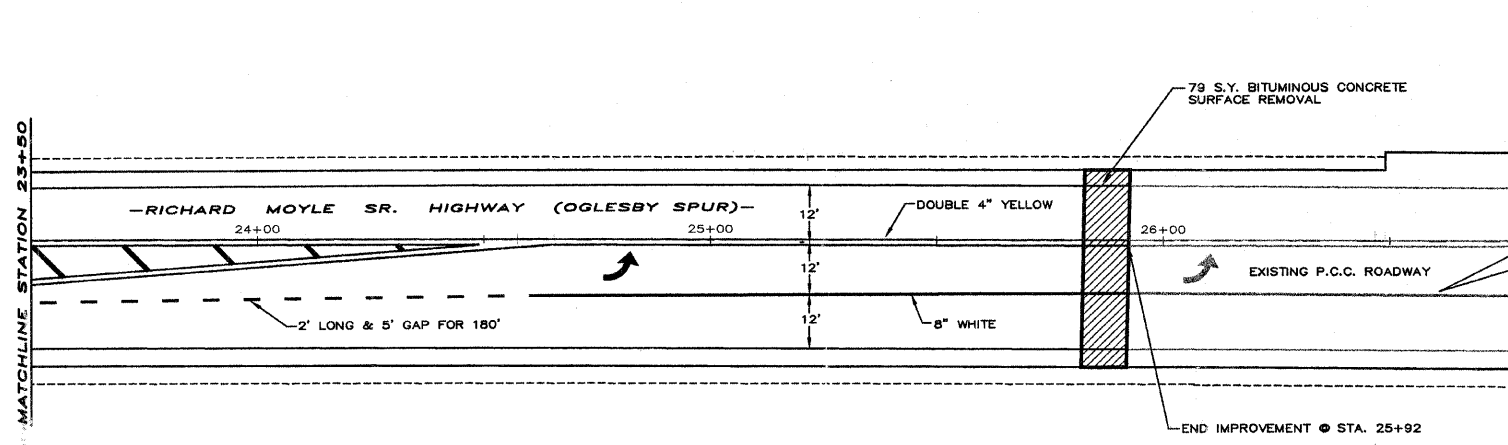
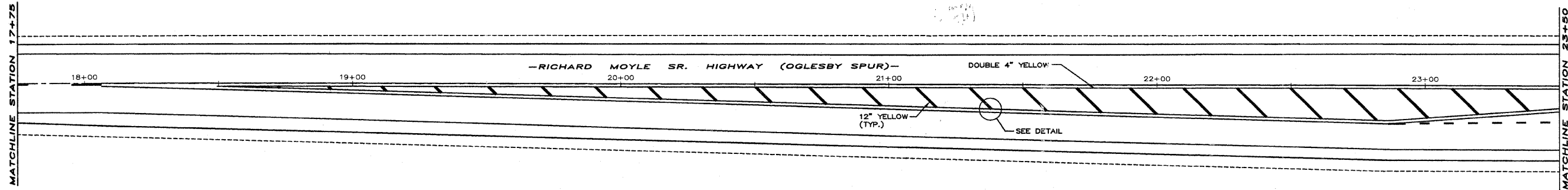

CROSS SECTION AT ORLANDO SMITH ROAD
- NOT TO SCALE -

DRAWN BY: D.E.Z.	HORIZONTAL SCALE: 1" = 20'
DESIGNED BY: R.P.B.	VERTICAL SCALE: N.A.

RICHARD MOYLE SR. HIGHWAY
(FAU RT. 6093) IMPROVEMENTS
CITY OF OGLESBY, ILLINOIS

PLAN VIEW
STATIONS: 17+75 - 25+92

CONTRACT 87426

AEA ADVANCED ENGINEERING ASSOCIATES INC.
1714 FOURTH STREET PERU, ILLINOIS 61354
E-MAIL ADDRESS: AEA@AENET.COM

DATE: 5/15/09	SHEET: 3 OF: 3
AutoCAD DRAWING: OGLE0803.DWG	
PROJECT NO.: OGLE0803	