

DATE: \_\_\_\_\_  
 BT  
 SURVEYED \_\_\_\_\_  
 PLOTTED \_\_\_\_\_  
 NOTE BOOK \_\_\_\_\_  
 AREAS CHECKED \_\_\_\_\_  
 NO. \_\_\_\_\_

DATE: \_\_\_\_\_  
 BT  
 SURVEYED \_\_\_\_\_  
 PLOTTED \_\_\_\_\_  
 NOTE BOOK \_\_\_\_\_  
 AREAS CHECKED \_\_\_\_\_  
 NO. \_\_\_\_\_

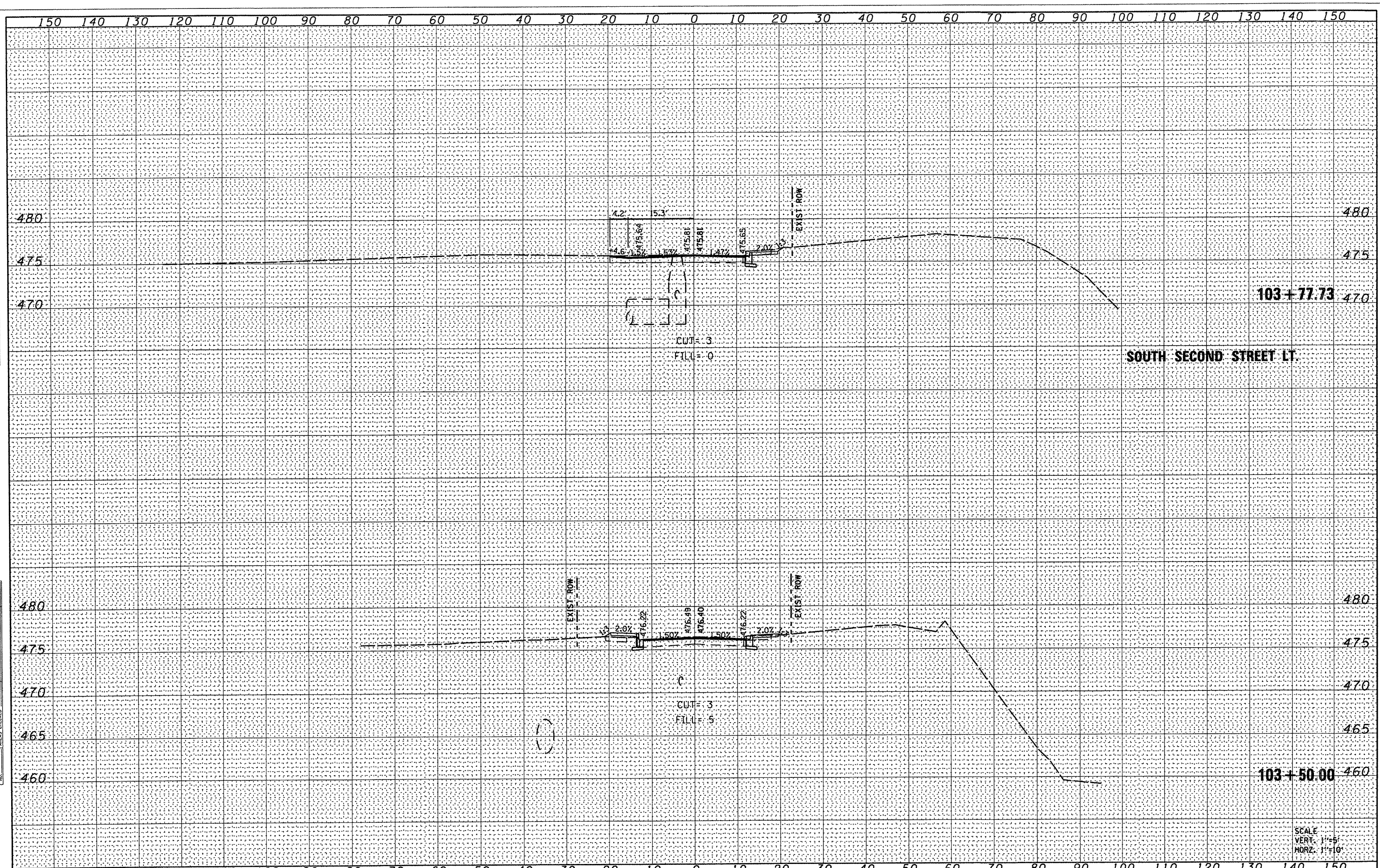

**SOUTH SECOND STREET LT.**

**103+77.73**

**103+50.00**

SCALE  
 VERT. 1"=5'  
 HORZ. 1"=10'

FILE NAME =	USER NAME = moisiegraser	DESIGNED -	REVISED -	<b>STATE OF ILLINOIS DEPARTMENT OF TRANSPORTATION</b>	<b>CROSS SECTIONS</b>			F.A.U. RTE. 9274	SECTION 04-00202-00-BR	COUNTY ST. CLAIR	TOTAL SHEETS 55	SHEET NO. 54
H:\VP\27055\MicroStation\8\CADD Sheets\27055-sh1-xsc.dgn		DRAWN -	REVISED -		SCALE: _____	SHEET NO. _____	OF _____	SHEETS _____	STA. 103+50.00 TO STA. 103+77.73	FED. ROAD DIST. NO. 7 ILLINOIS FED. AID PROJECT	CONTRACT NO. 97369	
PLOT SCALE = 20.0000' / IN.		CHECKED -	REVISED -									
PLOT DATE = 3/13/2009		DATE -	REVISED -									