

GENERAL NOTES:

THIS SECTION SHALL BE CONSTRUCTED IN ACCORDANCE WITH THE PLANS, SPECIAL PROVISIONS AND "STANDARD SPECIFICATIONS FOR ROAD AND BRIDGE CONSTRUCTION", ADOPTED JANUARY 1, 2007.

THE WORK INVOLVED ON THIS SECTION CONSISTS OF THE REMOVAL OF THE EXISTING STRUCTURE, THE CONSTRUCTION OF A 57 FOOT LONG SINGLE SPAN PRECAST, PRESTRESSED CONCRETE DECK BEAM BRIDGE, EARTH APPROACHES, AGGREGATE SURFACE COURSE AND OTHER MISCELLANEOUS ITEMS NECESSARY TO COMPLETE THIS SECTION.

ALL ELEVATIONS ARE BASED ON U.S.G.S. MEAN SEA LEVEL DATUM.

IT SHALL BE THE CONTRACTOR'S RESPONSIBILITY TO CONTACT ALL THE UTILITIES, AFFECTING THE PROJECT, PRIOR TO CONSTRUCTION.

NOTE: CONSTRUCTION TRANSITIONS
 STA. 2+25 TO STA 2+75
 STA 7+50 TO STA 8+00
 ALL QUANTITIES ARE INCLUDED IN THE PROPOSAL

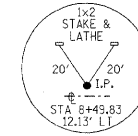
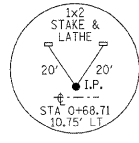

TYPICAL CROSS SECTION PROPOSED

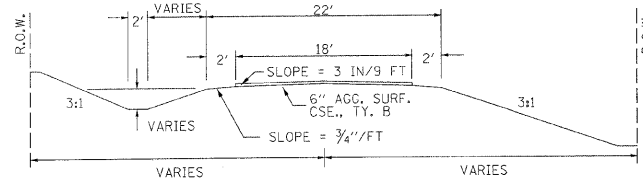

TYPICAL CROSS SECTION EXISTING

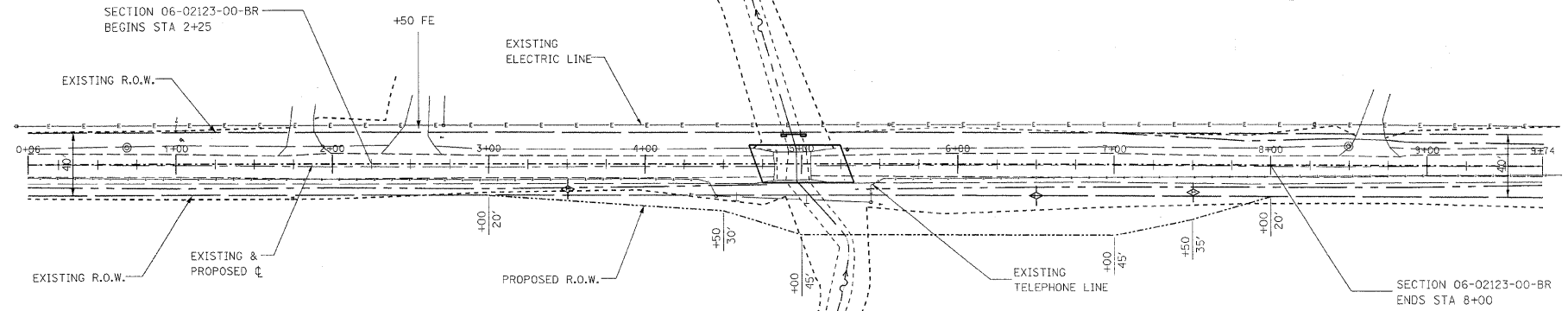
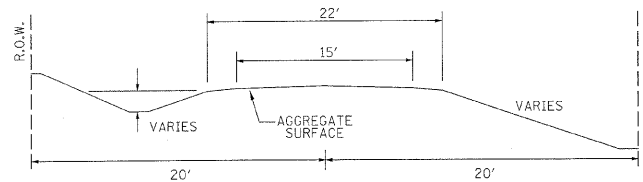

UTILITIES:
 J.U.L.I.E. 1-800-892-0123
 WAYNE-WHITE ELECTRIC CO-OP
 1-618-842-2196
 VERIZON
 1-618-997-0707

EXISTING BRIDGE STA 4+94.2; STRUCTURE NUMBER: 097-3096
 A 24' LONG SINGLE SPAN BRIDGE WITH 18" THICK PRECAST CONCRETE DECK BEAMS AND 9" CURB ON WOOD PILING AND WOODEN WINGWALLS & WOOD MUDWALLS. THERE IS ADDITIONAL CONCRETE UNDER THE STRUCTURAL THAT SHALL BE REMOVED ALONG WITH THE STRUCTURE.

ONE (1) EACH-REMOVAL OF EXISTING STRUCTURES ALLOWED IN THIS PROPOSAL.

PROPOSED STRUCTURE: NO. 097-3255, STA 5+00, A 57' LONG SINGLE SPAN P.P.C.D.B. BRIDGE WITH 21" DEPTH BEAMS, SPILL THROUGH TYPE ABUTMENTS, 24' WIDTH, 20" RT. FWD. SKEW.

SEE SHEETS 5-12 FOR THE DESIGN AND BILL OF MATERIALS.

FIELD ENTRANCE DETAIL

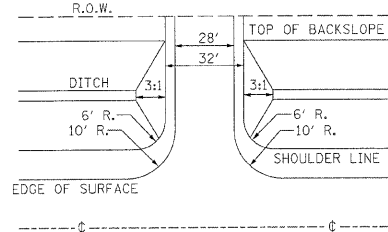

NOTE: CONSTRUCT SPECIAL DITCH
 STA 2+50 TO STA 4+73.5 RT
 STA 5+26.5 TO STA 8+00 RT
 NOTE: CONSTRUCT STONE RIPRAP DITCH
 STA 4+50 TO STA 4+73.5 RT (0.62 TON/LIN FT)
 STA 5+26.5 TO STA 5+50 RT (0.62 TON/LIN FT)
 29 TON STONE RIPRAP DITCH ALLOWED IN PROPOSAL.
 SEE STONE RIPRAP DITCH DETAIL.

STONE RIPRAP DITCH DESIGN

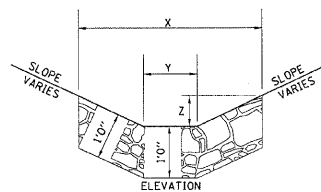
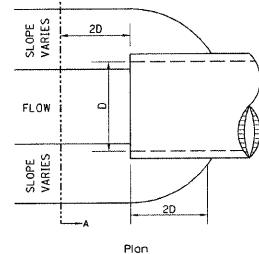

NOTE:

BOTTOM OF DITCH	SLOPE		
	1 1/2:1	2:1	3:1
2 FT	X = 5 FT	6 FT	8 FT
	Y = 2 FT	2 FT	2 FT
	Z = 1 FT	1 FT	1 FT
	0.40	0.48	0.62
	TON/LIN. FT		

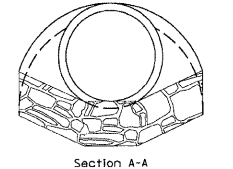

NOTE: FOR PLACEMENT, QUALITY GRADATION AND OTHER MISCELLANEOUS REQUIREMENTS FOR STONE RIPRAP DITCH-SEE SPECIAL PROVISIONS.

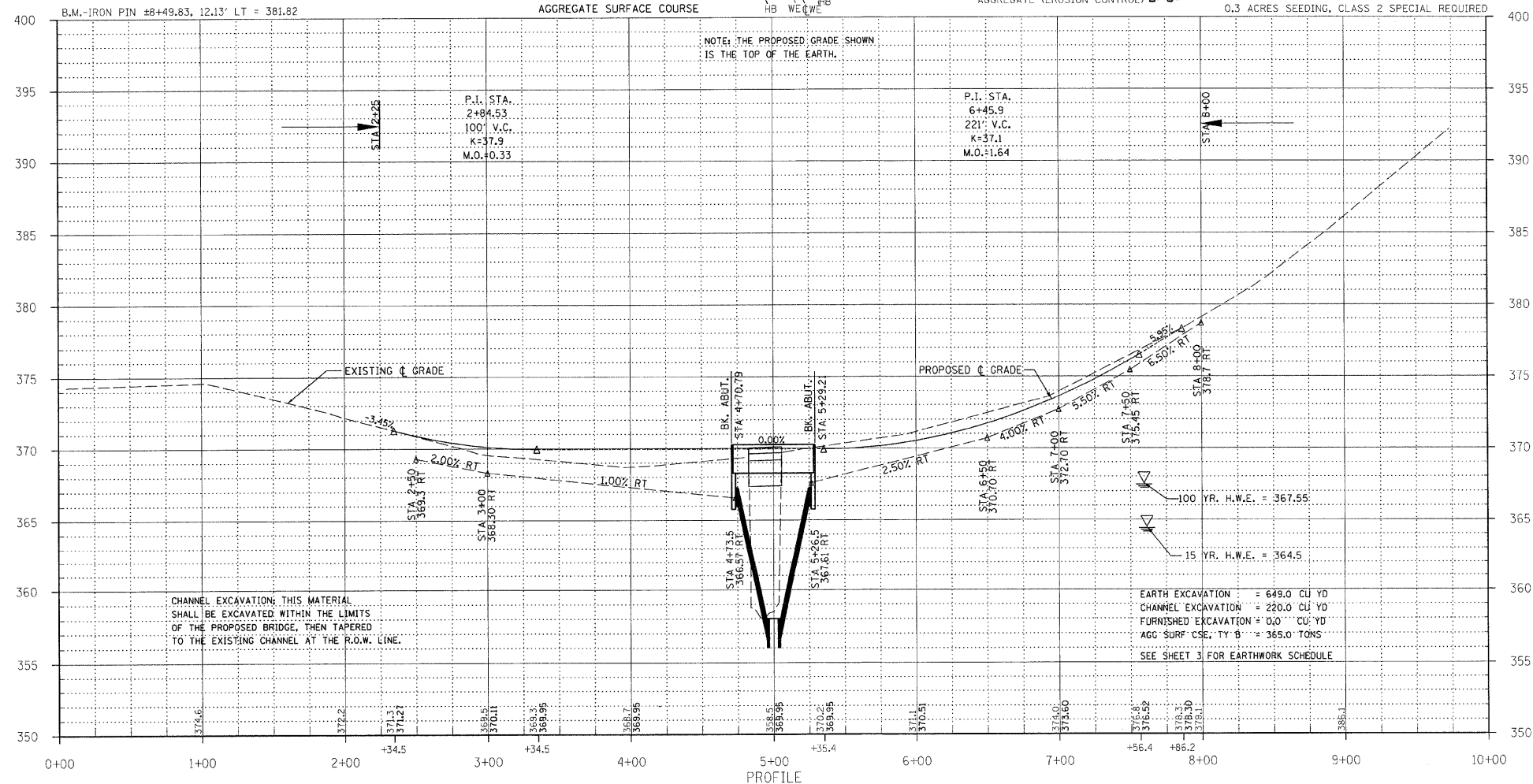

TEMPORARY DITCH CHECKS
 AGGREGATE (EROSION CONTROL)
 0.1 TREE REMOVAL, ACRES
 3.0 EACH TEMPORARY DITCH CHECKS
 12.0 TON AGGREGATE (EROSION CONTROL)
 0.3 ACRES SEEDING, CLASS 2 SPECIAL REQUIRED

TR	SECTION	COUNTY	TOTAL SHEETS	SHEET NO.
237	06-02123-00-BR	WHITE	12	2
FED. ROAD DIST. NO. 9 ILLINOIS LITTLE WABASH TRIB				
PROJECT # BROS-193129 CONTRACT # 93364				
LEC JOB # H081013MH				

323 W. 3RD ST.
 P.O. BOX 160
 MT. CARMEL, IL 62863
 PHONE: (618)-262-8651
 FAX: (618)-263-3327

405 W. STATE ST.
 SUITE 1
 PRINCETON, IN 47670
 PHONE: (812)-386-7611
 FAX: (812)-385-2812



PROFESSIONAL DESIGN FIRM
 LAND SURVEY & PROFESSIONAL ENGINEERING CORPORATION
 184-00887
 (62-032435)(35-002769)



AARON M. MEFFORD
 NAME
 Signature
 SIGNATURE
 DATE: 6/4/09
 11-30-09 EXPIRES

TOWNSHIP ROUTE 237
 OVER LITTLE WABASH TRIBUTARY
 WHITE COUNTY, ILLINOIS

SHEET TITLE:
 PLAN & PROFILE

SCALE: VARIES
 BY: AMM
 DATE: 4/2009
 REV:

2 OF 12 SHEETS
 SHEET NO. 2