

STATE OF ILLINOIS
DEPARTMENT OF TRANSPORTATION
DIVISION OF HIGHWAYS
PROPOSED
HIGHWAY PLANS

F.A.P. RTE.	SECTION	COUNTY	TOTAL SHEETS	SHEET NO.
615	(116)RS-7	BUREAU	18	1
		ILLINOIS	CONTRACT NO. 66D66	

- INDEX OF SHEETS:**
- 1 COVER SHEET
 - 2 GENERAL NOTES
 - 3-6 SUMMARY OF QUANTITIES
 - 7-8 TYPICAL SECTIONS
 - 9-10 SCHEDULES
 - 11-12 PLAN SHEETS / PAVEMENT MARKINGS
 - 13 PROPOSED DETECTOR LOOPS / WIRELESS VEHICLE DETECTION SENSORS
 - 14 DETECTOR LOOP PHASING AT BACKBONE ROAD
 - 15 EXISTING DETECTOR LOOPS AT BACKBONE ROAD
 - 16-18 DETAILS

- HIGHWAY STANDARDS:**
- 000001-06 STANDARD SYMBOLS, ABBREVIATIONS AND PATTERNS
 - 001006 DECIMAL OF AN INCH AND OF A FOOT
 - 442201-03 CLASS C AND D PATCHES
 - 701001-02 OFF-ROAD OPERATIONS 2L, 2W, MORE THAN 15' (4.5 m) AWAY
 - 701006-05 OFF-ROAD OPERATIONS 2L, 2W, 15' (4.5 m) TO 24" (600 mm) FROM PAVEMENT EDGE
 - 701011-04 OFF-ROAD MOVING OPERATIONS 2L, 2W, DAY ONLY
 - 701311-03 LANE CLOSURE, 2L, 2W, MOVING OPERATIONS - DAY ONLY
 - 701501-06 URBAN LANE CLOSURE, 2L, 2W, UNDIVIDED
 - 701502-06 URBAN LANE CLOSURE 2L, 2W, WITH BIDIRECTIONAL LEFT TURN LANE
 - 701701-09 URBAN LANE CLOSURE, MULTILANE INTERSECTION
 - 701901-04 TRAFFIC CONTROL DEVICES
 - 780001-05 TYPICAL PAVEMENT MARKINGS
 - 781001-03 TYPICAL APPLICATIONS RAISED REFLECTIVE PAVEMENT MARKERS
 - 782001 PRISMATIC CURB REFLECTORS
 - 886001-01 DETECTOR LOOP INSTALLATIONS
 - 886006-01 TYPICAL LAYOUT FOR DETECTION LOOPS

FAP ROUTE 615 (IL 26)
SECTION (116)RS-7
PROJECT: ACNHPP-0615 (006)
3P RESURFACING
BUREAU COUNTY

C-93-088-14



LOCATION OF SECTION INDICATED THUS: - ■ -

FUNCTIONAL CLASSIFICATION
RURAL OTHER ARTERIAL
 2014 ADT = 10,900
 P.V. = 91.06% S.U. = 6.65% M.U. = 2.29%

STATE OF ILLINOIS
 DEPARTMENT OF TRANSPORTATION
 DIVISION OF HIGHWAYS

SUBMITTED May 1 20 15
Paul Costello
 DEPUTY DIRECTOR OF HIGHWAYS, REGION ENGINEER

June 26 20 15
John D. Baranzelli P.E.
 acting ENGINEER OF DESIGN AND ENVIRONMENT

June 26 20 15
Omer Osman, P.E.
 DIRECTOR OF HIGHWAYS, CHIEF ENGINEER

BEGIN PROJECT
 STA. 108 + 23
 710' NORTH OF ACE RD

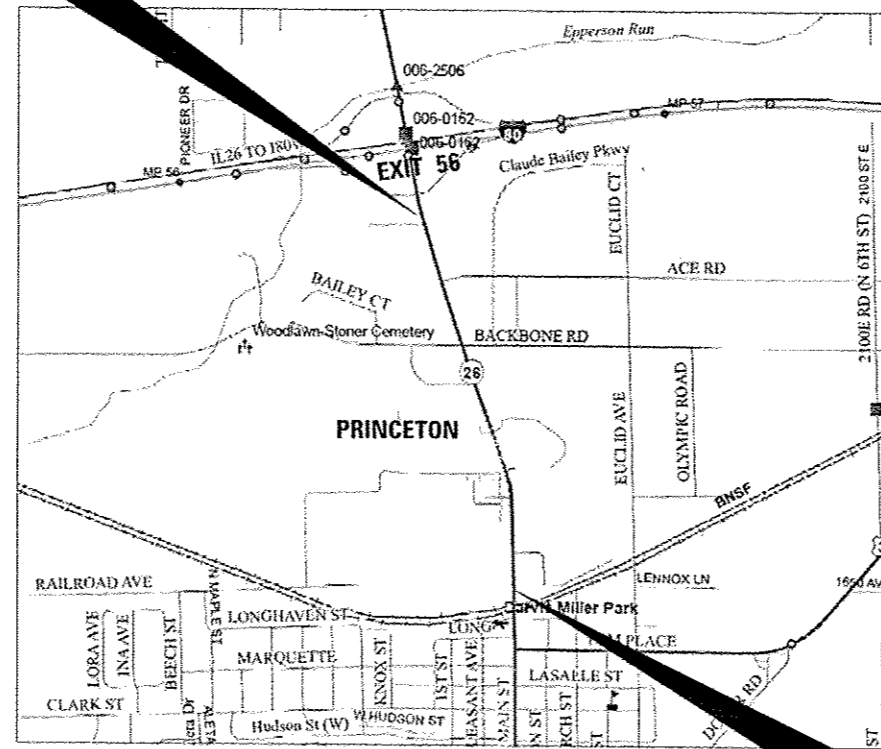

END PROJECT
 STA. 151 + 05
 65' NORTH OF THE BNSF RAILROAD

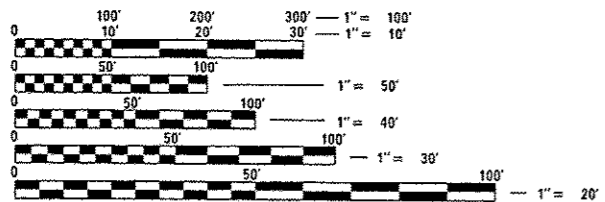

FULL SIZE PLANS HAVE BEEN PREPARED USING STANDARD ENGINEERING SCALES. REDUCED SIZED PLANS WILL NOT CONFORM TO STANDARD SCALES. IN MAKING MEASUREMENTS ON REDUCED PLANS, THE ABOVE SCALES MAY BE USED.

J.U.L.I.E.
 JOINT UTILITY LOCATION INFORMATION FOR EXCAVATION
 1-800-892-0123
 OR 811

GROSS LENGTH = 4,282 FT. = 0.81 MILES
 NET LENGTH = 4,282 FT. = 0.81 MILES

LOCATION MAP NOT TO SCALE

DISTRICT 3 NO. (815) 434-6131
 PROJECT ENGINEER: JOE KANNEL, P.E.
 UNIT CHIEF: DUANE LUKKARI, P.E.
 CONTRACT NO. 66D66

PRINTED BY THE AUTHORITY
OF THE STATE OF ILLINOIS

GENERAL NOTES

THE THICKNESS OF HMA SHOWN ON THE PLANS IS THE NOMINAL THICKNESS. DEVIATIONS FROM THE NOMINAL THICKNESS WILL BE PERMITTED WHEN SUCH DEVIATIONS OCCUR DUE TO IRREGULARITIES IN THE EXISTING SURFACE OR BASE ON WHICH THE HMA IS PLACED.

THE HMA SURFACE OF ALL MAILBOX TURNOUTS, PRIVATE ENTRANCES, COMMERCIAL ENTRANCES, AND SIDE ROADS SHALL BE MADE NEATLY, IN A WORKMANLIKE MANNER, AND SHALL ACCURATELY CONFORM TO THE SHAPES AND DIMENSIONS SHOWN ON THE PLAN DETAILS. IF REQUIRED BY THE ENGINEER, THE CONTRACTOR SHALL SAW CUT THE HMA SURFACE TO CONFORM TO THE SHAPES AND DIMENSIONS SHOWN ON THE PLAN DETAILS. THIS WORK WILL BE INCLUDED IN THE COST OF THE HMA SURFACE.

THE ENGINEER WILL BE THE SOLE JUDGE CONCERNING CURING TIME FOR THE VARIOUS HMA LIFTS.

ALL EXCAVATED MATERIAL, WHICH INCLUDES DIGGING OR GRADING OF ANY SOIL OR FILL MATERIAL, WITH THE EXCEPTION OF AGGREGATE FILLS, MUST BE INCORPORATED WITHIN THE IDOT RIGHT OF WAY DUE TO ENVIRONMENTAL DOCUMENTATION REQUIREMENTS.

ON EXISTING PAVEMENT WHICH MAY BE SUPERELEVATED, THE NEW HMA PAVEMENT SHALL BE BUILT WITH THE SAME SUPERELEVATION UNLESS NEW SUPERELEVATION RATES ARE GIVEN ON THE PLANS.

ADDITIONAL LEVELING BINDER, AT THE RATE GIVEN ON THE TYPICAL SECTIONS, HAS BEEN ADDED TO THE QUANTITIES TO CORRECT TO A 3/16"/FT. (1.5%) CROWN ON SECTIONS OF EXISTING ROADWAYS.

THE URBAN PORTION OF THIS PROJECT HAS THE SPECIAL CATCH BASINS NO.1 & NO.2. THESE CATCH BASINS (AND OTHER INLETS WITHIN THE PROJECT LIMITS) SHOULD BE COVERED DURING CLEAN-UP OF THE MILLINGS.

ALL ELEVATIONS REFERRING TO U.S.G.S. MEAN SEA LEVEL DATUM.

ANY REFERENCE TO A STANDARD IN THESE PLANS SHALL BE INTERPRETED TO MEAN THE EDITION AS INDICATED BY THE SUBNUMBER SHOWN IN THE LIST OF STANDARDS OR THE COPY INCLUDED IN THESE PLANS.

COMMITMENTS
ENVIRONMENT COORDINATION

THE FOLLOWING RATES OF APPLICATION HAVE BEEN USED IN CALCULATING PLAN QUANTITIES:

GRANULAR MATERIALS	2.05	TONS / CU YD
HMA RESURFACING	112	LBS / SQ YD / IN
SHORT TERM PAVEMENT MARKING	10	FT /100 FT OF APPLICATION
MIX FOR CRACKS, JTS & FLOWYS	0.0003	TONS / SQ YD
LEVEL BINDER (HAND METHOD)	0.0005	TONS / SQ YD

THE CONTRACTOR SHALL CONTACT JULIE AT LEAST 48 HOURS PRIOR TO EXCAVATION TO DETERMINE WHICH UTILITIES ARE IN THE AREA.

HMA MIXTURE REQUIREMENT TABLE				
LOCATIONS:	MAINLINE & SIDEROADS	MAINLINE & SIDEROADS	MAINLINE	COMMERCIAL ENTRANCES
MIXTURE USES:	SURFACE	LEVELING BINDER	BINDER	INCIDENTAL
PG GRADE:	SBS PG 70-22	PG 64-22	PG 64-22	PG 64-22
DESIGN AIR VOIDS:	4.0% @ N70	4.0% @ N70	4.0% @ N70	4.0% @ N50
MIXTURE COMPOSITION:	IL-9.5	IL-9.5FG	IL-19.0FG	IL-9.5
FRICTION AGGREGATE:	MIXTURE D			MIXTURE C
MIXTURE WEIGHT:	112 LB/SY/IN	112 LB/SY/IN	112 LB/SY/IN	112 LB/SY/IN
QUALITY MANAGEMENT PROGRAM:	QC/QA	QC/QA	QC/QA	QC/QA
DENSITY TEST METHOD:	CORES/NUCLEAR	GROWTH CURVE	CORES	SATISFACTION OF ENGINEER

DATE: May 1, 2015

PREPARED BY: Tom Baird
DISTRICT STUDIES & PLANS ENGINEER

EXAMINED BY: Harold Gray
DISTRICT CONSTRUCTION ENGINEER

Walter P. Hulley
DISTRICT MATERIALS ENGINEER

Bruce A. Anderson
DISTRICT OPERATIONS ENGINEER

SUMMARY OF QUANTITIES				CONSTR. CODE	
				80% FED. 20% STATE	
CODE NO.	ITEM	UNIT	TOTAL QUANTITY	ROADWAY	
				0005	URBAN
40600400	MIXTURE FOR CRACKS, JOINTS, AND FLANGWAYS	TON	7.6	7.6	
40600537	LEVELING BINDER (HAND METHOD), IL-9.5FG, N70	TON	12.6	12.6	
40600637	LEVELING BINDER (MACHINE METHOD), IL-9.5FG, N70	TON	908	908	
40600990	TEMPORARY RAMP	SQ YD	411	411	
40603087	HOT-MIX ASPHALT BINDER COURSE, IL-19.0 FG, N70	TON	671	671	
40603540	POLYMERIZED HOT-MIX ASPHALT SURFACE COURSE, MIX "D", N7	TON	1803	1803	
40800025	BITUMINOUS MATERIALS (PRIME COAT)	POUND	17510	17510	
40800050	INCIDENTAL HOT-MIX ASPHALT SURFACING	TON	669	669	
44000155	HOT-MIX ASPHALT SURFACE REMOVAL, 1 1/2"	SQ YD	1160	1160	
44000158	HOT-MIX ASPHALT SURFACE REMOVAL, 2 1/4"	SQ YD	20067	20067	
44201377	CLASS C PATCHES, TYPE II, 12 INCH	SQ YD	2100	2100	
44201381	CLASS C PATCHES, TYPE III, 12 INCH	SQ YD	23	23	
48102100	AGGREGATE WEDGE SHOULDER, TYPE B	TON	78	78	
56109210	WATER VALVES TO BE ADJUSTED	EACH	8	8	
14					

FILE NAME *	USER NAME # Schwenker	DESIGNED -	REVISED -	STATE OF ILLINOIS DEPARTMENT OF TRANSPORTATION	SUMMARY OF QUANTITIES	F.A.P. RTE.	SECTION	COUNTY	TOTAL SHEETS	SHEET NO.	
er:\p_work\axidot\schwenker\4037726	66066Plans.dgn	DRAWN -	REVISED -			615	(116)RS-7	BUREAU	18	3	
	PLOT SCALE = 100.0000' / 1"	CHECKED -	REVISED -			CONTRACT NO. 66066					
#MODELNAME#	PLOT DATE = 5/1/2015	DATE -	REVISED -			ILLINOIS FED. AID PROJECT					
						SCALE:	SHEET	OF	SHEETS	STA.	TO STA.

SUMMARY OF QUANTITIES				CONSTR. CODE	
CODE NO.	ITEM	UNIT	TOTAL QUANTITY	80% FED. 20% STATE	
				ROADWAY	URBAN
60255500	MANHOLES TO BE ADJUSTED	EACH	6	6	
67100100	MOBILIZATION	L SUM	1	1	
70102620	TRAFFIC CONTROL AND PROTECTION, STANDARD 701501	L SUM	1	1	
70102622	TRAFFIC CONTROL AND PROTECTION, STANDARD 701502	L SUM	1	1	
70102635	TRAFFIC CONTROL AND PROTECTION, STANDARD 701701	L SUM	1	1	
70300100	SHORT TERM PAVEMENT MARKING	FOOT	11490	11490	
70300210	TEMPORARY PAVEMENT MARKING LETTERS AND SYMBOLS	SO FT	1500	1500	
70301000	WORK ZONE PAVEMENT MARKING REMOVAL	SO FT	3826	3826	
* 78000100	THERMOPLASTIC PAVEMENT MARKING - LETTERS AND SYMBOLS	SO FT	866	866	
* 78000200	THERMOPLASTIC PAVEMENT MARKING - LINE 4"	FOOT	11630	11630	
* 78000400	THERMOPLASTIC PAVEMENT MARKING - LINE 6"	FOOT	1580	1580	
* 78000500	THERMOPLASTIC PAVEMENT MARKING - LINE 8"	FOOT	2065	2065	
* 78000600	THERMOPLASTIC PAVEMENT MARKING - LINE 12"	FOOT	582	582	
* 78000650	THERMOPLASTIC PAVEMENT MARKING - LINE 24"	FOOT	440	440	
14					

* SPECIALTY ITEM

FILE NAME *	USER NAME * Schwanberg	DESIGNED -	REVISED -	STATE OF ILLINOIS DEPARTMENT OF TRANSPORTATION	SUMMARY OF QUANTITIES				F.A.P. RTE.	SECTION	COUNTY	TOTAL SHEETS	SHEET NO.
c:\p\work\p\idot\schwanberg\037726\066666\066666.dgn	066666.dgn	DRAWN -	REVISED -		615	1116/RS-7	BUREAU	18	4				
PLOT SCALE * 100.0000' / 1"		CHECKED -	REVISED -		SCALE: SHEET OF SHEETS STA. TO STA.				CONTRACT NO. 66066				
MODEL NAME *	PLOT DATE * 5/1/2015	DATE -	REVISED -		ILLINOIS FED. AID PROJECT								

SUMMARY OF QUANTITIES				CONSTR. CODE	
CODE NO.	ITEM	UNIT	TOTAL QUANTITY	80% FED. 20% STATE	
				ROADWAY	URBAN
* 78100100	RAISED REFLECTIVE PAVEMENT MARKER	EACH	234	234	
* 78200300	PRISMATIC CURB REFLECTOR	EACH	22	22	
78300200	RAISED REFLECTIVE PAVEMENT MARKER REMOVAL	EACH	198	198	
* 81028320	UNDERGROUND CONDUIT, PVC, 1" DIA.	FOOT	150	150	
* 87301305	ELECTRIC CABLE IN CONDUIT, LEAD-IN, NO. 14 1 PAIR	FOOT	200	200	
* 87900200	DRILL EXISTING HANDHOLE	EACH	1	1	
* 88500100	INDUCTIVE LOOP DETECTOR	EACH	6	6	
* 88600100	DETECTOR LOOP, TYPE 1	FOOT	1241	1241	
* 89502210	MODIFY EXISTING CONTROLLER CABINET	EACH	2	2	
* X4401198	HOT-MIX ASPHALT SURFACE REMOVAL, VARIABLE DEPTH	SO YD	5100	5100	
* X7830074	GROOVING FOR RECESSED PAVEMENT MARKING 7"	FOOT	370	370	
* X7830076	GROOVING FOR RECESSED PAVEMENT MARKING 9"	FOOT	2065	2065	
* X7830090	GROOVING FOR RECESSED PAVEMENT MARKING 25"	FOOT	440	440	
* X8860100	LOOP DETECTOR TESTING	EACH	1	1	

* SPECIALTY ITEM

FILE NAME =	USER NAME = Schwanberg	DESIGNED -	REVISED -	STATE OF ILLINOIS DEPARTMENT OF TRANSPORTATION	SUMMARY OF QUANTITIES	F.A.P. RTE.	SECTION	COUNTY	TOTAL SHEETS	SHEET NO.
ci:\pvc\work\pvc\dos\schwanberg\09077726\066066Plans.dgn	DRAWN -	REVISED -	615			016RS-7	BUREAU	18	5	
PLOT SCALE = 1/8" = 100'-0" / in.	CHECKED -	REVISED -	CONTRACT NO. 66D66							
MODELNAME#	DATE -	REVISED -	SCALE:			SHEET OF SHEETS	STA. TO STA.	ILLINOIS FED. AID PROJECT		

7/1/15

SUMMARY OF QUANTITIES				CONSTR. CODE	
				80% FED. 20% STATE	
CODE NO.	ITEM	UNIT	TOTAL QUANTITY	ROADWAY	
				0005	URBAN
* X1400106	WIRELESS VEHICLE DETECTION SYSTEM	EACH	1		1
Z0030850	TEMPORARY INFORMATION SIGNING	SO FT	42		42

* SPECIALTY ITEM

~

FILE NAME =	USER NAME = Schwenker	DESIGNED -	REVISED -	STATE OF ILLINOIS DEPARTMENT OF TRANSPORTATION	SUMMARY OF QUANTITIES	F.A.P. RTE.	SECTION	COUNTY	TOTAL SHEETS	SHEET NO.	
c:\p4_work\p4\dot\schwenker\03772261	03RC66P1ans.dgn	DRAWN -	REVISED -			615	1116/RS-7	BUREAU	18	6	
#MODELNAME#	PLOT SCALE = 1/8" = 1' / 1" IN.	CHECKED -	REVISED -			CONTRACT NO. 66066					
	PLOT DATE = 5/1/2015	DATE -	REVISED -			SCALE:	SHEET OF SHEETS	STA. TO STA.	ILLINOIS FED. AID PROJECT		

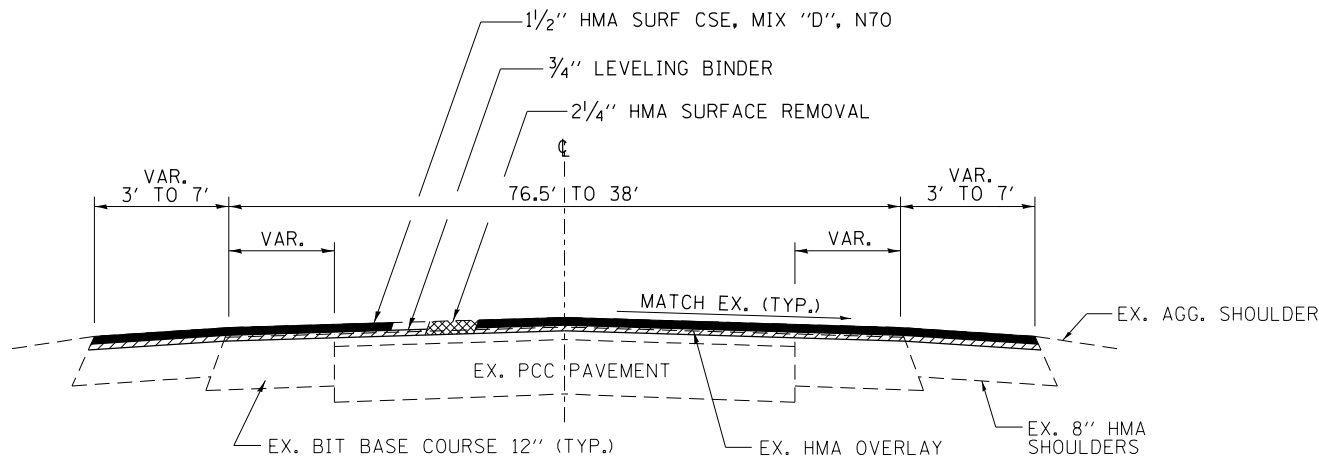

PROPOSED TYPICAL SECTION 1
STA. 108+22.70 TO STA. 112+20

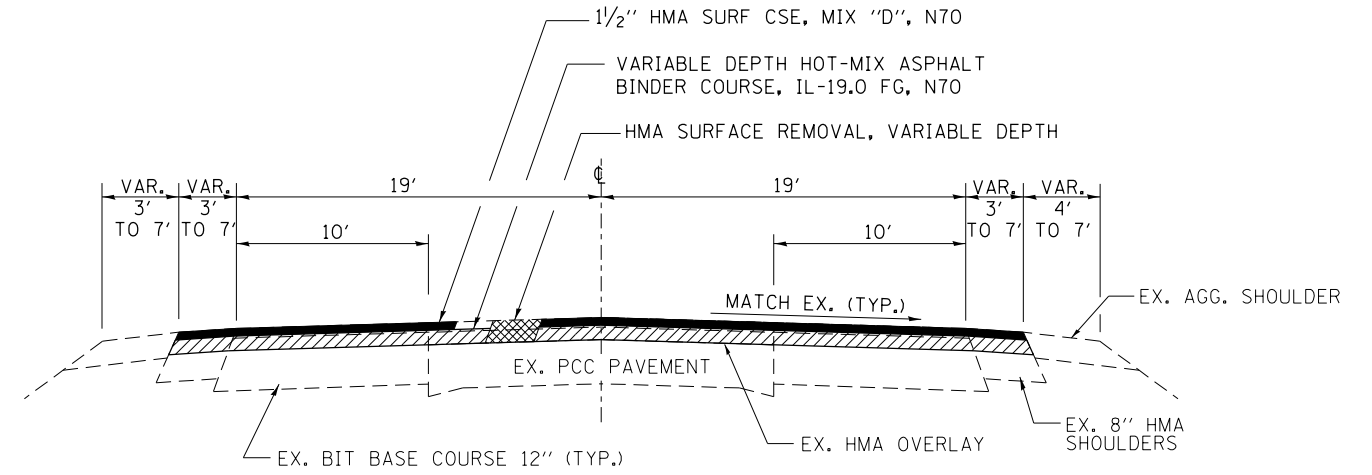

PROPOSED TYPICAL SECTION 3
STA. 114+53 TO STA. 121+80

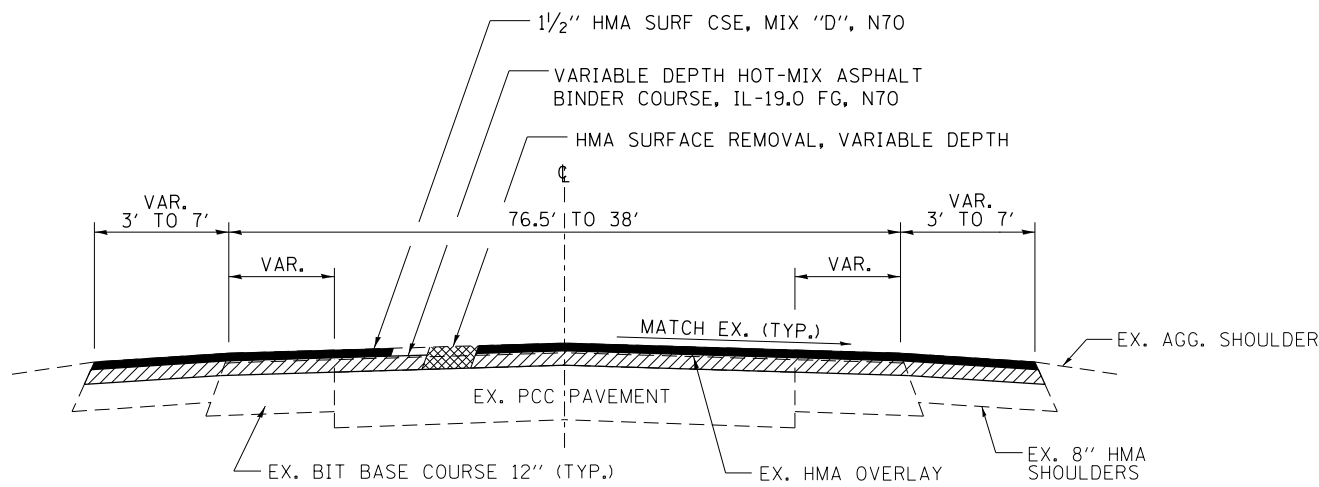

PROPOSED TYPICAL SECTION 2
STA. 112+20 TO STA. 114+53

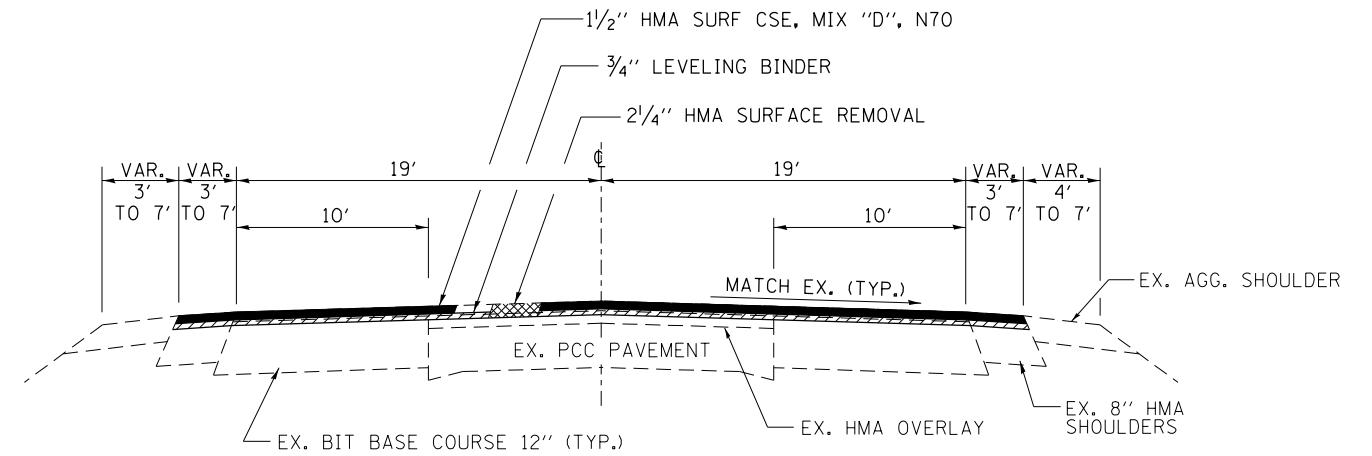

PROPOSED TYPICAL SECTION 4
STA. 121+80 TO STA. 122+57

FILE NAME =	USER NAME = Schwankerg	DESIGNED -	REVISED -	STATE OF ILLINOIS DEPARTMENT OF TRANSPORTATION	TYPICAL SECTIONS			F.A.P. RTE.	SECTION	COUNTY	TOTAL SHEETS	SHEET NO.
et:\pw\work\p\idot\schwankerg\d037726\066066P\ans.dgn		DRAWN -	REVISED -					615	(116)RS-7	BUREAU	18	7
\$MODELNAME\$	PLOT SCALE = 100.0000' / 1"	CHECKED -	REVISED -		SCALE: SHEET OF SHEETS STA. TO STA.			CONTRACT NO. 66D66				
	PLOT DATE = 5/1/2015	DATE -	REVISED -		ILLINOIS FED. AID PROJECT							

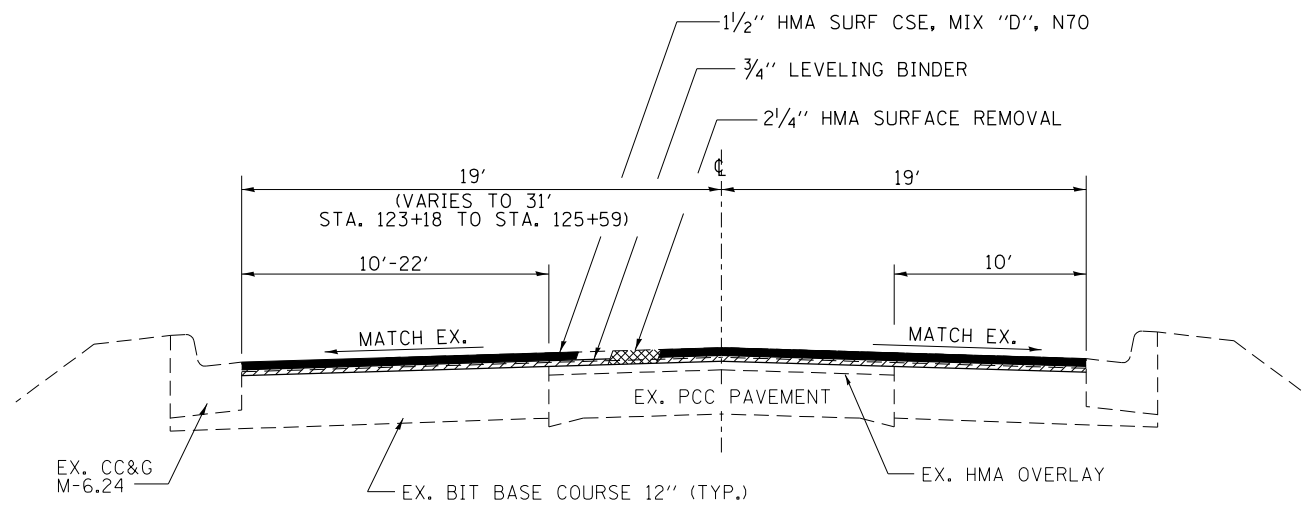

PROPOSED TYPICAL SECTION 5

STA. 122+57 TO STA. 136+45.6
 STA. 140+81.3 TO STA. 146+07

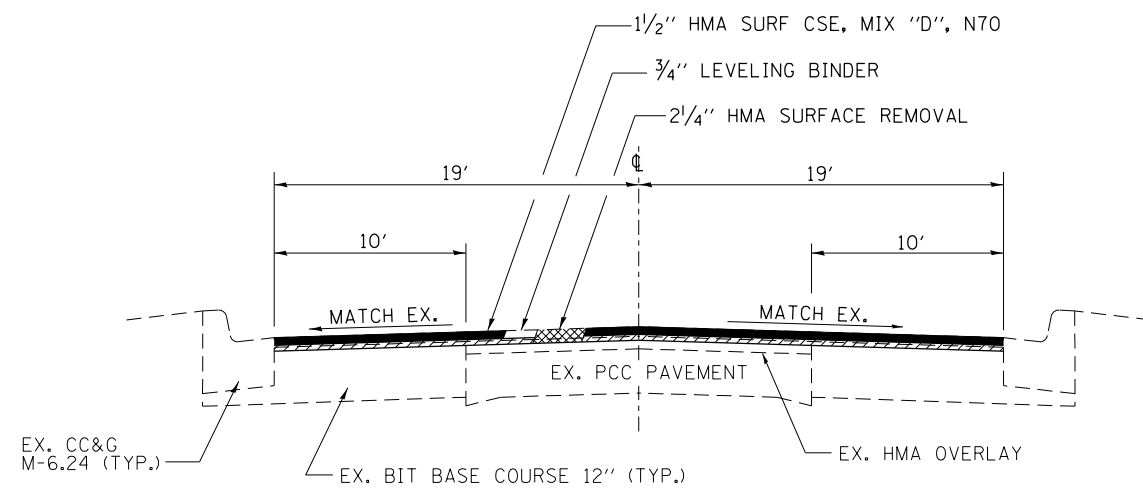

PROPOSED TYPICAL SECTION 7

STA. 146+07 TO STA. 151+05

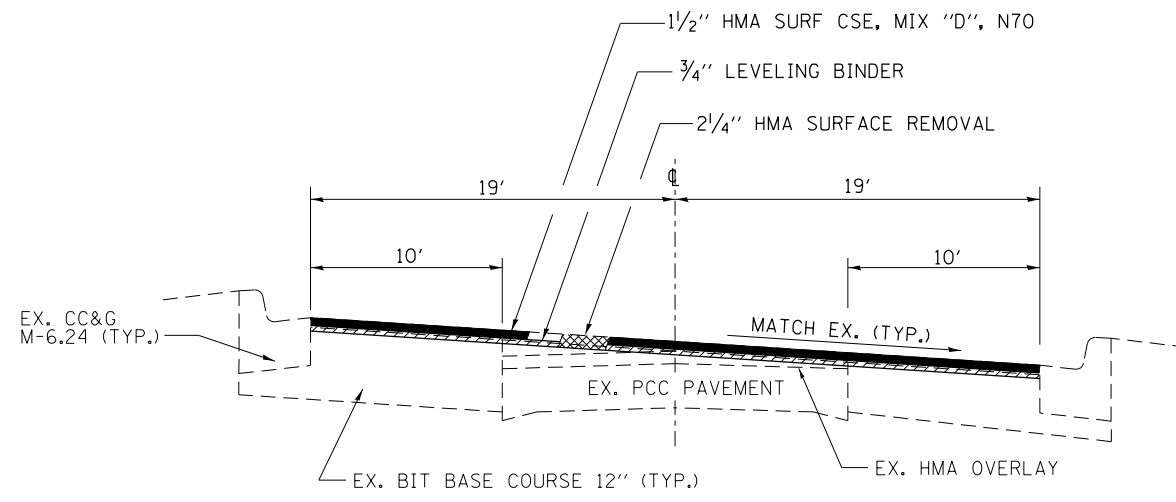

PROPOSED TYPICAL SECTION 6

STA. 136+45.6 TO STA. 140+81.3

FILE NAME =	USER NAME = Schwankerg	DESIGNED -	REVISED -
c:\pwork\work\pwork\schwankerg\d0377726\B66D66Plans.dgn		DRAWN -	REVISED -
\$MODELNAME\$	PLOT SCALE = 100.0000' / 1in.	CHECKED -	REVISED -
	PLOT DATE = 5/1/2015	DATE -	REVISED -

**STATE OF ILLINOIS
 DEPARTMENT OF TRANSPORTATION**

TYPICAL SECTIONS			
SCALE:	SHEET	OF SHEETS	STA. TO STA.

F.A.P. RTE.	SECTION	COUNTY	TOTAL SHEETS	SHEET NO.
615	(116)RS-7	BUREAU	18	8
CONTRACT NO. 66D66			ILLINOIS FED. AID PROJECT	

MAINLINE SCHEDULE													
	PVMT. LENGTH	PVMT. WIDTH	PVMT. AREA	BINDER N70	LEVELING BINDER 3/4" * (MM), N70	POLY. HMA SURF. CSE. 1 1/2" MIX D, N70	AGG. WEDGE SHOULDER TY. B	TEMP. RAMP	HMA SURF. REM. 2 1/4"	VARIABLE DEPTH SURF. REM.	LEVELING BINDER (HM), N70	MIXT. FOR CRACKS, JTS. & FLGWYS.	BIT. MTLs. PRIME COAT
	FOOT	FOOT	SQ YD	TON	TON	TON	TON	SQ YD	SQ YD	SQ YD	TON	TON	LBS
108+22.7 (710' NORTH OF ACE RD) TO 112+20	397.3	85-52	2477		143	214		39	2477		1.2	0.7	1672
112+20 TO 121+80	960.0	38-54	5100	671		441	78			5100	2.6	1.5	3443
121+80 TO 125+48.6	368.6	42-52	2063		119	178			2063		1.0	0.6	1393
125+48.6 TO 127+38.6	190.0	50-38	929		54	80			929		0.5	0.3	627
127+38.6 TO 151+05 (65' NORTH OF BNSF RR TRACKS)	2431.9	38	10,268		592	888		20	10,268		5.1	3.1	6931
TOTALS	4347.8		20837	671	908	1803	78	59	15737	5100	10.4	6.3	14065

• NOTE: AN EXTRA 1/4" OF LEVEL BINDER (MM) WAS ADDED FROM STATION 108+23 TO 125+48.6 FOR CROWN CORRECTION

INCIDENTAL HMA SCHEDULE									
	PVMT. AREA	LEVELING BINDER (HM), N70	INCIDENTAL 3/4" LB (MM), N70	INCIDENTAL 1 1/2" POLY. SC MIX D, N70	TEMP. RAMP	HMA SURF. REM. 1 1/2"	HMA SURF. REM. 2 1/4"	MIXT. FOR CRACKS, JTS. & FLGWYS.	BIT. PRIME COAT
SIDEROADS / OTHER	SQ YD	TON	TON	TON	SQ YD	SQ YD	SQ YD	TON	LBS
ACE ROAD (115+34.0 LT)	860	0.4	37	74	60		860	0.3	581
ACE ROAD (115+34.0 RT)	520	0.3	22	45	57		520	0.2	351
BACKBONE ROAD (122+57.0 LT)	690	0.3	30	60	43		690	0.2	466
BACKBONE ROAD (122+57.0 RT)	780	0.4	34	67	40		780	0.2	527
RAILROAD AVENUE (149+58.7 LT)	190	0.1	8	16	20		190	0.1	128
RAILROAD AVENUE (149+58.7 RT)	440	0.2	19	38	50		440	0.1	297
SHOULDERS 108+22.7 TO 114+60 LT	400	0.2	17	35			400	0.1	270
SHOULDERS 108+22.7 TO 114+80 RT	450	0.2	19	39			450	0.1	304
TOTALS	4330	2.2	187	375	270	0	4330	1.3	2923
ENTRANCE LOCATIONS:	SQ YD	TON	TON	MIX C - TON	SQ YD	SQ YD	SQ YD	TON	LBS
WENDY'S (108+57 RT)	140			13	18	140			63
SHELL NORTH (108+93 LT)	135			12	19	135			61
ABANDONED GAS NORTH (109+36 RT)	165			15	0	165			74
ABANDONED GAS SOUTH (110+39 RT)	185			17	0	185			83
SHELL SOUTH (110+48 LT)	130			12	14	130			59
ECONOLODGE (111+13 RT)	220			20	14	220			99
BIG APPLE RESTAURANT (112+66 RT)	185			17	17	185			83
TOTALS	1160	0	0	107	82	1160	0	0	522
GRAND TOTALS		2.2	187	482	352	1160	4330	1.3	3445

DETECTOR LOOPS & WIRELESS VEHICLE DETECTION SENSORS SCHEDULE								
LOCATION	DETECTOR LOOP TYPE I	LOOP DETECTOR TESTING	INDUCTIVE LOOP DETECTOR	UNDERGROUND CONDUIT 1" PVC	ELECTRIC CABLE IN CONDUIT, LEAD IN NO 14, 1 PAIR	DRILL EXISTING HANDHOLE	MODIFY EXIST. CONTROLLER CABINET	WIRELESS VEHICLE DETECTION SYSTEM
BACKBONE RD (122+57)	1241	1	6	150	200	1	1	
ACE RD (115+34)							1	1
TOTALS	1241	1	6	150	200	1	2	1

PRISMATIC CURB REFLECTORS	
LOCATION	PRISMATIC CURB REFLECTOR EACH
ACE ROAD (115+34 RT)	12
RAILROAD AVE (149+59 RT)	10
TOTALS	22

WATER VALVES & MANHOLES TO BE ADJUSTED		
LOCATION	WATER VALVES TO BE ADJUSTED EACH	MANHOLES TO BE ADJUSTED EACH
ECONOLOGDE ENTRANCE 111+13 RT		1
BACKBONE ROAD INTERSECTION - LT	4	
BACKBONE ROAD INTERSECTION - RT		3
RAILROAD AVE. INTERSECTION - LT	1	
RAILROAD AVE. INTERSECTION - RT	3	2
TOTALS	8	6

SHORT TERM PAVEMENT MARKINGS SCHEDULE						
LOCATION			4" LINE YELLOW	4" LINE WHITE	12" LINE WHITE	WORK ZONE PAVT MK REM
STA.	TO	STA.	FOOT	FOOT	FOOT	SQ FT
108+33	TO	114+00	656	628		428
114+00	TO	121+00	896	1086	392	791
121+00	TO	128+00	848	1518	372	912
128+00	TO	147+00	1904	2112		1337
147+00	TO	151+70.50	528	360	190	359
TOTALS			4832	5704	954	3826

RAISED REFL. PAVEMENT MARKERS BREAKDOWN				
LOCATION	R.R.P.M. 1-WAY CRYSTAL EACH	R.R.P.M. 1-WAY AMBER EACH	R.R.P.M. 2-WAY AMBER EACH	
108+22.7 TO 114+00	1	8	18	
114+00 TO 121+00	11	12	18	
121+00 TO 128+00	13	10	22	
128+00 TO 147+00			96	
147+00 TO 151+05	5	8	12	
TOTALS	30	38	166	234

THERMOPLASTIC PAVEMENT MARKINGS SCHEDULE																
LOCATION			THERMO. 4" LINE WHITE	THERMO. 4" LINE YELLOW	THERMO. 6" LINE WHITE	THERMO. 6" LINE YELLOW	THERMO. 8" LINE WHITE	THERMO. 12" LINE WHITE	THERMO. 12" LINE YELLOW	THERMO. 24" LINE WHITE	THERMO. LETTERS & SYMBOLS	GROOVING FOR RECESSED PAVEMENT MARKING*			RAISED REFL. PVMT. MKRS EACH	RAISED REFL. PVMT. MKR. REMOVAL EACH
STA.	TO	STA.	FOOT	FOOT	FOOT	FOOT	FOOT	FOOT	FOOT	FOOT	SQ FT	7"	9"	25"		
108+33	TO	114+00	385	1885		160	258	116	78		89.5		258		27	16
114+00	TO	121+00	1365	1712			960	126	108	140	135.2		960	140	41	34
121+00	TO	128+00		1408		80	669		73	198	197.6		669	198	45	40
128+00	TO	147+00		3800		950					343.2				96	84
147+00	TO	151+05		1075	370	20	178		81	102	100.8	370	178	102	25	24
TOTALS			1750	9880	370	1210	2065	242	340	440	866.3	370	2065	440	234	198

*NOTE: THE GROOVING WILL BE DONE AT THE 6" CROSS WALKS LINES, 24" STOP BARS, 8" SOLID LINES, AND 8" DOTTED LANE LINES.

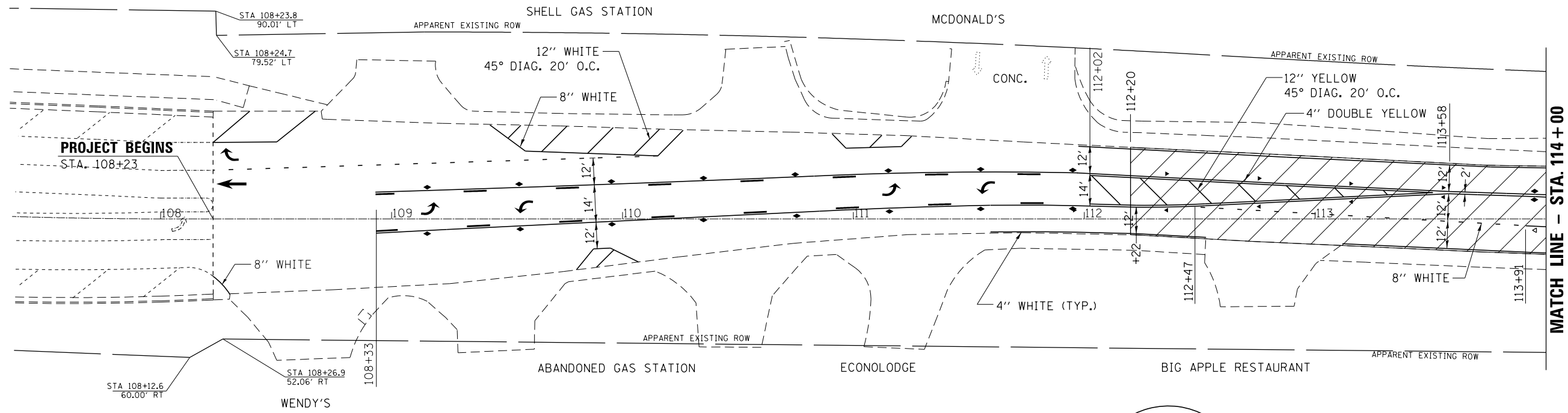

MATCH LINE - STA. 114 + 00

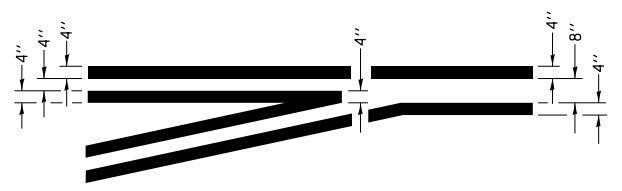

**LEFT TURN LANE
TYPICAL APPLICATION**

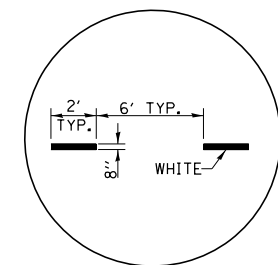

**ADVANCE AND INTERSECTION LANE
DIVIDER LINES**

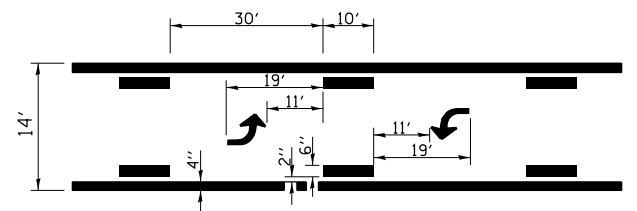

**TYPICAL APPLICATION
BI-DIRECTIONAL TURN LANE**

APPROX. LIMITS
OF RESURFACING

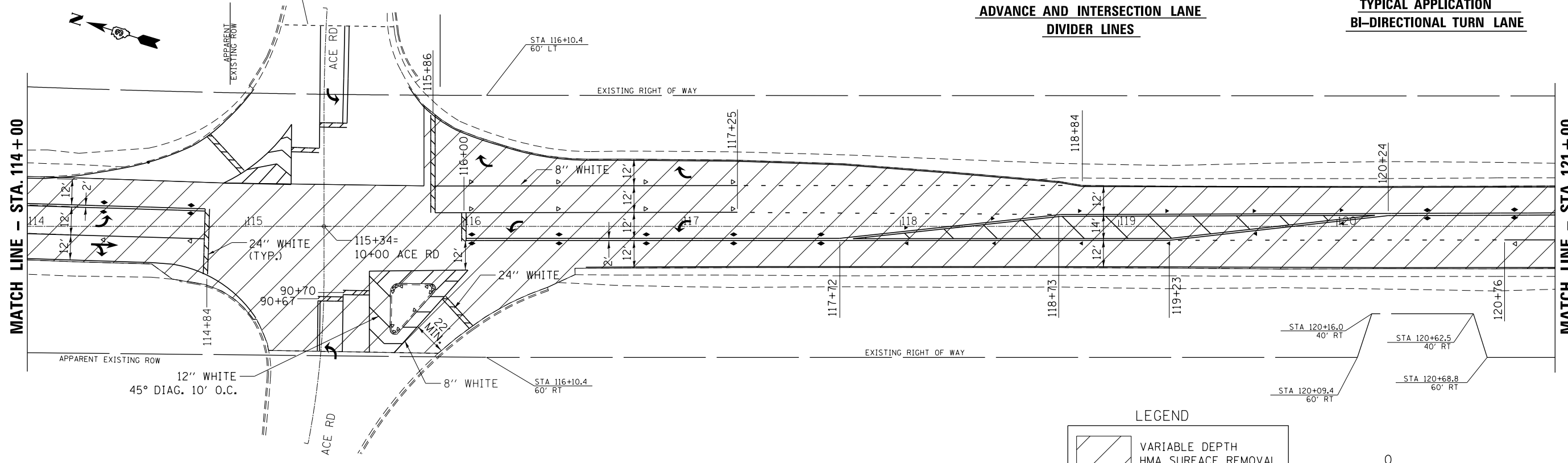

MATCH LINE - STA. 114 + 00

MATCH LINE - STA. 121 + 00

LEGEND

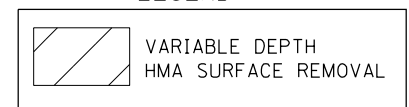

SCALE IN FEET

FILE NAME =	USER NAME = Schwankerg	DESIGNED -	REVISED -
c:\pw\work\p\dot\schwankerg\d0377726\B66D66Plans.dgn		DRAWN -	REVISED -
#MODELNAME#	PLOT SCALE = 100.0000' / 1in.	CHECKED -	REVISED -
	PLOT DATE = 5/1/2015	DATE -	REVISED -

**STATE OF ILLINOIS
DEPARTMENT OF TRANSPORTATION**

PAVEMENT MARKING

SCALE: SHEET OF SHEETS STA. TO STA.

F.A.P. RTE.	SECTION	COUNTY	TOTAL SHEETS	SHEET NO.
615	(116)RS-7	BUREAU	18	11
CONTRACT NO. 66D66				
ILLINOIS FED. AID PROJECT				

LEGEND

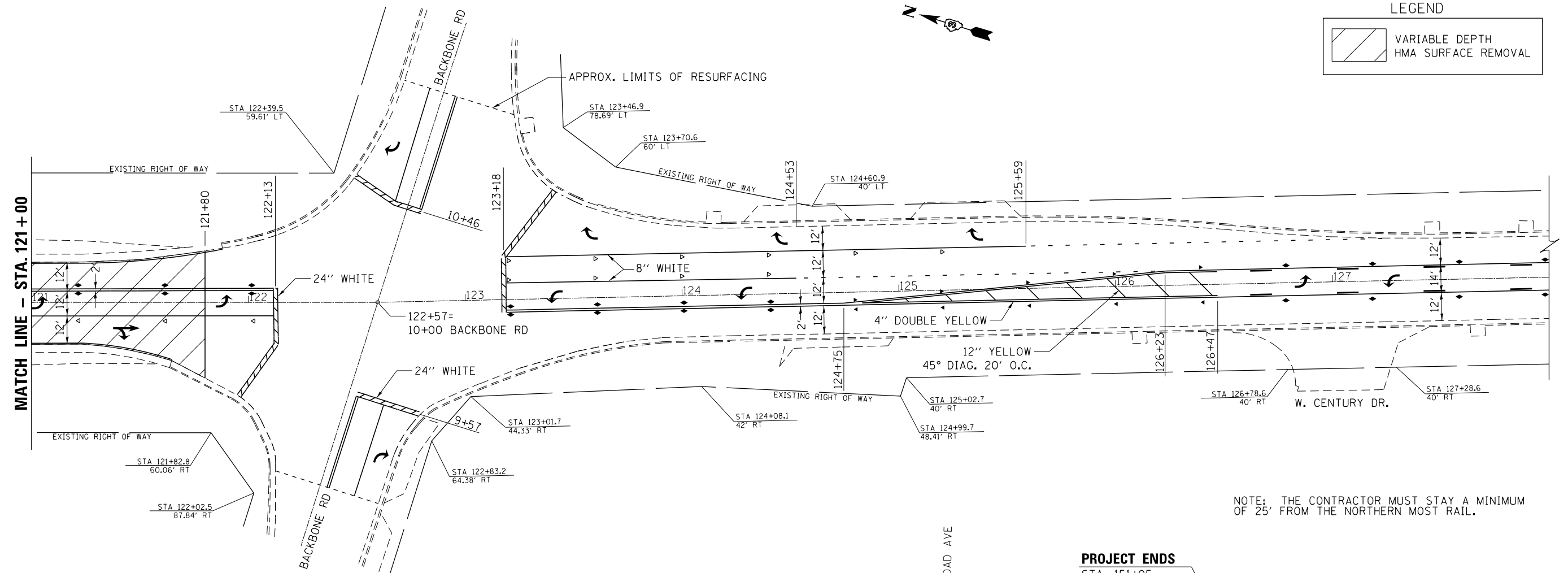
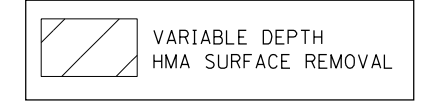

NOTE: THE CONTRACTOR MUST STAY A MINIMUM OF 25' FROM THE NORTHERN MOST RAIL.

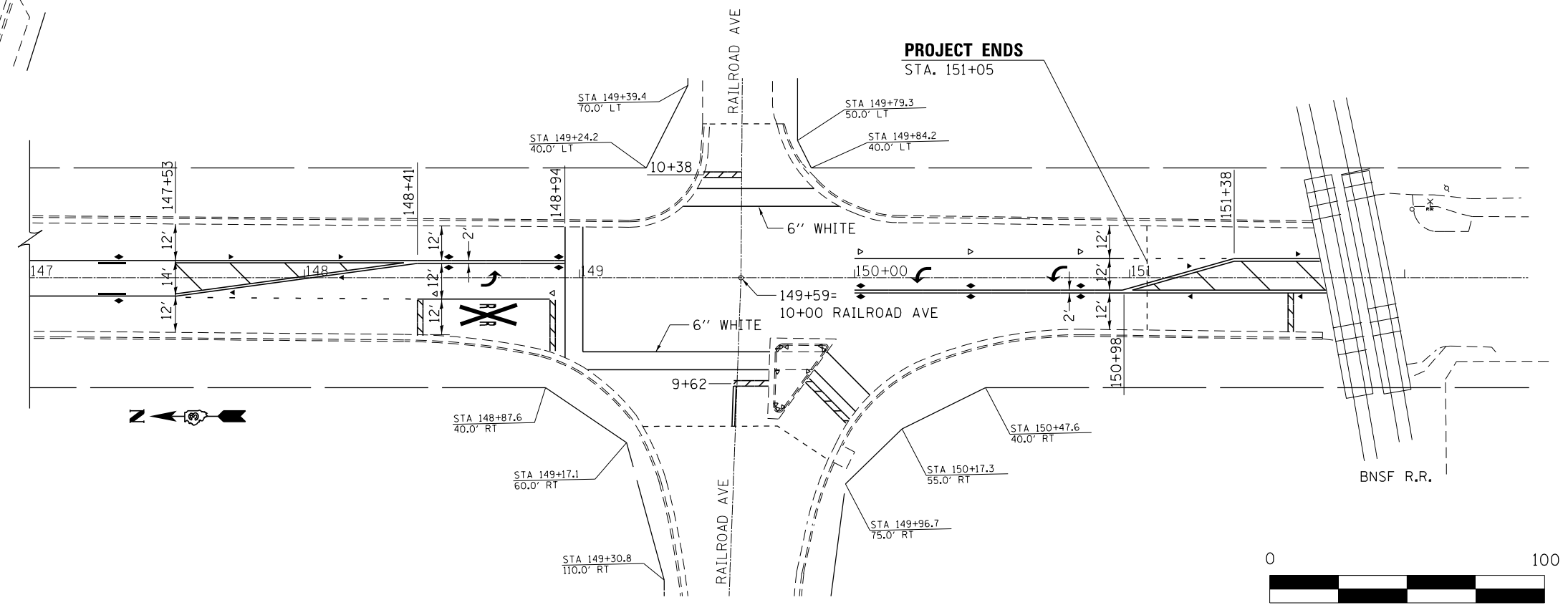
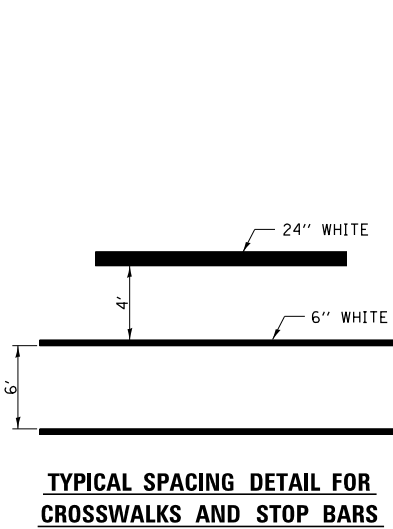

FILE NAME =	USER NAME = Schwankerg	DESIGNED -	REVISED -	STATE OF ILLINOIS DEPARTMENT OF TRANSPORTATION	PAVEMENT MARKING				F.A.P. RTE.	SECTION	COUNTY	TOTAL SHEETS	SHEET NO.		
ei:\pw\work\p\idot\schwankerg\d0377726\066066P1ans.dgn		DRAWN -	REVISED -		SCALE:	SHEET	OF	SHEETS	STA.	TO STA.	615	(116)RS-7	BUREAU	18	12
MODELNAME	PLOT SCALE = 100.0000' / in.	CHECKED -	REVISED -											CONTRACT NO. 66D66	
	PLOT DATE = 5/1/2015	DATE -	REVISED -											ILLINOIS FED. AID PROJECT	

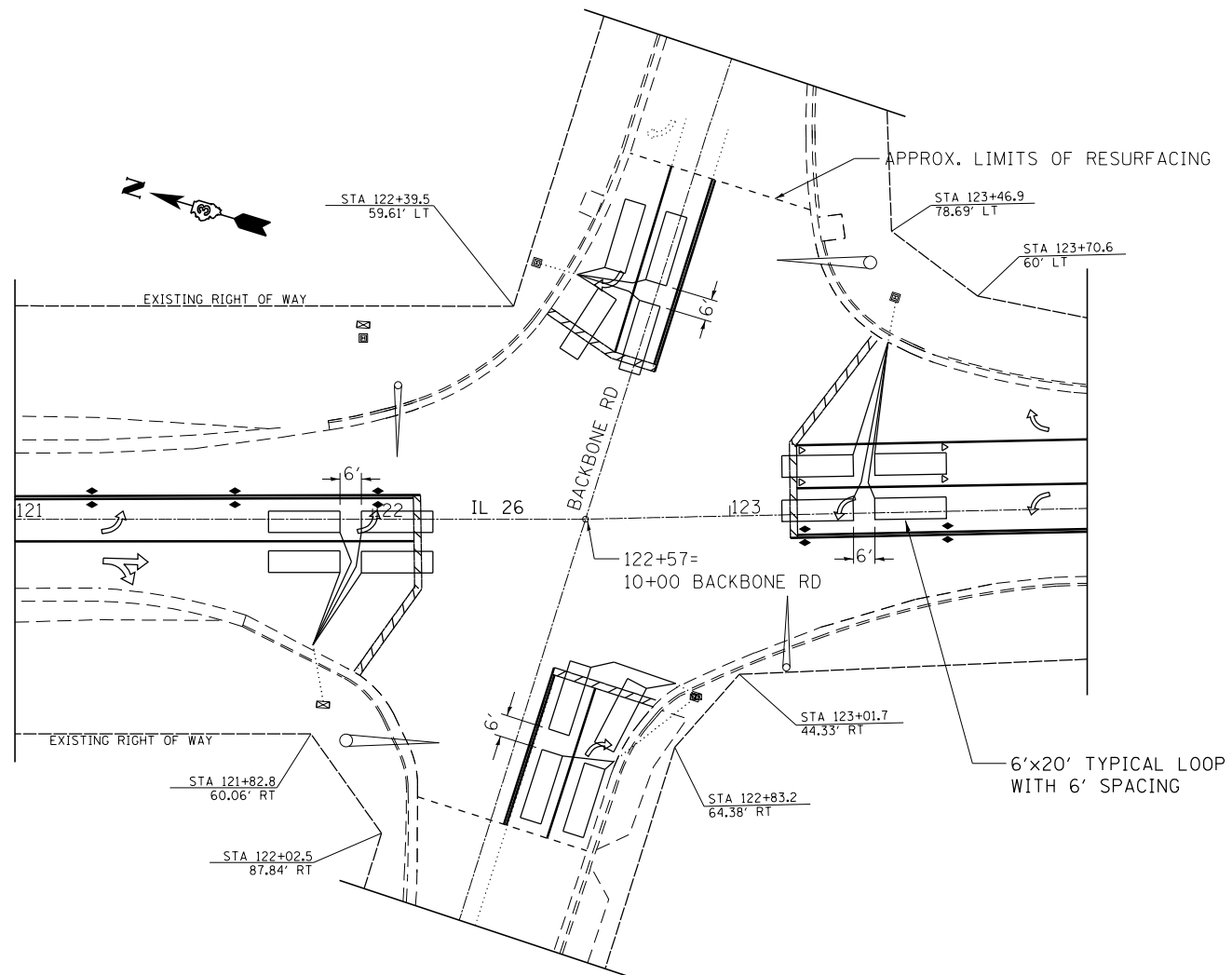

BACKBONE ROAD DETECTOR LOOPS

NOTES FOR BACKBONE ROAD:

1. PLACE DETECTOR LOOPS IN THE HMA LEVEL BINDER.
2. DETECTOR LOOPS SHALL HAVE FOUR TURNS EXCEPT FOR ADV LOOPS WHICH SHALL HAVE 6 TURNS.
3. SAW CUT EXISTING DETECTOR LOOPS TO BE ABANDONED.
4. THE DEPARTMENT OF TRANSPORTATION 815-434-8506 SHALL BE NOTIFIED AT LEAST 72 HOURS PRIOR TO THE LAYOUT OF THE DETECTOR LOOPS.
5. UNLESS OTHERWISE NOTED, ALL DETECTOR LOOPS WILL BE 20' X 6'.
6. THE EXACT LOCATIONS OF ALL UTILITIES SHALL BE FIELD VERIFIED BY THE CONTRACTOR BEFORE ANY WORK IS STARTED.
7. THE DETECTOR LOOP CABLE FROM THE END OF THE SAW CUT IN THE PAVEMENT TO THE SPLICE IN THE HANDHOLE SHALL BE CONSIDERED INCIDENTAL TO THE COST OF THE DETECTOR LOOP.

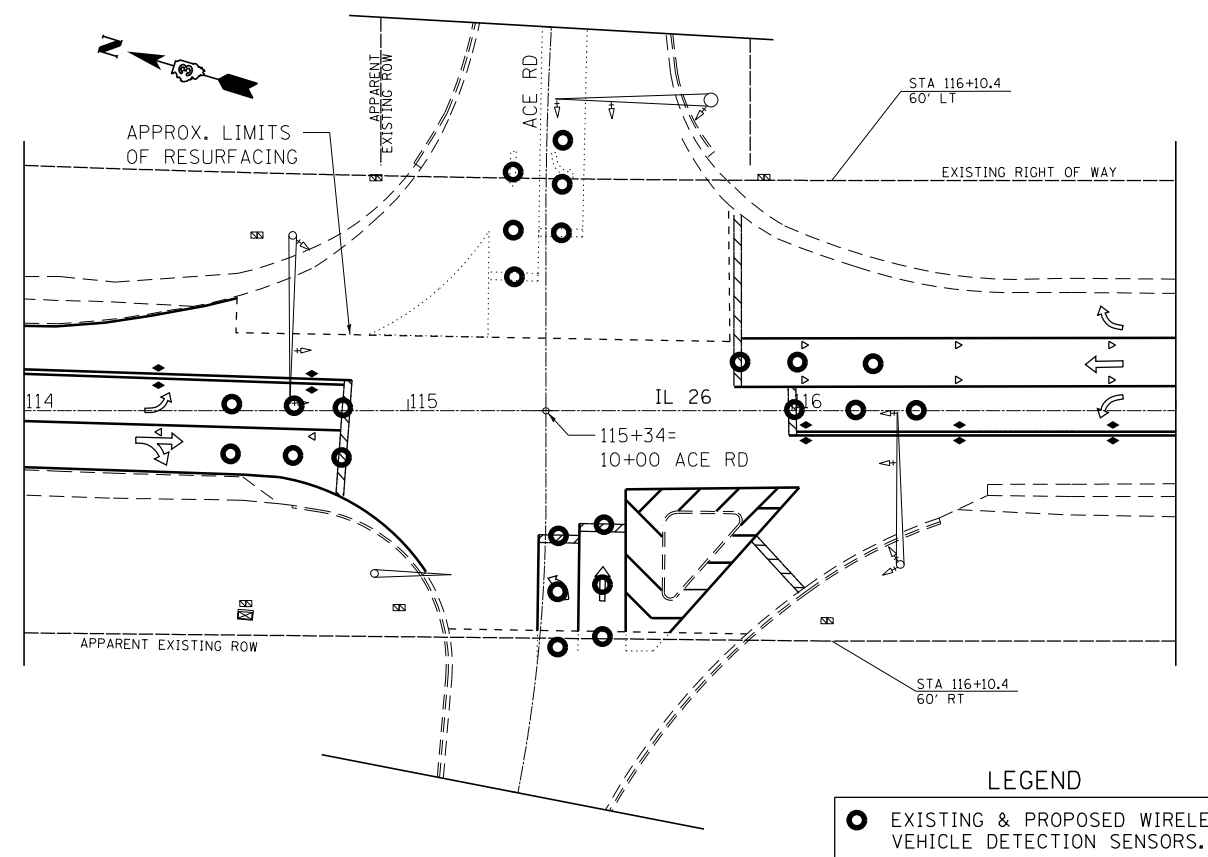

ACE ROAD WIRELESS VEHICLE DETECTION SENSORS

NOTES FOR ACE ROAD:

1. PLACEMENT OF THE WIRELESS VEHICLE DETECTION SENSORS SHALL BE OBSERVED BY THE COMPANY SENSYS.
2. SENSORS SHALL BE PLACED IN THE HMA SURFACE COURSE.
3. THE DEPARTMENT OF TRANSPORTATION 815-434-8506 SHALL BE NOTIFIED AT LEAST 72 HOURS PRIOR TO THE LAYOUT OF SENSORS.

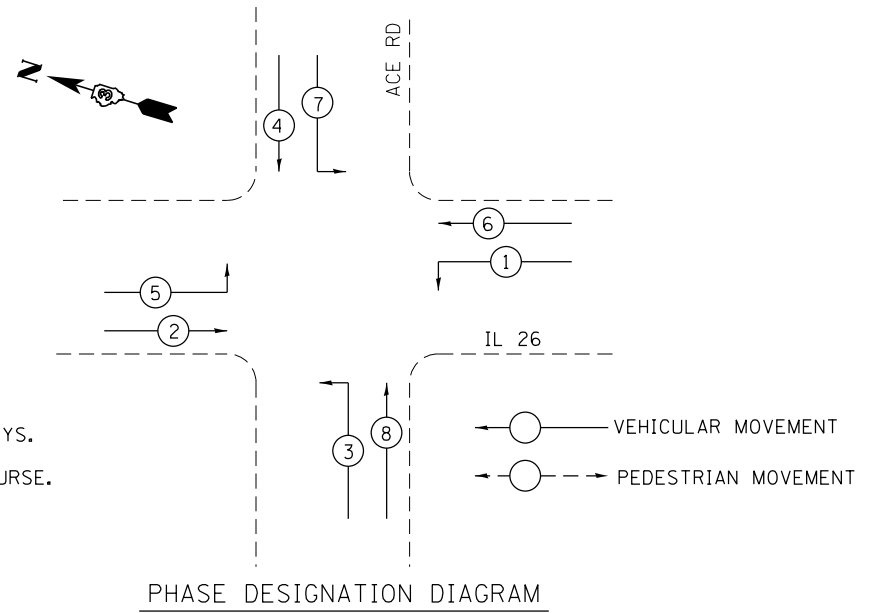

FILE NAME =	USER NAME = Schwankerg	DESIGNED -	REVISED -	STATE OF ILLINOIS DEPARTMENT OF TRANSPORTATION	DETECTOR LOOPS / WIRELESS VEHICLE DETECTION SENSORS				F.A.P. RTE.	SECTION	COUNTY	TOTAL SHEETS	SHEET NO.
ci:\pw\work\p\idot\schwankerg\d037726\066066Plans.dgn	DRAWN -	REVISED -	REVISED -						615	(116)RS-7	BUREAU	18	13
\$MODELNAME\$	PLOT SCALE = 100.0000' / in.	CHECKED -	REVISED -		CONTRACT NO. 66D66				ILLINOIS FED. AID PROJECT				
	PLOT DATE = 5/1/2015	DATE -	REVISED -		SCALE:	SHEET	OF	SHEETS	STA.	TO	STA.		

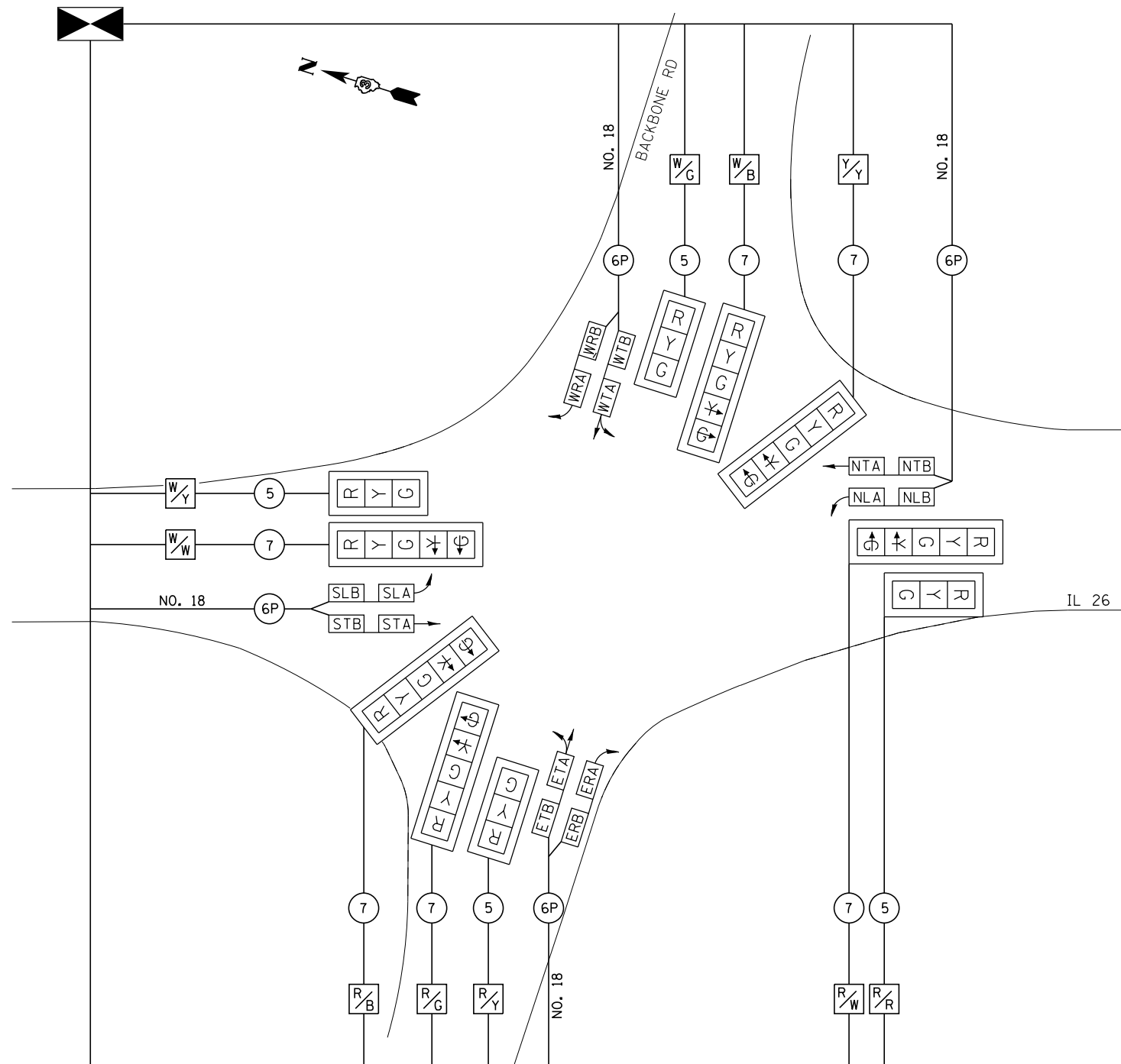

BACKBONE RD

LEGEND



12" SIGNALS WITH BACKPLATES



DETECTOR LOOPS



"R/W" INDICATES COLOR OF ELECTRICAL TAPE USED FOR IDENTIFYING CABLE
 R-RED W-WHITE Y-YELLOW G-GREEN B-BLUE



INDICATES NUMBER OF CONDUCTORS
 ALL CABLE IS NO. 14 EXCEPT AS INDICATED
 "P" INDICATES PAIR CABLE

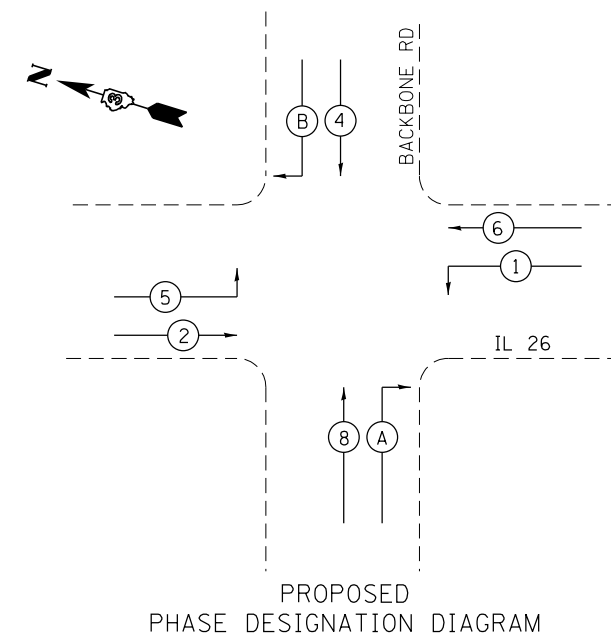

PROPOSED PHASE DESIGNATION DIAGRAM

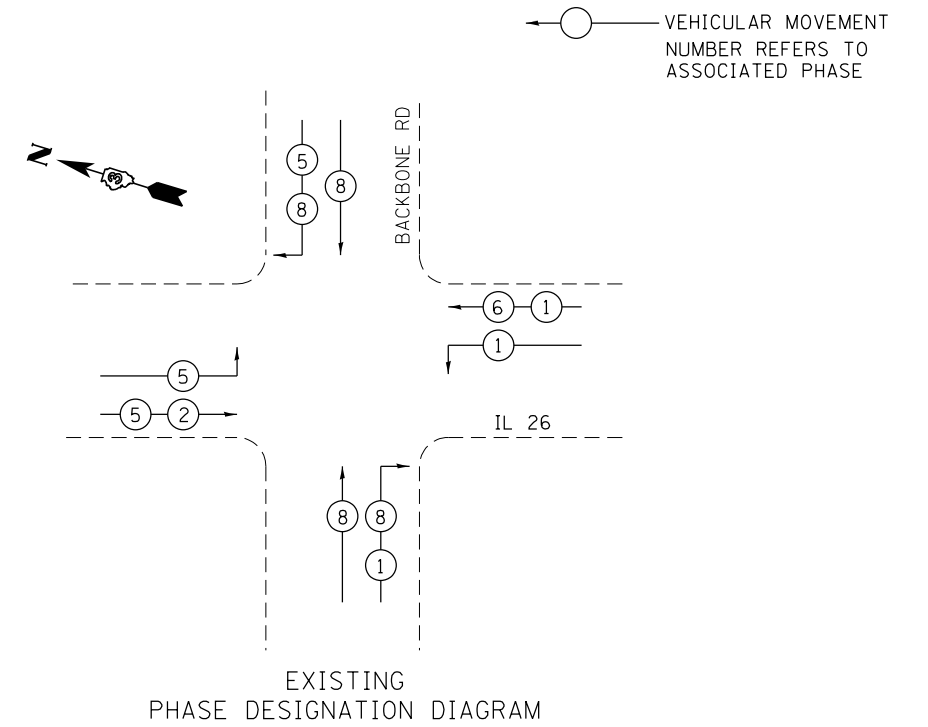

EXISTING PHASE DESIGNATION DIAGRAM

← ○ ← VEHICULAR MOVEMENT NUMBER REFERS TO ASSOCIATED PHASE

FILE NAME =	USER NAME = Schwankerg	DESIGNED -	REVISED -
ei:\pw_work\p\idotschwankerg\d0377726\066066P1ans.dgn		DRAWN -	REVISED -
\$MODELNAME\$	PLOT SCALE = 100.0000' / in.	CHECKED -	REVISED -
	PLOT DATE = 5/1/2015	DATE -	REVISED -

**STATE OF ILLINOIS
 DEPARTMENT OF TRANSPORTATION**

SCALE:	SHEET	OF	SHEETS	STA.	TO	STA.
--------	-------	----	--------	------	----	------

DETECTOR LOOPS

F.A.P. RTE.	SECTION	COUNTY	TOTAL SHEETS	SHEET NO.
615	(116)RS-7	BUREAU	18	14
CONTRACT NO. 66D66			ILLINOIS FED. AID PROJECT	

TABULATION OF QUANTITIES

TOTAL	UNIT	ITEM
4	EACH	SIGNAL HEAD, ALUMINUM, 1-FACE, 3-SECTION, MAST ARM MOUNTED
2	EACH	SIGNAL HEAD, ALUMINUM, 1-FACE, 5-SECTION, BRACKET MOUNTED
4	EACH	SIGNAL HEAD, ALUMINUM, 1-FACE, 5-SECTION, MAST ARM MOUNTED
8	EACH	TRAFFIC SIGNAL BACKPLATE
2	EACH	STRAIGHT RAY LOUVRE, TYPE B FOR 12-INCH LENS
2	EACH	STEEL MAST ARM ASSEMBLY AND POLE, 34 FT
2	EACH	STEEL MAST ARM ASSEMBLY AND POLE, 44 FT
1	EACH	FULL-ACTUATED CONTROLLER, STANDARD SEQUENCE III, 5 PHASES, IN TYPE IV CABINET
6	EACH	INDUCTION LOOP DETECTOR AMPLIFIER
1206	LN FT	DETECTOR LOOP
244	LN FT	GALVANIZED STEEL CONDUIT IN TRENCH 1 1/2"
221	LN FT	GALVANIZED STEEL CONDUIT IN TRENCH 2 1/2"
64	LN FT	GALVANIZED STEEL CONDUIT IN TRENCH 3"
3	LN FT	GALVANIZED STEEL CONDUIT IN TRENCH 3 1/2"
47	LN FT	GALVANIZED STEEL CONDUIT, PUSHED 2 1/2"
27	LN FT	GALVANIZED STEEL CONDUIT, PUSHED 3"
5	LN FT	ELECTRIC CABLE IN CONDUIT NO.8 2/C
654	LN FT	ELECTRIC CABLE IN CONDUIT NO.14 5/C
324	LN FT	ELECTRIC CABLE IN CONDUIT NO.14 7/C
491	LN FT	ELECTRIC CABLE IN CONDUIT NO.18, 6 PAIR, TWISTED SHIELDED
1	EACH	SERVICE INSTALLATION, TYPE A (MODIFIED)
3.5	LN FT	CONCRETE FOUNDATION, TYPE D
50	LN FT	CONCRETE FOUNDATION, TYPE E 30 INCH
4	EACH	CONCRETE HANDHOLE
1	EACH	CONCRETE DOUBLE HANDHOLE
532	LN FT	TRENCH AND BACKFILL
*1	EACH	SPARE MODULE AND SPARE LOAD SWITCH
43.5	SQ FT	SIGN PANEL TYPE I
* NON-PARTICIPATING ITEM		

GENERAL NOTES

- THE EXACT LOCATIONS OF ALL UTILITIES SHALL BE FIELD VERIFIED BY THE CONTRACTOR BEFORE ANY WORK IS STARTED.
- THE EXACT LOCATION OF THE MAST ARM ASSEMBLIES AND THE DETECTOR LOOPS SHALL BE DETERMINED IN THE FIELD BY THE ENGINEER. ALL DETECTOR LOOPS ARE 6'x20' WITH A SPACING OF 10 FEET BETWEEN LOOPS FOR EACH LANE.
- ALL SIGNAL CABLE SHALL BE MARKED WITH ELECTRICAL TAPE FOR IDENTIFICATION PURPOSES AS SHOWN ON THE WIRING DIAGRAM. THIS IDENTIFICATION SHALL BE DONE BOTH IN THE BASE OF THE CONTROLLER CABINET AND IN THE SIGNAL HEAD.
- EACH DETECTOR LOOP SHALL BE MARKED WITH WATERPROOF LABELS USING THE WIRING IDENTIFICATION SHOWN ON THE WIRING DIAGRAM. THIS IDENTIFICATION SHALL BE DONE AT TWO LOCATIONS. THE FIRST LOCATION IS IN THE SPLICE HANDHOLE ADJACENT TO THE DETECTOR LOOPS. THE IDENTIFICATION TAGS SHOULD BE PLACED ON THE DETECTOR LOOP CABLE END RATHER THAN THE PAIRED CABLE END OF THE SPLICE. THE SECOND LOCATION IS ON THE PAIRED CABLE IN THE BASE OF THE CONTROLLER CABINET ADJACENT TO THE TERMINAL FACILITY.
- ALL NEW CONDUIT UNDER THE EXISTING PAVEMENT SHALL BE PUSHED. ALL CONDUIT UNDER THE PROPOSED PAVEMENT WIDENING SHALL BE TRENCHED IN PRIOR TO THE PLACEMENT OF THE WIDENING.
- EACH DETECTOR LOOP SHALL HAVE AN INDIVIDUAL CONDUIT STUB.
- THE DETECTOR LOOP CABLE FROM THE END OF THE SAW CUT IN THE PAVEMENT TO THE SPLICE IN THE HANDHOLE SHALL BE CONSIDERED INCIDENTAL TO THE COST OF THE DETECTOR LOOP.

FOR INFORMATION ONLY
BACKBONE RD EXISTING DETECTOR LOOPS

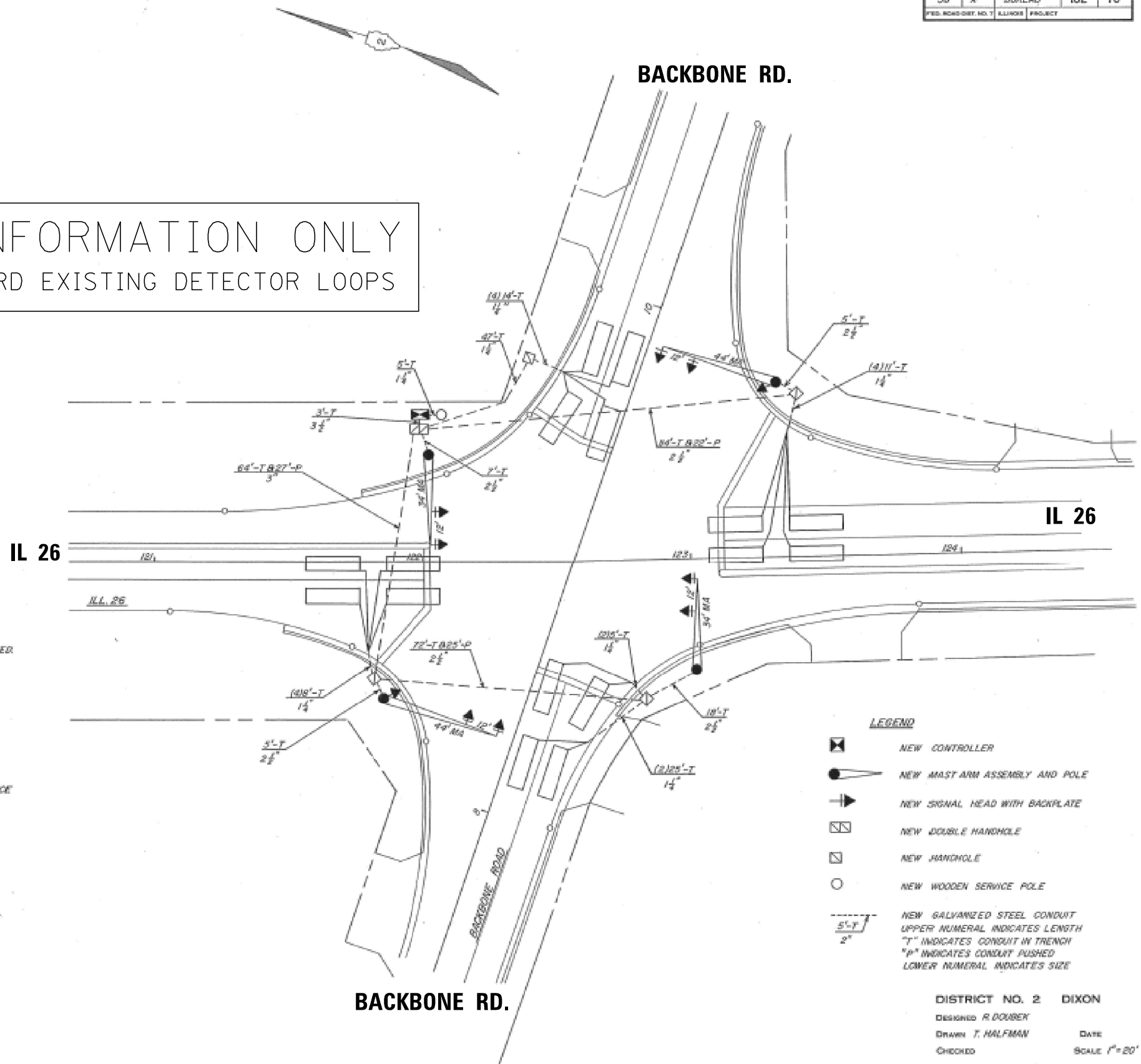

LEGEND

- NEW CONTROLLER
- NEW MAST ARM ASSEMBLY AND POLE
- NEW SIGNAL HEAD WITH BACKPLATE
- NEW DOUBLE HANDHOLE
- NEW HANDHOLE
- NEW WOODEN SERVICE POLE
- NEW GALVANIZED STEEL CONDUIT
UPPER NUMERAL INDICATES LENGTH
"T" INDICATES CONDUIT IN TRENCH
"P" INDICATES CONDUIT PUSHED
LOWER NUMERAL INDICATES SIZE

DISTRICT NO. 2 DIXON
DESIGNED R. DOUBEK
DRAWN T. HALFMAN
CHECKED _____ DATE _____
SCALE 1" = 20'

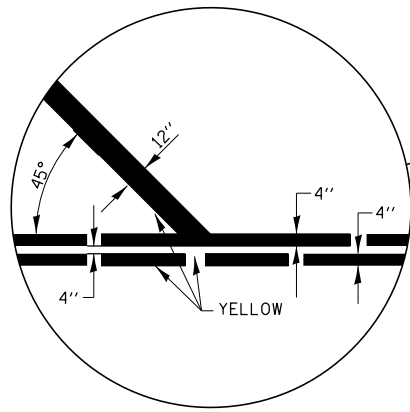
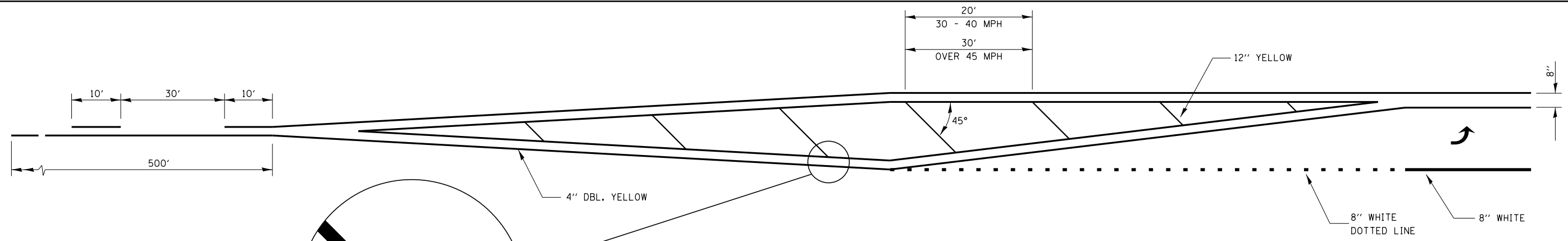

LEFT TURN LANE WITH APPROACH MEDIAN

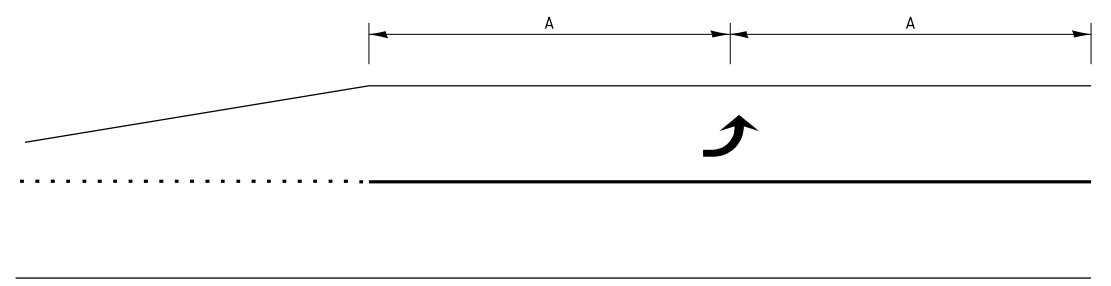

99' AND UNDER

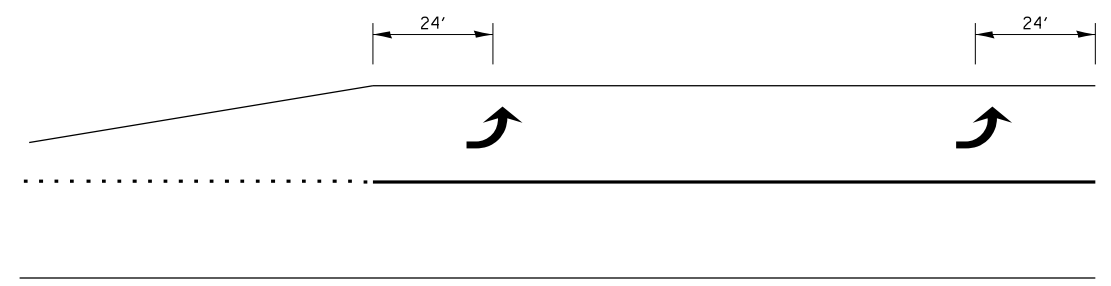

100' TO 149'

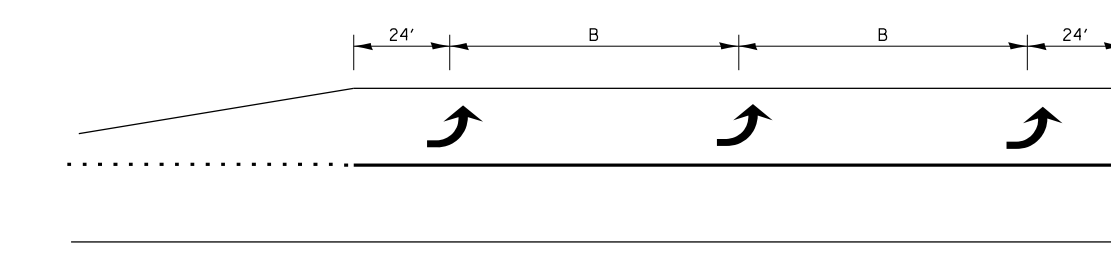

150' AND LONGER

TYPICAL PLACEMENT OF ARROWS IN TURN LANES

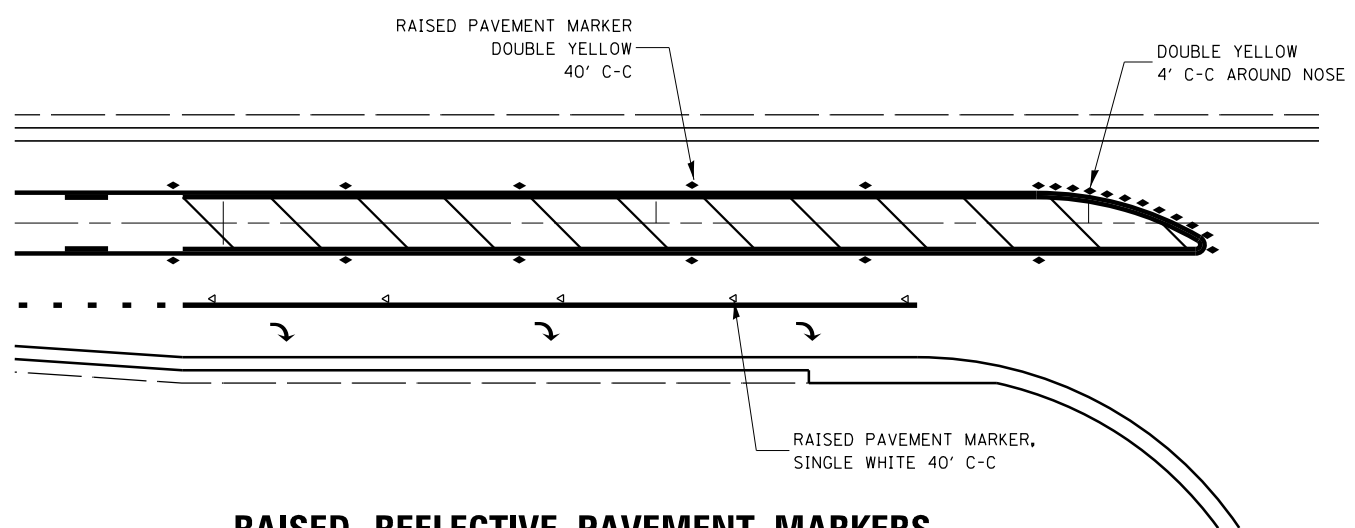

RAISED REFLECTIVE PAVEMENT MARKERS RIGHT TURN LANE

FILE NAME =	USER NAME = Schwankerg	DESIGNED -	REVISED -	STATE OF ILLINOIS DEPARTMENT OF TRANSPORTATION	DETAILS				F.A.P. RTE.	SECTION	COUNTY	TOTAL SHEETS	SHEET NO.
ci:\pw\work\p\idot\schwankerg\d037726\066066P\ans.dgn	DRAWN -	REVISED -	REVISED -						615	(116)RS-7	BUREAU	18	16
\$MODELNAME\$	PLOT SCALE = 100.0000' / in.	CHECKED -	REVISED -		SCALE: SHEET OF SHEETS STA. TO STA.				CONTRACT NO. 66D66				
	PLOT DATE = 5/1/2015	DATE -	REVISED -						ILLINOIS FED. AID PROJECT				

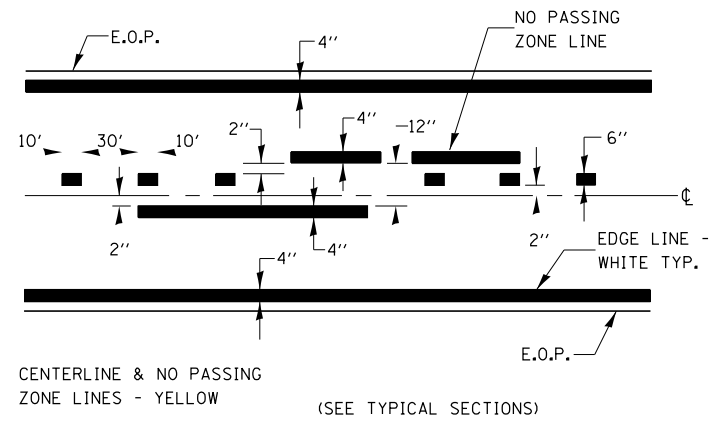

PAVEMENT MARKING

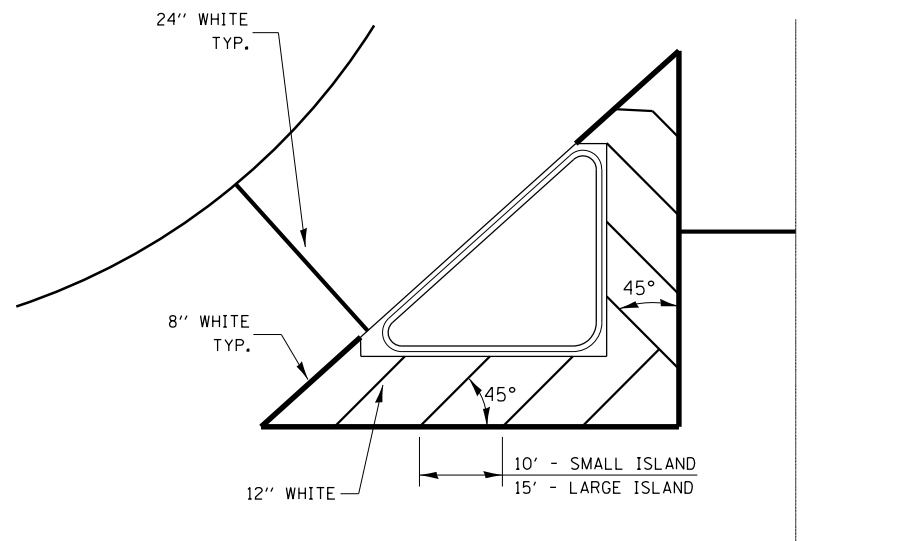

TYPICAL ISLAND

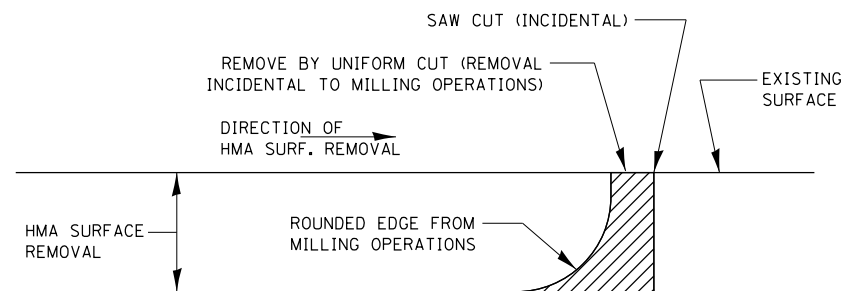

NOTE:
WHEN MILLING OPERATIONS PRODUCE A ROUNDED EDGE, THEN A SAW CUT SHALL BE USED TO MANUFACTURE A PERPENDICULAR EDGE AS SHOWN IN THE DETAIL. THE ENGINEER SHALL BE THE SOLE JUDGE CONCERNING THE USE OF THIS DETAIL

HMA DETAIL AT BUTT JOINTS

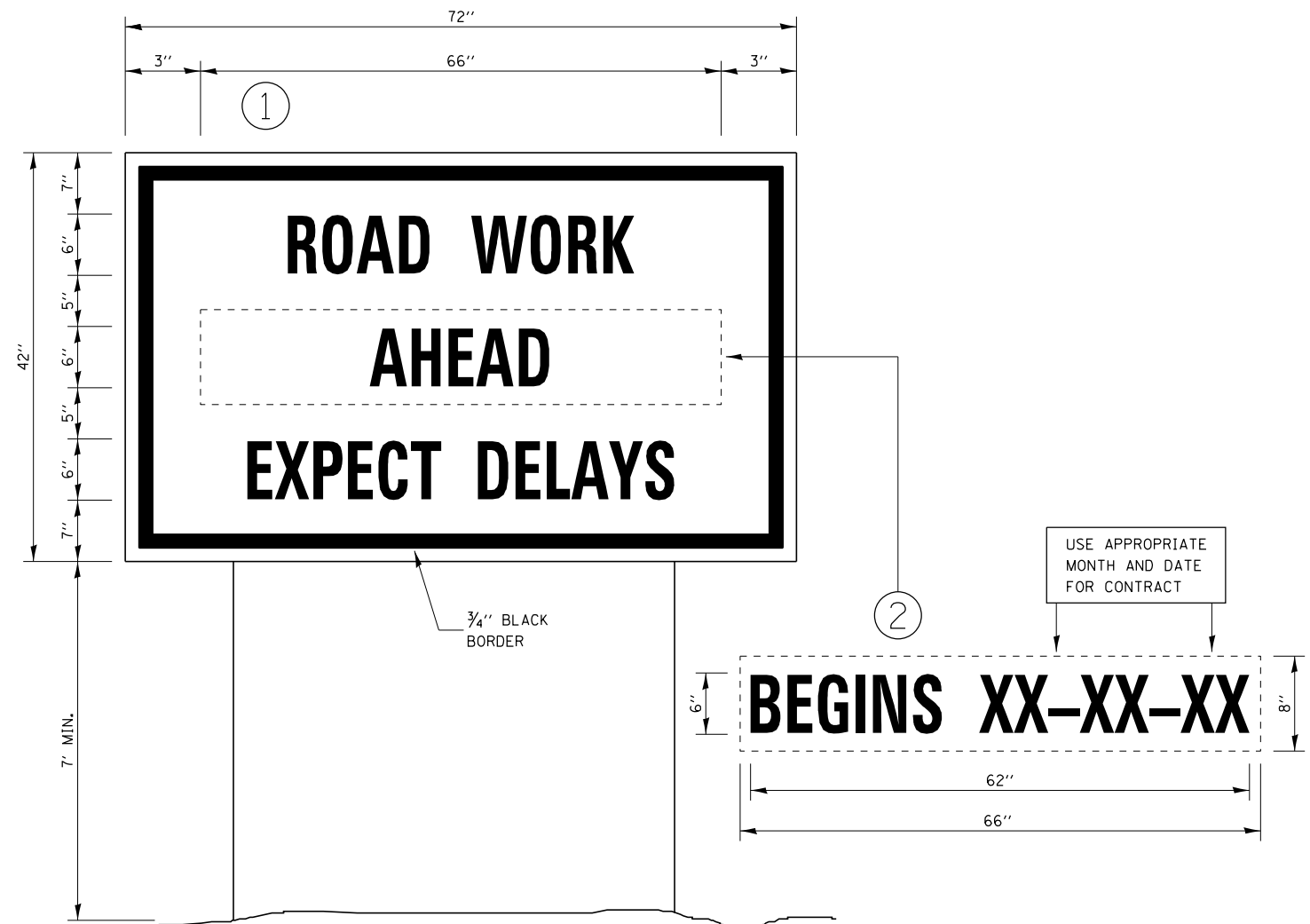

TEMPORARY INFORMATION SIGNING

NOTES:

1. USE 6" D BLACK LETTERING ON FLOURESENT ORANGE BACKGROUND.
2. ERECT SIGNS AT LOCATIONS IN ADVANCE OF THE "ROAD CONSTRUCTION AHEAD" SIGNS AS DIRECTED BY THE ENGINEER.
3. ERECT SIGN ① WITH INSTALLED PANEL ② A MINIMUM OF ONE WEEK PRIOR TO THE START OF THE LANE CLOSURE.
4. REMOVE PANEL ② ON THAT DATE.
5. SEE SPECIAL PROVISION "TEMPORARY INFORMATION SIGNING" FOR ADDITIONAL INFORMATION.
6. WILL BE PAID FOR PER SQ FT AS "TEMPORARY INFORMATION SIGNING". EACH SIGN = 21 SQ FT AND THE DATE PANEL ② WILL NOT BE MEASURED SEPARATELY FOR PAYMENT.

FILE NAME =	USER NAME = Schwankerg	DESIGNED -	REVISED -	STATE OF ILLINOIS DEPARTMENT OF TRANSPORTATION	DETAILS				F.A.P. RTE.	SECTION	COUNTY	TOTAL SHEETS	SHEET NO.
ei:\pw\work\p\idot\schwankerg\d037726\B66D66Plans.dgn		DRAWN -	REVISED -		615	(116)RS-7	BUREAU	18	17				
#MODELNAME#	PLOT SCALE = 100.0000' / 1in.	CHECKED -	REVISED -		CONTRACT NO. 66D66								
	PLOT DATE = 5/1/2015	DATE -	REVISED -		SCALE:	SHEET	OF	SHEETS	STA.	TO	STA.	ILLINOIS FED. AID PROJECT	

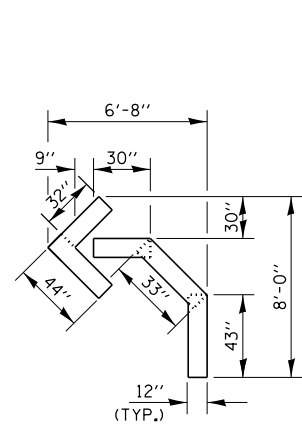

QUANTITY
 12" LINE = 16 LIN. FT.
 OR 4" LINE = 48 LIN. FT.

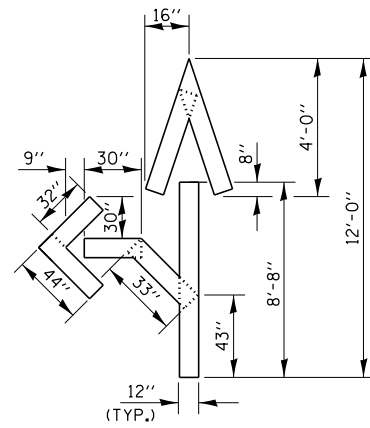

QUANTITY
 12" LINE = 29 LIN. FT.
 OR 4" LINE = 87 LIN. FT.

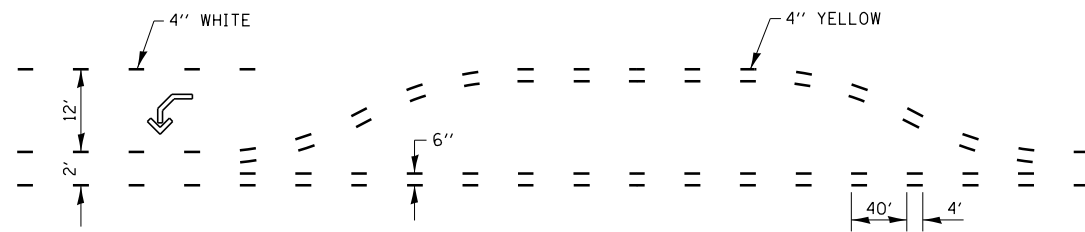

**SHORT-TERM PAVEMENT MARKING
 FOR MEDIANS AND ARROWS**

FILE NAME =	USER NAME = Schwankerg	DESIGNED -	REVISED -
c:\pwork\work\pwork\schwanerg\d037726\B66D66Plans.dgn		DRAWN -	REVISED -
	PLOT SCALE = 100.0000' / in.	CHECKED -	REVISED -
\$MODELNAME\$	PLOT DATE = 5/1/2015	DATE -	REVISED -

**STATE OF ILLINOIS
 DEPARTMENT OF TRANSPORTATION**

DETAILS			
SCALE:	SHEET	OF	SHEETS
	STA.	TO	STA.

F.A.P. RTE.	SECTION	COUNTY	TOTAL SHEETS	SHEET NO.
615	(116)RS-7	BUREAU	18	18
CONTRACT NO. 66D66			ILLINOIS FED. AID PROJECT	