

**STATE OF ILLINOIS**  
**DEPARTMENT OF TRANSPORTATION**  
**DIVISION OF HIGHWAYS**  
**PROPOSED**  
**HIGHWAY PLANS**

**FAU ROUTE 379 (IL 126)**  
**SECTION (119) I-2**  
**PROJECT**  
**SIGHT DISTANCE IMPROVEMENT**  
**KENDALL COUNTY**

C-93-080-15

F.A.U. RTE.	SECTION	COUNTY	TOTAL SHEETS	SHEET NO.
379	(119) I-2	KENDALL	11	1
		ILLINOIS	CONTRACT NO. 66E66	

**INDEX OF SHEETS**

1	COVER SHEET
2	GENERAL NOTES
3-4	SUMMARY OF QUANTITIES
5	TYPICAL SECTIONS
6	SCHEDULES
7	PLAN SHEET AND REMOVAL DETAILS
8	PROFILE
9	DETAILS
10-11	CROSS SECTIONS

**STANDARDS**

000001-06	STANDARD SYMBOLS, ABBREVIATIONS AND PATTERNS
001006	DECIMAL OF AN INCH AND OF A FOOT
482001-02	HMA SHOULDER ADJACENT TO FLEXIBLE PAVEMENT
642006	SHOULDER RUMBLE STRIPS, 8 INCH
701006-05	OFF-ROAD OPERATIONS 2L, 2W, 15' (4.5 m) TO 24" (600 mm) FROM PAVEMENT EDGE
701201-04	LANE CLOSURE, 2L, 2W, DAY ONLY, FOR SPEEDS ≥ 45 MPH
701306-03	LANE CLOSURE, 2L, 2W, SLOW MOVING OPERATIONS DAY ONLY, FOR SPEEDS ≥ 45 MPH
701311-03	LANE CLOSURE, 2L, 2W, MOVING OPERATIONS - DAY ONLY
701326-04	LANE CLOSURE, 2L, 2W, PAVEMENT WIDENING, FOR SPEEDS ≥ 45 MPH
542406-01	METAL END SECTION FOR PIPE ARCHES
701901-04	TRAFFIC CONTROL DEVICES
720001-01	SIGN PANEL MOUNTING DETAILS
720006-04	SIGN PANEL ERECTION DETAILS
781001-03	TYPICAL APPLICATIONS RAISED REFLECTIVE PAVEMENT MARKERS

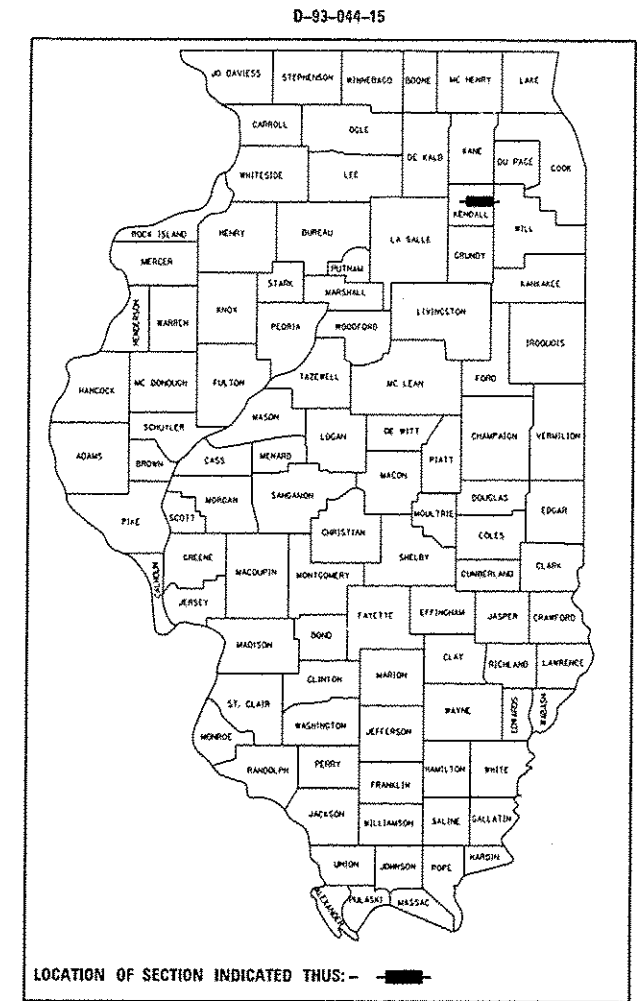

**URBAN MINOR ARTERIAL**  
**2013 ADT = 6150**  
**P.V. = 91.4% S.U. = 2.1% M.U. = 6.5%**

STATE OF ILLINOIS  
 DEPARTMENT OF TRANSPORTATION  
 DIVISION OF HIGHWAYS

SUBMITTED May 21 2015  
Paul A. [Signature]  
 DEPUTY DIRECTOR OF HIGHWAYS, REGION ENGINEER

June 26 2015  
John D. Baranzelle, PE  
 ENGINEER OF DESIGN AND ENVIRONMENT

June 26 2015  
Omer Osman, PE, P.E.  
 DIRECTOR OF HIGHWAYS, CHIEF ENGINEER

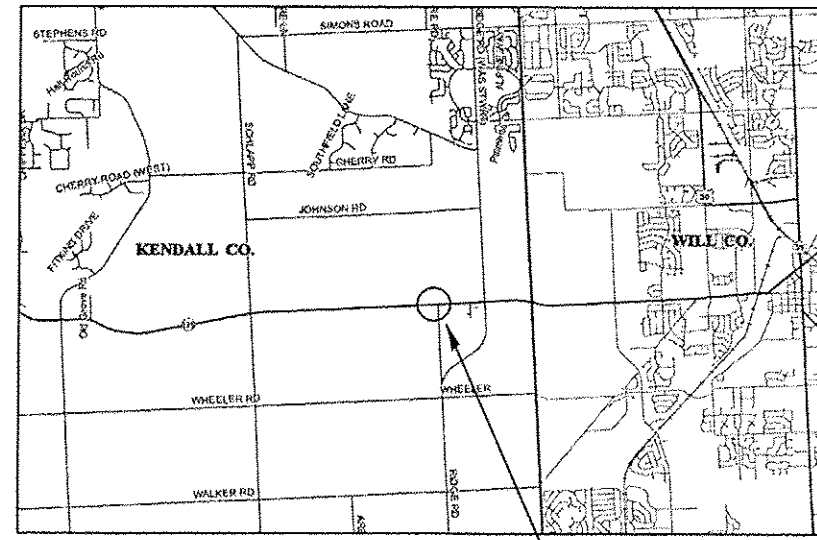

**PROJECT LOCATION**  
 IL 126 AND OLD RIDGE RD  
 STA. 503+00 TO STA. 506+00

GROSS AND NET LENGTH = 300 FT. = 0.057 MILES

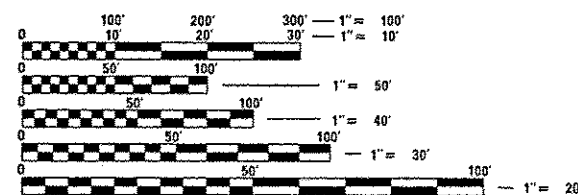

FULL SIZE PLANS HAVE BEEN PREPARED USING STANDARD ENGINEERING SCALES. REDUCED SIZED PLANS WILL NOT CONFORM TO STANDARD SCALES. IN MAKING MEASUREMENTS ON REDUCED PLANS, THE ABOVE SCALES MAY BE USED.

J.U.L.I.E.  
 JOINT UTILITY LOCATION INFORMATION FOR EXCAVATION  
 1-800-892-0123  
 OR 811

**PROJECT ENGINEER: SCOTT FERGUSON, P.E.**  
**UNIT CHIEF: MARC BUDZYNSKI**  
**DISTRICT 3 NO. (815) 434-6131**  
**CONTRACT NO. 66E66**

**PRINTED BY THE AUTHORITY**  
**OF THE STATE OF ILLINOIS**

GENERAL NOTES

THE THICKNESS OF HMA SHOWN ON THE PLANS IS THE NOMINAL THICKNESS. DEVIATIONS FROM THE NOMINAL THICKNESS WILL BE PERMITTED WHEN SUCH DEVIATIONS OCCUR DUE TO IRREGULARITIES IN THE EXISTING SURFACE OR BASE ON WHICH THE HMA IS PLACED.

THE HMA SURFACE OF ALL MAILBOX TURNOUTS, PRIVATE ENTRANCES, COMMERCIAL ENTRANCES, AND SIDE ROADS SHALL BE MADE NEATLY, IN A WORKMANLIKE MANNER, AND SHALL ACCURATELY CONFORM TO THE SHAPES AND DIMENSIONS SHOWN ON THE PLAN DETAILS. IF REQUIRED BY THE ENGINEER, THE CONTRACTOR SHALL SAW CUT THE HMA SURFACE TO CONFORM TO THE SHAPES AND DIMENSIONS SHOWN ON THE PLAN DETAILS. THIS WORK WILL BE INCLUDED IN THE COST OF THE HMA SURFACE.

BEFORE ORDERING PIPE CULVERTS OR PIPE DRAINS, THE CONTRACTOR SHALL CONSULT THE ENGINEER FOR EXACT LENGTHS.

THE ENGINEER WILL BE THE SOLE JUDGE CONCERNING CURING TIME FOR THE VARIOUS HMA LIFTS.

FOR STABILIZATION, ALL TYPE III BARRICADES WILL REQUIRE A MINIMUM OF FOUR SAND BAGS PER BARRICADE.

SEEDING WILL NOT BE PERMITTED AT ANY TIME WHEN THE GROUND IS FROZEN, WET, OR IN AN UNTILLABLE CONDITION. LOCATIONS TO BE SEEDED WILL BE DETERMINED BY THE ENGINEER.

THE FINISHED EARTHWORK SHALL HAVE A VEGETATION SUSTAINING SOIL COVERING THE TOP FOUR INCHES ( 100 MILLIMETERS) IN AREAS TO BE SEEDED OR SODDED. THE VEGETATION SUSTAINING SOIL REQUIRED WILL NOT BE PAID FOR SEPARATELY BUT WILL BE INCLUDED IN THE COST OF EXCAVATING AND GRADING EXISTING SHOULDER.

ALL EXCAVATED MATERIAL, WHICH INCLUDES DIGGING OR GRADING OF ANY SOIL OR FILL MATERIAL, WITH THE EXCEPTION OF AGGREGATE FILLS, MUST BE INCORPORATED WITHIN THE IDOT RIGHT OF WAY DUE TO ENVIRONMENTAL DOCUMENTATION REQUIREMENTS.

ALL ELEVATIONS REFERRING TO U.S.G.S. MEAN SEA LEVEL DATUM.

ANY REFERENCE TO A STANDARD IN THESE PLANS SHALL BE INTERPRETED TO MEAN THE EDITION AS INDICATED BY THE SUBNUMBER SHOWN IN THE LIST OF STANDARDS OR THE COPY INCLUDED IN THESE PLANS.

THE FOLLOWING RATES OF APPLICATION HAVE BEEN USED IN CALCULATING PLAN QUANTITIES:

HMA RESURFACING	112	LBS / SQ YD / IN
GRANULAR MATERIALS	2.05	TONS / CU YD

THE CONTRACTOR SHALL CONTACT JULIE AT LEAST 48 HOURS PRIOR TO EXCAVATION TO DETERMINE WHICH UTILITIES ARE IN THE AREA.

COMMITMENTS:

STATE OF ILLINOIS  
DEPARTMENT OF TRANSPORTATION  
DISTRICT THREE

PREPARED BY: David E. Blawie, Jr.  
DISTRICT STUDIES & PLANS ENGINEER

DATE: MAY 21, 2015

EXAMINED BY: Herb Gray  
DISTRICT CONSTRUCTION ENGINEER

Wynne Phillips  
DISTRICT MATERIALS ENGINEER

Bruce A. Husker  
DISTRICT OPERATIONS ENGINEER

FILE NAME *	USER NAME *	DESIGNED -	REVISED -	<b>STATE OF ILLINOIS DEPARTMENT OF TRANSPORTATION</b>	<b>GENERAL NOTES</b>	F.A.U. RTE.	SECTION	COUNTY	TOTAL SHEETS	SHEET NO.	
p:\11884EBIDINTEC\illinois.gov\PIDOT\Do	ments\DOT Offices\District 3\Projects\036	EDRAW\Dot\B36E06-ht-detailed.dgn	REVISED -			379	(119) 1-2	KENDALL	11	2	
PLOT SCALE *	100.0000' / in.	CHECKED -	REVISED -			CONTRACT NO. 66E66					
PLOT DATE *	5/21/2015	DATE -	REVISED -			ILLINOIS FED. AID PROJECT					
					SCALE:	SHEET OF SHEETS		STA.	TO STA.		

CONSTR. CODE

100%  
STATE

ROADWAY

0005

URBAN

CODE NO.	ITEM	UNIT	TOTAL QUANTITY	ROADWAY
20200600	EXCAVATING AND GRADING EXISTING SHOULDER	UNIT	6	6
40201000	AGGREGATE FOR TEMPORARY ACCESS	TON	2	2
40600275	BITUMINOUS MATERIALS (PRIME COAT)	POUND	407	407
40603335	HOT-MIX ASPHALT SURFACE COURSE, MIX "D", N50	TON	102	102
44004250	PAVED SHOULDER REMOVAL	SO YD	297	297
48203029	HOT-MIX ASPHALT SHOULDERS, 8"	SO YD	297	297
50105220	PIPE CULVERT REMOVAL	FOOT	30	30
542D5470	PIPE CULVERTS, CLASS D, TYPE 1 EQUIVALENT ROUND-SIZE 15"	FOOT	30	30
54215760	METAL END SECTIONS, EQUIVALENT ROUND-SIZE 15"	EACH	2	2
64200108	SHOULDER RUMBLE STRIPS, 8 INCH	FOOT	600	600
67100100	MOBILIZATION	L SUM	1	1
70100450	TRAFFIC CONTROL AND PROTECTION, STANDARD 701201	L SUM	1	1
70100460	TRAFFIC CONTROL AND PROTECTION, STANDARD 701306	L SUM	1	1
70100500	TRAFFIC CONTROL AND PROTECTION, STANDARD 701326	L SUM	1	1

FILE NAME *	USER NAME = budzgnakm	DESIGNED -	REVISED -	<b>STATE OF ILLINOIS DEPARTMENT OF TRANSPORTATION</b>	<b>SUMMARY OF QUANTITIES</b>	F.A.U. RTE.	SECTION	COUNTY	TOTAL SHEETS	SHEET NO.	
pw\11084E01D\TEC\illinois.gov\PI001\Documents\DOT Offices\District 3\Projects\0366	DRAWN Data\0366E66-shr-details.dgn	CHECKED -	REVISED -			379	1191 1-2	KENDALL	11	3	
PLOT SCALE = 100.0000' / 1"	DATE -	REVISED -	REVISED -			CONTRACT NO. 66E66					
PLOT DATE = 5/21/2015	DATE -	REVISED -	REVISED -			ILLINOIS FED. AID PROJECT					
						SCALE:	SHEET NO.	OF	SHEETS	STA. TO STA.	

CONSTR. CODE  
100%  
STATE  
ROADWAY  
0005  
URBAN

CODE NO.	ITEM	UNIT	TOTAL QUANTITY	
70103815	TRAFFIC CONTROL SURVEILLANCE	CAL DA	5	5
70106800	CHANGEABLE MESSAGE SIGN	CAL MO	1	1
* 72000100	SIGN PANEL - TYPE 1	SO FT	4	4
* 72400100	REMOVE SIGN PANEL ASSEMBLY - TYPE A	EACH	3	3
* 78001110	PAINT PAVEMENT MARKING - LINE 4"	FOOT	1200	1200
* 78001130	PAINT PAVEMENT MARKING - LINE 6"	FOOT	150	150
* 78100100	RAISED REFLECTIVE PAVEMENT MARKER	EACH	4	4
78300200	RAISED REFLECTIVE PAVEMENT MARKER REMOVAL	EACH	4	4
89502400	REMOVE EXISTING FLASHING BEACON INSTALLATION COMPLETE	EACH	1	1
X4401198	HOT-MIX ASPHALT SURFACE REMOVAL, VARIABLE DEPTH	SO YD	905	905
X4402800	ISLAND PAVEMENT REMOVAL	SO YD	9	9
Z0030850	TEMPORARY INFORMATION SIGNING	SO FT	42	42

FILE NAME *	USER NAME * budzyskim	DESIGNED -	REVISED -
\\s1\l004EB\INTEG\illinois.gov\PI\DOT\Documents\DOT Offices\Districts\3\Projects\036	\\s1\l004EB\INTEG\illinois.gov\PI\DOT\Documents\DOT Offices\Districts\3\Projects\036	\\s1\l004EB\INTEG\illinois.gov\PI\DOT\Documents\DOT Offices\Districts\3\Projects\036	\\s1\l004EB\INTEG\illinois.gov\PI\DOT\Documents\DOT Offices\Districts\3\Projects\036
PLOT SCALE * 1/8"=1'-0"	CHECKED -	REVISIONS	REVISIONS
PLOT DATE * 5/21/2019	DATE -	REVISIONS	REVISIONS

STATE OF ILLINOIS  
DEPARTMENT OF TRANSPORTATION

SUMMARY OF QUANTITIES

SCALE: SHEET NO. OF SHEETS STA. TO STA.

\*Specialty Items

F.A.D. RTE.	SECTION	COUNTY	TOTAL SHEETS	SHEET NO.
379	1191 I-2	KENDALL	11	4
CONTRACT NO. 66E66			ILLINOIS FED. AID PROJECT	

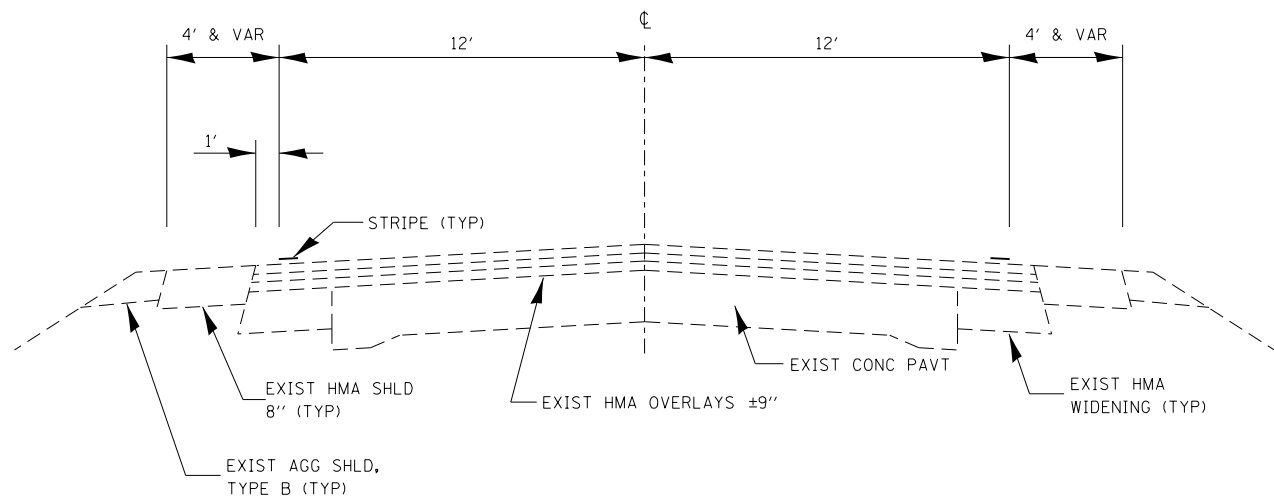

**EXISTING TYPICAL SECTION – IL 126**

STA 503+00 TO STA 506+00

HMA MIXTURE REQUIREMENT TABLE			
LOCATION(S):	STA. 503+00 TO STA. 506+00		
MIXTURE USE(S):	SURFACE COURSE	SHOULDER BOTTOM LIFT(S)	SHOULDER TOP LIFT (2'')
BINDER GRADE (PG):	PG 64-22	PG 64-22	PG 64-22
DESIGN AIR VOIDS:	4.0% @ N50	4.0% @ N50	4.0% @ N50
MIXTURE COMPOSITION: (MIXTURE GRADATION)	IL 9.5	IL-19.0 FG	IL-9.5
FRICTION AGGREGATE:	MIXTURE D	-	MIXTURE D
MIXTURE WEIGHT:	112.0 LB/SY/IN	112.0 LB/SY/IN	112.0 LB/SY/IN
QUALITY MANAGEMENT PROGRAM:	QC/OA	QC/OA	QC/OA
SUBLOT SIZE:	N/A	N/A	N/A
DENSITY TEST METHOD:	CORES	CORES	CORES

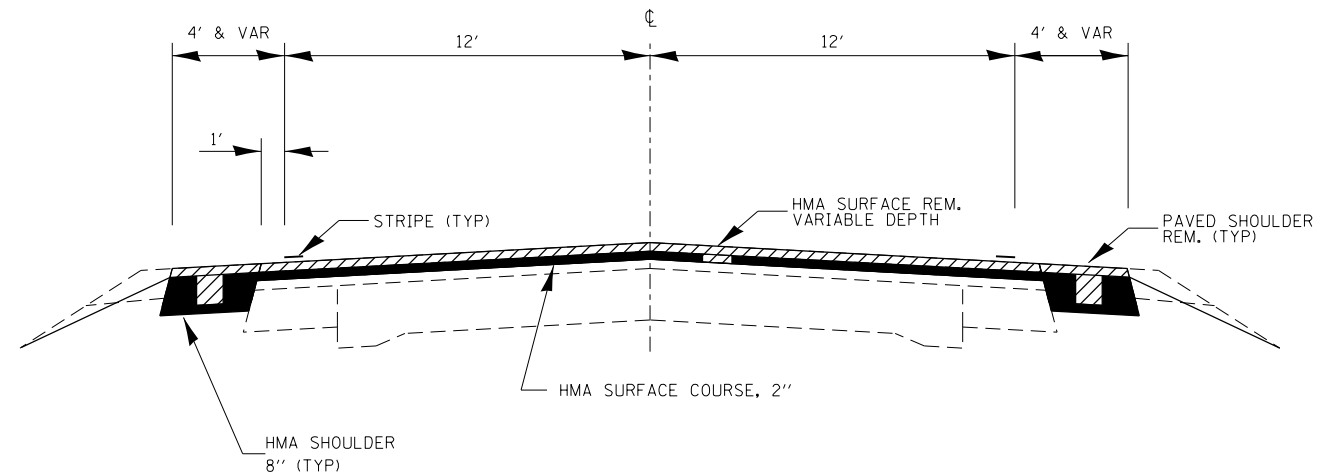

 HMA REMOVAL  
 PROPOSED HMA

**PROPOSED TYPICAL SECTION – IL 126**





STA 503+00 TO STA 506+00

SHOULDER AND RESURFACING SCHEDULE							
LOCATION	HMA SURFACE COURSE 2"	BIT MATLS PRIME COAT	HMA SHOULDER 8"	SHOULDER RUMBLE STRIPS 8"	PAVED SHOULDER REMOVAL	HMA SURF. REMOVAL VAR DEPTH	EXCAVATING AND GRADING EXIST. SHLD
	TON	POUND	SQ YD	FOOT	SQ YD	SQ YD	UNIT
STA. 503+00 TO STA. 506+00	102	407	297	600	297	905	6
<b>TOTAL</b>	<b>102</b>	<b>407</b>	<b>297</b>	<b>600</b>	<b>297</b>	<b>905</b>	<b>6</b>

PAVEMENT MARKING SCHEDULE				
LOCATION	PAINT PAVEMENT MARKINGS TWO APPLICATIONS		RAISED REF PVT MKR (AMBER) EACH	RAISED REF PVT MKR REM EACH
	4" WHITE FOOT	6" YELLOW FOOT		
	STA. 503+00 TO STA. 506+00 EDGELINES CENTERLINE	1200	150	4
<b>TOTAL</b>	<b>1200</b>	<b>150</b>	<b>4</b>	<b>4</b>

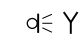
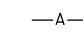
PROFILE AND MILLING DETAILS				
STATION	EXISTING ELEVATION	PROP ELEV - FINISHED GRADE	PROP ELEV - MILLED GRADE	HMA TO BE MILLED (FEET)
503+00	649.03	649.03	648.86	0.17
503+25	649.93	649.92	649.75	0.18
503+50	650.84	650.75	650.58	0.26
503+75	651.75	651.54	651.37	0.38
504+00	652.66	652.28	652.11	0.55
504+25	653.32	652.96	652.79	0.53
504+50	653.98	653.60	653.43	0.55
504+75	654.64	654.19	654.02	0.62
505+00	655.19	654.72	654.55	0.64
505+25	655.49	655.21	655.04	0.45
505+50	655.79	655.65	655.48	0.31
505+75	656.09	656.03	655.86	0.23
506+00	656.37	656.37	656.20	0.17

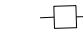
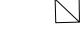

-  EXISTING FLASHING BEACON  
SPAN WIRE MOUNTED (ALL RED) TBR
-  EXISTING SIGN WITH WITH FLASHER (YELLOW) TBR
-  EXISTING ELECTRICAL CABLE AERIAL SUSPENDED TBR
-  EXISTING 34' STEEL STRAIN POLE TBR
-  EXISTING SERVICE INSTALLATION
-  EXISTING HANDHOLE
-  EXISTING SPLICEBOX

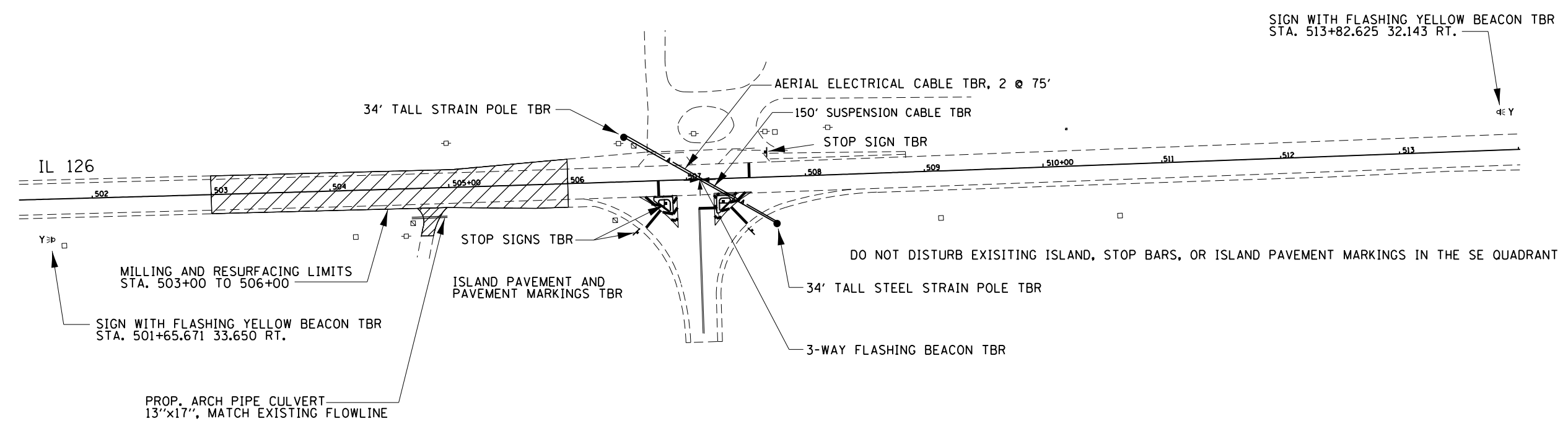

NOTE: ALL OF THE SIGNAL EQUIPMENT AND SIGNS THAT ARE REMOVED AS A PART OF THIS CONTRACT SHALL BE DELIVERED BY THE CONTRACTOR TO THE ILLINOIS DEPARTMENT OF TRANSPORTATION MAINTENENCE YARD IN YORKVILLE. ALL OTHER ITEMS SHALL BE REMOVED FROM IDOT ROW AND BECOME THE PROPERTY OF THE CONTRACTOR.

FILE NAME =	USER NAME = budzynskim	DESIGNED -	REVISED -	<b>STATE OF ILLINOIS DEPARTMENT OF TRANSPORTATION</b>	<b>PLAN SHEET AND REMOVAL DETAILS</b>	F.A.U. RTE.	SECTION	COUNTY	TOTAL SHEETS	SHEET NO.	
pw:\IL\084EBID\INTEG.illinois.gov\PIWIDOT\Documents\IDOT Offices\District 3\Projects\0366\BROWND\B366E66-shit-details.dgn						379	(119) I-2	KENDALL	11	7	
PLOT SCALE = 100.0000' / in.						CHECKED -	REVISED -	CONTRACT NO. 66E66			
PLOT DATE = 5/21/2015						DATE -	REVISED -	ILLINOIS FED. AID PROJECT			
SCALE:						SHEET NO. OF SHEETS		STA. TO STA.			

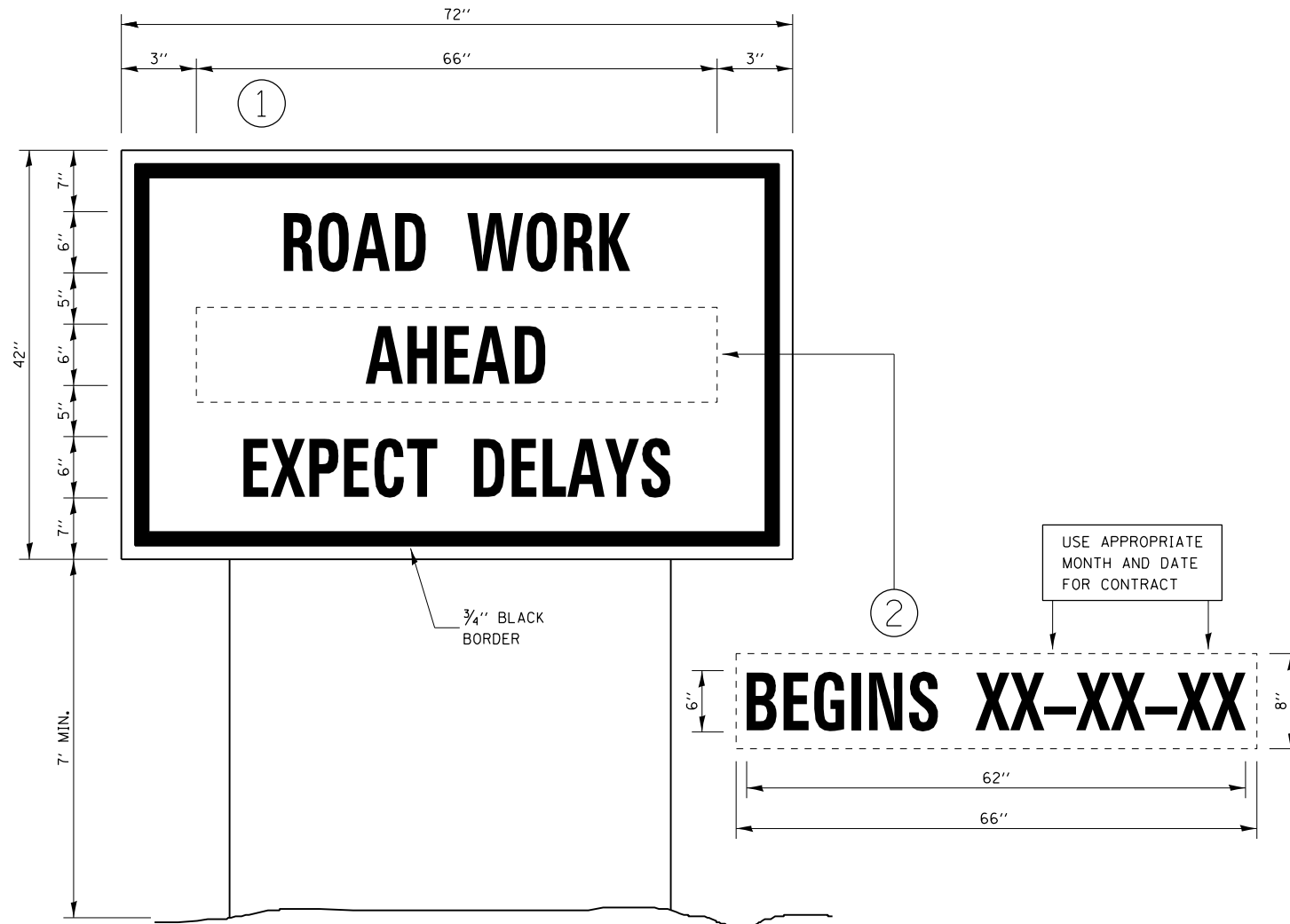

**TEMPORARY INFORMATION SIGNING**

**NOTES:**

1. USE 6" D BLACK LETTERING ON FLOURESENT ORANGE BACKGROUND.
2. ERECT SIGNS AT LOCATIONS IN ADVANCE OF THE "ROAD CONSTRUCTION AHEAD" SIGNS AS DIRECTED BY THE ENGINEER.
3. ERECT SIGN ① WITH INSTALLED PANEL ② A MINIMUM OF ONE WEEK PRIOR TO THE START OF THE LANE CLOSURE.
4. REMOVE PANEL ② ON THAT DATE.
5. SEE SPECIAL PROVISION "TEMPORARY INFORMATION SIGNING" FOR ADDITIONAL INFORMATION.
6. WILL BE PAID FOR PER SQ FT AS "TEMPORARY INFORMATION SIGNING". EACH SIGN = 21 SQ FT AND THE DATE PANEL ② WILL NOT BE MEASURED SEPARATELY FOR PAYMENT.

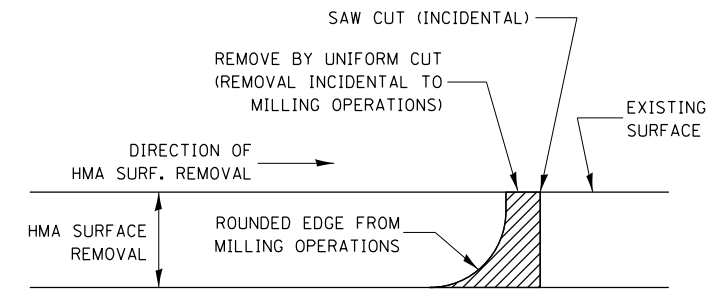

NOTE:  
WHEN MILLING OPERATIONS PRODUCE A ROUNDED EDGE, THEN A SAW CUT SHALL BE USED TO MANUFACTURE A PERPENDICULAR EDGE AS SHOWN IN THE DETAIL. THE ENGINEER SHALL BE THE SOLE JUDGE CONCERNING THE USE OF THIS DETAIL.

**HMA DETAIL AT BUTT JOINTS**

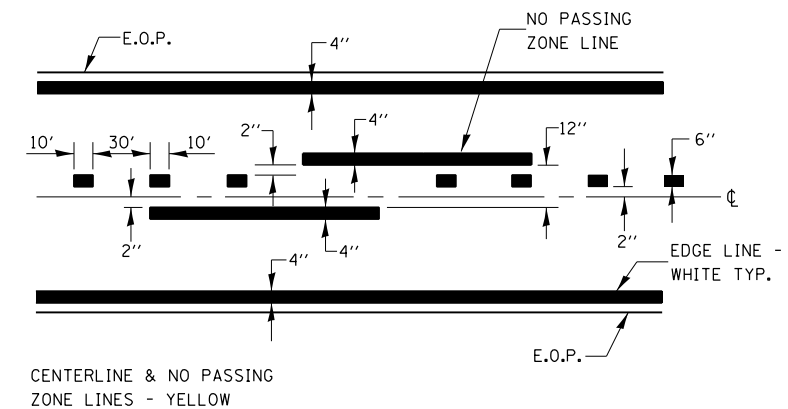

**PAVEMENT MARKING**

FILE NAME =	USER NAME = budzynskim	DESIGNED -	REVISED -	<b>STATE OF ILLINOIS DEPARTMENT OF TRANSPORTATION</b>	<b>DETAILS</b>			F.A.U. RTE.	SECTION	COUNTY	TOTAL SHEETS	SHEET NO.
p:\11\084EBIDINTEG.illinois.gov\PIWIDOT\Documents\IDOT Offices\District 3\Projects\036666\B366E66-sht-details.dgn	PLotted SCALE = 100.0000' / in.	CHECKED -	REVISED -					379	(119) I-2	KENDALL	11	8
	PLOT DATE = 5/21/2015	DATE -	REVISED -		SCALE: SHEET NO. OF SHEETS STA. TO STA.			CONTRACT NO. 66E66				
											ILLINOIS FED. AID PROJECT	



PLAN	SURVEYED	BY	DATE
	PLOTTED		
	NOTE BOOK NO.		
	CHECKED		
	FILE NAME		

PROFILE	SURVEYED	BY	DATE
	PLOTTED		
	NOTE BOOK NO.		
	CHECKED		
	FILE NAME		

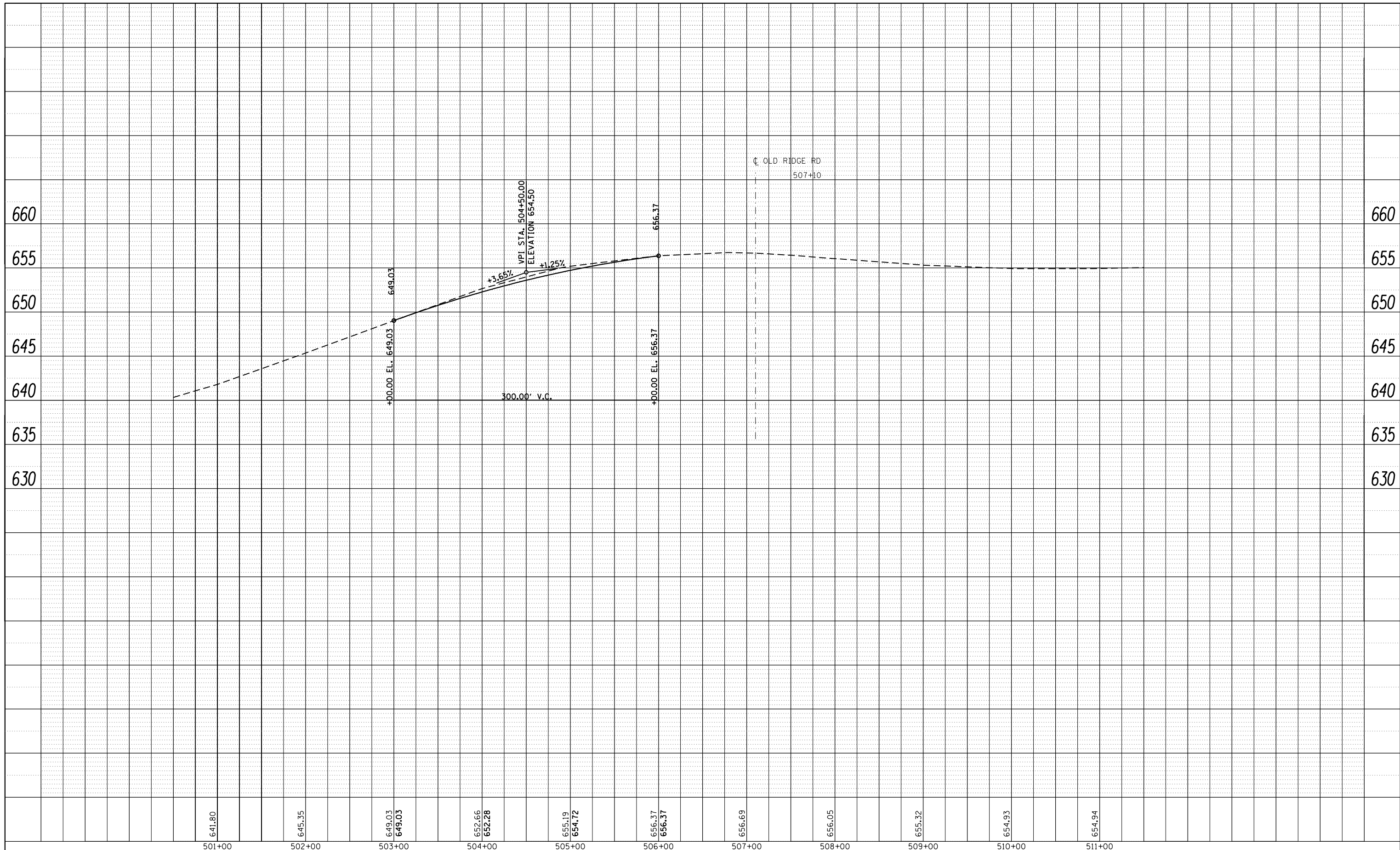

FILE NAME =	USER NAME = budzynskim	DESIGNED -	REVISED -
\\JL084EBIDINTEG.allinois.gov\PIWIDOT\Documents\DOT Offices\District 3\Projects\366E66\Drawings\366E66-sht-details.dgn		DRAWN -	REVISED -
Default	PLOT SCALE = 100.0000' / 1" =	CHECKED -	REVISED -
	PLOT DATE = 5/21/2015	DATE -	REVISED -

**STATE OF ILLINOIS  
DEPARTMENT OF TRANSPORTATION**

<b>PROFILE</b>	
SCALE:	SHEET OF SHEETS STA. TO STA.

F.A.U. RTE.	SECTION	COUNTY	TOTAL SHEETS	SHEET NO.
379	(119) I-2	KENDALL	11	9
CONTRACT NO. 66E66				
ILLINOIS FED. AID PROJECT				

ORIGINAL SURVEY	SURVEYED	BY	DATE
NOTE BOOK	PLOTTED		
	TEMPLATE		
	AREAS		
	AREAS CHECKED		

FINAL SURVEY	SURVEYED	BY	DATE
NOTE BOOK	PLOTTED		
	TEMPLATE		
	AREAS		
	AREAS CHECKED		

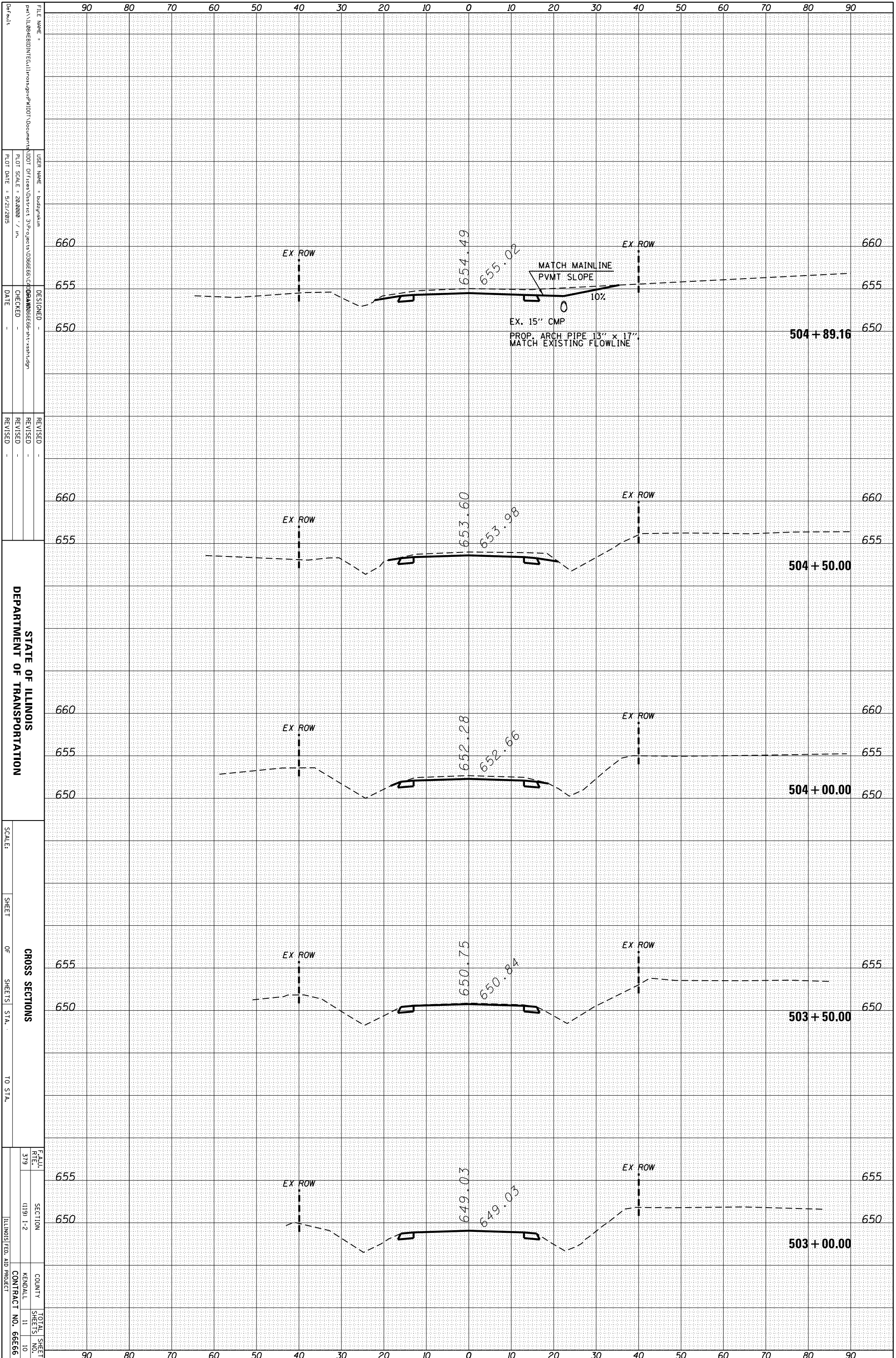

FILE NAME:   
 USER NAME:   
 PLOT SCALE:   
 PLOT DATE:   
 DESIGNED:   
 CHECKED:   
 DATE:

REVISED:   
 REVISED:   
 REVISED:

STATE OF ILLINOIS   
 DEPARTMENT OF TRANSPORTATION

SCALE:   
 SHEET OF SHEETS STA. TO STA.

CROSS SECTIONS   
 ELEV. REVISION:   
 SECTION:   
 COUNTY:   
 KENDALL   
 CONTRACT NO. 66E66

ORIGINAL SURVEY	SURVEYED	BY	DATE
NOTE BOOK	PLOTTED		
	TEMPLATE		
	AREAS		
	AREAS CHECKED		

FINAL SURVEY	SURVEYED	BY	DATE
NOTE BOOK	PLOTTED		
	TEMPLATE		
	AREAS		
	AREAS CHECKED		

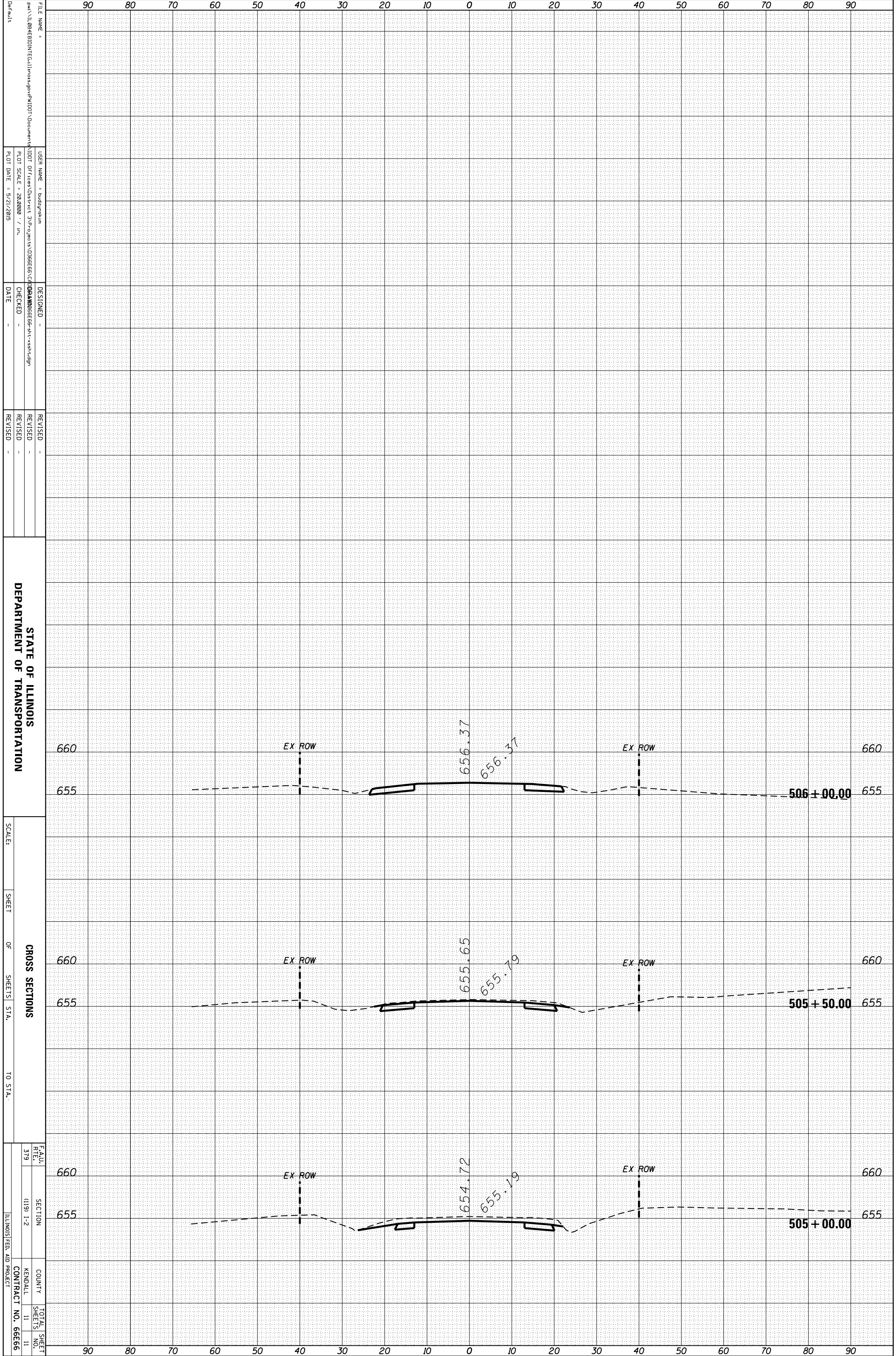

FILE NAME :  
 USER NAME :  
 DESIGNED :  
 CHECKED :  
 DATE :  
 REVISIONS :  
 REVISIONS :  
 REVISIONS :

STATE OF ILLINOIS  
 DEPARTMENT OF TRANSPORTATION

CROSS SECTIONS  
 SCALE :  
 SHEET OF SHEETS STA. TO STA.

FEAU. RTU. 319  
 SECTION (119) 1-2  
 COUNTY KENDALL  
 CONTRACT NO. 66E66  
 TOTAL SHEET NO. 11