

# SCHOOLHOUSE TRAIL CONNECTOR PHASE 1

**MARYVILLE, ILLINOIS**  
**PROJECT NO TE-0008(147)**  
**SECTION NO. 10-00019-00-SW**  
**MADISON COUNTY**  
**JOB NO C-98-363-10**

INDEX OF SHEETS

SHEET NUMBER	DESCRIPTION
1	COVER SHEET
2	GENERAL NOTES AND LEGEND
3	SUMMARY OF QUANTITIES
4	TYPICAL SECTIONS - EXISTING
5-6	TYPICAL SECTIONS - PROPOSED
7-8	QUANTITY SCHEDULES
9	PLAN AND PROFILE SHEETS
10	ADVANCE WARNINGS
11	STAGE CONSTRUCTION
12	MISCELLANEOUS DETAILS
13-14	CROSS SECTIONS

STANDARDS

STD. NO.	
000001-06	604001-04
001006	604036-03
280001-07	701001-02
542301-03	701006-05
602301-04	701901-04
602306-03	720001-01
602601-03	720006-04
602701-02	8.L.R. 17-4

SCALES  
 PLAN 1" = 20'  
 PROFILE HORIZ. 1" = 20'  
 PROFILE VERT. 1" = 5'  
 CROSS SECTIONS 1" = 10' HORIZ.  
 1" = 5' VERT.

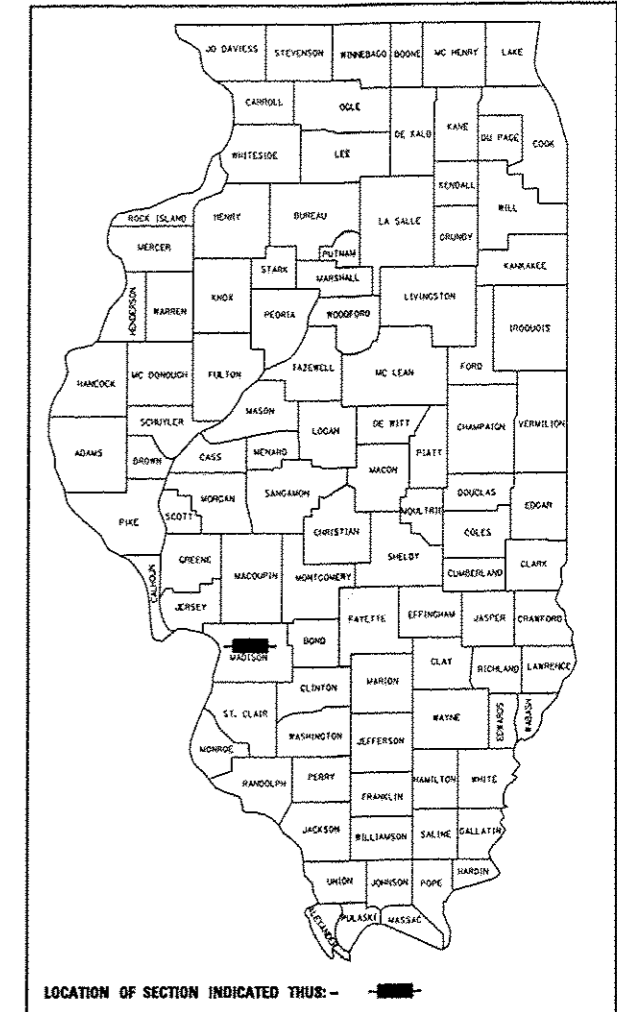

LOCATION OF SECTION INDICATED THUS: - [Black Box] -

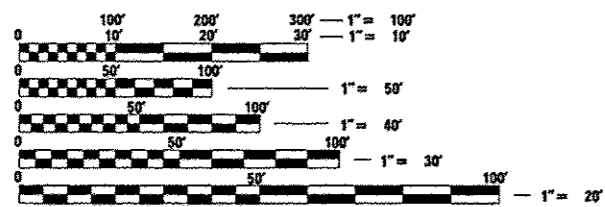

FULL SIZE PLANS HAVE BEEN PREPARED USING STANDARD ENGINEERING SCALES. REDUCED SIZED PLANS WILL NOT CONFORM TO STANDARD SCALES. IN MAKING MEASUREMENTS ON REDUCED PLANS, THE ABOVE SCALES MAY BE USED.

J.U.L.I.E.  
 JOINT UTILITY LOCATION INFORMATION FOR EXCAVATION  
 1-800-892-0123  
 OR 811

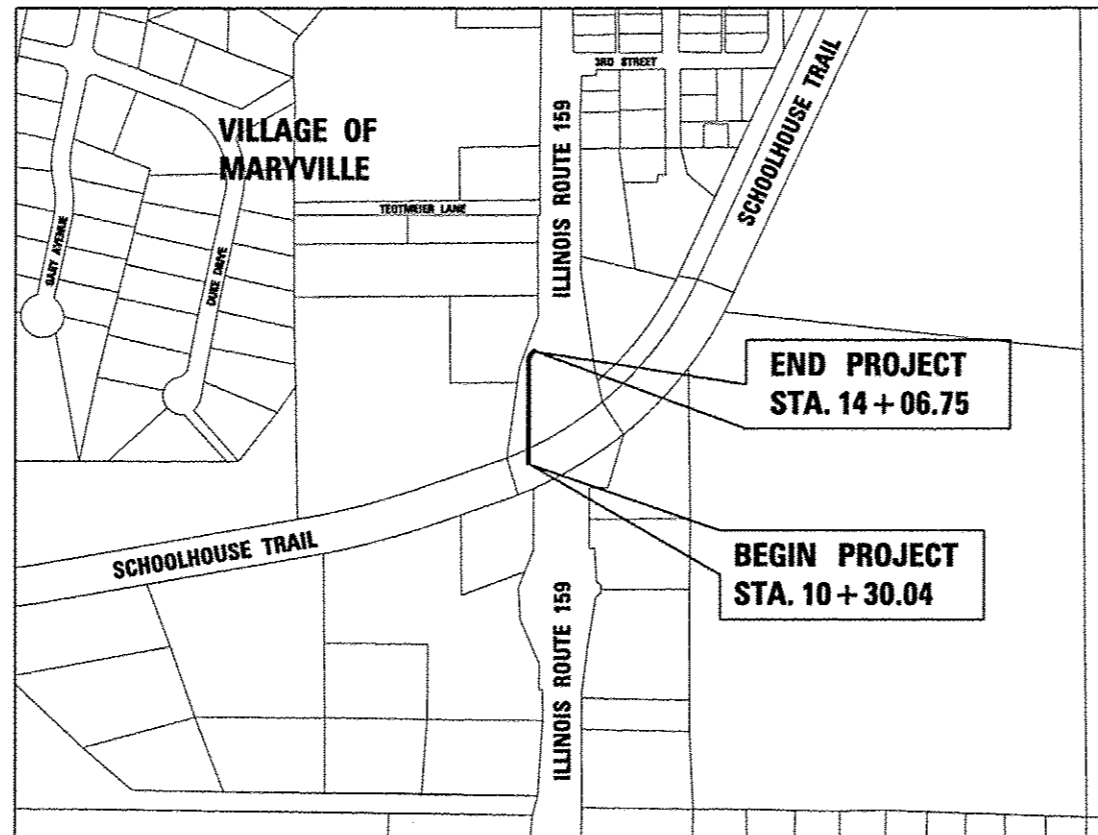

LOCATION MAP

SCALE: 1" = 250'

NET LENGTH OF PROJECT: 487.00 FEET - 0.09 MILES  
 SECTION 11, T. 3 N., R. 8 W., 3RD P.M.



STATE OF ILLINOIS DEPARTMENT OF TRANSPORTATION  
 DIVISION OF HIGHWAYS

Approved: *[Signature]*  
 Village of Maryville, Mayor

Passed: *[Signature]*  
 District 8 Engineer of Local Roads & Streets

Releasing for Bid Based on Limited Review: *[Signature]*  
 Deputy Director of Highways, Region 6 Engineer

PRINTED BY THE AUTHORITY OF THE STATE OF ILLINOIS

*[Signature]*  
 BRIAN F. KULICK, P.E. No. 49936  
 (Printed by Authority of the State of Illinois)  
 Job No. E110713



Expires 11-30-15



2100 State Street, P.O. Box 1326, Granite City, IL 62040  
 618-877-1400 F. 618-462-5641  
 100 North Research Drive, Edwardsville, IL 62025  
 618-659-0900 F. 618-659-0941  
 330 N. Fourth Street, Suite 200, St. Louis, MO 63102  
 314-241-4444 F. 314-909-1331  
 Professional Design Firm License No. 184.003389

LEGEND

	EVERGREEN (5" DIA)		FOUND CONCRETE MONUMENT		WOOD POST
	DECIDUOUS (8" DIA)		WATER METER		WATER LINE
	EVERGREEN SHRUB		GAS METER		GAS LINE
	SHRUB		WATER VALVE		OVERHEAD ELECTRIC LINE
	FIRE HYDRANT		GAS VALVE		TELEPHONE LINE
	SIGN	(TBA)	TO BE ADJUSTED		CABLE TV LINE
	BOLLARD	(TBR)	TO BE REMOVED		STORM SEWER
	POWER POLE	(TBR&R)	TO BE REMOVED & RELOCATED		SANITARY SEWER
	POWER POLE WITH DOWN GUY	(TBRBO)	TO BE REMOVED BY OTHERS		LIGHT POLE
	FENCE	(TBR&RBO)	TO BE REMOVED & RELOCATED BY OTHERS		STORM SEWER MANHOLE
	BENCH MARK	DND	DO NOT DISTURB		SANITARY SEWER MANHOLE
	DITCH/SWALE		PROPERTY LINE		CATCH BASIN
	EXISTING MAILBOX		EXIST R.O.W. LINE		INLET

GENERAL NOTES:

- ILLINOIS STATE LAW REQUIRES A 48-HR NOTICE BE GIVEN TO ALL UTILITIES BEFORE DIGGING. FIELD MARKING OF FACILITIES MAY BE OBTAINED BY CONTACTING J.U.L.I.E. OR FOR NON-J.U.L.I.E. MEMBERS, THE UTILITY COMPANY DIRECTLY, AGENCIES KNOWN TO HAVE FACILITIES WITHIN THE PROJECT AREA ARE AS FOLLOWS:
  - VILLAGE OF MARYVILLE  
2520 NORTH CENTRE STREET  
MARYVILLE, ILLINOIS 62062  
(618)345-7027  
ATTN: PATRICK PRESSON
  - AMEREN IP  
2600 NORTH CENTER STREET  
P.O. BOX 378, MC 0-10  
MARYVILLE, ILLINOIS 62062  
(618) 346-1228  
ATTN: TOM EPPERSON
  - AT&T  
203 GOETHE AVENUE  
COLLINSVILLE, ILLINOIS 62234  
(618)346-6494  
ATTN: JANET BURNS
  - CHARTER COMMUNICATIONS, INC  
941 CHARTER COMMONS  
TOWN & COUNTRY, MISSOURI 63017  
(636)220-2174  
ATTN: LARRY SAAFIR
  - SOUTHWEST ELECTRIC COOP.  
10103 ELLIS ROAD  
ST. JACOB, IL 62281  
ATTN: BEN WILES
  - AMEREN IP  
370 S. MAIN STREET  
DECATUR, ILLINOIS 62523  
(217)424-6600
  - NATURAL GAS PIPELINE  
7501 HUEY ROAD  
CENTRALIA, ILLINOIS 62801  
ATTN: ROBERT MOODY
  - ILLINOIS AMERICAN WATER COMPANY  
2000 WEST 24TH STREET  
GRANITE CITY, ILLINOIS 62040  
(618)876-0011  
ATTN: RON BEARD
- (MEMBERS OF J.U.L.I.E. (800) 892-0123 ARE INDICATED BY \*. NON-J.U.L.I.E. MEMBERS MUST BE NOTIFIED INDIVIDUALLY.)
- FOR UTILITY LOCATION PURPOSES, THIS PROJECT IS LOCATED IN SECTION 11 OF TOWNSHIP 3 NORTH, RANGE 8 WEST OF THE THIRD PRINCIPAL MERIDIAN.
- TREES SHALL BE PRESERVED THROUGHOUT THIS SECTION AS SHOWN ON THE PLANS AND AS DIRECTED BY THE ENGINEER.
- THE CONTRACTOR SHALL ADJUST WATER VALVES, WATER METERS, GAS VALVES, GAS METERS AND OTHER ITEMS LOCATED WITHIN THE CONNECTOR CORRIDOR TO MATCH THE PROPOSED CONCRETE SURFACE. THIS WORK SHALL BE CONSIDERED INCLUDED IN THE CONTRACT AND NO ADDITIONAL COMPENSATION WILL BE ALLOWED.
- ALL AREAS DISTURBED WITHIN CONSTRUCTION LIMITS FOR ANY REASON SHALL BE SEEDED WITH CLASS 1 SEEDING AND MULCH, AS DIRECTED BY THE ENGINEER. NUTRIENTS SHALL CONFORM TO ARTICLE 250.04 AND WILL BE PAID FOR SEPARATELY. ALL AREAS THAT ARE DISTURBED OUTSIDE THE CONSTRUCTION LIMITS SHALL BE SEEDED AT THE CONTRACTORS EXPENSE.
- THE CONTRACTOR SHALL BE REQUIRED TO PERFORM SAWCUTTING AT THE EXISTING PAVEMENT, EXISTING WIDENING, OR EXISTING SHOULDER EDGE THROUGHOUT THE PROJECT LIMITS IN ORDER TO PERFORM REMOVAL OPERATIONS. THIS SAWING WILL NOT BE PAID FOR SEPARATELY, BUT WILL BE INCLUDED IN THE COST FOR THE REMOVAL ITEM INVOLVED.
- THE CONTRACTOR SHALL VERIFY ALL DIMENSIONS AND CONDITIONS IN THE FIELD PRIOR TO CONSTRUCTION AND ORDERING OF MATERIALS.
- ALL MANHOLE AND INLET LOCATIONS NOTED IN THE PLANS REFER TO THE CENTER OF THE BARREL SECTION OF THE STRUCTURES.

- THE FOLLOWING CONSTANTS WERE USED IN THE CALCULATION OF QUANTITIES FOR THIS PROJECT:
  - NITROGEN FERTILIZER NUTRIENTS 90 LBS/ACRE
  - PHOSPHORUS FERTILIZER NUTRIENTS 90 LBS/ACRE
  - POTASSIUM FERTILIZER NUTRIENTS 90 LBS/ACRE
  - GRANULAR MATERIALS 2.05 TONS/C.Y.

- "TRAIL CONSTRUCTION AHEAD" SIGNS (48"x48") SHALL BE PLACED AT THE BEGINNING AND END OF THE PROJECT PLUS THE INTERSECTING TRAIL, AND WILL BE CONSIDERED INCLUDED IN THE TRAFFIC CONTROL PAY ITEMS, ALL CONSTRUCTION SIGNS SHALL BE FLUORESCENT ORANGE.
- THE CONTRACTOR SHALL BE RESPONSIBLE FOR AN ON-SITE INSPECTION PRIOR TO SUBMITTING A BID ON THIS PROJECT. UPON RECEIPT OF A BID, IT SHALL BE ASSUMED THAT THE CONTRACTOR IS FULLY FAMILIAR WITH THE CONSTRUCTION SITE.
- THE CONTRACTOR SHALL EXCAVATE WITH CARE WHEN INSTALLING PROPOSED CULVERTS AND STORM SEWERS, AS EXISTING FIELD TILES MAY BE PRESENT.
- ALL EXCAVATED AREAS DUE TO WIDENING AND SIDEWALK CONSTRUCTION OPERATIONS SHALL BE PROTECTED WITH EXTENDED LEG BARRICADES WITH APPROPRIATE LIGHTS. THIS WILL NOT BE PAID FOR SEPARATELY BUT WILL BE INCLUDED IN THE CONTRACT.
- IF ASH TREES ARE REMOVED ON THE PROJECT, THE CONTRACTOR SHALL BECOME FAMILIAR WITH AND COMPLY WITH MEASURES SPECIFIED BY THE ILLINOIS DEPARTMENT OF AGRICULTURE (IDOA) TO PREVENT THE SPREAD OF THE EMERALD ASH BORER. THE IDOA INFORMATION FOR ASH TREE REMOVAL CAN BE FOUND ON THE IDOA WEBSITE AT WWW.AGR.STATE.IL.US/EAB.
- THE CONTRACTOR SHALL BE RESPONSIBLE FOR CONTACTING THE FIRE DEPARTMENT AND POLICE DEPARTMENT OF THE RESPECTIVE MUNICIPALITY ANY TIME NORMAL TRAFFIC FLOW ON ANY STREET OR ROAD IS TO BE INTERRUPTED, HOWEVER BRIEFLY.
  - VILLAGE OF MARYVILLE POLICE DEPARTMENT 618-344-8899 (NON-EMERGENCY)
  - VILLAGE OF MARYVILLE FIRE DEPARTMENT 618-346-5201 (NON-EMERGENCY)
  - MADISON COUNTY SHERIFF DEPARTMENT 618-692-4433 (NON-EMERGENCY)

- NONE.

COMMITMENTS

FILE NAME * gennotes.dgn	USER NAME * Scott	DESIGNED - SAS	REVISED -	<b>SCHOOLHOUSE TRAIL CONNECTOR PHASE 1 MARYVILLE, ILLINOIS</b>	<b>GENERAL NOTES</b>			F.A.U. RTE.	SECTION	COUNTY	TOTAL SHEETS	SHEET NO.
	PLOT SCALE * #SCALE#	DRAWN - SAS	REVISED -		SCALE: N.T.S.	SHEET NO. 1 OF 1 SHEETS	STA.	TO STA.	10-00019-00-SW	MADISON	14	2
PLOT DATE * 5/27/2015	CHECKED - BFK	DATE - 12/09/14	REVISED -				CONTRACT NO. 97602			[ILLINOIS] FED. AID PROJECT		

# SUMMARY OF QUANTITIES

CODE No.	ITEM	UNIT	TOTAL QUANTITY
20200100	EARTH EXCAVATION	CU YD	58
20400800	FURNISHED EXCAVATION	CU YD	376
20800150	TRENCH BACKFILL	CU YD	12
25000100	SEEDING, CLASS 1	ACRE	0.3
25000400	NITROGEN FERTILIZER NUTRIENT	POUND	27
25000500	PHOSPHORUS FERTILIZER NUTRIENT	POUND	27
25000600	POTASSIUM FERTILIZER NUTRIENT	POUND	27
25100115	MULCH, METHOD 2	ACRE	0.3
28000250	TEMPORARY EROSION CONTROL SEEDING	POUND	30
28000400	PERIMETER EROSION BARRIER	FOOT	227
28000500	INLET AND PIPE PROTECTION	EACH	2
31100300	SUBBASE GRANULAR MATERIAL, TYPE A 4"	SQ YD	448
40201000	AGGREGATE FOR TEMPORARY ACCESS	TON	5
42001300	PROTECTIVE COAT	SQ YD	435
42400200	PORTLAND CEMENT CONCRETE SIDEWALK 5 INCH	SQ FT	3731
44000100	PAVEMENT REMOVAL	SQ YD	115
54213660	PRECAST REINFORCED CONCRETE FLARED END SECTIONS 15"	EACH	1
550A0070	STORM SEWERS, CLASS A, TYPE 1 15"	FOOT	42
60236200	INLETS, TYPE A, TYPE B GRATE	EACH	1
60240215	INLETS, TYPE B, TYPE 1 FRAME, CLOSED LID	EACH	1
67100100	MOBILIZATION	L SUM	1
72000100	SIGN PANEL - TYPE 1	SQ FT	23
73000100	WOOD SIGN SUPPORT	FOOT	83
Δ 78001110	PAINT PAVEMENT MARKINGS - LINE 4"	FOOT	167
X6062700	CONCRETE GUTTER, TYPE A (SPECIAL)	FOOT	118
X7010216	TRAFFIC CONTROL AND PROTECTION, (SPECIAL)	L SUM	1

Δ Specialty Items

FILE NAME * Summary Bike.dgn	USER NAME * Scott	DESIGNED - SAS	REVISED -	<b>SCHOOLHOUSE TRAIL CONNECTOR PHASE 1 MARYVILLE, ILLINOIS</b>	<b>SUMMARY OF QUANTITIES</b>			F.A.U. RTE.	SECTION	COUNTY	TOTAL SHEETS	SHEET NO.	
		DRAWN - SAS	REVISED -						10-00019-00-SW	MADISON	14	3	
		CHECKED - BFK	REVISED -										
		DATE - 01/05/15	REVISED -			SCALE: N.T.S.	SHEET NO. 01 OF 01 SHEETS	STA.	TO STA.				CONTRACT NO. 97602
												ILLINOIS FED. AID PROJECT	

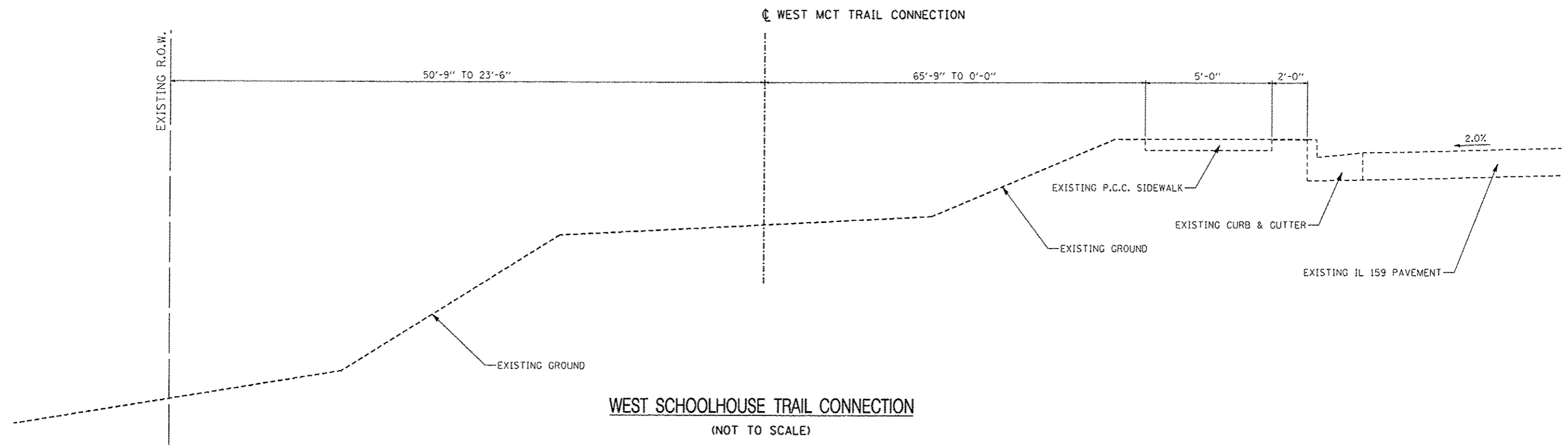

**WEST SCHOOLHOUSE TRAIL CONNECTION**  
(NOT TO SCALE)

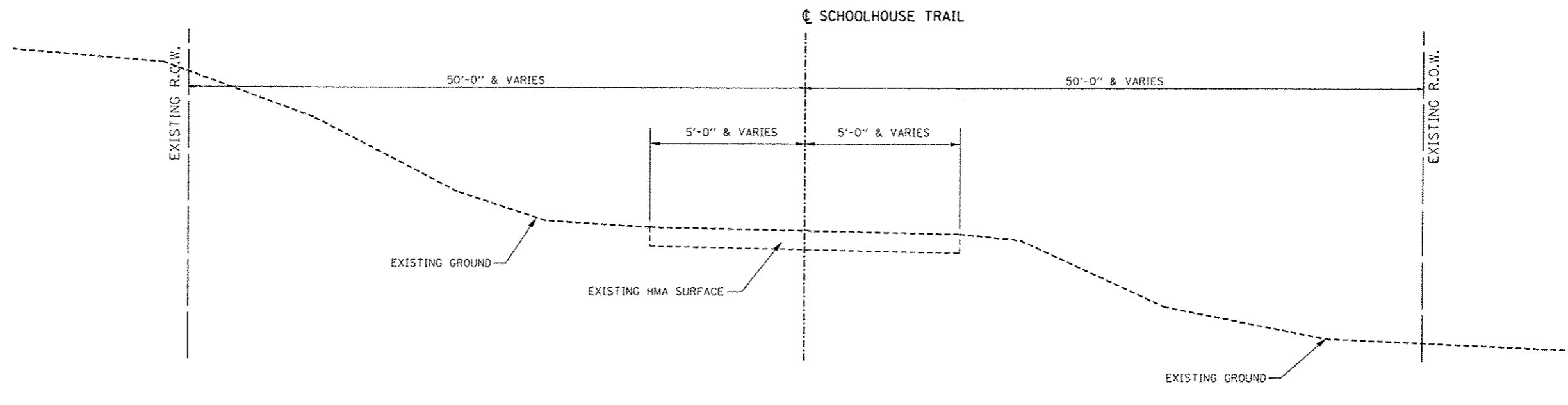

**SCHOOLHOUSE TRAIL**  
(NOT TO SCALE)

FILE NAME * Existing typical.dgn	USER NAME * Scott	DESIGNED - SAS	REVISED -	<b>SCHOOLHOUSE TRAIL CONNECTOR PHASE 1</b> <b>MARYVILLE, ILLINOIS</b>	<b>EXISTING TYPICALS</b>			F.A. RTE.	SECTION	COUNTY	TOTAL SHEETS	SHEET NO.
	PLOT SCALE = *SCALE*	DRAWN - SAS	REVISED -					10-00019-00-SW	MADISON	14	4	
	PLOT DATE = 5/27/2015	CHECKED - BFK	REVISED -					CONTRACT NO. 97602				
	DATE - 12/10/14	REVISED -		SCALE: N.T.S.	SHEET NO. 01 OF 01 SHEETS	STA.	TO STA.	ILLINOIS FED. AID PROJECT				

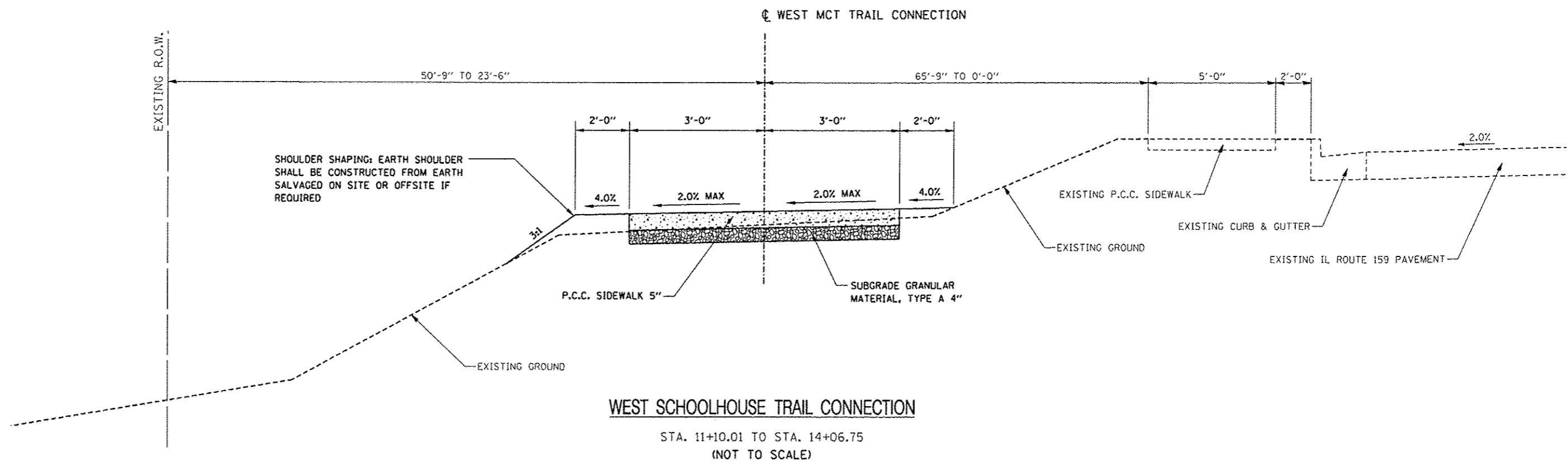
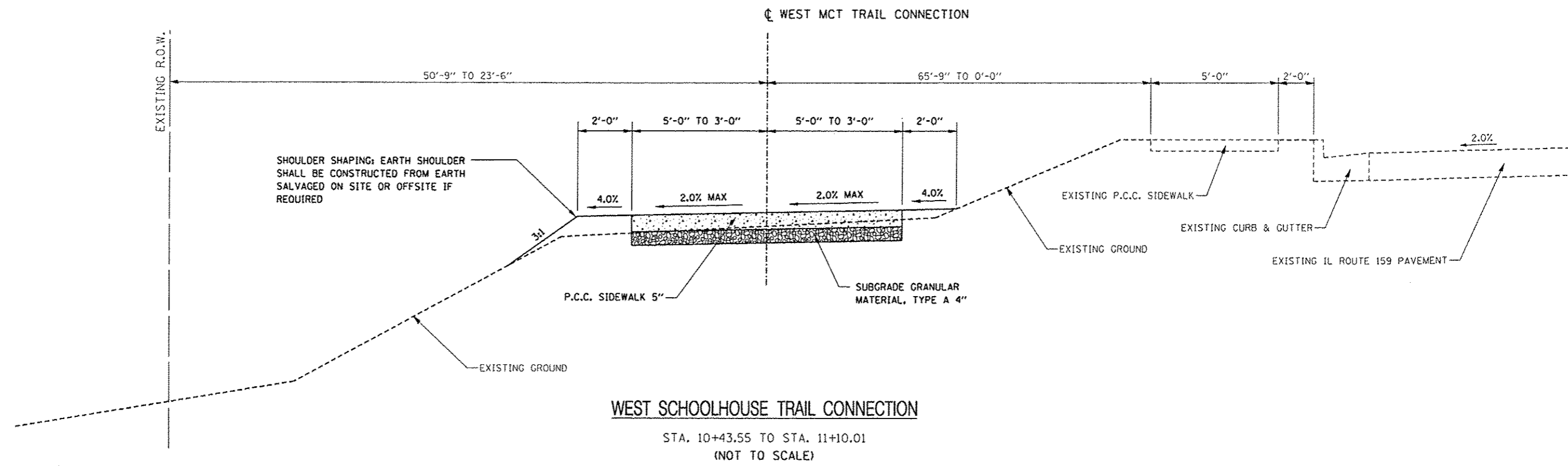

FILE NAME * Proposed typical.dgn	USER NAME * Scott	DESIGNED - SAS	REVISED -	<b>SCHOOLHOUSE TRAIL CONNECTOR PHASE 1</b> <b>MARYVILLE, ILLINOIS</b>	<b>PROPOSED TYPICALS</b>		F.A. - RTE.	SECTION	COUNTY	TOTAL SHEETS	SHEET NO.
	PLOT SCALE * #SCALE#	DRAWN - SAS	REVISED -				10-00019-00-SW	MADISON	14	5	
	PLOT DATE * 5/27/2015	CHECKED - BFK	REVISED -				CONTRACT NO. 97602				
	DATE - 12/10/14	REVISED -		SCALE: N.T.S.	SHEET NO. 01 OF 02 SHEETS	STA.	TO STA.	ILLINOIS FED. AID PROJECT			

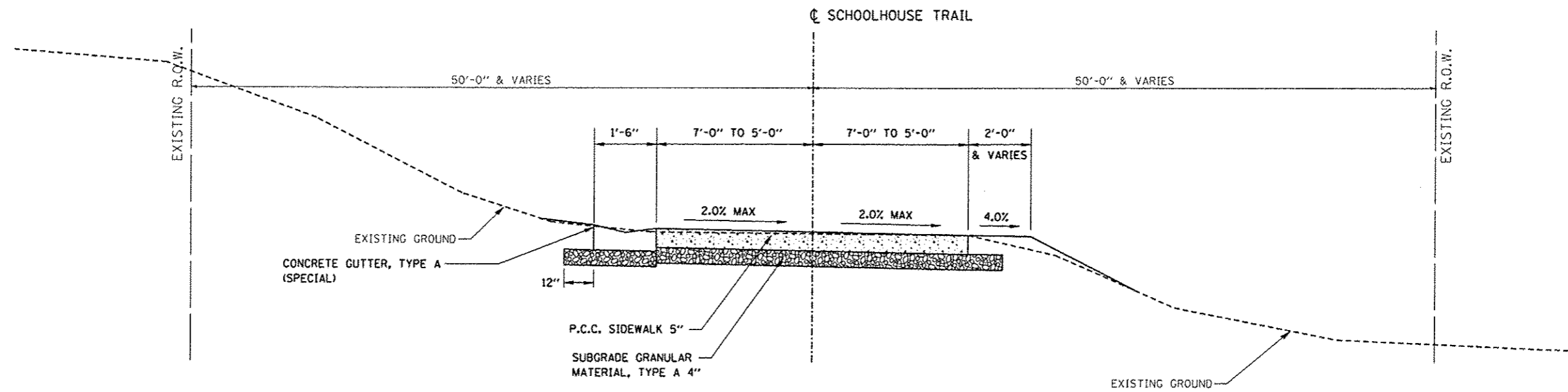

**SCHOOLHOUSE TRAIL**  
 STA. 0+00.00 TO STA. 1+02.45  
 (NOT TO SCALE)

FILE NAME * Proposed typical.dgn	USER NAME * Scott	DESIGNED - SAS	REVISED -	<b>SCHOOLHOUSE TRAIL CONNECTOR PHASE 1 MARYVILLE, ILLINOIS</b>	<b>PROPOSED TYPICALS</b>			F.A. RTE.	SECTION	COUNTY	TOTAL SHEETS	SHEET NO.
	PLOT SCALE * SCALE*	CHECKED - BFK	REVISED -					10-00019-00-SW	MADISON	14	6	
	PLOT DATE = 5/27/2015	DATE - 12/10/14	REVISED -					CONTRACT NO. 97602				
					SCALE: N.T.S.	SHEET NO. 02 OF 02 SHEETS	STA.	TO STA.		ILLINOIS FED. AID PROJECT		

**EARTHWORK SCHEDULE**

LOCATION	EARTH EXCAVATION (CU YD)	EARTH • EXCAVATION ADJUSTED FOR SHRINKAGE (CU YD)	EMBANKMENT (CU YD)	EARTHWORK BALANCE WASTE (+) OR SHORTAGE (-) (CU YD)
SCHOOLHOUSE TRAIL CONNECTOR				
STA. 10+30.04 TO STA. 14+06.75	58	43	419	-376
<b>TOTAL</b>	<b>58</b>	<b>43</b>	<b>419</b>	<b>-376</b>

NOTES: • BASED ON 25% SHRINKAGE

**STORM SEWER SCHEDULE**

STRUCTURE ID	LOCATION	STORM SEWERS CLASS A, RCCP TYPE 1 15" (FOOT)	TRENCH BACKFILL (CU YD)
SCHOOLHOUSE TRAIL CONNECTOR			
I-1 TO I-2	STA. 10+61.64 - 15.88' RT TO STA. 10+80.69 - 13.74' LT	33	12
I-2 TO I-3	STA. 10+80.69 - 13.74' LT TO STA. 10+73.54 - 28.40' LT	9	
<b>TOTAL</b>		<b>42</b>	<b>12</b>

**SIDEWALK SCHEDULE**

LOCATION	P.C.C. SIDEWALK 5" (SQ FT)	SUBBASE GRAN MAT'L 4" (TON)
SCHOOLHOUSE TRAIL CONNECTOR		
STA. 10+30.04 TO STA. 14+06.75	2580	65
TRAIL SECTION	1151	29
<b>TOTAL</b>	<b>3731</b>	<b>94</b>

**STORM STRUCTURE SCHEDULE**

STRUCTURE ID	LOCATION	INLETS, TYPE A, TY 8 GRATE	INLETS, TYPE B, TY 1 F&G	PRC FES 15"
		(EACH)	(EACH)	(EACH)
SCHOOLHOUSE TRAIL CONNECTOR				
I-1	STA. 10+61.64 - 15.88' RT	1		
I-2	STA. 10+80.69 - 13.74' LT		1	
I-3	STA. 10+73.54 - 28.40' LT			1
<b>TOTAL</b>		<b>1</b>	<b>1</b>	<b>1</b>

**PROTECTIVE COAT SCHEDULE**

LOCATION	PROTECTIVE COAT (SQ YD)
SCHOOLHOUSE TRAIL CONNECTOR	
P.C.C. SIDEWALK	415
CONCRETE GUTTER, TYPE A (SPECIAL)	20
<b>TOTAL</b>	<b>435</b>

**INLET AND PIPE PROTECTION SCHEDULE**

LOCATION	DISTANCE (FOOT)	INLET AND PIPE PROTECTION (EACH)
SCHOOLHOUSE TRAIL CONNECTOR		
STA. 10+61.64 RT	15.88	1
STA. 10+80.69 LT	13.74	1
<b>TOTAL</b>		<b>2</b>

**TRENCH BACKFILL SCHEDULE**

LOCATION	TRENCH BACKFILL (CU YD)
SCHOOLHOUSE TRAIL CONNECTOR	
STORM SEWER SCHEDULE	12
<b>TOTAL</b>	<b>12</b>

**CONCRETE GUTTER SCHEDULE**

LOCATION	CONCRETE GUTTER TYPE A (SPECIAL) (FOOT)	SUBBASE GRAN MATL TYPE A 4" (SQ YD)
SCHOOLHOUSE TRAIL CONNECTOR		
TRAIL SECTION	118	33
<b>TOTAL</b>	<b>118</b>	<b>33</b>

### SIGN SCHEDULE

LOCATION	R1-1 STOP 18 X 18 WHITE ON RED (EACH)	W4-4P CROSS TRAFFIC DOES NOT STOP 30 X 15 BLACK ON YELLOW (EACH)	D11-1 BIKE ROUTE 24 X 18 WHITE ON GREEN (EACH)	M7-4 ARROW 12 X 9 WHITE ON GREEN (EACH)	SP-1 BIKERS DISMOUNT 24 X 18 BLACK ON WHITE (EACH)	SP-2 SCHOOLHOUSE TRAIL CONNECTION 24 X 18 WHITE ON GREEN (EACH)	W2-2 INTERSECTION 18 X 18 BLACK ON FL. YELLOW (EACH)	W16-7P ARROW 12 X 9 BLACK ON FL. YELLOW (EACH)	WOOD SIGN SUPPORT 4" X 6" (FOOT)
SCHOOLHOUSE TRAIL CONNECTOR									
STA. 10+53.00, 8.60' LT	1	1							12.5
STA. 11+10.00, 6.00' LT			1	1					11.4
STA. 11+10.00, 6.00' RT					1				11.5
STA. 14+00.00, 6.00' LT						1			11.5
SCHOOLHOUSE TRAIL									
100' WEST OF INTERSECTION							1		12.1
10' EAST OF INTERSECTION							1	1	12.0
200' EAST OF INTERSECTION							1		12.1
SQUARE FOOT/SIGN	2.25	3.13	3.00	0.75	3.00	3.00	2.25	0.75	
<b>TOTAL</b>	<b>2.25</b>	<b>3.13</b>	<b>3.00</b>	<b>0.75</b>	<b>3.00</b>	<b>3.00</b>	<b>6.75</b>	<b>0.75</b>	<b>83</b>

### PAVEMENT REMOVAL SCHEDULE

LOCATION	PAVEMENT REMOVAL (SQ YD)
SCHOOLHOUSE TRAIL CONNECTOR	
TRAIL SECTION	115
<b>TOTAL</b>	<b>115</b>

### PAVEMENT MARKING SCHEDULE

LOCATION	TYPE	PAINT PAVEMENT MARKINGS 4" YELLOW (FOOT)
SCHOOLHOUSE TRAIL CONNECTOR		
TRAIL SECTION	SKIP DASH CENTERLINE	26 141
<b>TOTAL</b>		<b>167</b>

### SEEDING SCHEDULE

LOCATION	TEMPORARY EROSION CONTROL SEEDING (LB)	SEEDING CLASS 1 (ACRE)	NITROGEN FERT NUTR (LB)	PHOSPHORUS FERT NUTR (LB)	POTASSIUM FERT NUTR (LB)	MULCH METHOD 2 (ACRE)
SCHOOLHOUSE TRAIL CONNECTOR						
STA. 10+30.04 TO STA. 14+06.75	30	0.3	27	27	27	0.3
<b>TOTAL</b>	<b>30</b>	<b>0.3</b>	<b>27</b>	<b>27</b>	<b>27</b>	<b>0.3</b>

### PERIMETER EROSION BARRIER

LOCATION	PERIMETER EROSION BARRIER (FOOT)
SCHOOLHOUSE TRAIL CONNECTOR	
STA. 10+65.00 LT TO STA. 12+75.00 LT	227
<b>TOTAL</b>	<b>227</b>



PLAN  
 DATE: \_\_\_\_\_ BY: \_\_\_\_\_  
 CHECKED: \_\_\_\_\_  
 DRAWN: \_\_\_\_\_  
 NO. \_\_\_\_\_

PROFILE  
 DATE: \_\_\_\_\_ BY: \_\_\_\_\_  
 CHECKED: \_\_\_\_\_  
 DRAWN: \_\_\_\_\_  
 NO. \_\_\_\_\_

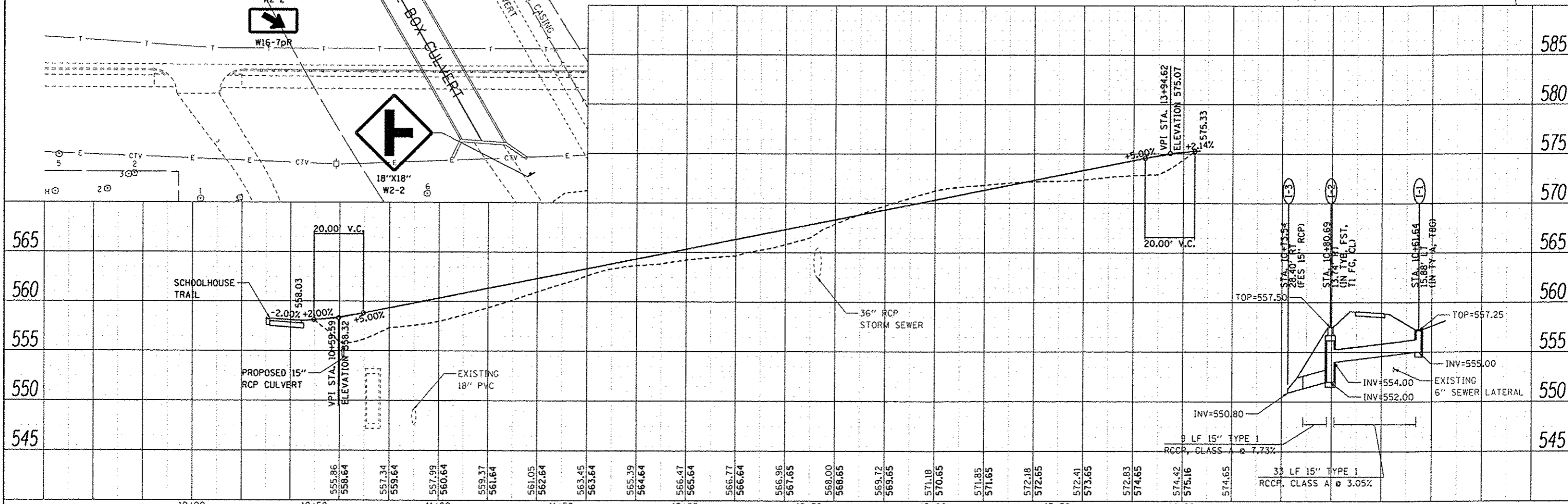
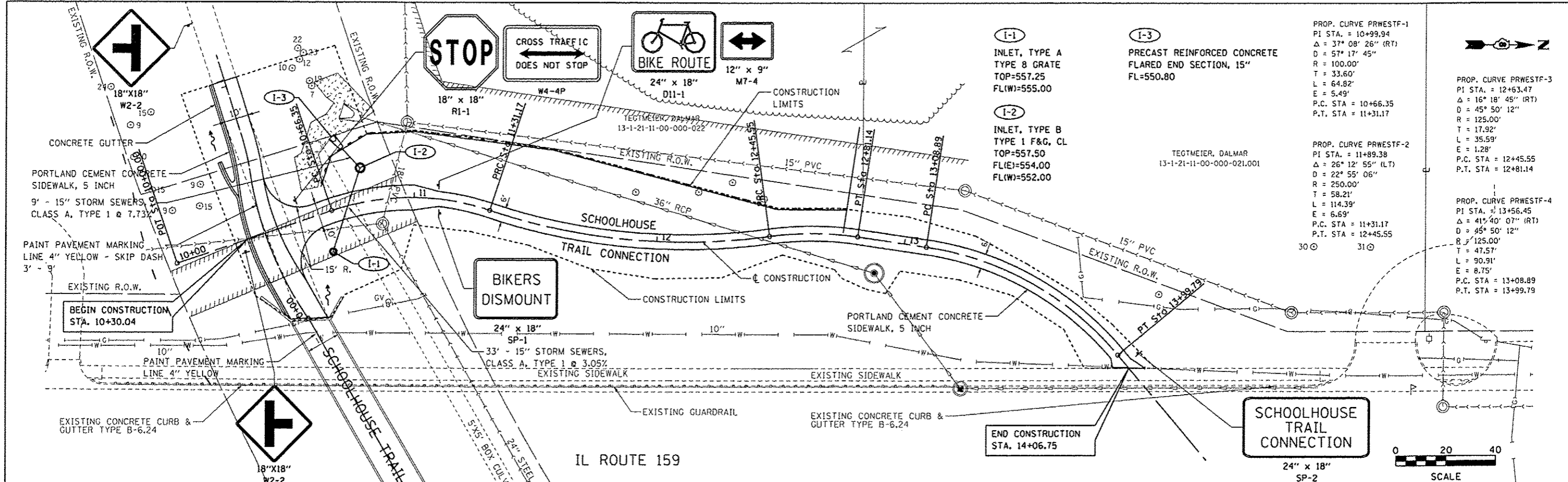

FILE NAME: plan01.dgn	USER NAME: Scott	DESIGNED: SAS	REVISED: -	<b>SCHOOLHOUSE TRAIL CONNECTOR PHASE 1</b> <b>MARYVILLE, ILLINOIS</b>	<b>PLAN AND PROFILE</b>	F.A. RTE.	SECTION	COUNTY	TOTAL SHEETS	SHEET NO.
PLOT SCALE: 1/4\"/>										
PLOT DATE: 5/27/2015	DATE: 12/10/14	REVISIONS:	10-00019-00-SW			MADISON	14	9		
SCALE: 1\"/>										

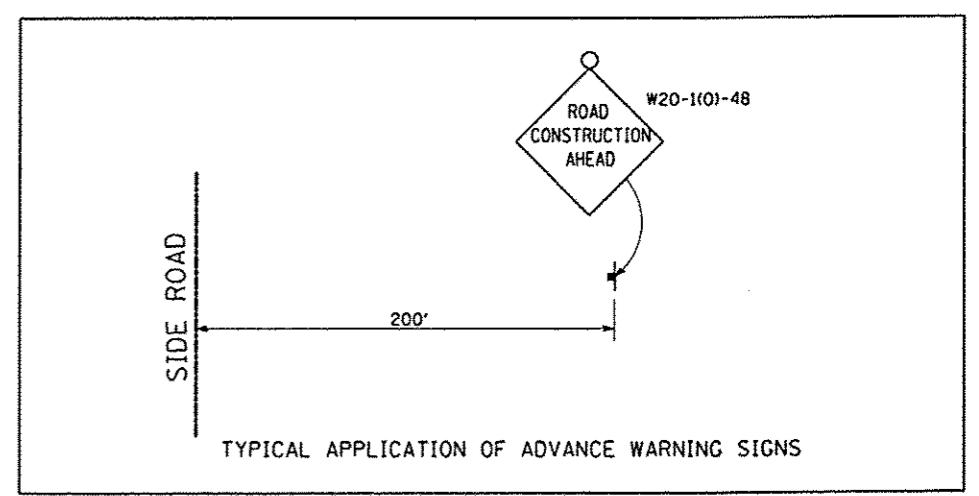
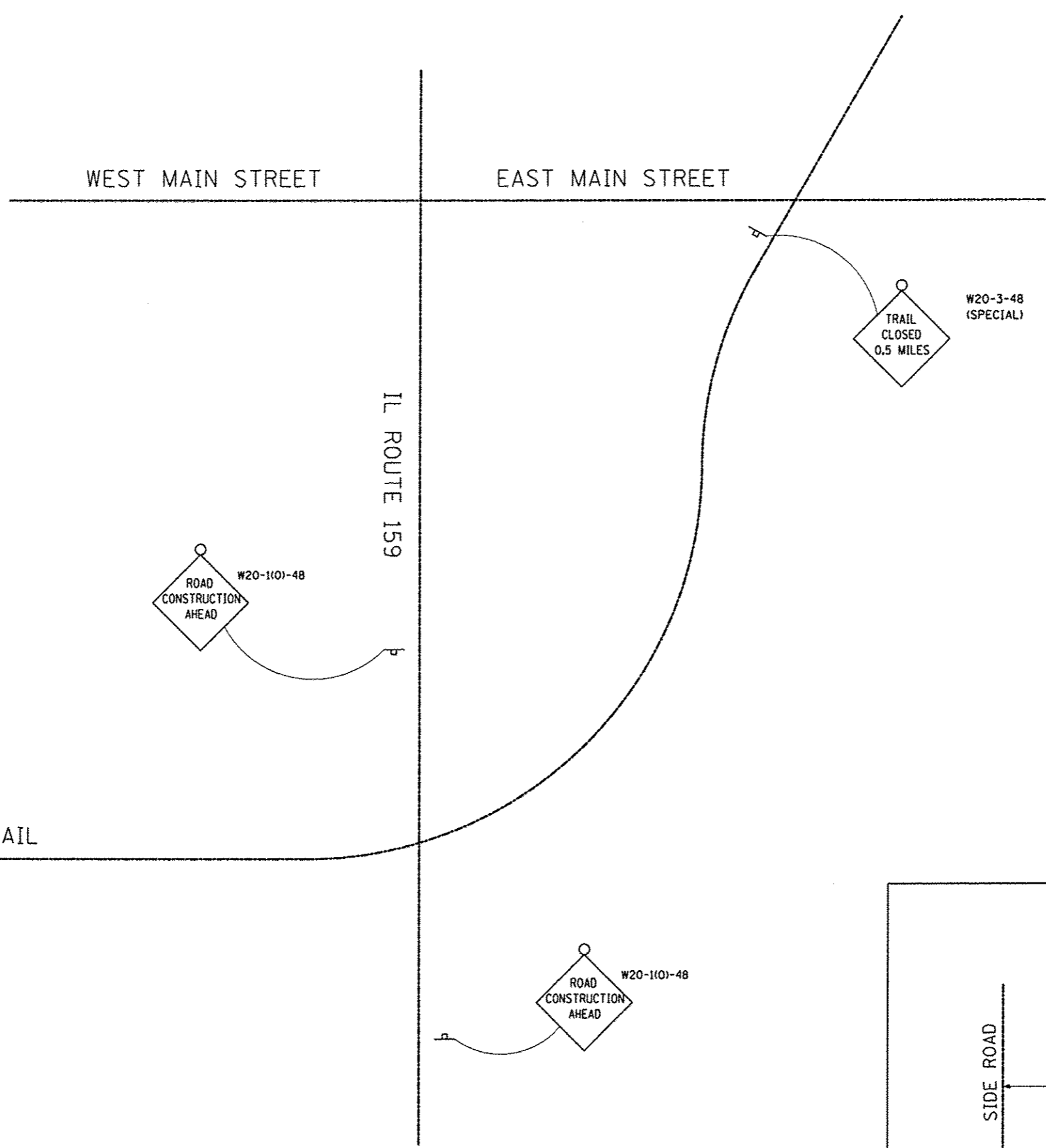

FILE NAME *	USER NAME * Scott	DESIGNED - SAS	REVISED -	<b>SCHOOLHOUSE TRAIL CONNECTOR VILLAGE OF MARYVILLE</b>	<b>ADVANCED WARNING SIGNS</b>			F.A.U. RTE.	SECTION	COUNTY	TOTAL SHEETS	SHEET NO.
FILE#		DRAWN - SAS	REVISED -		SCALE: N.T.S.	SHEET NO. 1 OF 1 SHEETS	STA.	TO STA.	10-00019-00-SW	MADISON	14	10
	PLOT SCALE * #SCALE*	CHECKED - BFK	REVISED -		CONTRACT NO. 97602							
	PLOT DATE * 5/27/2015	DATE - 01/02/15	REVISED -		ILLINOIS FED. AID PROJECT							





FINAL SURVEY	DATE
SURVEYED	BT
PLOTTED	
NOTE BOOK	
AREAS	
AREAS CHECKED	

GRAND SURVEY	DATE
SURVEYED	BT
PLOTTED	
NOTE BOOK	
AREAS	
AREAS CHECKED	

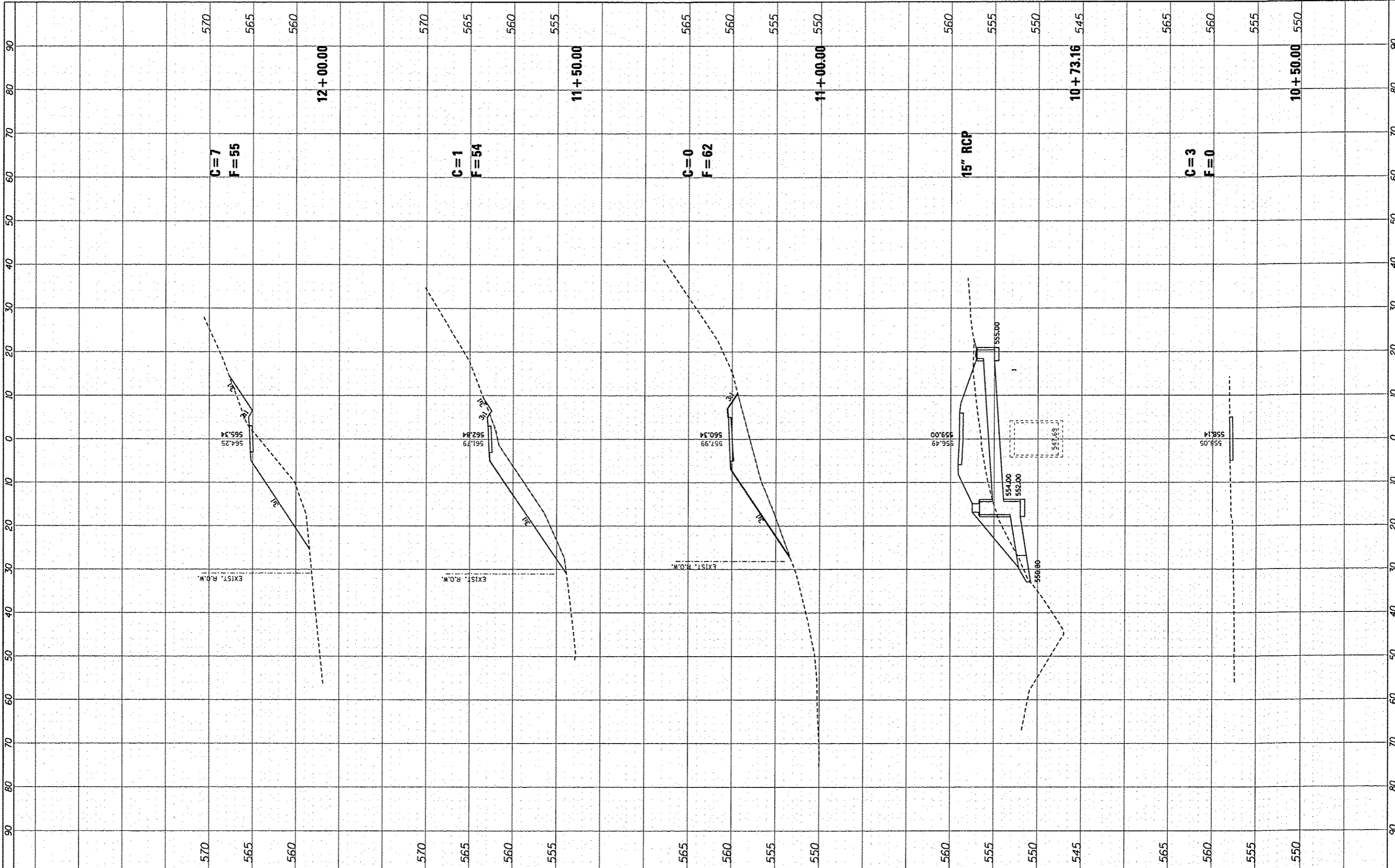

FILE NAME =  
#FILE#  
#MODELNAME#

USER NAME = Scott  
DESIGNED - SAS  
DRAWN - SAS  
CHECKED - BFK  
DATE - 12/10/14

REVISED -  
REVISED -  
REVISED -  
REVISED -

**SCHOOLHOUSE TRAIL CONNECTOR PHASE 1  
MARYVILLE, ILLINOIS**

**CROSS SECTIONS**  
SCALE: SHEET 01 OF 02 SHEETS STA. 10+50.00 TO STA. 12+00.00

F.A. RTE.	SECTION	COUNTY	TOTAL SHEETS	SHEET NO.
	10-00019-00-SW	MADISON	14	13
CONTRACT NO. 97602			ILLINOIS FED. AID PROJECT	

FINAL SURVEY	DATE
PLOTTED	
NOTE BOOK	
AREAS CHECKED	
NO.	

ORIGINAL SURVEY	DATE
PLOTTED	
NOTE BOOK	
AREAS CHECKED	
NO.	

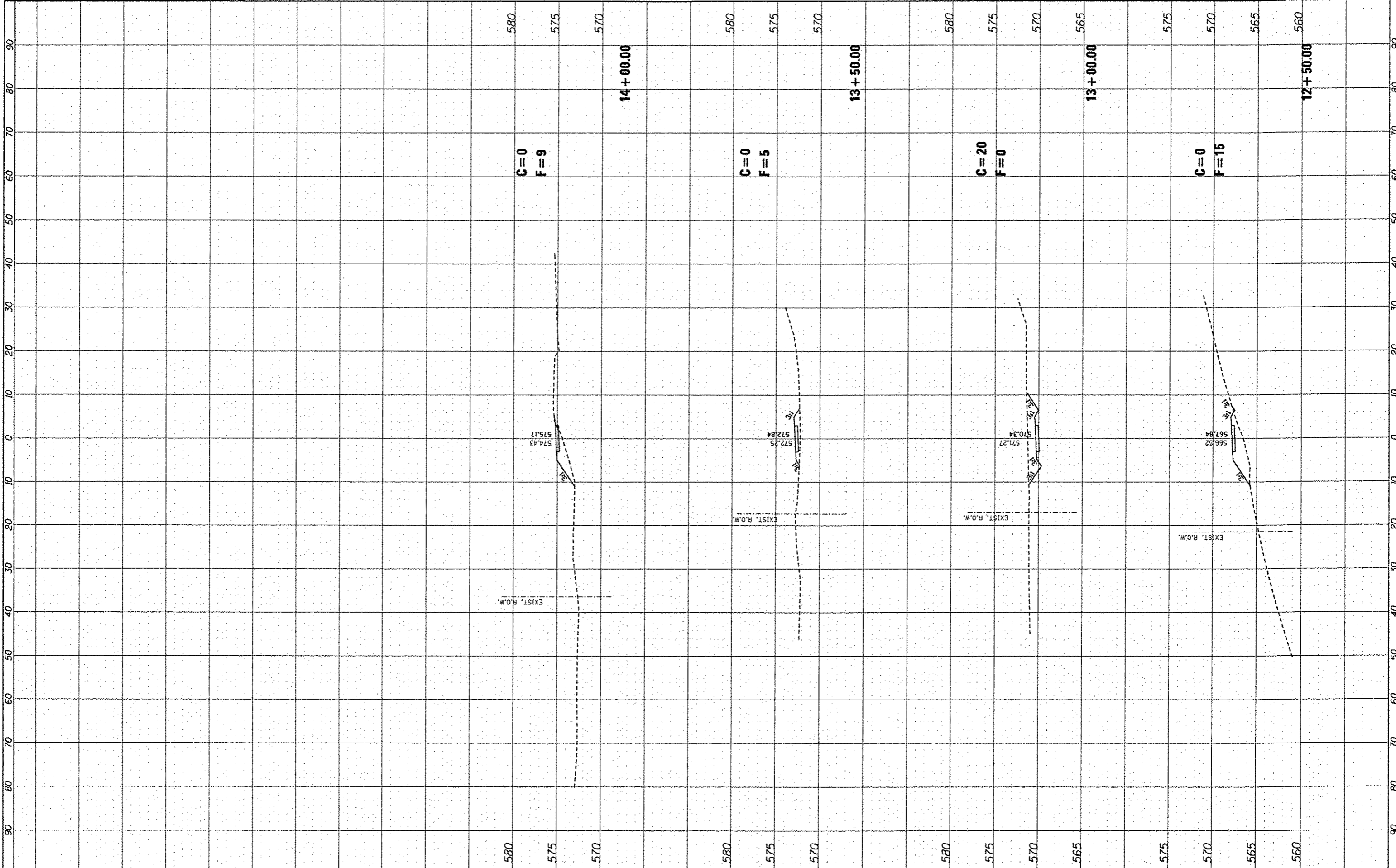

FILE NAME \*  
#FILEL\*  
#MODELNAME\*

USER NAME \* Scott  
DESIGNED - SAS  
DRAWN - SAS  
CHECKED - BFK  
DATE - 12/10/14

REVISIONS  
REVISED -  
REVISED -  
REVISED -  
REVISED -

**SCHOOLHOUSE TRAIL CONNECTOR PHASE 1  
MARYVILLE, ILLINOIS**

**CROSS SECTIONS**

SCALE: SHEET 02 OF 02 SHEETS STA. 12+50.00 TO STA. 14+00.00

F.A. RTE.	SECTION	COUNTY	TOTAL SHEETS	SHEET NO.
	10-00019-00-SW	MADISON	14	14
CONTRACT NO. 97602			ILLINOIS FED. AID PROJECT	