

STATE OF ILLINOIS
DEPARTMENT OF TRANSPORTATION

| F.A.P. RTE. | SECTION | COUNTY | TOTAL SHEETS | SHEET NO. |
|-------------|---------|----------|--------------------|-----------|
| 311 | (651)PP | KENDALL | 12 | 1 |
| | | ILLINOIS | CONTRACT NO. 66K96 | |

INDEX OF SHEETS

1. COVER SHEET
2. GENERAL NOTES
- 3-4. SUMMARY OF QUANTITIES
5. TYPICAL SECTION
- 6-7. SCHEDULES
- 8-9. CLASS B PATCHING DETAILS
- 10-11. TYPICAL PAVEMENT MARKING
12. TEMPORARY INFORMATION SIGNING

STANDARDS

- | | |
|-----------|--|
| 000001-07 | STANDARD SYMBOLS, ABBREVIATIONS AND PATTERNS |
| 001006 | DECIMAL OF AN INCH AND OF A FOOT |
| 420001-09 | PAVEMENT JOINTS |
| 420701-03 | PAVEMENT WELDED WIRE REINFORCEMENT |
| 701101-05 | OFF-ROAD OPERATIONS, MULTILANE, 15' (4.5 m) TO 24' (600 mm) FROM PAVEMENT EDGE |
| 701427-05 | LANE CLOSURE, MULTILANE INTERMITTENT OR MOVING OPERATION, FOR SPEEDS ≤ 40 MPH |
| 701602-10 | URBAN LANE CLOSURE, MULTILANE, 2W WITH BIDIRECTIONAL LEFT TURN LANE |
| 701701-10 | URBAN LANE CLOSURE, MULTILANE INTERSECTION |
| 701901-08 | TRAFFIC CONTROL DEVICES |
| 886001-01 | DETECTOR LOOP INSTALLATIONS |
| 886006-01 | TYPICAL LAYOUT FOR DETECTION LOOPS |

PROPOSED
HIGHWAY PLANS

F.A.P. 311 (US 34)
SECTION (651)PP
PAVEMENT PATCHING
KENDALL COUNTY

C-93-081-20

IMPROVEMENT ENDS
500' WEST OF
US 34 /US 30
INTERSECTION
(L.M. 2.80)

IMPROVEMENT BEGINS
0.10 MILE WEST OF
BOULDER HILL PASS
(L.M. 0.00)

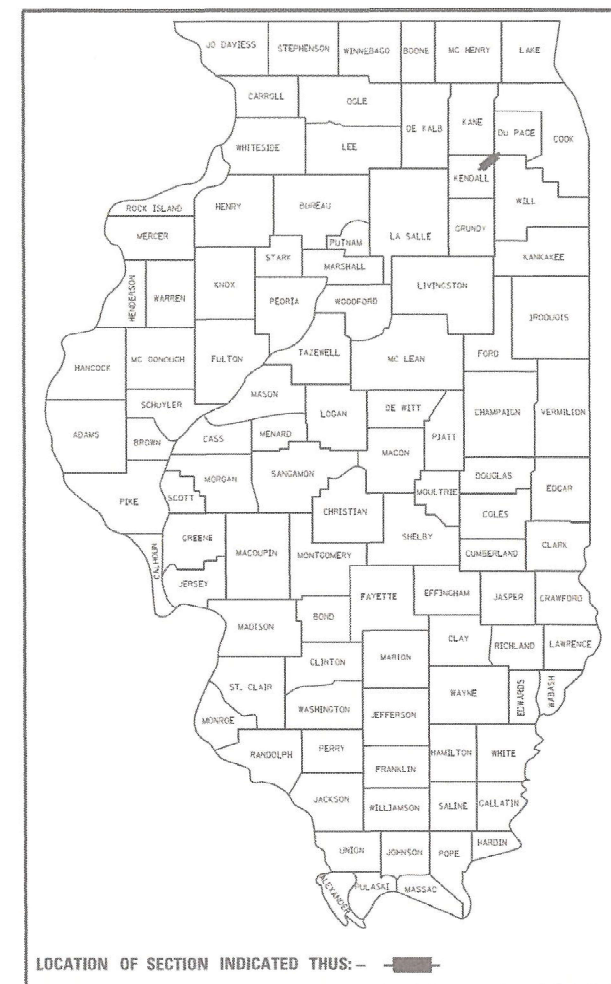

FUNCTIONAL CLASSIFICATION

| | |
|-----------------|--------|
| URBAN | |
| OTHER ARTERIAL | |
| FAP 311 (US 34) | |
| ADT YEAR = 2019 | |
| ADT | 25333 |
| P. V. | 93.65% |
| S. U. | 3.96% |
| M. U. | 2.39% |

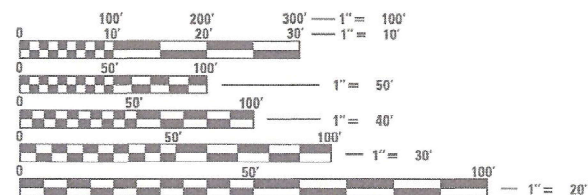

FULL SIZE PLANS HAVE BEEN PREPARED USING STANDARD ENGINEERING SCALES. REDUCED SIZED PLANS WILL NOT CONFORM TO STANDARD SCALES. IN MAKING MEASUREMENTS ON REDUCED PLANS, THE ABOVE SCALES MAY BE USED.

J.U.L.I.E.
JOINT UTILITY LOCATION INFORMATION FOR EXCAVATION
1-800-892-0123
OR 811

PROJECT ENGINEER JOE KANNEL P.E.
UNIT CHIEF RON WOODSHANK
DISTRICT 3 NO. (815) 434-6131
CONTRACT NO. 66K96



GROSS LENGTH = 14784 FT. = 2.80 MILE
NET LENGTH = 677 FT. = 0.13 MILE

STATE OF ILLINOIS
DEPARTMENT OF TRANSPORTATION

SUBMITTED *May 13th 2020*

[Signature]
REGIONAL ENGINEER

June 26, 2020

[Signature]
ENGINEER OF DESIGN AND ENVIRONMENT

June 26, 2020

[Signature]
DIRECTOR OF HIGHWAYS PROJECT IMPLEMENTATION

PRINTED BY THE AUTHORITY
OF THE STATE OF ILLINOIS

GENERAL NOTES

PLAN DIMENSIONS AND DETAILS RELATIVE TO EXISTING PLANS ARE SUBJECT TO NOMINAL CONSTRUCTION VARIATIONS. THE CONTRACTOR SHALL FIELD VERIFY EXISTING DIMENSIONS AND DETAILS AFFECTING NEW CONSTRUCTION AND MAKE NECESSARY APPROVED ADJUSTMENTS PRIOR TO CONSTRUCTION OR ORDERING OF MATERIALS. SUCH VARIATIONS SHALL NOT BE CAUSE FOR ADDITIONAL COMPENSATION FOR A CHANGE IN SCOPE OF WORK; HOWEVER, THE CONTRACTOR WILL BE PAID FOR THE QUANTITY ACTUALLY FURNISHED AT THE UNIT PRICE BID FOR THE WORK.

ALL EXCAVATED MATERIAL, WHICH INCLUDES DIGGING OR GRADING OF ANY SOIL OR FILL MATERIAL, WITH THE EXCEPTION OF AGGREGATE FILLS, MUST BE INCORPORATED WITHIN THE IDOT RIGHT OF WAY DUE TO ENVIRONMENTAL DOCUMENTATION REQUIREMENTS.

ANY REFERENCE TO A STANDARD IN THESE PLANS SHALL BE INTERPRETED TO MEAN THE EDITION AS INDICATED BY THE SUBNUMBER SHOWN IN THE LIST OF STANDARDS OR THE COPY INCLUDED IN THESE PLANS.

THE CONTRACTOR SHALL CONTACT JULIE AT LEAST 48 HOURS PRIOR TO EXCAVATION TO DETERMINE WHICH UTILITIES ARE IN THE AREA.

TRAFFIC SIGNAL NOTES

THE DISTRICT 3 TRAFFIC SIGNAL UNIT IN THE BUREAU OF OPERATIONS SHALL BE NOTIFIED AT LEAST 72 HOURS PRIOR TO THE LAYOUT OF THE DETECTOR LOOPS.

4 TURNS REQUIRED ON ALL DETECTOR LOOPS. EXCEPT 6 TURNS FOR ADVANCE 6' X 6' DETECTOR LOOPS.

6' X 20' TYPICAL DETECTOR LOOPS WITH 6' SPACING 10' FROM PROJECTED EDGE LINE OR STOP BARS.

6' X 6' TYPICAL DETECTOR FOR ADVANCE LOOPS

COMMITMENTS

STATE OF ILLINOIS
DEPARTMENT OF TRANSPORTATION
DISTRICT THREE
AS BUILT INFORMATION

SUPERVISING CONSTRUCTION FIELD ENGINEER

RESIDENT ENGINEER / TECHNICIAN

START & END DATES
OF CONSTRUCTION:

INSPECTORS:

DATE: _____

PREPARED BY: _____
DISTRICT STUDIES & PLANS ENGINEER

EXAMINED BY: _____
DISTRICT CONSTRUCTION ENGINEER

DISTRICT MATERIALS ENGINEER

DISTRICT OPERATIONS ENGINEER

| | | | | | | | | | | | |
|-------------|---------------------------|------------------|-----------------|---|----------------------|--------------------|---------|---------|--------------|------------|---------------|
| FILE NAME = | USER NAME = mar11111 | DESIGNED - EM | REVISED - _____ | STATE OF ILLINOIS DEPARTMENT OF TRANSPORTATION | GENERAL NOTES | F.A.P. RTE. | SECTION | COUNTY | TOTAL SHEETS | SHEET NO. | |
| | | DRAWN - EM | REVISED - _____ | | | 311 | (651)PP | KENDALL | 12 | 2 | |
| Default | PLOT SCALE = 3.9370' / mm | CHECKED - RW | REVISED - _____ | | | CONTRACT NO. 66K96 | | | | | |
| | PLOT DATE = 4/17/2020 | DATE - 4/17/2020 | REVISED - _____ | | | SCALE: _____ | SHEET 1 | OF 1 | SHEETS | STA. _____ | TO STA. _____ |

C:\Users\mar11111\Documents\DOT - District 3\Projects\66K96\66K96-01\Drawings\66K96-01-01.dwg

PATCHING SCHEDULE - EASTBOUND LANES

| DRIVING LANE | | | | | | | | |
|---------------|--------------|---------------|----------------|---------------|----------------------|------------|--------------------|------------------|
| LOCATION | PATCH LENGTH | CLASS B | | | DOWEL BARS 1 1/2" | SAW CUTS | WELDED WIRE REINF. | TIE BARS 3/4" |
| | | TYPE II 9" | TYPE III 9" | TYPE IV 9" | | | | |
| LOG MILE | (FT) | SQ YD | SQ YD | SQ YD | EACH | FOOT | SQ YD | EACH |
| 0.0 | 7 | 11 | | | 20 | 50 | | |
| 0.2 | 7 | 11 | | | 20 | 50 | | |
| 1.0 | 26 | | | 40 | 20 | 88 | 40 | 13 |
| 1.5 | 26 | | | 40 | 20 | 88 | 40 | 13 |
| 2.0 | 26 | | | 40 | 20 | 88 | 40 | 13 |
| 2.7 | 7 | 11 | | | 20 | 50 | | |
| 2.8 | 10 | | 16 | | 20 | 56 | 16 | |
| TOTALS | 109 | 33 | 16 | 120 | 140 | 470 | 136 | 39 |

DETECTOR LOOP SCHEDULE
EASTBOUND LANES

| LOCATION STREET | DETECTOR LOOP, TYPE I | | LOOP DETECTOR TESTING | |
|------------------------|-----------------------|--------------|-----------------------|--------------|
| | FOOT | | FOOT | |
| | DRIVING LANE | PASSING LANE | DRIVING LANE | PASSING LANE |
| BOULDER HILL PASS | 56 | 69 | 1 | 1 |
| 5 TH STREET | 56 | 69 | 1 | 1 |
| SUBTOTALS | 112 | 138 | 2 | 2 |
| TOTALS | 250 | | 4 | |

PATCHING SCHEDULE - EASTBOUND LANES

| PASSING LANE | | | | | | | | |
|---------------|--------------|---------------|----------------|---------------|----------------------|------------|--------------------|------------------|
| LOCATION | PATCH LENGTH | CLASS B | | | DOWEL BARS 1 1/2" | SAW CUTS | WELDED WIRE REINF. | TIE BARS 3/4" |
| | | TYPE II 9" | TYPE III 9" | TYPE IV 9" | | | | |
| LOG MILE | (FT) | SQ YD | SQ YD | SQ YD | EACH | FOOT | SQ YD | EACH |
| 0.0 | 7 | | | | 20 | 50 | | |
| 0.2 | 7 | 9 | | | 20 | 50 | | |
| 1.0 | 26 | | | 35 | 20 | 88 | 35 | 13 |
| 1.5 | 26 | | | 35 | 20 | 88 | 35 | 13 |
| 1.9 | 15 | | 20 | | 20 | 66 | 20 | |
| 2.0 | 26 | | | 35 | 20 | 88 | 35 | 13 |
| 2.0 | 24 | | | 32 | 20 | 84 | 32 | 12 |
| 2.8 | 10 | 13 | | | 20 | 56 | | |
| TOTALS | 141 | 22 | 20 | 137 | 160 | 570 | 157 | 51 |

PATCHING SCHEDULE - EASTBOUND LANES

| CENTER LANE | | | | | | | |
|---------------|--------------|---------------|---------------|----------------------|------------|--------------------|------------------|
| LOCATION | PATCH LENGTH | CLASS B | | DOWEL BARS 1 1/2" | SAW CUTS | WELDED WIRE REINF. | TIE BARS 3/4" |
| | | TYPE II 9" | TYPE IV 9" | | | | |
| LOG MILE | (FT) | SQ YD | SQ YD | EACH | FOOT | SQ YD | EACH |
| 2.0 | 24 | | 35 | 20 | 84 | 35 | 12 |
| 2.6 | 7 | 10 | | 20 | 50 | | |
| TOTALS | 31 | 10 | 35 | 40 | 134 | 35 | 12 |

| | | | |
|-------------|---------------------------|-----------------|-----------------|
| FILE NAME = | USER NAME = mar1n1eJ | DESIGNED - EM | REVISED - _____ |
| | | DRAWN - EM | REVISED - _____ |
| | PLOT SCALE = 3.9378' / mm | CHECKED - RW | REVISED - _____ |
| Default | PLOT DATE = 4/9/2020 | DATE - 4/9/2020 | REVISED - _____ |

STATE OF ILLINOIS
DEPARTMENT OF TRANSPORTATION

SCHEDULES - EASTBOUND LANES

SCALE: _____ SHEET 1 OF 2 SHEETS STA. _____ TO STA. _____

| | | | | |
|---------------------------|---------|---------|--------------------|-----------|
| F.A.P. RTE. | SECTION | COUNTY | TOTAL SHEETS | SHEET NO. |
| 311 | (651)PP | KENDALL | 12 | 6 |
| ILLINOIS FED. AID PROJECT | | | CONTRACT NO. 66K96 | |

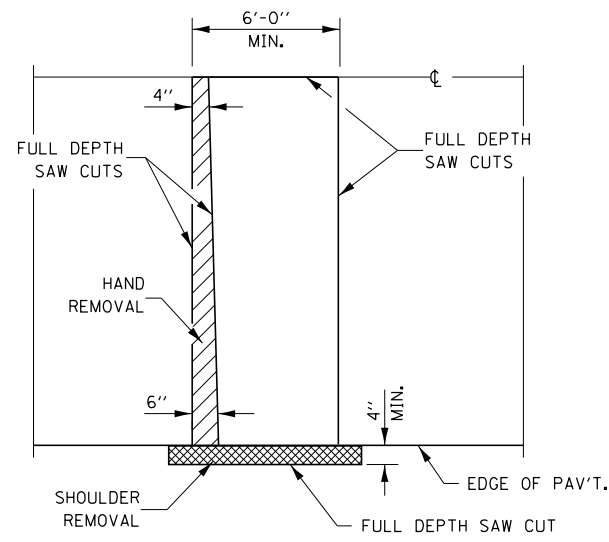

PAVEMENT SAWING DETAIL
(HMA SHOULDER)

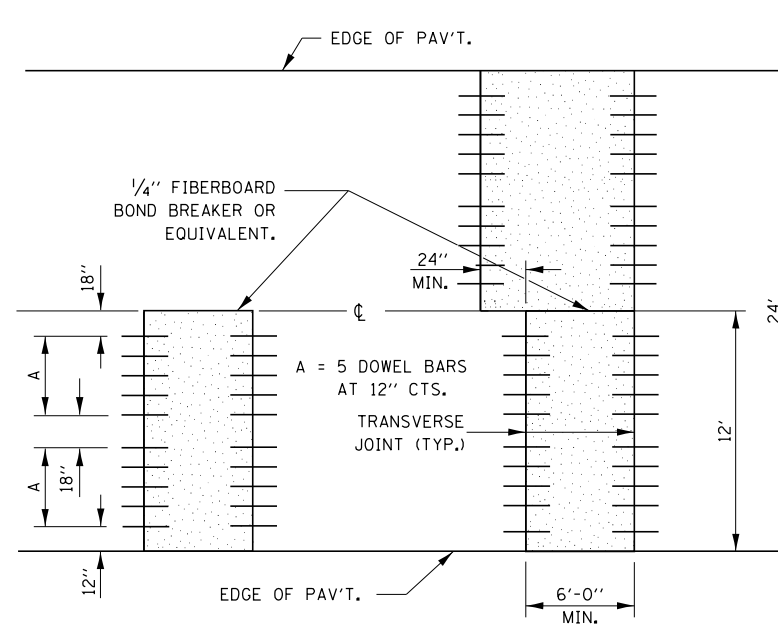

12' WIDE LANES

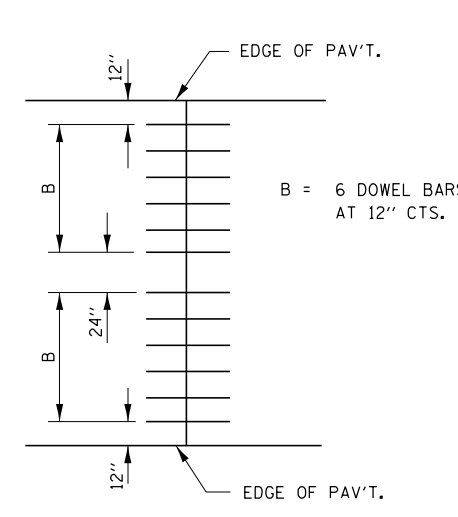

14' WIDE RAMP

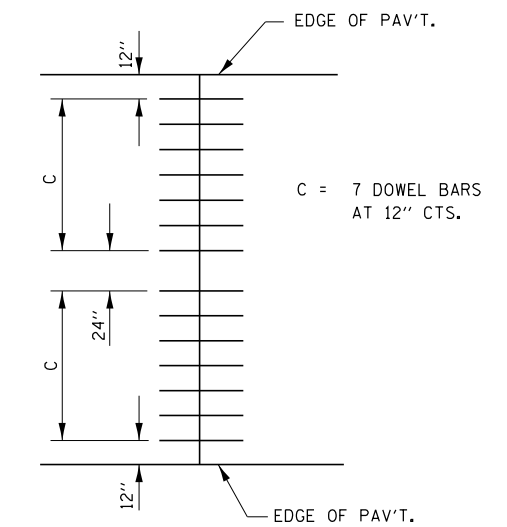

16' WIDE RAMP

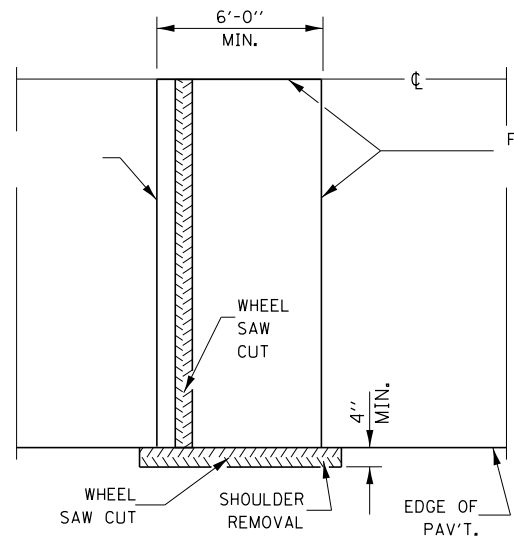

ALTERNATE SAWING DETAIL
(HMA SHOULDER)

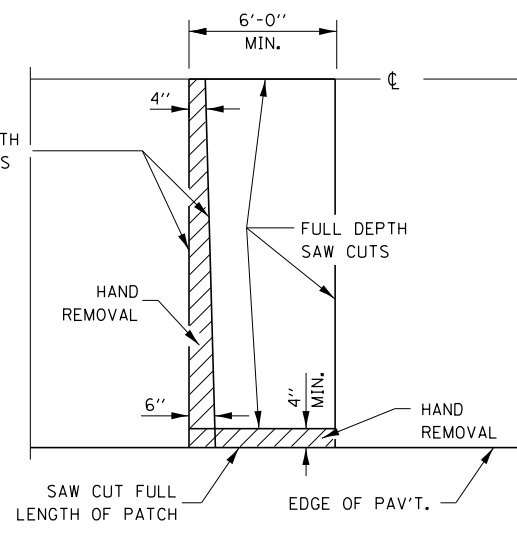

PAVEMENT SAWING DETAIL
(PCC SHOULDER)

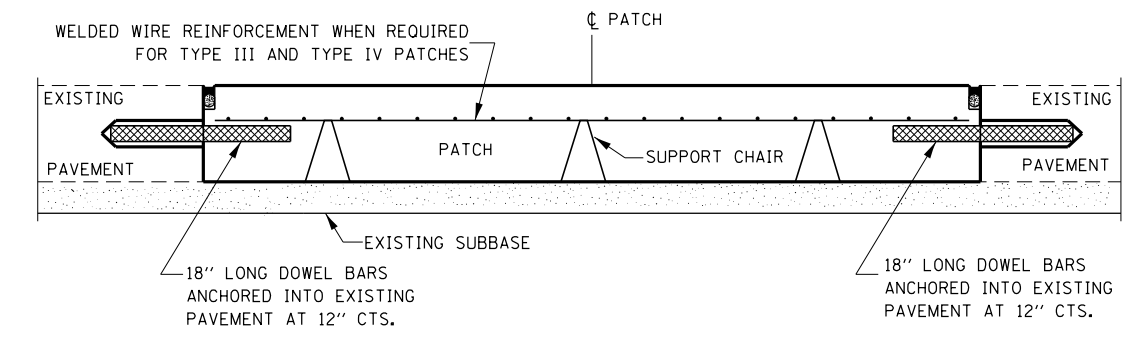

PATCHING WITHOUT HMA OVERLAY

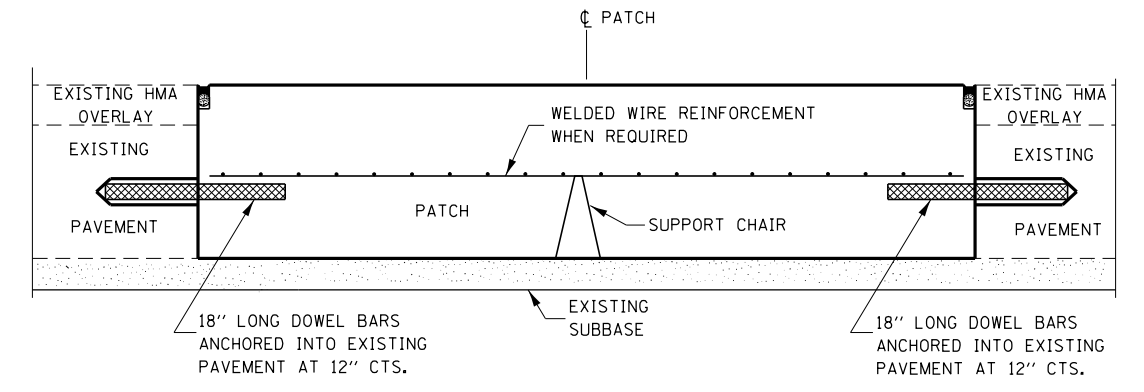

PATCHING WITH HMA OVERLAY

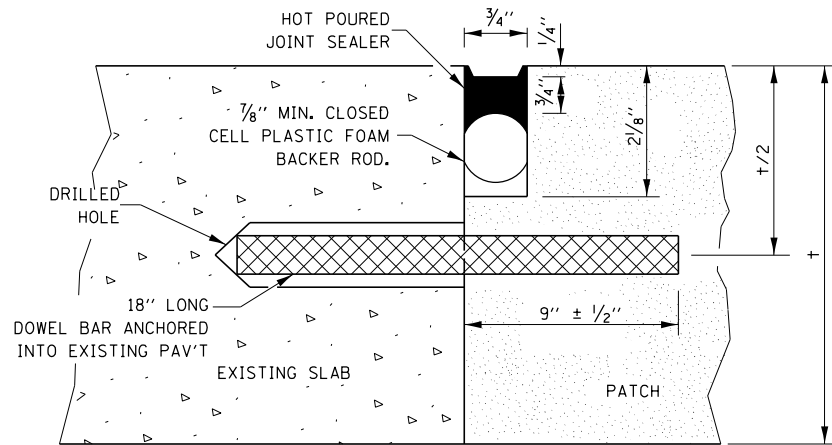

TRANSVERSE JOINT

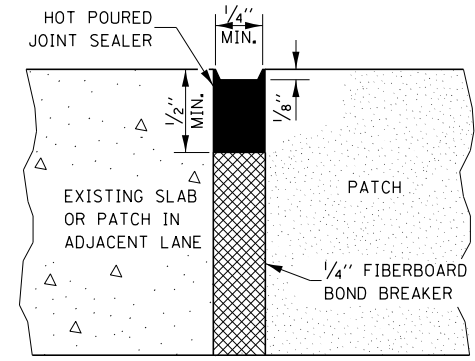

CENTERLINE JOINT

| DOWEL BAR TABLE | | |
|--------------------|--------------------|---------------|
| PAVEMENT THICKNESS | DOWEL BAR DIAMETER | HOLE DIAMETER |
| 8" OR GREATER | 1 1/2" | 1 5/8" |
| 7" THRU 7.99" | 1 1/4" | 1 3/8" |
| LESS THAN 7" | 1" | 1 1/8" |

GENERAL NOTES

THE TRANSVERSE JOINTS FOR CLASS B PATCHES SHALL ALIGN WITH JOINTS OR CRACKS IN THE ADJACENT LANE WHENEVER POSSIBLE.
SEE STANDARD 420701 FOR DETAILS OF PAVEMENT WELDED WIRE REINFORCEMENT.

| | | | |
|-------------|---------------------------|-----------------|-----------|
| FILE NAME = | USER NAME = marinoj | DESIGNED - EM | REVISED - |
| | | DRAWN - EM | REVISED - |
| | PLOT SCALE = 3.9370' / mm | CHECKED - RW | REVISED - |
| | PLOT DATE = 4/9/2020 | DATE - 4/9/2020 | REVISED - |

**STATE OF ILLINOIS
DEPARTMENT OF TRANSPORTATION**

CLASS B PATCHING DETAILS

SCALE: _____ SHEET 1 OF 2 SHEETS STA. _____ TO STA. _____

| | | | | |
|---------------------------|---------|---------|--------------|--------------------|
| F.A.P. RTE. | SECTION | COUNTY | TOTAL SHEETS | SHEET NO. |
| 311 | (651)PP | KENDALL | 12 | 8 |
| | | | | CONTRACT NO. 66K96 |
| ILLINOIS FED. AID PROJECT | | | | |

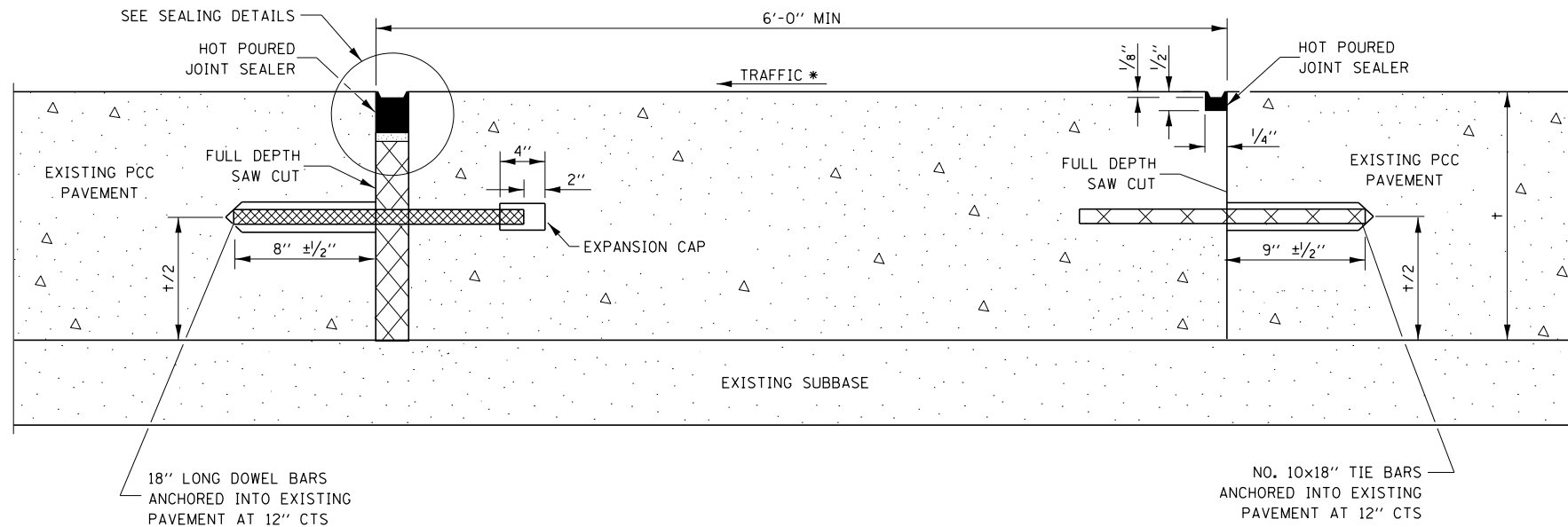

METHOD I
(WITHOUT HMA OVERLAY)

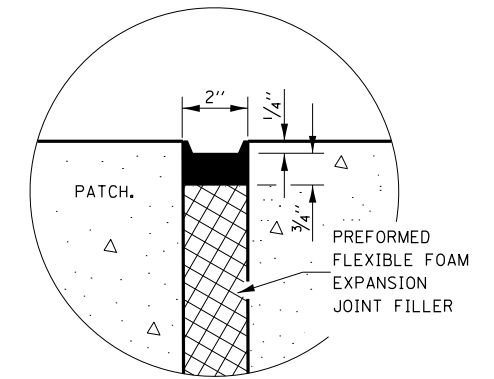

SEALING DETAIL

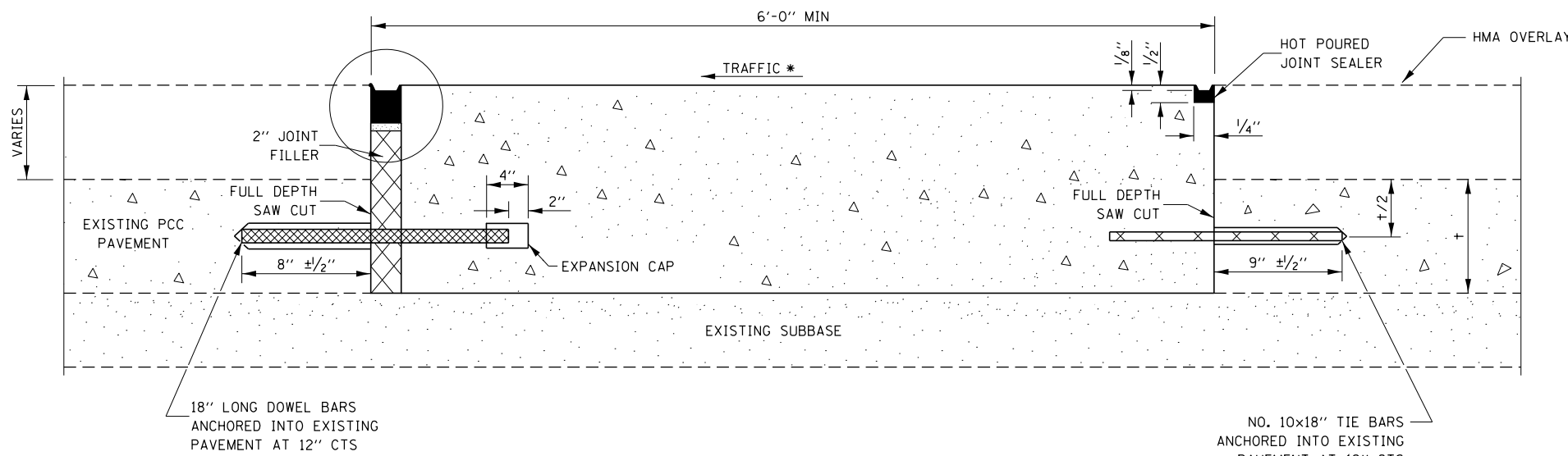

METHOD II
(WITH HMA OVERLAY)

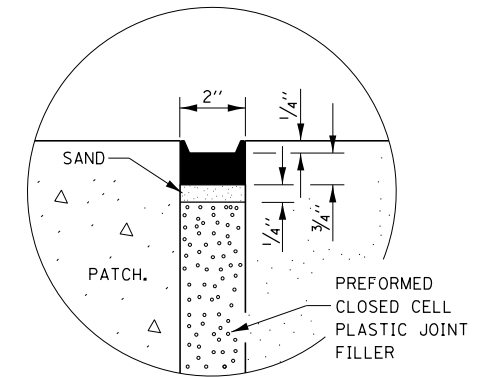

SEALING DETAIL

NOTE

* WHEN RE-ESTABLISHING A TRANSVERSE EXPANSION JOINT ON A TWO-WAY ROAD, REVERSE THE ORIENTATION OF THE DOWEL BARS WITH RESPECT TO TRAFFIC FOR ONE OF THE PATCHES SUCH THAT THE JOINT WILL BE CONTINUOUS ACROSS BOTH LANES.

| | | | | | | | | | | | |
|-------------|----------------------------|-----------------|-----------------|---|---------------------------------|---------------------------|---------|---------|--------------|-----------|--|
| FILE NAME = | USER NAME = mar1n1eJ | DESIGNED - EM | REVISED - _____ | STATE OF ILLINOIS DEPARTMENT OF TRANSPORTATION | CLASS B PATCHING DETAILS | F.A.P. RTE. | SECTION | COUNTY | TOTAL SHEETS | SHEET NO. | |
| Default | PLLOT SCALE = 3.9370' / mm | DRAWN - EM | REVISED - _____ | | | 311 | (651)PP | KENDALL | 12 | 9 | |
| | PLLOT DATE = 4/9/2020 | CHECKED - RW | REVISED - _____ | | | CONTRACT NO. 66K96 | | | | | |
| | | DATE - 4/9/2020 | REVISED - _____ | | | ILLINOIS FED. AID PROJECT | | | | | |

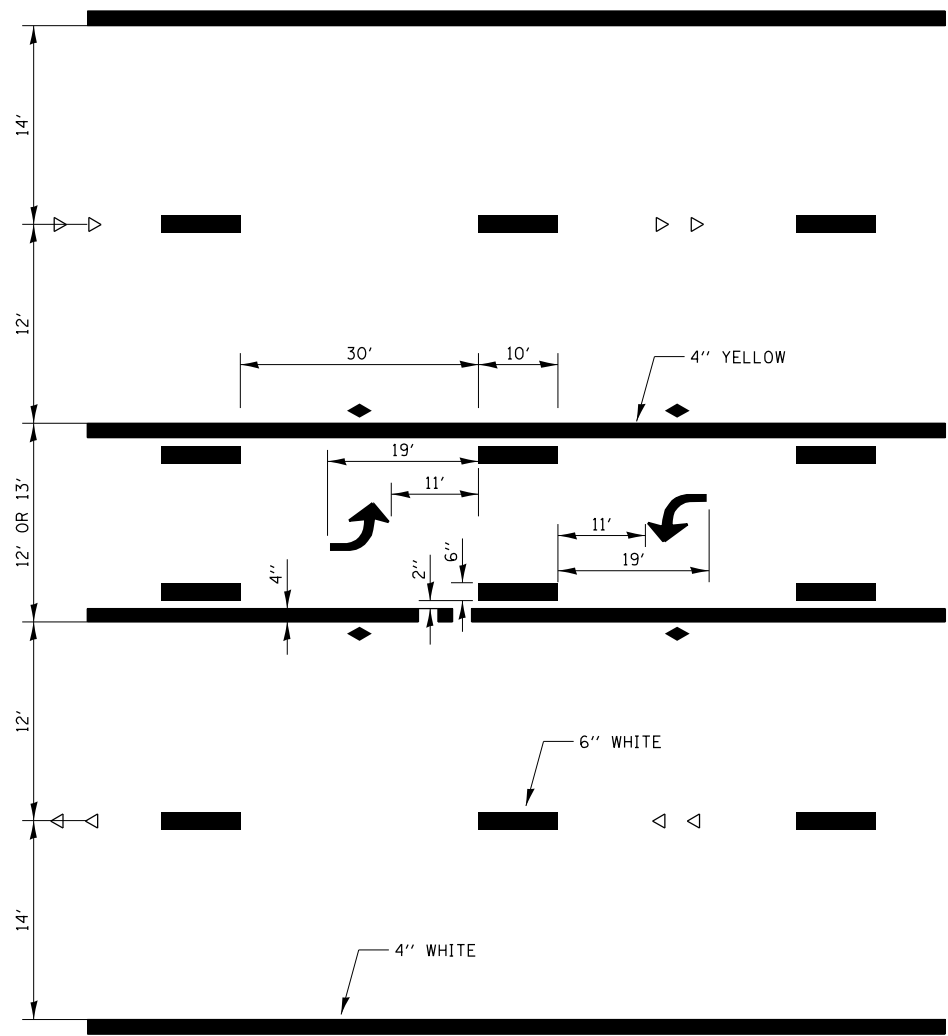

**TYPICAL APPLICATION
TWO WAY LEFT TURN LANE (TWLTL)**

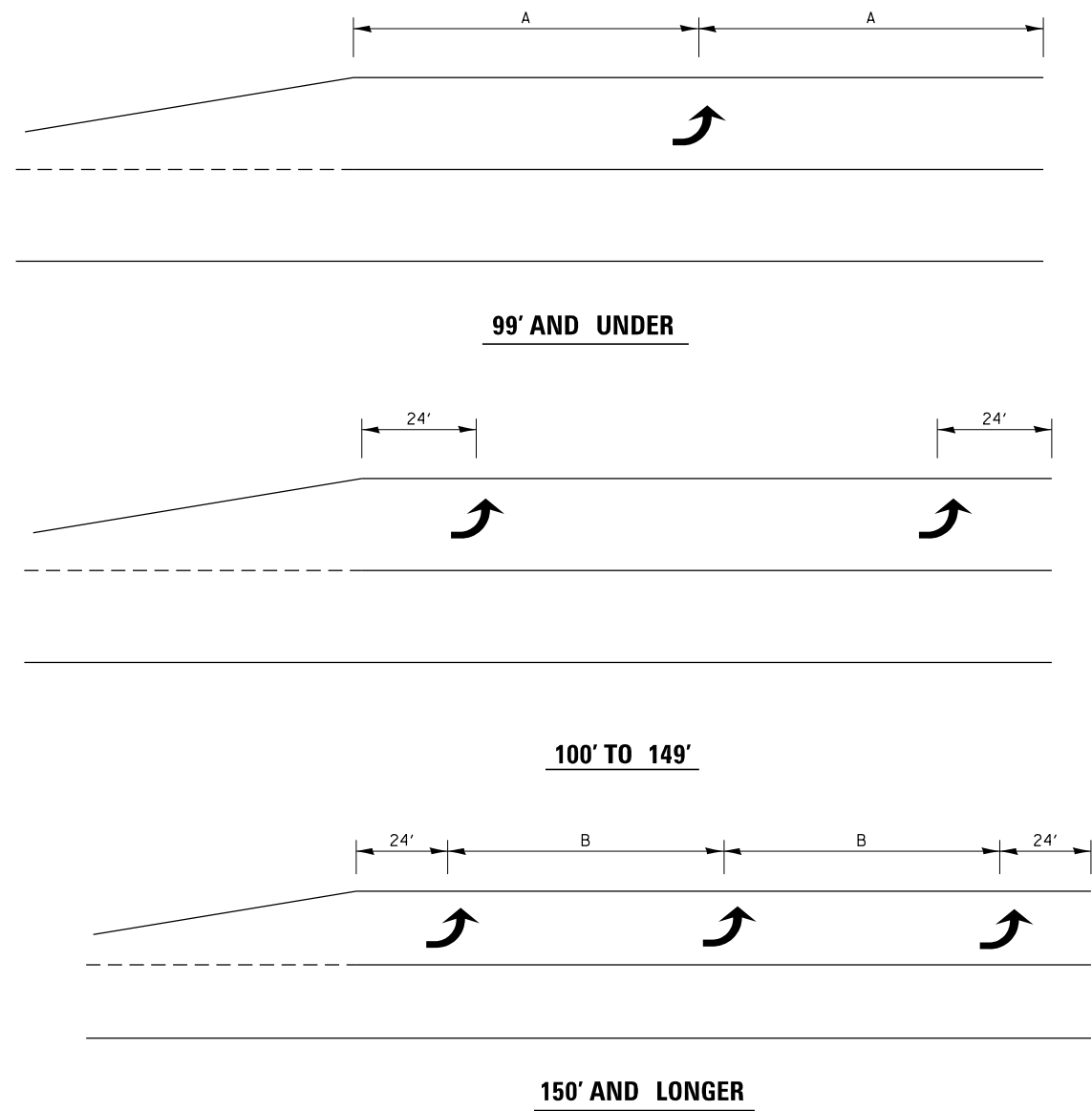

**TYPICAL PLACEMENT OF ARROWS
IN TURN LANES**

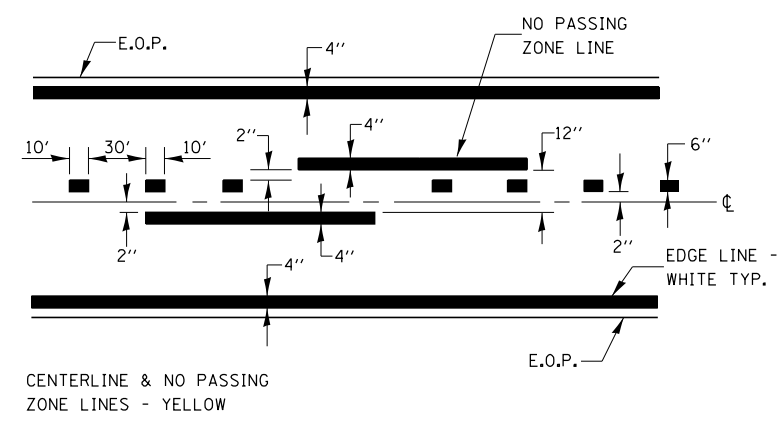

PAVEMENT MARKING

Default

| | | | |
|-------------|---------------------------|-----------------|-----------------|
| FILE NAME = | USER NAME = mar1n1eJ | DESIGNED - EM | REVISED - _____ |
| | | DRAWN - EM | REVISED - _____ |
| | PLOT SCALE = 3.9378' / mm | CHECKED - RW | REVISED - _____ |
| | PLOT DATE = 4/9/2020 | DATE - 4/9/2020 | REVISED - _____ |

**STATE OF ILLINOIS
DEPARTMENT OF TRANSPORTATION**

| | | | |
|----------------------------------|---------------------|--------------------------|--|
| TYPICAL PAVEMENT MARKINGS | | | |
| SCALE: _____ | SHEET 1 OF 2 SHEETS | STA. _____ TO STA. _____ | |

| | | | | |
|---------------------------|---------|---------|--------------|--------------------|
| F.A.P. RTE. | SECTION | COUNTY | TOTAL SHEETS | SHEET NO. |
| 311 | (651)PP | KENDALL | 12 | 10 |
| | | | | CONTRACT NO. 66K96 |
| ILLINOIS FED. AID PROJECT | | | | |

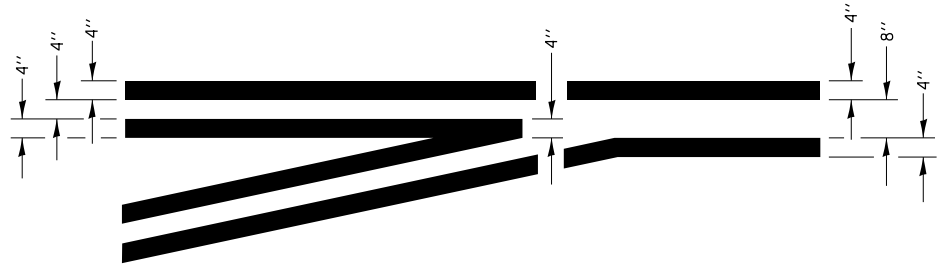
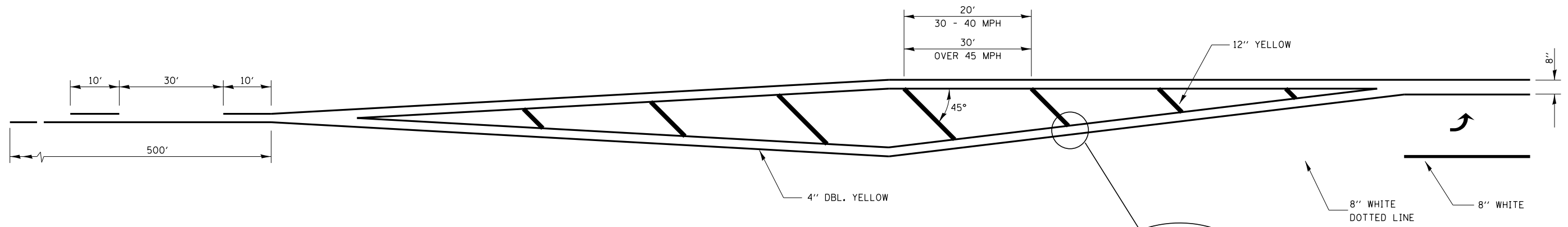

**TYPICAL APPLICATION
LEFT TURN LANES**

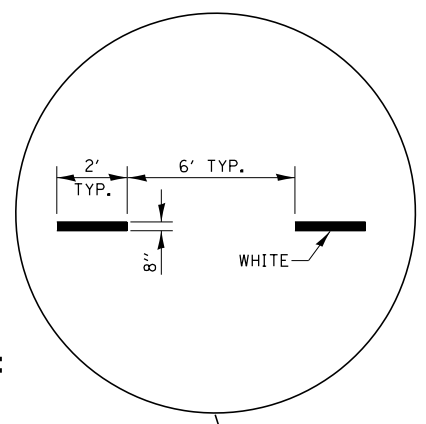

**ADVANCE AND INTERSECTION LANE
DIVIDER LINES**

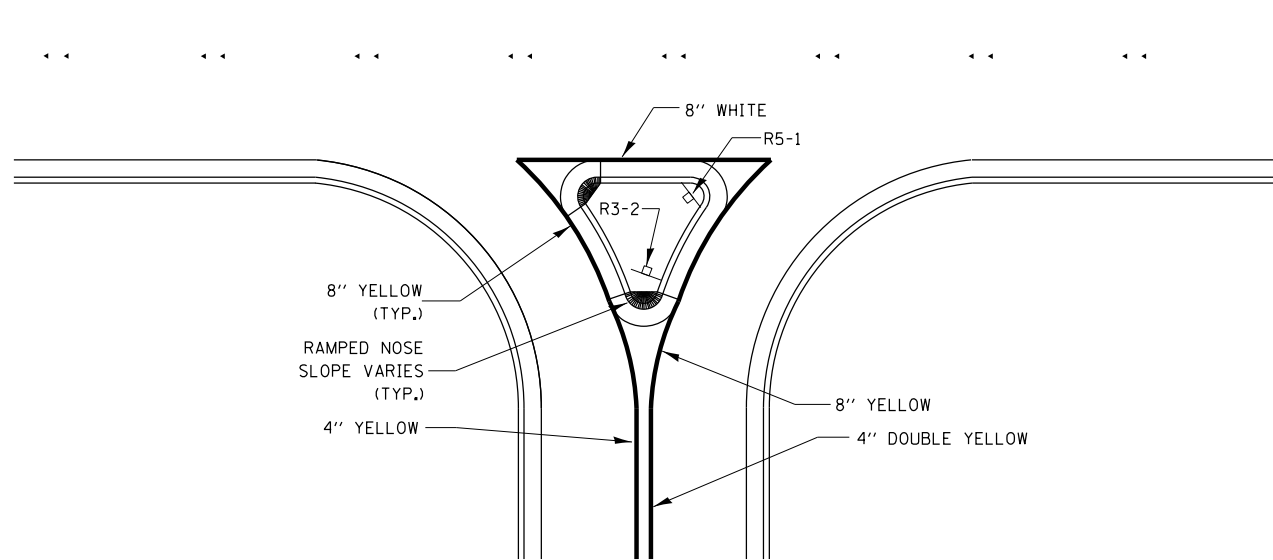

RIGHT IN RIGHT OUT ACCESS PAVEMENT MARKING

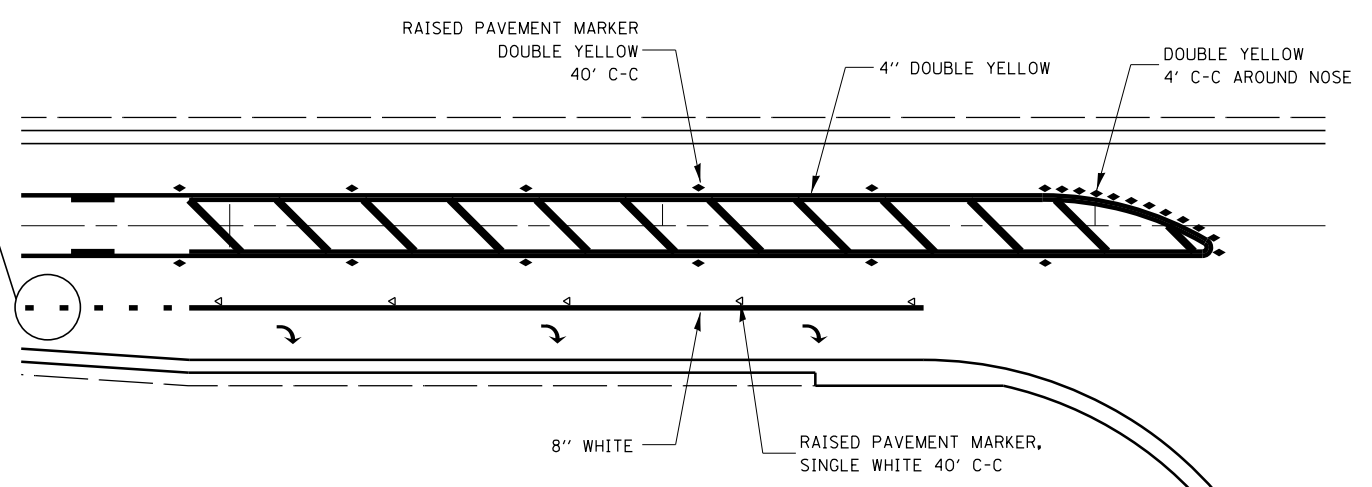

**RAISED REFLECTIVE AND PAVEMENT MARKERS
RIGHT TURN LANE**

C:\Users\marinje\Documents\VIDOT - OF Files\Documents\VIDOT - OF Files\66K96\66K96.dwg
 Default

| | | | |
|-------------|---------------------------|-----------------|-----------------|
| FILE NAME = | USER NAME = marinje | DESIGNED - EM | REVISED - _____ |
| | | DRAWN - EM | REVISED - _____ |
| | PLOT SCALE = 3.9370' / mm | CHECKED - RW | REVISED - _____ |
| | PLOT DATE = 4/9/2020 | DATE - 4/9/2020 | REVISED - _____ |

**STATE OF ILLINOIS
DEPARTMENT OF TRANSPORTATION**

TYPICAL PAVEMENT MARKINGS

SCALE: _____ SHEET 2 OF 2 SHEETS STA. _____ TO STA. _____

| | | | | |
|---------------------------|---------|---------|--------------|-----------|
| F.A.P. RTE. | SECTION | COUNTY | TOTAL SHEETS | SHEET NO. |
| 311 | (651)PP | KENDALL | 12 | 11 |
| CONTRACT NO. 66K96 | | | | |
| ILLINOIS FED. AID PROJECT | | | | |

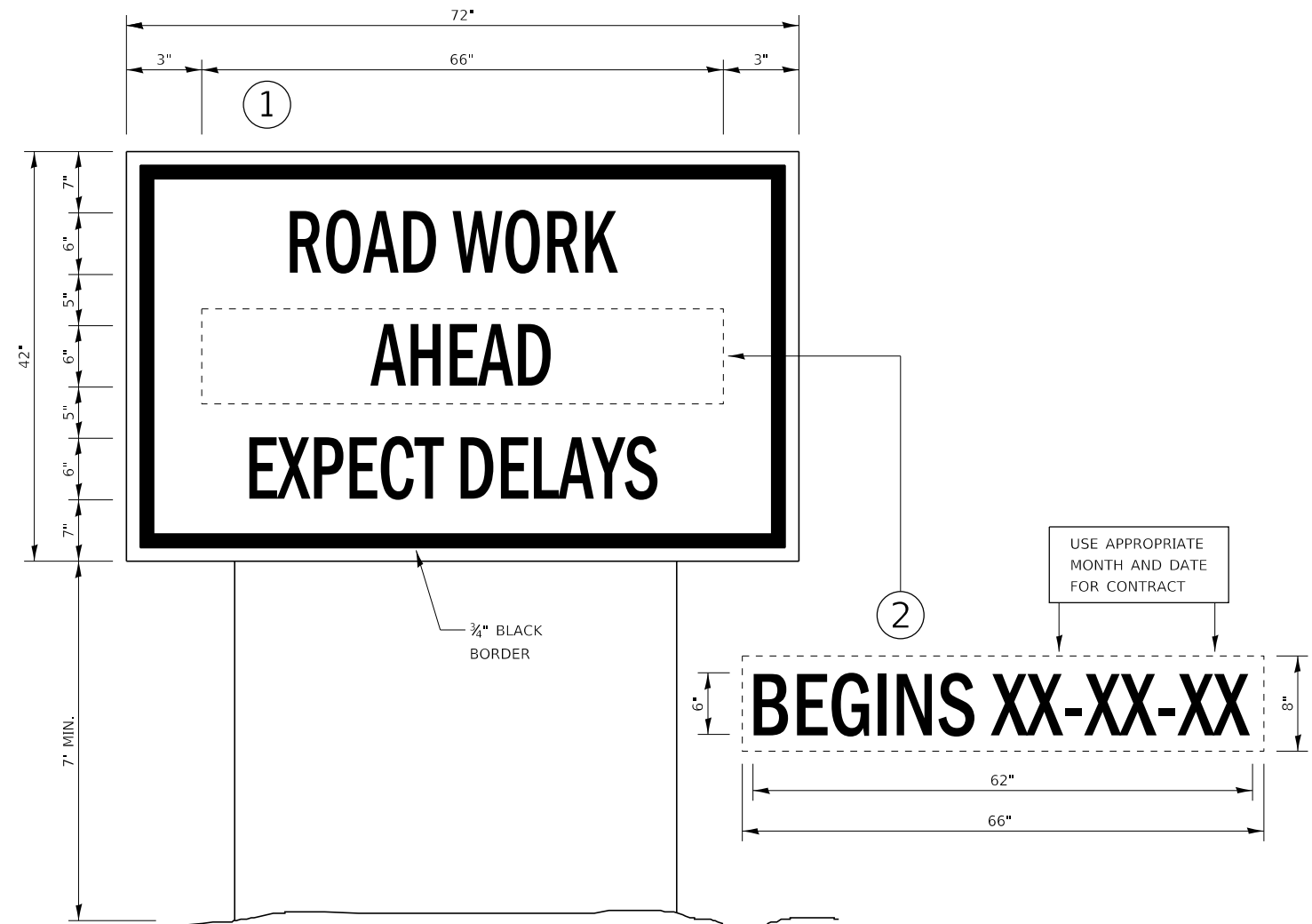

TEMPORARY INFORMATION SIGNING

NOTES:

- TEMPORARY INFORMATION SIGNS SHALL BE LOCATED OR RELOCATED AS DIRECTED BY THE ENGINEER.
- USE 6" D BLACK LETTERING ON FLUORESCENT ORANGE BACKGROUND.
- ERECT SIGNS AT LOCATIONS IN ADVANCE OF THE "ROAD CONSTRUCTION AHEAD" SIGNS AS DIRECTED BY THE ENGINEER.
- ERECT SIGN ① WITH INSTALLED PANEL ② A MINIMUM OF ONE WEEK PRIOR TO THE START OF THE LANE CLOSURE.
- REMOVE PANEL ② ON THAT DATE.
- SEE SPECIAL PROVISION "TEMPORARY INFORMATION SIGNING" FOR ADDITIONAL INFORMATION.
- WILL BE PAID FOR PER SQ FT AS "TEMPORARY INFORMATION SIGNING". EACH SIGN = 21 SQ FT AND THE DATE PANEL ② WILL NOT BE MEASURED SEPARATELY FOR PAYMENT.

| | | | |
|-------------|---------------------------|-----------------|-----------------|
| FILE NAME = | USER NAME = mar1n1eJ | DESIGNED - EM | REVISED - _____ |
| | | DRAWN - EM | REVISED - _____ |
| | PLOT SCALE = 3.9370' / mm | CHECKED - RW | REVISED - _____ |
| Default | PLOT DATE = 4/9/2020 | DATE - 4/9/2020 | REVISED - _____ |

STATE OF ILLINOIS
DEPARTMENT OF TRANSPORTATION

TEMPORARY INFORMATION SIGNING

SCALE: _____ SHEET 1 OF 1 SHEETS STA. _____ TO STA. _____

| F.A.P. RTE. | SECTION | COUNTY | TOTAL SHEETS | SHEET NO. |
|---------------------------|---------|---------|--------------------|-----------|
| 311 | (651)PP | KENDALL | 12 | 12 |
| | | | CONTRACT NO. 66K96 | |
| ILLINOIS FED. AID PROJECT | | | | |