

STATE OF ILLINOIS
DEPARTMENT OF TRANSPORTATION

F.A.I. RTE.	SECTION	COUNTY	TOTAL SHEETS	SHEET NO.
57	(27-38A,271A)CJS	FORD	7	1
		ILLINOIS	CONTRACT NO. 66K99	

INDEX OF SHEETS

- 1 COVER SHEET
- 2 GENERAL NOTES
- 3 SUMMARY OF QUANTITIES
- 4 TYPICAL SECTIONS
- 5 LINE DIAGRAM
- 6 SCHEDULES
- 7 DETAILS

LIST OF ILLINOIS DOT HIGHWAY STANDARDS

000001-07	STANDARD SYMBOLS, ABBREVIATIONS AND PATTERNS
001006	DECIMAL OF AN INCH AND OF A FOOT
701400-09	APPROACH TO LANE CLOSURE, FREEWAY/EXPRESSWAY
701406-12	LANE CLOSURE, FREEWAY/EXPRESSWAY, DAY OPERATIONS ONLY
701411-09	LANE CLOSURE, MULTILANE, AT ENTRANCE OR EXIT RAMP FOR SPEEDS ≥ 45 MPH
701901-08	TRAFFIC CONTROL DEVICES

PROPOSED HIGHWAY PLANS

FAI ROUTE 57 (I-57)
SECTION (27-38A,271A)CJS
PROJECT NHPP-EMY8(956)
CRACK & JOINT SEALING
FORD COUNTY

D-93-046-20



FUNCTIONAL CLASSIFICATION

INTERSTATE
2019 ADT = 19,500
PV = 60.7% SU = 3.0% MU = 36.3%

STATE OF ILLINOIS
DEPARTMENT OF TRANSPORTATION

SUBMITTED *May 5th 2020*
[Signature] REGIONAL ENGINEER
June 26, 2020
[Signature] ENGINEER OF DESIGN AND ENVIRONMENT
June 26, 2020
[Signature] DIRECTOR OF HIGHWAYS PROJECT IMPLEMENTATION

PRINTED BY THE AUTHORITY OF THE STATE OF ILLINOIS

BRIDGE
SN 027-0010
(OVER INTERSTATE)

BRIDGE
SN 027-0049
(OVER INTERSTATE)

BRIDGE
SN 027-0052 (SB)

BRIDGE
SN 027-0053 (NB)

PROJECT BEGINS
STA 200+00

C-93-082-20

BRIDGE
SN 027-0047
(OVER INTERSTATE)

CULVERT
SN 027-2002

BRIDGE
SN 027-0048
(OVER INTERSTATE)

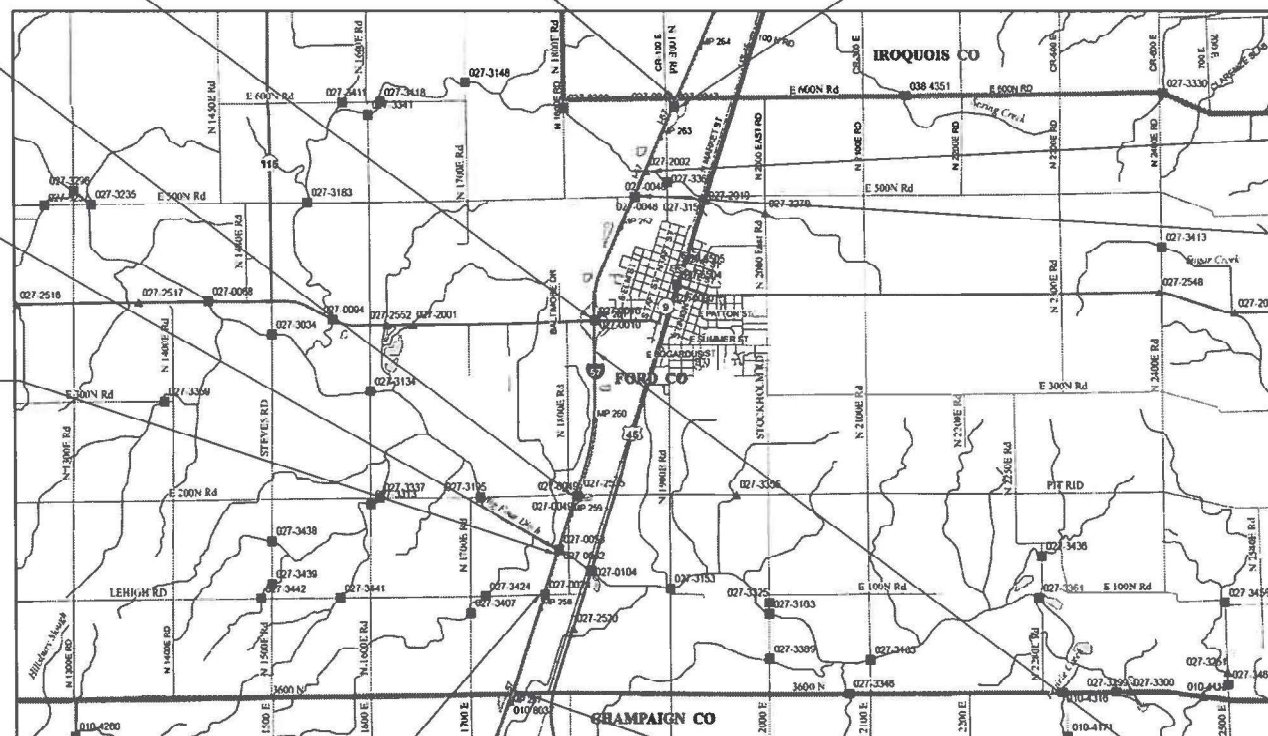

BRIDGE
SN 027-0028
(OVER INTERSTATE)

PROJECT ENDS
STA 1649+15.82

STA EQUATION:
356+50 BK =
1829+53.99 AH

GROSS LENGTH = 33528 FT. = 6.35 MILE
NET LENGTH = 33528 FT. = 6.35 MILE

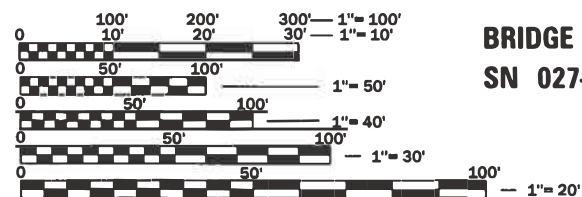

FULL SIZE PLANS HAVE BEEN PREPARED USING STANDARD ENGINEERING SCALES. REDUCED SIZED PLANS WILL NOT CONFORM TO STANDARD SCALES. IN MAKING MEASUREMENTS ON REDUCED PLANS, THE ABOVE SCALES MAY BE USED.

J.U.L.I.E.
JOINT UTILITY LOCATION INFORMATION FOR EXCAVATION
1-800-892-0123
OR 811

PROJECT ENGINEER: JACOB OYIER, PE
UNIT CHIEF: ARLENE OTERO-FEBUS
DISTRICT 3 NO. (815) 434-6131
CONTRACT NO. 66K99

GENERAL NOTES

THE INTENT OF THIS PROJECT IS TO ROUT AND SEAL WORKING TRANSVERSE CRACKS AND PRIMARY LONGITUDINAL CRACKS GREATER THAN 1/4" IN WIDTH. SECONDARY CRACKS GREATER THAN 1/4" IN WIDTH SHALL BE CLEANED AND SEALED.

THE CONTRACTOR SHALL NOT DISTURB THE EXISTING PAVEMENT MARKING OR RAISED REFLECTIVE PAVEMENT MARKERS. THE CONTRACTOR SHALL REPLACE, AT NO ADDITIONAL COST TO THE DEPARTMENT, ANY PAVEMENT MARKING OR RAISED REFLECTIVE PAVEMENT MARKERS DAMAGED BY HIS OPERATION.

THE ENGINEER SHALL DETERMINE WHETHER SECTIONS OF CRACKS SEALING SHOULD BE OMITTED IN ORDER TO AVOID DAMAGING THE PAVEMENT MARKING IN THOSE AREAS.

PLAN DIMENSIONS AND DETAIL RELATIVE TO THE EXISTING PLANS ARE SUBJECT TO ROUTINE VARIATIONS. THE CONTRACTOR SHALL FIELD VERIFY EXISTING DIMENSIONS AND DETAILS AFFECTING NEW CONSTRUCTION OF ORDERING OF MATERIALS, SUCH VARIATIONS SHALL NOT BE CAUSE FOR ADDITIONAL COMPENSATION FOR A CHANGE IN THE SCOPE OF THE WORK, HOWEVER, THE CONTRACTOR WILL BE PAID FOR THE QUANTITY FURNISHED BASED UPON THE UNIT BID PRICE.

ALL PCC BRIDGE DECKS AND PAVEMENT SHALL BE OMITTED. BRIDGE DECKS WITH HMA OVERLAYS ARE TO BE SEALED ONLY (NO ROUTING).

THE FOLLOWING RATES OF APPLICATION HAVE BEEN USED IN CALCULATING PLAN QUANTITIES:

CRACK FILLING	0.35	POUND/FOOT
---------------	------	------------

COMMITMENTS

STATE OF ILLINOIS
DEPARTMENT OF TRANSPORTATION
DISTRICT THREE
AS BUILT INFORMATION

SUPERVISING CONSTRUCTION FIELD ENGINEER

RESIDENT ENGINEER / TECHNICIAN

START & END DATES
OF CONSTRUCTION:

INSPECTORS:

STATE OF ILLINOIS
DEPARTMENT OF TRANSPORTATION
DISTRICT THREE

PREPARED BY: _____
DISTRICT STUDIES & PLANS ENGINEER

DATE: _____

EXAMINED BY: _____
DISTRICT CONSTRUCTION ENGINEER

DISTRICT MATERIALS ENGINEER

DISTRICT OPERATIONS ENGINEER

**STATE OF ILLINOIS
DEPARTMENT OF TRANSPORTATION**

GENERAL NOTES

SCALE: SHEET OF SHEETS STA. TO STA.

F.A.I. RTE.	SECTION	COUNTY	TOTAL SHEETS	SHEET NO.
57	(27-38A,271A)CJS	FORD	7	2
CONTRACT NO. 66K99				
		ILLINOIS	FED. AID PROJECT	

USER NAME = NOLASCOCJ	DESIGNED -	REVISED -
	DRAWN -	REVISED -
PLOT SCALE = 100.0000 ' / in.	CHECKED -	REVISED -
PLOT DATE = 4/30/2020	DATE -	REVISED -

MODEL: Default
 FILE: \\nlsdot\pub\lanscom\data\illinois\pwr\DOT\Documents\DOT_Offices\District_3\Projects\10366K99\CADD\data\10366K99-1r-sheet11c.dgn

CODE NO.	ITEM	UNIT	TOTAL QUANTITY	CONSTR. CODE	
				90% FED 10% STATE	
				FEDERAL FUNDING	
				ROADWAY	0005 RURAL
45100100	CRACK ROUTING (PAVEMENT)	FOOT	208789	208789	
45100200	CRACK FILLING	POUND	73075	73075	
67100100	MOBILIZATION	L SUM	1	1	
70100420	TRAFFIC CONTROL AND PROTECTION, STANDARD 701411	EACH	4	4	
70100700	TRAFFIC CONTROL AND PROTECTION, STANDARD 701406	L SUM	1	1	
70107025	CHANGEABLE MESSAGE SIGN	CAL DA	28	28	

USER NAME = NOLASCOCJ	DESIGNED -	REVISED -
	DRAWN -	REVISED -
PLOT SCALE = 100.0000' / in.	CHECKED -	REVISED -
PLOT DATE = 4/30/2020	DATE -	REVISED -

**STATE OF ILLINOIS
DEPARTMENT OF TRANSPORTATION**

SUMMARY OF QUANTITIES			
SCALE:	SHEET	OF	SHEETS

F.A.I. RTE.	SECTION	COUNTY	TOTAL SHEETS	SHEET NO.
57	(27-38A,271A)CJS	FORD	7	3
CONTRACT NO. 66K99				
ILLINOIS FED. AID PROJECT				

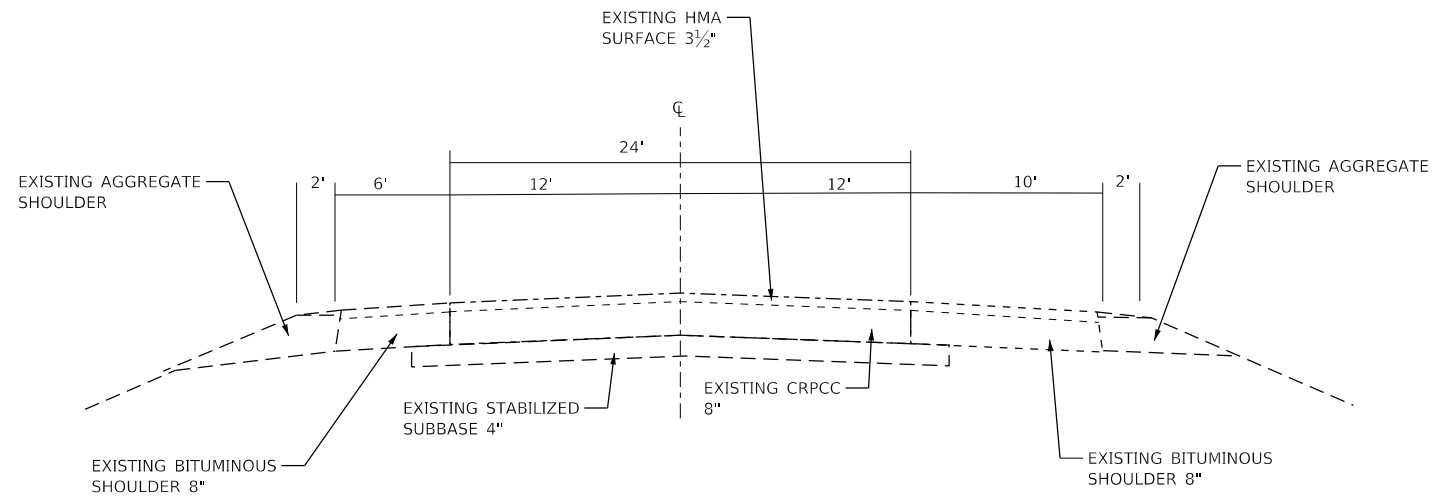

TYPICAL SECTION

STA 200+00 TO STA 1649+15.82
 (FOR BOTH SIDES, LOOKING IN THE DIRECTION OF TRAFFIC)
 PROPOSED CRACK SEALING - SEE DETAILS

MODEL: Default
 FILE: Model: 3:pub\planroom.dwg
 PROJECT: RWIDOT\Documents\DOT - Offices\District 3\Projects\ID366K99\CADD\plan\366K99-1r-detail.dgn

USER NAME = NOLASCOCJ	DESIGNED -	REVISED -
	DRAWN -	REVISED -
PLOT SCALE = 100.0000' / in.	CHECKED -	REVISED -
PLOT DATE = 4/30/2020	DATE -	REVISED -

**STATE OF ILLINOIS
 DEPARTMENT OF TRANSPORTATION**

TYPICAL SECTIONS		SCALE:	SHEET	OF	SHEETS	STA.	TO	STA.

F.A.I. RTE.	SECTION	COUNTY	TOTAL SHEETS	SHEET NO.
57	(27-38A,271A)CJS	FORD	7	4
CONTRACT NO. 66K99				
ILLINOIS			FED. AID PROJECT	

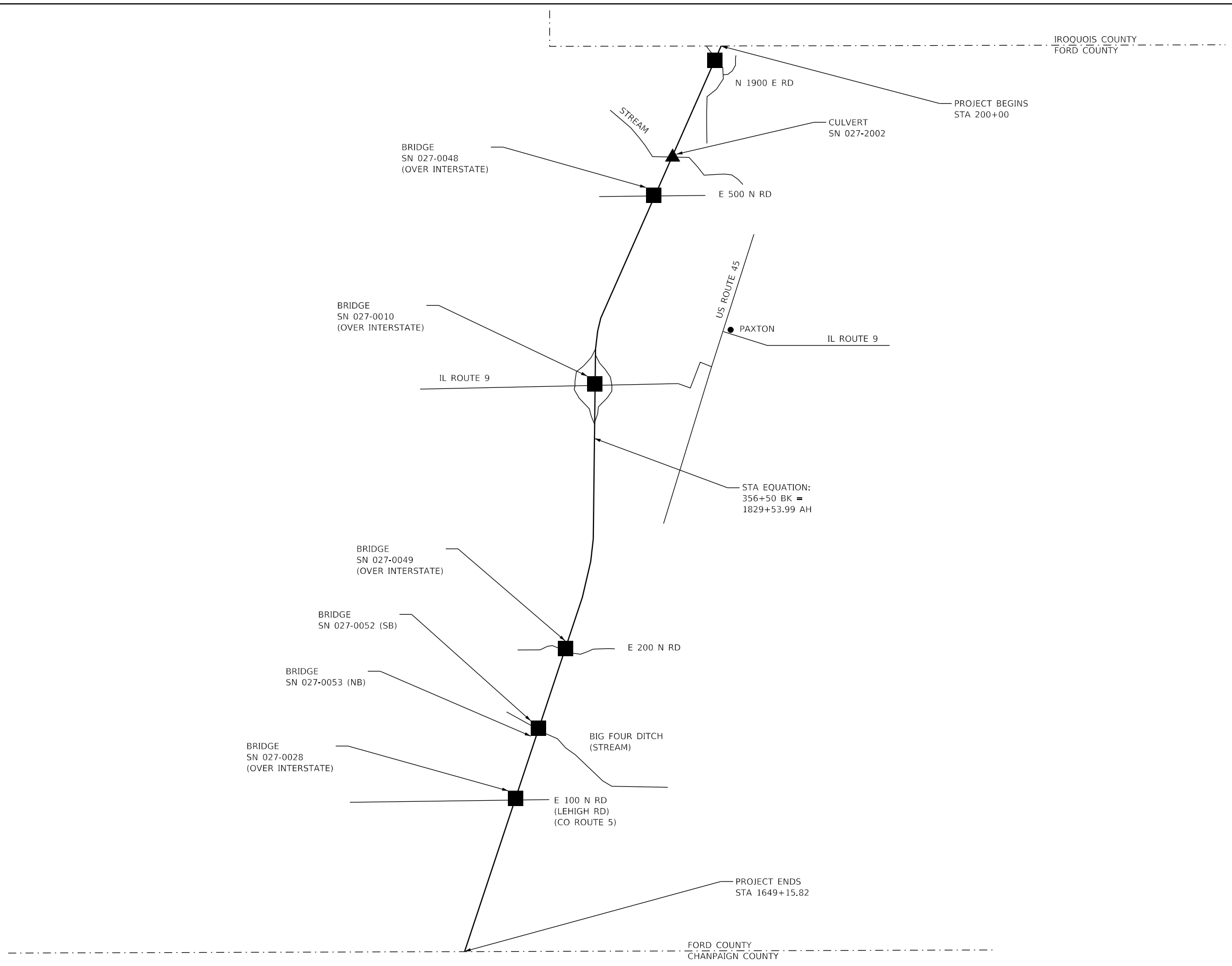

MODEL: Default
 FILE: \\nlsdot-pub\pub\lanroom\data\illinois.gov\PWIDOT\Documents\DOT_Offices\District 3\Projects\0366K99\CADD\data\0366K99-01r-detailed.dgn

USER NAME = NOLASCOCJ	DESIGNED -	REVISED -
	DRAWN -	REVISED -
PLOT SCALE = 100,0000' / in.	CHECKED -	REVISED -
PLOT DATE = 4/30/2020	DATE -	REVISED -

**STATE OF ILLINOIS
DEPARTMENT OF TRANSPORTATION**

LINE DIAGRAM

SCALE: SHEET OF SHEETS STA. TO STA.

F.A.I. RTE.	SECTION	COUNTY	TOTAL SHEETS	SHEET NO.
57	(27-38A,271A)CJ5	FORD	7	5
CONTRACT NO. 66K99				
		ILLINOIS	FED. AID PROJECT	

CRACK ROUTING AND SEALING SCHEDULE				
LOCATION	LONGITUDINAL CRACK ROUTING (PAVEMENT)	TRANSVERSE CRACK ROUTING (PAVEMENT)	LONGITUDINAL CRACK FILLING	TRANSVERSE CRACK FILLING
	FOOT	FOOT	POUND	POUND
SOUTHBOUND	102,829	1,944	35,990	680
NORTHBOUND	102,684	1,332	35,939	466
SUB-TOTAL	205,513	3,276	71,929	1,146
TOTAL	208,789		73,075	

MODEL: Default
 FILE: \\nlsdot-pub\pubroom\data\illinois.gov\PWIDOT\Documents\DOT_Offices\District_3\Projects\ID366K99\CADD\data\ID366K99-1r-sheet.dgn

USER NAME = NOLASCOCJ	DESIGNED -	REVISED -
	DRAWN -	REVISED -
PLOT SCALE = 100.0000 ' / in.	CHECKED -	REVISED -
PLOT DATE = 4/30/2020	DATE -	REVISED -

**STATE OF ILLINOIS
DEPARTMENT OF TRANSPORTATION**

SCHEDULES			
SCALE:	SHEET	OF	SHEETS

F.A.I. RTE.	SECTION	COUNTY	TOTAL SHEETS	SHEET NO.
57	(27-38A,271A)CJS	FORD	7	6
CONTRACT NO. 66K99				
		ILLINOIS	FED. AID PROJECT	

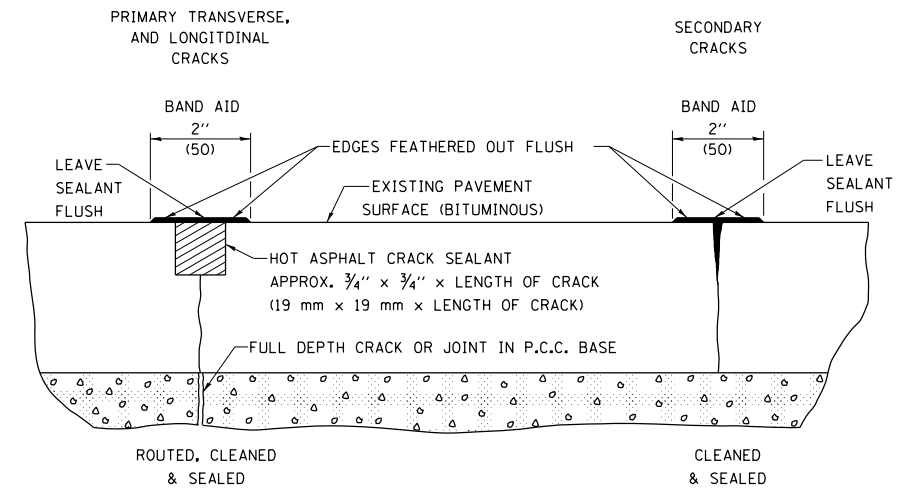

CRACK SEALING HMA PAVEMENT DETAIL

MODEL: Default
 FILE: hma15c_pavuplanroom.dwg
 I:\projects\66K99\CADD\Drawings\DOT_Offices\Detail\66K99-CRACK-SEALING.dgn

USER NAME = NOLASCOCJ	DESIGNED -	REVISED -
	DRAWN -	REVISED -
PLOT SCALE = 100.0000' / in.	CHECKED -	REVISED -
PLOT DATE = 4/30/2020	DATE -	REVISED -

**STATE OF ILLINOIS
 DEPARTMENT OF TRANSPORTATION**

DETAILS

SCALE: SHEET OF SHEETS STA. TO STA.

F.A. RTE.	SECTION	COUNTY	TOTAL SHEETS	SHEET NO.
	(27-38A,271A)CJ5	FORD	7	7
CONTRACT NO. 66K99				
ILLINOIS FED. AID PROJECT				