

STATE OF ILLINOIS
DEPARTMENT OF TRANSPORTATION

F.A.P. RTE.	SECTION	COUNTY	TOTAL SHEETS	SHEET NO.
67	(6) CR	CASS	9	1
		ILLINOIS	CONTRACT NO. 72M14	

FOR INDEX OF SHEETS, SEE SHEET NO. 2

PROPOSED IMPROVEMENTS

FAP 67 (IL 125)
SECTION (6) CR
REMOVE AND REPLACE CULVERTS

CASS CO.

C-96-112-20

D-96-083-20

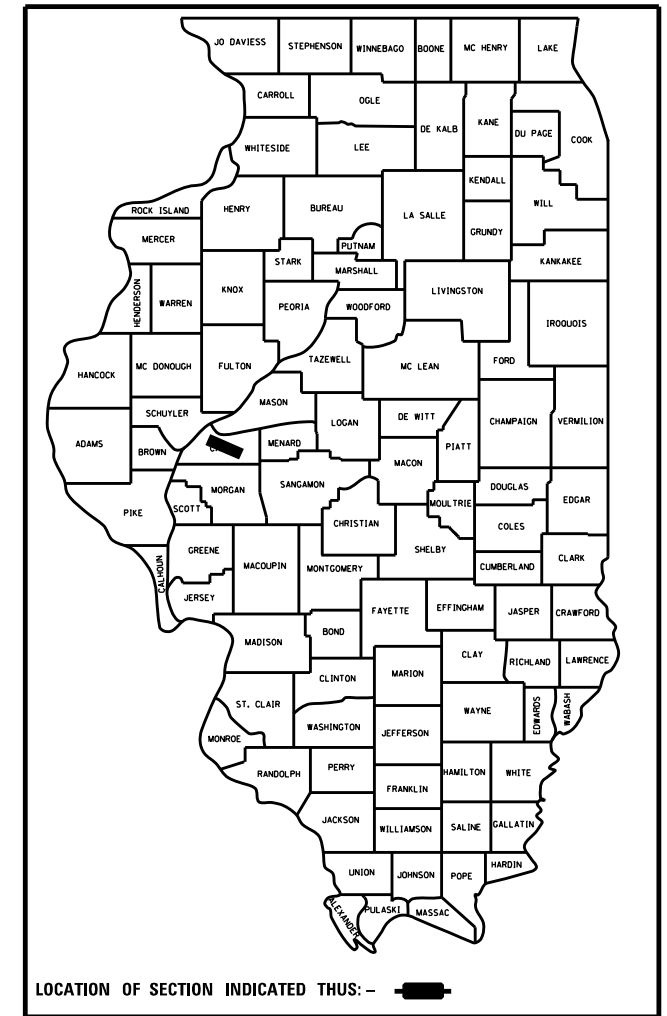

IL 125 (2019)
ADT = 1,1950
SU = 150
MU = 150

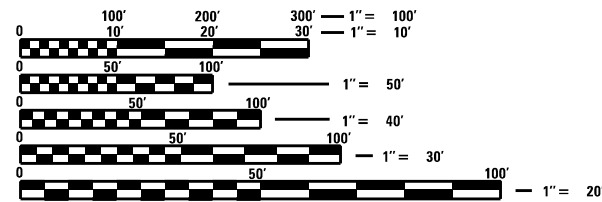
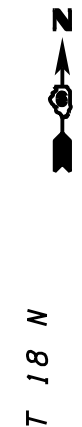

FULL SIZE PLANS HAVE BEEN PREPARED USING STANDARD ENGINEERING SCALES. REDUCED SIZED PLANS WILL NOT CONFORM TO STANDARD SCALES. IN MAKING MEASUREMENTS ON REDUCED PLANS, THE ABOVE SCALES MAY BE USED.

J.U.L.I.E.
JOINT UTILITY LOCATION INFORMATION FOR EXCAVATION
1-800-892-0123
OR 811

BEGIN PROJECT
STA. 169+45.00

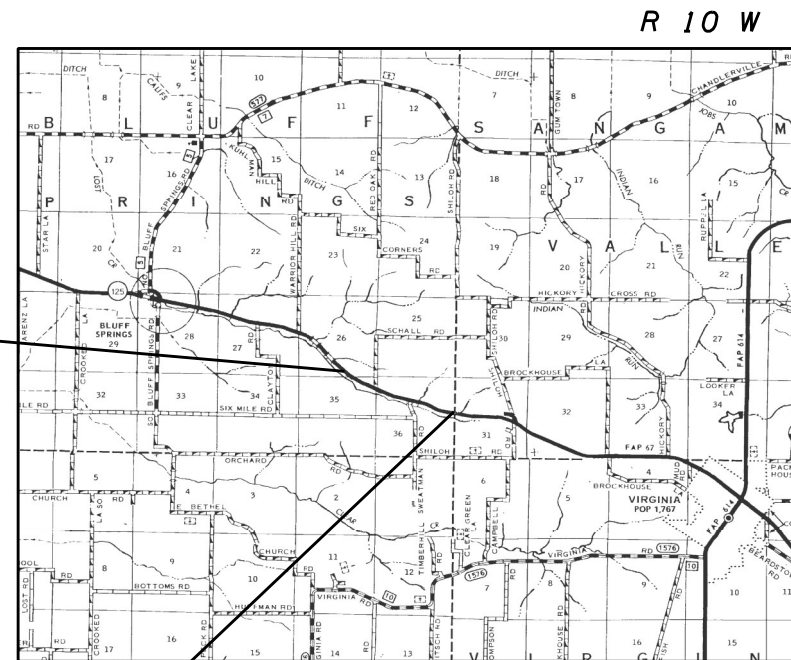

END PROJECT
STA. 242+28.20

PROJECT ENGINEER : MIKE IRWIN - (217)524-7765
PROJECT MANAGER : TIM SHARP - (217)524-9160

CONTRACT NO. 72M14

STATE OF ILLINOIS
DEPARTMENT OF TRANSPORTATION

SUBMITTED May 19 20 20

Jeff P. Myer
REGION FOUR ENGINEER

June 26, 2020
Joe E.A. Etk
ENGINEER OF DESIGN AND ENVIRONMENT

June 26, 2020
James J. ...
DIRECTOR OF HIGHWAYS PROJECT IMPLEMENTATION 13



PRINTED BY THE AUTHORITY
OF THE STATE OF ILLINOIS

INDEX OF SHEETS

SHEET NO.	DESCRIPTION
1.	COVER SHEET
2.	INDEX OF SHEETS, STANDARDS, GENERAL NOTES & SIGNATURE
3.	SUMMARY OF QUANTITIES
4.	SCHEDULE OF QUANTITIES
5-8.	PROJECT LOCATION MAP
9.	TYPICAL SECTIONS

STANDARDS

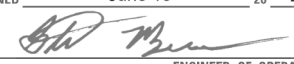
STANDARD NO.	DESCRIPTION
542301-03	PRECAST REINFORCED CONCRETE FLARED END SECTION
701001-02	OFF-RD OPERATIONS, 2L, 2W, MORE THAN 15' AWAY
701006-05	OFF-RD OPERATIONS, 2L, 2W, 15' TO 24" FROM PAVEMENT EDGE
701011-04	OFF-RD MOVING OPERATIONS, 2L, 2W, DAY ONLY
701201-05	LANE CLOSURE, 2L, 2W, DAY ONLY, FOR SPEEDS \geq 45 MPH
701901-08	TRAFFIC CONTROL DEVICES

STATE OF ILLINOIS DEPARTMENT OF TRANSPORTATION DIVISION OF HIGHWAYS DISTRICT 6	
EXAMINED	June 15 20 20
 ENGINEER OF OPERATIONS	
EXAMINED	June 15 20 20
 ENGINEER OF PROJECT IMPLEMENTATION	
EXAMINED	June 15 20 20
 ENGINEER OF PROGRAM DEVELOPMENT	

FILE NAME =	USER NAME = sharptd	DESIGNED - _____	REVISED - _____	STATE OF ILLINOIS DEPARTMENT OF TRANSPORTATION	INDEX OF SHEETS, STANDARDS GENERAL NOTES, SIGNATURES	F.A.P. RTE.	SECTION	COUNTY	TOTAL SHEETS	SHEET NO.	
S:\CONTRMAINT_CAD\72M14 - Cass Co pipe	subverts\PLANS\72M14-sht-2-gennote.dgn	DRAWN - DMS	REVISED - _____			67	(6) CR	CASS	9	2	
Default	PLOT SCALE = 40.0000' / in.	CHECKED - _____	REVISED - _____			CONTRACT NO. 72M14					
	PLOT DATE = 5/5/2020	DATE - _____	REVISED - _____			ILLINOIS FED. AID PROJECT					

CODE NO.	ITEM	UNIT	TOTAL QUANTITY	0-02175-6009
				CONSTR. CODE
				100 STATE CASS
				PIPE CULVERT 0004
				RURAL
20800150	TRENCH BACKFILL	CU YD	300	300
44213204	TIE BARS 3/4"	EACH	96	96
44201377	CLASS C PATCHES, TYPE II, 12 INCH	SQ YD	88	88
50104400	CONCRETE HEADWALL REMOVAL	EACH	10	10
50105220	PIPE CULVERT REMOVAL	FOOT	269	269
542A0220	PIPE CULVERTS, CLASS A, TYPE 1 15"	FOOT	109	109
542A0223	PIPE CULVERTS, CLASS A, TYPE 1 18"	FOOT	50	50
542A0229	PIPE CULVERTS, CLASS A, TYPE 1 24"	FOOT	110	110
54213660	PRECAST REINFORCED CONCRETE FLARED END SECTIONS 15"	EACH	4	4
54213663	PRECAST REINFORCED CONCRETE FLARED END SECTIONS 18"	EACH	2	2
54213669	PRECAST REINFORCED CONCRETE FLARED END SECTIONS 24"	EACH	4	4
67100100	MOBILIZATION	L SUM	1	1
70100450	TRAFFIC CONTROL AND PROTECTION, STANDARD 701201	L SUM	1	1

FILE NAME =	USER NAME = SHARPTD	DESIGNED - _____	REVISED - _____
S:\CONTRMAINT_CAD\72M14 - Cass Co pipe	culverts\PLANS\72M14-sht-3-500.dgn	DRAWN - DMS	REVISED - _____
Default	PLOT SCALE = 40.0000' / in.	CHECKED - _____	REVISED - _____
	PLOT DATE = 5/22/2020	DATE - _____	REVISED - _____

**STATE OF ILLINOIS
DEPARTMENT OF TRANSPORTATION**

SUMMARY OF QUANTITIES

SCALE: _____ SHEET _____ OF _____ SHEETS STA. _____ TO STA. _____

F.A.P. RTE.	SECTION	COUNTY	TOTAL SHEETS	SHEET NO.
67	(6) CR	CASS	9	3
CONTRACT NO. 72M14			ILLINOIS FED. AID PROJECT	

PATCHING SCHEDULE						
LOCATION	STATION	ROAD		AREA	CLASS C, TY II, 12"	TIE BARS
		LENGTH (FT)	WIDTH (FT)	SQ YD	SQ YD	12" CENTERS
IL 125	169+45 LT	7.00	14.00	10.89	10.89	12.00
	169+45 RT	7.00	14.00	10.89	10.89	12.00
	185+71.5 LT	7.00	14.00	10.89	10.89	12.00
	185+71.5 RT	7.00	14.00	10.89	10.89	12.00
	189+91 LT	7.00	14.00	10.89	10.89	12.00
	189+91 RT	7.00	14.00	10.89	10.89	12.00
	197+95 LT	7.00	14.00	10.89	10.89	12.00
	197+95 RT	7.00	14.00	10.89	10.89	12.00
	242+28.2 LT	7.00	14.00	10.89	10.89	12.00
	242+28.2 RT	7.00	14.00	10.89	10.89	12.00
TOTAL:				88.00	96.00	



EXIST. CMP 53 L.F.
0° SKEW
AND HEADWALL
TO BE REMOVED

LOCATION #1
STA. 169+45
PIPE CULVERT 15",
CLASS A, TY. 1, 53 L.F.
PRCFES 15"
0 ° SKEW
NOTE: FIT TO FIELD CONDITIONS

FILE NAME = S:\CONTRMAINT_CAD\72M14 - Cass Co pipe	USER NAME = sharptd culverts\PLANS\72M14-sht-5-8-plans.dgn	DESIGNED - _____ DRAWN - _____	REVISED - _____ REVISED - _____	STATE OF ILLINOIS DEPARTMENT OF TRANSPORTATION	LOCATION MAP			F.A.P. RTE. 67	SECTION 161 CR	COUNTY CASS	TOTAL SHEETS 9	SHEET NO. 5
Default	PLOT SCALE = 40.0000' / in. PLOT DATE = 5/5/2020	CHECKED - _____ DATE - _____	REVISED - _____ REVISED - _____		SCALE: _____	SHEET _____	OF _____	SHEETS	STA. _____	TO STA. _____	CONTRACT NO. 72M14	
<small>ILLINOIS FED. AID PROJECT</small>												



EXIST. CMP 50 L.F.
0° SKEW
AND HEADWALL
TO BE REMOVED

LOCATION #2
STA. 185+71.5
PIPE CULVERT 18",
CLASS A, TY. 1, 50 L.F.
0 ° SKEW
PRCFES 18"
NOTE: FIT TO FIELD CONDITIONS

LOCATION #3
STA. 189+91
PIPE CULVERT 24",
CLASS A, TY. 1, 60 L.F.
0 ° SKEW
PRCFES 24"
NOTE: FIT TO FIELD CONDITIONS

EXIST. CMP 60 L.F.
0° SKEW
AND HEADWALL
TO BE REMOVED

FILE NAME = S:\CONTRMAINT_CAD\72M14 - Cass Co pipe	USER NAME = sharptd culverts\PLANS\72M14-sht-5-8-plans.dgn	DESIGNED - _____ DRAWN - _____	REVISED - _____ REVISED - _____	STATE OF ILLINOIS DEPARTMENT OF TRANSPORTATION	LOCATION MAP			F.A.P. RTE. 67	SECTION 16) CR	COUNTY CASS	TOTAL SHEETS 9	SHEET NO. 6
Default	PLOT SCALE = 40.0000' / in.	CHECKED - _____ DATE - _____	REVISED - _____ REVISED - _____		SCALE: _____	SHEET _____	OF _____	SHEETS	STA. _____	TO STA. _____	CONTRACT NO. 72M14	
	PLOT DATE = 5/5/2020				<small>ILLINOIS FED. AID PROJECT</small>							



LOCATION #4
 STA. 197+95
 PIPE CULVERT 24",
 CLASS A, TY. 1, 50 L.F.
 0°SKEW
 PRCFES 24"
 NOTE: FIT TO FIELD CONDITIONS

EXIST. CMP 50 L.F.
 0° SKEW
 AND HEADWALL
 TO BE REMOVED

FILE NAME =	USER NAME = sharptd	DESIGNED - _____	REVISED - _____	STATE OF ILLINOIS DEPARTMENT OF TRANSPORTATION	LOCATION MAP			F.A.P. RTE.	SECTION	COUNTY	TOTAL SHEETS	SHEET NO.
S:\CONTRMAINT_CAD\72M14 - Cass Co pipe	culverts\PLANS\72M14-sht-5-8-plans.dgn	DRAWN - _____	REVISED - _____		67	161 CR	CASS	9	7			
Default	PLOT SCALE = 40.0000' / in.	CHECKED - _____	REVISED - _____		CONTRACT NO. 72M14							
	PLOT DATE = 5/5/2020	DATE - _____	REVISED - _____		ILLINOIS FED. AID PROJECT							
				SCALE: _____	SHEET _____	OF _____	SHEETS	STA. _____	TO STA. _____			



LOCATION #5
 STA. 242+28.2
 PIPE CULVERT 15",
 CLASS A, TY. 1, 56 L.F.
 0° SKEW
 PRCFES 15"
 NOTE: FIT TO FIELD CONDITIONS

EXIST. CMP 56 L.F.
 0° SKEW
 AND HEADWALL
 TO BE REMOVED

FILE NAME =	USER NAME = sharptd	DESIGNED - _____	REVISED - _____	STATE OF ILLINOIS DEPARTMENT OF TRANSPORTATION	LOCATION MAP		F.A.P. RTE.	SECTION	COUNTY	TOTAL SHEETS	SHEET NO.
S:\CONTRMAINT_CAD\72M14 - Cass Co pipe	culverts\PLANS\72M14-sht-5-8-plans.dgn	DRAWN - _____	REVISED - _____		67	161 CR	CASS	9	8	CONTRACT NO. 72M14	
Default	PLOT SCALE = 40.0000' / in.	CHECKED - _____	REVISED - _____		SCALE: _____ SHEET _____ OF _____ SHEETS STA. _____ TO STA. _____		ILLINOIS FED. AID PROJECT				
	PLOT DATE = 5/5/2020	DATE - _____	REVISED - _____								

OLD ROUTE 54/36

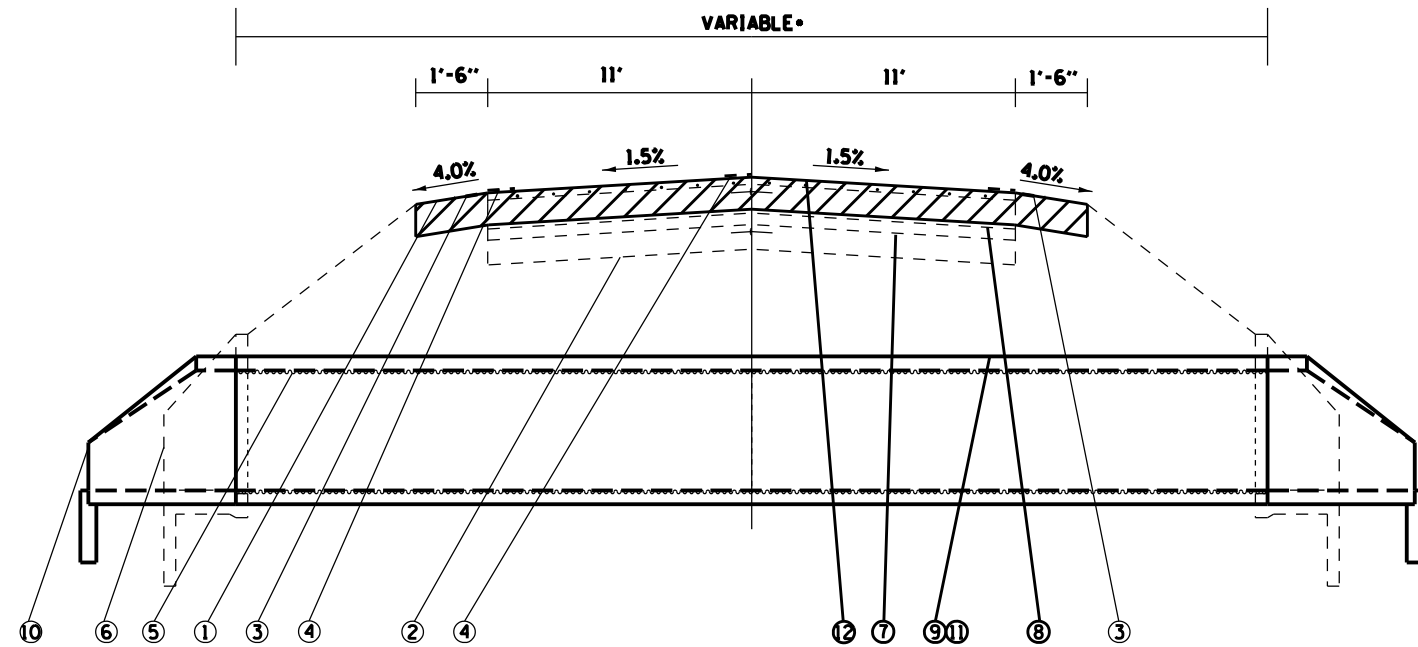

TYPICAL SECTION
STA. 169+45 TO 242+28.2

LEGEND

- ① EXIST. HMA SHOULDERS, 8"
- ② EXIST. PCC PAVEMENT, 9-6-9
- ③ EXIST. RUMBLE STRIP
- ④ EXIST. PAVEMENT MARKING-LINE, 5"
- ⑤ EXIST. PIPE CULVERTS, TY. 1 (RCCP), 30"
- ⑥ EXIST. CONC. HEADWALLS FOR PIPE DRAINS
- ⑦ EXIST. GRANULAR EMBANKMENT 3" TO 48"
- ⑧ EXIST. H.M.A. SURFACE 6 1/2"
- ⑨ PROP. PIPE CULVERT REMOVAL
- ⑩ PROP. PRECAST REINFORCED CONCRETE FLARED END SECTIONS, 24" & 30" (FIT TO FIELD CONDITIONS)
- ⑪ PROP. PIPE CULVERTS, CLASS A, TY. 1 & 2, 24" & 30" (FIT TO FIELD CONDITIONS)
- ⑫ PROP. CLASS C PATCHES, TYPE II

NOTES:

1. THE ROAD LANE SHALL BE KEPT OPEN TO TRAFFIC ACCORDING TO ARTICLE 701.17(e). NO BROKEN PAVEMENT, OPEN HOLES, OR PARTIALLY FILLED PATCHES SHALL REMAIN OVERNIGHT AND ALL DEVICES SHALL BE REMOVED BEFORE DARK. USE TEMPORARY PATCHES OF 6 INCHES OF COLD BITUMINOUS MIX TO MATCH THE EXISTING SURFACE AS NEEDED. THIS WORK WILL BE CONSIDERED AS INCIDENTAL.
2. ALL THE NEW PIPE CULVERTS SHALL BE INSTALLED SATISFYING THE FIELD CONDITIONS.

MODEL: D:\p\h\it FILE NAME: S:\CONTRACT\MANT CAD\72M14 - Cass Co pipe culverts\PLANS\72M14-211-212-213-214.dwg

USER NAME = sharptd	DESIGNED -	REVISED -
	DRAWN -	REVISED -
PLOT SCALE = 40.0000' / in.	CHECKED -	REVISED -
PLOT DATE = 5/5/2020	DATE -	REVISED -

STATE OF ILLINOIS
DEPARTMENT OF TRANSPORTATION

TYPICAL SECTIONS

SCALE: SHEET OF SHEETS STA. TO STA.

F.A.P. RTE.	SECTION	COUNTY	TOTAL SHEETS	SHEET NO.
554	(18) CR, (18G) CR-1	CASS	9	9
			CONTRACT NO. 72L61	
ILLINOIS FED. AID PROJECT				