

F.A.S.	SECTION	COUNTY	TOTAL SHEETS	SHEET NO.
806	17-00084-00-RS	WABASH	5	1
FED. ROAD DIST. NO.		ILLINOIS	BRIDGEPORT BLACKTOP	

**INDEX OF SHEETS**

07-31-2020 LETTING ITEM 061

SHEET NO.	DESCRIPTION
1.	COVER SHEET
2.	TYPICAL SECTIONS, SUMMARY OF QUANTITIES, AND GENERAL NOTES
3.	MISCELLANEOUS DETAILS AND SCHEDULES
4.	PIPE CULVERT DETAILS
5.	STATION 106+90.8 TO STATION 108+22.0 INTERSECTION IMPROVEMENT HIGHWAY STANDARDS: SEE SHEET 2

STATE OF ILLINOIS  
DEPARTMENT OF TRANSPORTATION  
DIVISION OF HIGHWAYS  
**PLANS FOR PROPOSED  
FEDERAL-AID SECONDARY PROJECT**

WABASH COUNTY  
FAS 806 (COUNTY HIGHWAY 4)  
SECTION: 17-00084-00-RS  
JOB NO.: C-97-070-19  
PROJECT NO.: SFH9(301)  
CONTRACT NO.: 95856

**UTILITIES**

- RURAL WABASH WATER DISTRICT  
P.O. BOX 55; LANCASTER, IL 62855  
PHONE: (618)-665-3311
- MT. CARMEL PUBLIC UTILITY  
316 MARKET STREET; MT. CARMEL, IL 62863
- NORRIS ELECTRIC COOP.  
8543 NORTH STATE HWY 130 SOUTH; NEWTON, IL 62448  
PHONE: (618)-299-6101
- FRONTIER COMMUNICATIONS  
200 WEST CHERRY STREET; CARMEL, IL 62821  
PHONE: (618)-382-2887
- NEW WAVE COMMUNICATIONS  
1 MONTGOMERY PLAZA, 4TH FLOOR; SIKESTON, MO 63801  
PHONE: (618)283-9630



Know what's below.  
Call before you dig.

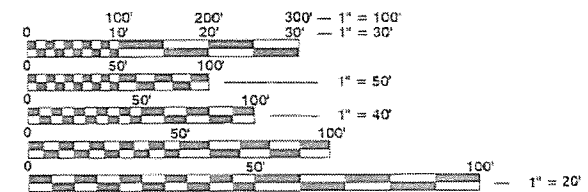

FULL SIZE PLANS HAVE BEEN PREPARED USING STANDARD ENGINEERING SCALES. REDUCED SIZE PLANS WILL NOT CONFORM TO STANDARD SCALES. IN MAKING MEASUREMENTS ON REDUCED PLANS, THE ABOVE SCALES MAY BE USED.

**CONTRACT NO.: 95856**  
DESIGN CLASS - MAJOR COLLECTOR  
CURRENT A.D.T. = 900 DESIGN  
SPEED = 50 MPH

SECTION 17-00084-00-RS  
BEGINS STATION 0+00

SECTION 17-00084-00-RS  
ENDS STATION 108+22

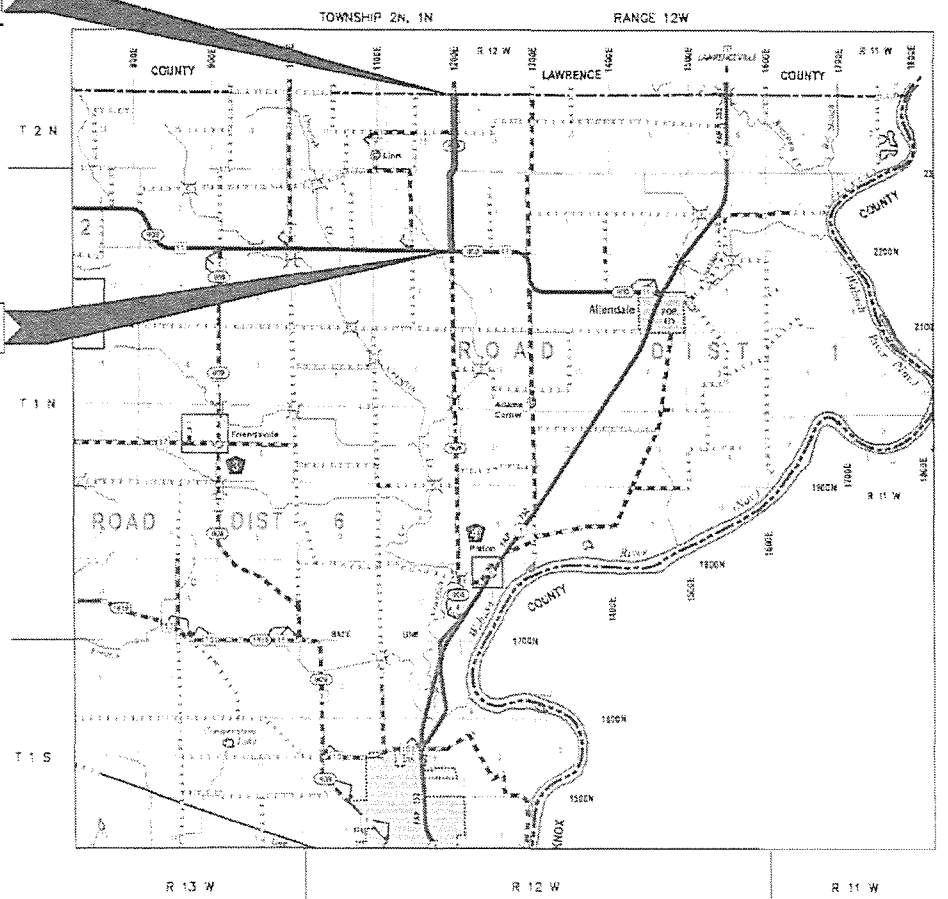

**LOCATION MAP**



GROSS LENGTH = 10,822.00 FEET (2.050 MILES)  
OMMISSIONS = 0 FEET (0.00 MILES)  
NET LENGTH = 10,822.00 FEET (2.050 MILES)

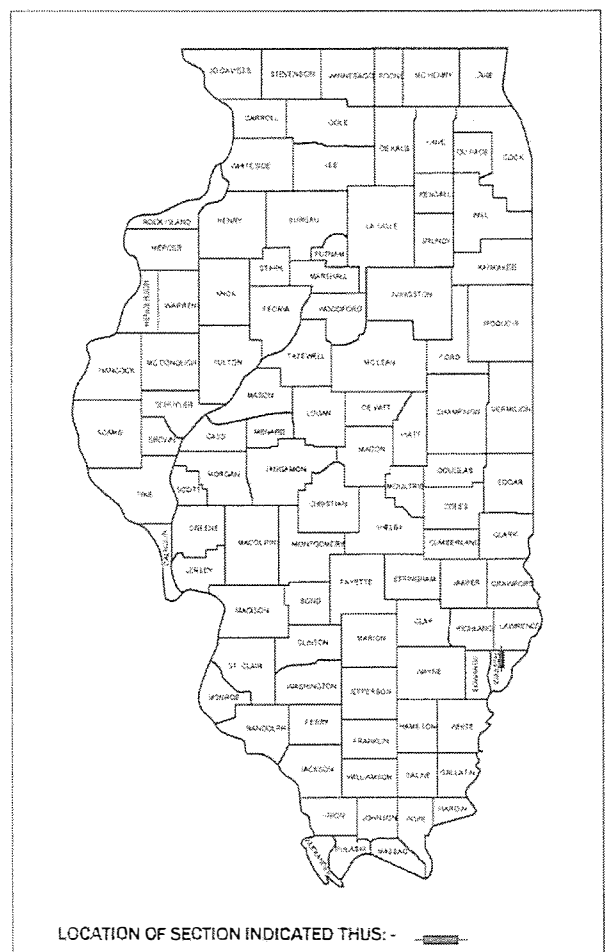

LOCATION OF SECTION INDICATED THIS: -

APPROVED: *[Signature]* 2020  
COUNTY ENGINEER

PASSED: *[Signature]* June 1, 2020  
DISTRICT SEVEN ENGINEER OF LOCAL ROADS & STREETS

RELEASING FOR BID BASED ON LIMITED REVIEW: *[Signature]* June 1, 2020  
REGION FOUR ENGINEER

STATE OF ILLINOIS  
DEPARTMENT OF TRANSPORTATION

*[Signature]*

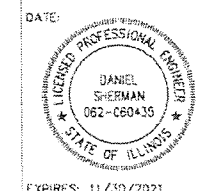

**HAMPTON, LENZINI AND RENWICK, INC.**  
323 WEST THIRD STREET, P.O. BOX 160  
MT. CARMEL, ILLINOIS 62863  
ILLINOIS PROFESSIONAL DESIGN FIRM  
LS / PE / SE CORP. 184.00959

DATE	
BY	
REVISIONS	
NO.	
DESCRIPTION	
DATE	
BY	
REVISIONS	
NO.	
DESCRIPTION	
DATE	
BY	
REVISIONS	
NO.	
DESCRIPTION	

DATE	
BY	
REVISIONS	
NO.	
DESCRIPTION	
DATE	
BY	
REVISIONS	
NO.	
DESCRIPTION	
DATE	
BY	
REVISIONS	
NO.	
DESCRIPTION	

### HIGHWAY STANDARDS

- 000001-07 STANDARD SYMBOLS, ABBREVIATIONS AND PATTERNS
- 280001-07 TEMPORARY EROSION CONTROL SYSTEMS
- 406201-01 MAILBOX TURNOUT
- 420001-09 PAVEMENT JOINTS
- 420701-03 PAVEMENT WELDED WIRE REINFORCEMENT
- 542301-03 PRECAST REINFORCED CONCRETE FLARED END SECTION
- 701006-05 OFF-RD OPERATIONS 2L, 2W, 15' TO 24" FROM PAVEMENT EDGE
- 701301-04 LANE CLOSURE 2L, 2W, SHORT TIME OPERATIONS
- 701306-04 LANE CLOSURE, 2L, 2W, SLOW MOVING OPERATIONS DAY ONLY FOR SPEEDS < 45 MPH
- 701311-03 LANE CLOSURE 2L, 2W MOVING OPERATIONS - DAY ONLY
- 701336-07 LANE CLOSURE 2L, 2W, WORK AREAS IN SERIES FOR SPEEDS < 45 MPH
- 701901-08 TRAFFIC CONTROL DEVICES
- 780001-05 TYPICAL PAVEMENT MARKINGS
- BLR 21-9 TYPICAL APPLICATION OF TRAFFIC CONTROL DEVICES FOR CONSTRUCTION ON RURAL LOCAL HIGHWAYS

### GENERAL NOTES:

THE EXISTING GRADE, ALIGNMENT, DRAINAGE STRUCTURES, BASE AND SURFACE WERE CONSTRUCTED UNDER SECTIONS 19, 34-Q, 37-Q, 38-Q, 84-00019-02-AS, 92-00055-00-RS AND SHALL REMAIN IN PLACE. ALL STATIONS REFERRED TO IN THE PLANS AND PROPOSAL ARE REFERENCED TO THE ABOVE MENTIONED SECTIONS.

MAXIMUM PERCENT OF GRADE	+2.86 %
MINIMUM STOPPING SIGHT DISTANCE	425 FT
DESIGN SPEED	50 MPH
CURRENT ADT	800 VPD
DESIGN ADT (20 YEAR)	900 VPD

THE QUANTITY SHOWN IN THE SUMMARY OF QUANTITIES FOR HOT-MIX ASPHALT SURFACE COURSE, IL-9.5, MIX "C", N70 ALLOWS 43 TONS FOR THE INTERSECTIONS, SIDE ROADS, AND TAPERS; 91 TONS FOR THE ENTRANCES; 48 TONS FOR THE MAILBOX TURNOUTS, AND 2,196 TON FOR THE 1 1/2" LIFT OF HOT-MIX ASPHALT SURFACE COURSE, IL-9.5, MIX "C", N70.

THE QUANTITY SHOWN IN THE SUMMARY OF QUANTITIES FOR HOT-MIX ASPHALT BINDER COURSE, IL-19.0, N70 ALLOWS 6 TONS FOR PAVEMENT REMOVAL AND REPLACEMENT AND 4,365 TONS FOR THE 3" LIFT OF HOT-MIX ASPHALT BINDER COURSE, IL-19.0, N70.

THE FOLLOWING RATES HAVE BEEN USED TO CALCULATE PLAN QUANTITIES:

AGGREGATE SHOULDERS TYPE B	1.8 T / CU YD
HOT-MIX ASPHALT	112 LBS / SQ YD * INCH
BITUMINOUS MATERIALS (TACK COAT)	0.05 LBS / SQ FT
RIPRAP	1.8 TONS / CU YD

THE RELOCATION OF EXISTING SIGNS SHALL BE INCLUDED IN THE COST OF PORTLAND CEMENT CONCRETE PAVEMENT 8" (JOINTED).

TEMPORARY RAMPS SHALL BE PLACED AT A 1 TO 40 SLOPE AT LOCATIONS SHOWN ON SHEET 3. THE REMOVAL OF TEMPORARY RAMPS SHALL BE INCLUDED IN THE COST OF THE TEMPORARY RAMP.

ALL DISTURBED AREAS ARE TO BE SEED BY THE COUNTY.

HOT-MIX ASPHALT MIXTURES SHALL BE PG64-22 ASPHALT AND ACCORDING TO THE TABLE BELOW.

APPLICATION	AC/PG	DESIGN AIR VOIDS	MIXTURE COMPOSITION	FRICTION AGGREGATE	QUALITY MANAGEMENT
HMA SURFACE COURSE, IL-9.5, MIX "C", N70 (1 1/2")	PG 64-22	4.0% @ N=70	IL-9.5	MIXTURE C	QC/QA
HMA BINDER COURSE, IL-19.0, N70 (3")	PG 64-22	4.0% @ N=70	IL-19.0	N/A	QC/QA

CODE NO.	ITEM	UNIT	TOTAL QUANTITY
20200100	EARTH EXCAVATION	CU YD	345
28000305	TEMPORARY DITCH CHECKS	FOOT	50
28100805	STONE-DUMPED RIPRAP, CLASS A3	TON	33
35101600	AGGREGATE BASE COURSE, TYPE B 4"	SQ YD	813
40600290	BITUMINOUS MATERIALS (TACK COAT)	LB	35,508
40600982	HOT-MIX ASPHALT REMOVAL - BUTT JOINT	SQ YD	123
40600990	TEMPORARY RAMP	SQ YD	74
40603085	HOT-MIX ASPHALT BINDER COURSE, IL-19.0, N70	TON	4,396
40604052	HOT-MIX ASPHALT SURFACE COURSE, IL-9.5, MIX "C", N70	TON	2,376
42000060	WELDED WIRE REINFORCEMENT	SQ YD	726
42000301	PORTLAND CEMENT CONCRETE PAVEMENT 8" (JOINTED)	SQ YD	726
44000100	PAVEMENT REMOVAL	SQ YD	813
48101200	AGGREGATE SHOULDERS, TYPE B	TON	2,671
50104400	CONCRETE HEADWALL REMOVAL	EACH	1
50800105	REINFORCEMENT BARS	LB	60
54213660	PRECAST REINFORCED CONCRETE FLARED END SECTIONS 15"	EACH	1
54213687	PRECAST REINFORCED CONCRETE FLARED END SECTIONS 42"	EACH	1
54248510	CONCRETE COLLAR	CU YD	2
542A0220	PIPE CULVERTS, CLASS A, TYPE 1 15"	FOOT	13
542A0247	PIPE CULVERTS, CLASS A, TYPE 1 42"	FOOT	35
59300100	CONTROLLED LOW-STRENGTH MATERIAL	CU YD	19
60500060	REMOVING INLETS	EACH	1
67100100	MOBILIZATION	L SUM	1
70100460	TRAFFIC CONTROL AND PROTECTION, STANDARD 701306	L SUM	1
70100600	TRAFFIC CONTROL AND PROTECTION, STANDARD 701336	L SUM	1
70300100	SHORT TERM PAVEMENT MARKING	FOOT	3,208
70300150	SHORT TERM PAVEMENT MARKING REMOVAL	SQ FT	1,070
78001110	PAINT PAVEMENT MARKING - LINE 4"	FOOT	29,472
XX006821	CONCRETE TRUCK WASHOUT	L SUM	1
XX127400	PAVEMENT REMOVAL AND REPLACEMENT, SPECIAL	TON	6

### Δ SPECIALTY ITEMS

### TYPICAL CROSS SECTION EXISTING

(STA 0+00 TO STA 108+22)

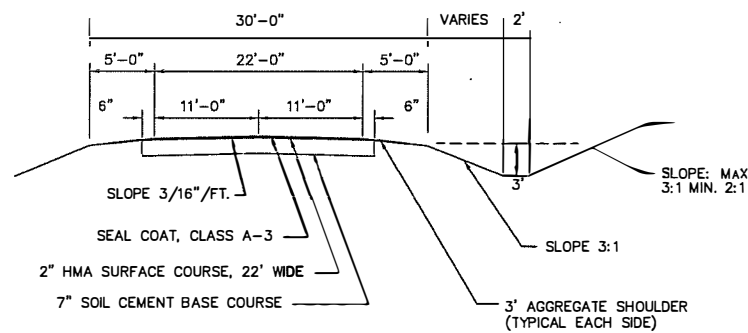

### TYPICAL CROSS SECTION PROPOSED

(STA 106+91 TO STA 108+22)

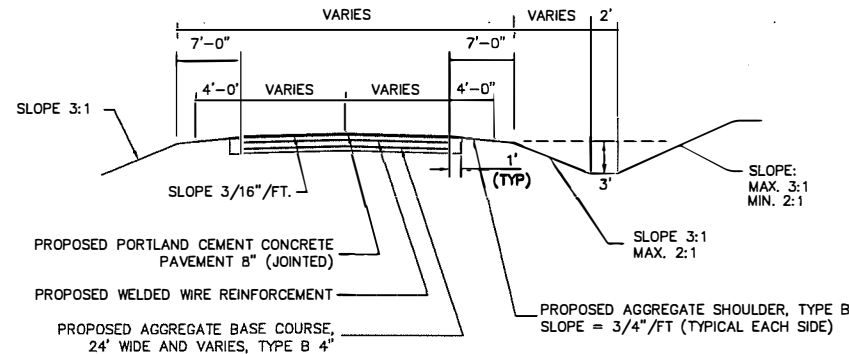

### TYPICAL CROSS SECTION PROPOSED

(STA 0+00 TO STA 106+91)

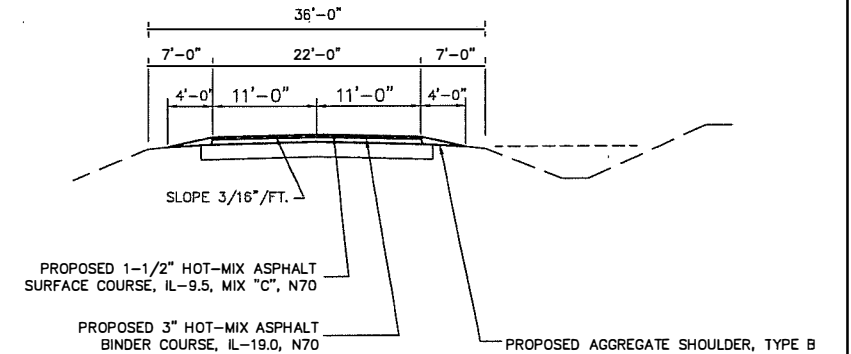

**HAMPTON, LENZINI AND RENWICK, INC.**  
323 WEST THIRD STREET, P.O. BOX 160  
MT. CARMEL, ILLINOIS 62853  
ILLINOIS PROFESSIONAL DESIGN FIRM  
LS / PE / SE CORP. 184.009959

PROJECT NO. - 17.0903.330	DESIGNED - SEK	REVISED -
FILE NAME - 170903.dwg	DRAWN - SEK	REVISED -
PLOT SCALE - NTS	CHECKED - PJG	REVISED -
PLOT DATE - 04/16/2020	DATE - 04/16/2020	REVISED -

STATE OF ILLINOIS  
DEPARTMENT OF TRANSPORTATION

### TYPICAL SECTIONS, SUMMARY OF QUANTITIES AND GENERAL NOTES

SCALE: NONE SHEET 2 OF 5 SHEETS STA. TO STA.

F.A.S.	SECTION	COUNTY	TOTAL SHEETS	SHEET NO.
806	17-00084-DO-RS	WABASH	5	2
CONTRACT NO.: 95656				
ILLINOIS FEDERAL AID PROJECT				

DATE	
BY	
DESIGNED	
DRAWN	
CHECKED	
IN CHARGE	
PROJECT NO.	
DATE	
BY	
DESIGNED	
DRAWN	
CHECKED	
IN CHARGE	
PROJECT NO.	
DATE	
BY	
DESIGNED	
DRAWN	
CHECKED	
IN CHARGE	
PROJECT NO.	

**SCHEDULE OF MAILBOX TURNOUTS**

STATION	TO	STATION	LOCATION	TONS
9+85 (3)		10+55	LT	10.3
33+76		34+46	RT	6.5
42+46		43+16	RT	10.3
67+94		68+64	RT	10.3
86+57		87+27	RT	10.3
TOTAL				47.7

THE ABOVE QUANTITY IS INCLUDED IN THE HOT-MIX ASPHALT SURFACE COURSE, IL-9.5, MIX "C", N70 IN THE SUMMARY OF QUANTITIES.

**TEMPORARY RAMP DETAIL**

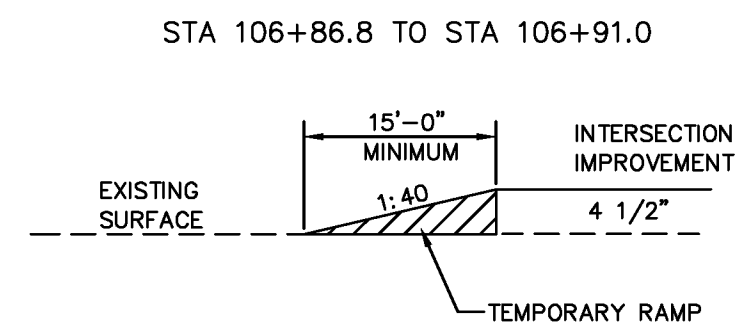

**SCHEDULE OF TEMPORARY RAMPS**

STATION	LENGTH	WIDTH	AREA (SQ. YD)
0+00	15'	22'	36.7
106+91	15'	22'	36.7
TOTAL			73.4

**DETAIL OF INTERSECTION 25+96 LT AND RT**

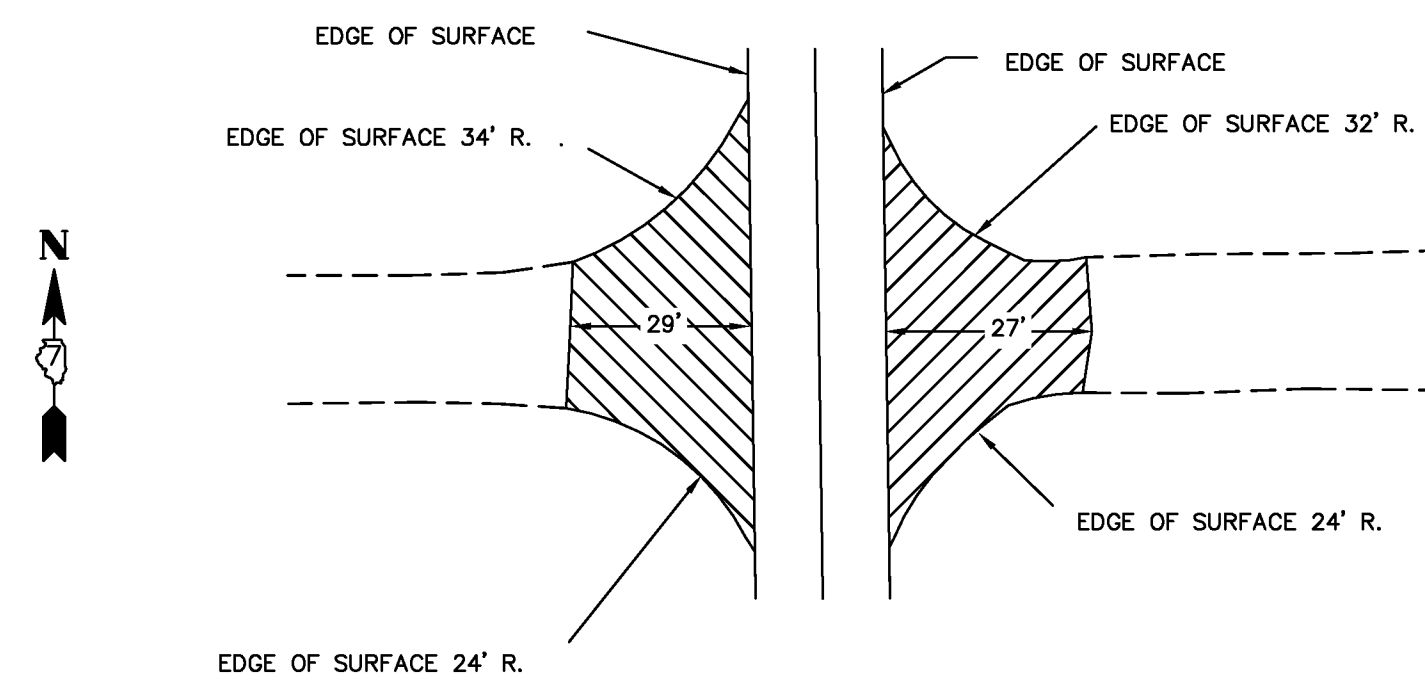

**PROFILE RT**

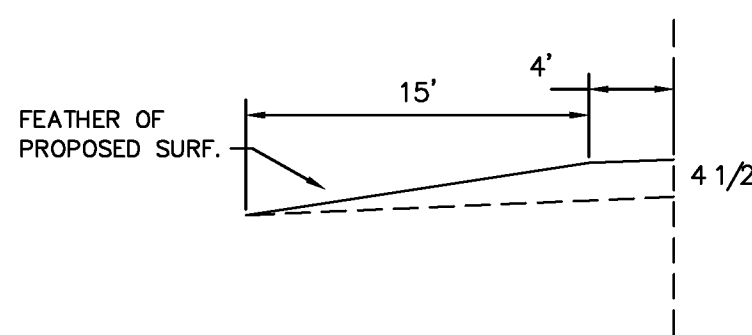

**PROFILE LT**

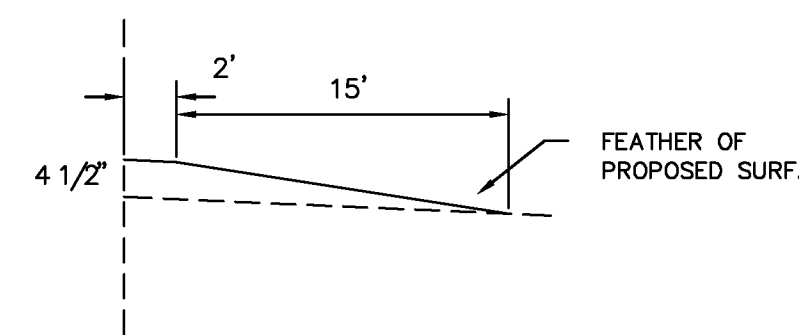

**DETAIL OF INTERSECTION STA 0+00 AT COUNTY LINE**

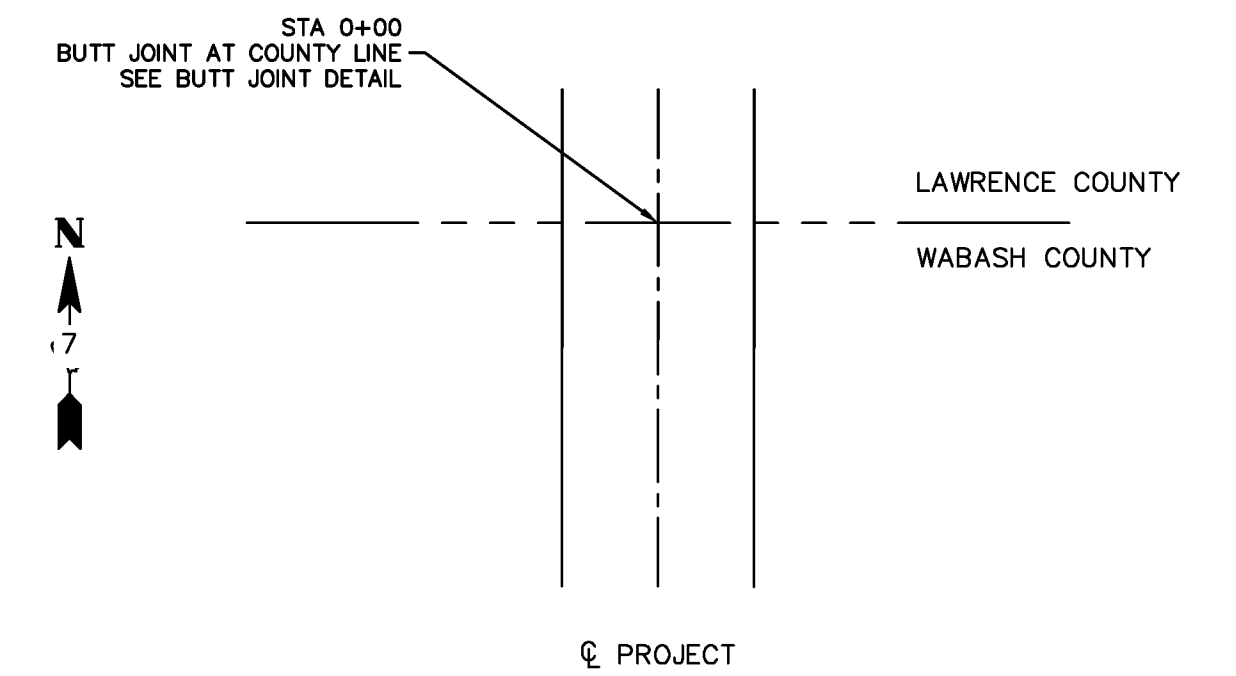

**BUTT JOINT DETAIL**

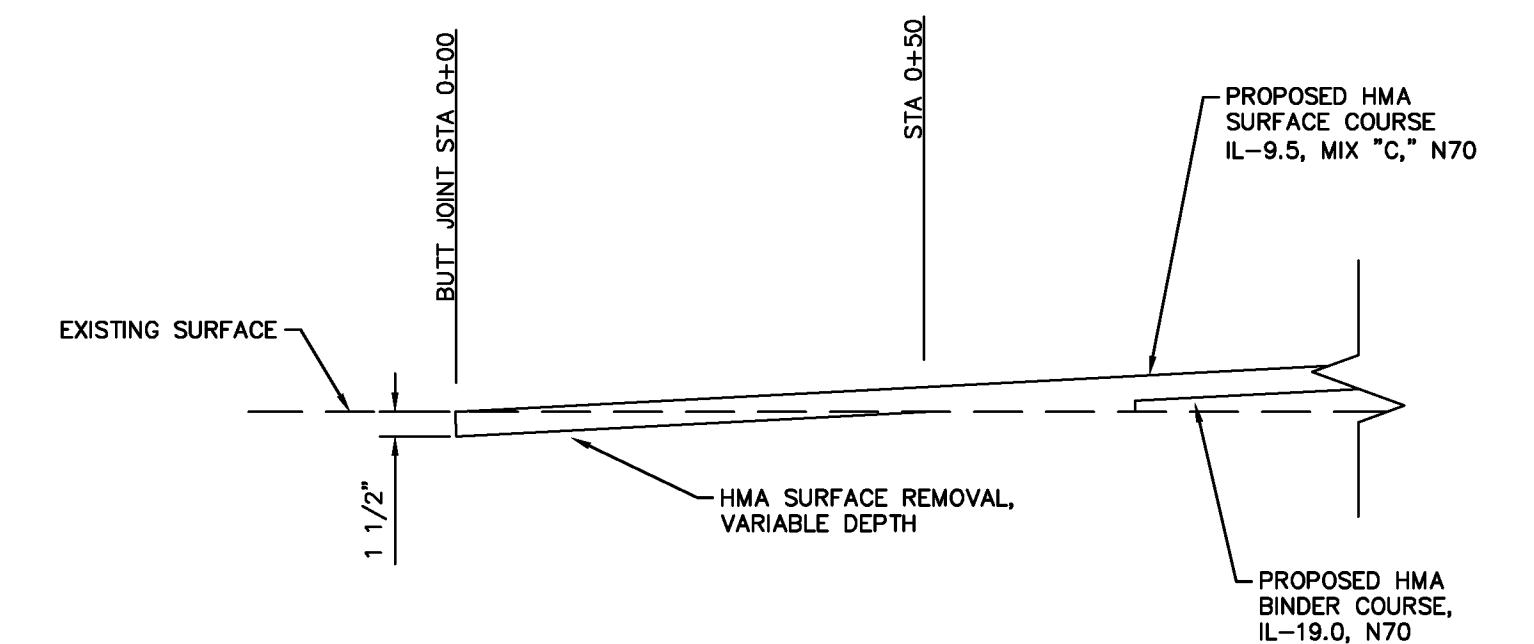

**DETAIL OF PRIVATE AND FIELD ENTRANCES**

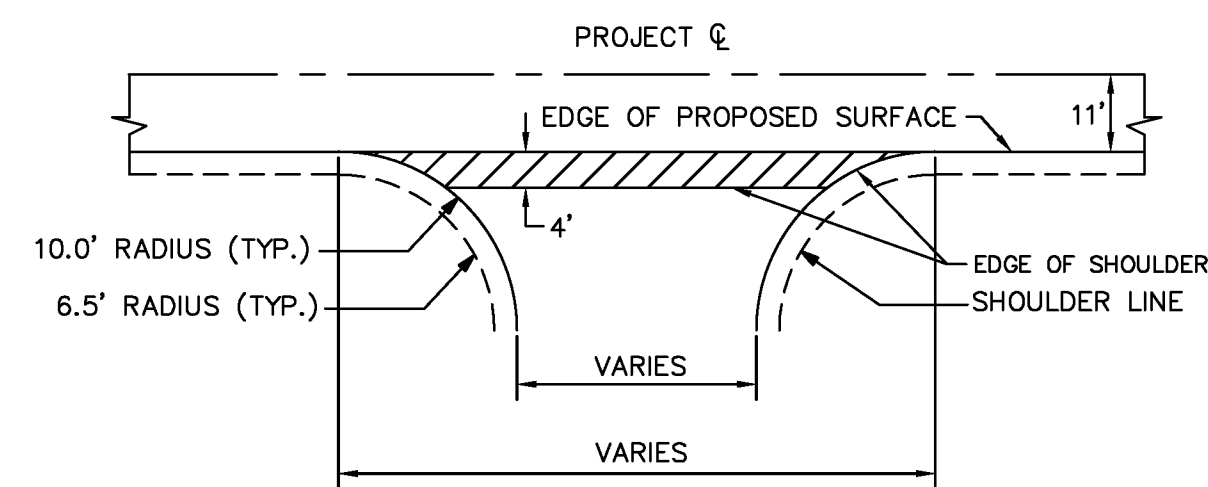

**SCHEDULE OF PRIVATE AND FIELD ENTRANCES**

STATION	LOCATION	TONS
2+91	LT	6.6
5+98	RT	2.8
8+30	RT	2.2
9+80	RT	3.4
10+24	RT	2.8
10+48	LT	4.1
21+48	RT	2.8
34+40	RT	5.1
38+76	RT	3.2
39+40	RT	2.7
39+49	LT	5.9
40+84	LT	6.6
42+51	LT	4.3
48+68	LT	4.0
52+47	LT	2.4
52+91	RT	3.0
56+23	RT	2.3
61+04	LT	2.2
68+89	RT	4.1
70+40	LT	1.4
81+15	LT	2.1
83+30	RT	2.2
87+68	RT	2.6
92+38	RT	2.1
95+11	RT	2.5
95+26	LT	2.2
101+25	RT	2.4
101+35	LT	2.4

TOTAL TONNAGE: 90.4

THE ABOVE QUANTITY IS INCLUDED IN THE HOT-MIX ASPHALT SURFACE COURSE, IL-9.5, MIX "C", N70 IN THE SUMMARY OF QUANTITIES.

**SCHEDULE OF SIDE ROADS**

STATION	LOCATION	AREA (SF)	TONS
25+96	LT	776.30	21.74
25+96	RT	737.00	20.64
TOTAL			42.4

THE ABOVE QUANTITY IS INCLUDED IN THE HOT-MIX ASPHALT SURFACE COURSE, IL-9.5, MIX "C", N70 IN THE SUMMARY OF QUANTITIES.

**SCHEDULE OF SURFACE REMOVAL**

STATION	TO	STATION	LENGTH	WIDTH	AREA
0+00		0+40	50'	22'	122.2
TOTAL					122.2

THE ABOVE QUANTITY IS INCLUDED IN THE QUANTITY FOR HOT-MIX ASPHALT SURFACE REMOVAL - BUTT JOINT IN THE SUMMARY OF QUANTITIES.

**PRIVATE & FIELD ENTRANCE APPROACH DETAIL**

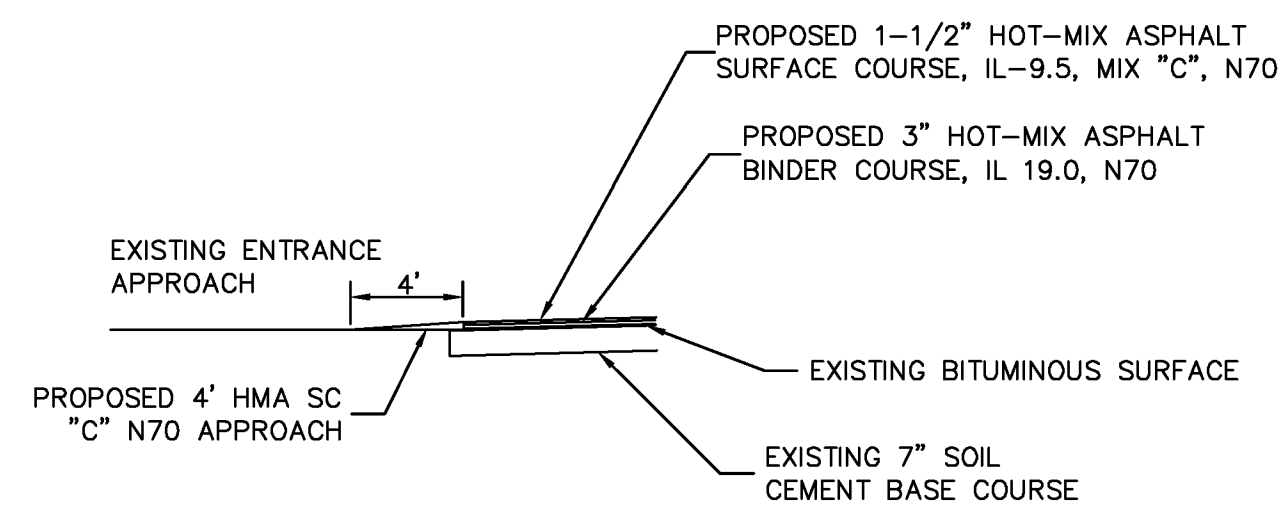

NOTE: THE 4' AREA FROM THE EDGE OF SURFACE, AS SHOWN ABOVE, SHALL BE HOT-MIX ASPHALT SURFACE COURSE, IL-9.5, MIX "C", N70 FOR THE PRIVATE ENTRANCES AND THE FIELD ENTRANCES. THIS QUANTITY IS INCLUDED IN THE QUANTITY FOR HOT-MIX ASPHALT SURFACE COURSE, IL-9.5, MIX "C", N70.

**AGGREGATE SHOULDER DETAIL**

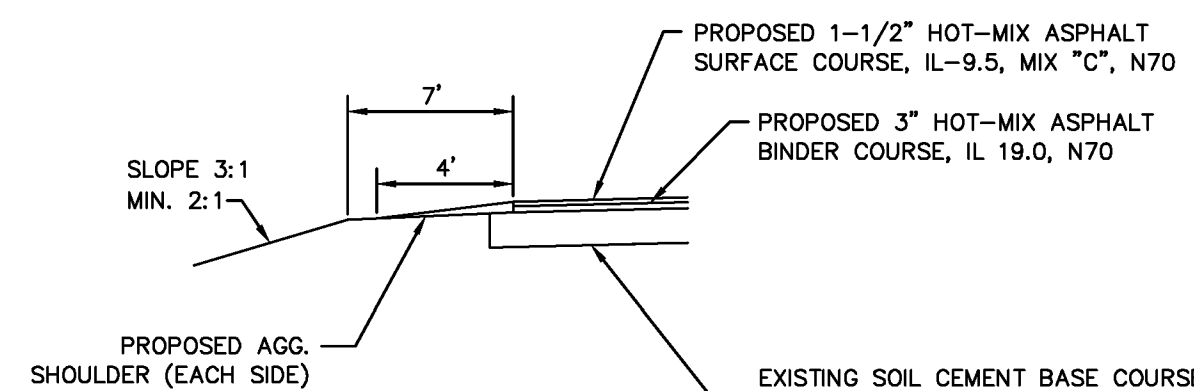

**SCHEDULE OF AGGREGATE SHOULDER TYPE B**

STATION	TO	STATION	LOCATION	TONS
0+00		108+22	LT	1,372.0
0+00		108+22	RT	1,299.0
TOTAL				2,671.0

THE ABOVE QUANTITY IS FOR THE ENTIRE SECTION AND IS INCLUDED IN THE QUANTITY FOR AGGREGATE SHOULDERS, TYPE B IN THE SUMMARY OF QUANTITIES.

**PAVEMENT MARKING SCHEDULE**

LOCATION	PAINT PAVEMENT MARKING - LINE 4"		
	SOLID WHITE (FT)	SOLID YELLOW (FT)	SKIP DASH YELLOW (FT)
EDGE LINES - WHITE			
STA 0+00 TO STA 25+62, LT	2,562		
STA 26+44 TO STA 106+91, LT	8,123		
STA 0+00 TO STA 25+69, RT	2,569		
STA 26+69 TO STA 106+91 RT	8,126		
NO PASSING ZONE - YELLOW			
STA 0+00 TO STA 0+94, RT		94	
STA 3+88 TO STA 9+03, RT		515	
STA 26+33 TO STA 32+92, RT		659	
STA 42+43 TO STA 56+75, RT		1,432	
STA 1+39 TO STA 6+55, LT		516	
STA 11+04 TO STA 16+10, LT		506	
STA 34+32 TO STA 40+86, LT		654	
STA 49+19 TO STA 62+18, LT		1,299	
SKIP DASH - YELLOW			
STA 0+00 TO STA 3+88			97
STA 6+55 TO STA 49+19			1,066
STA 56+75 TO STA 106+91			1,254
TOTAL	21,380	5,675	2,417



**SCHEDULE OF STORM SEWER STRUCTURES**

STATION	LOCATION	ITEM	
[A]	107+52	33.4', LT	54213687
[B]	107+91	25.1', LT	54248510
[C]	108+08	46.0', LT	54248510
[D]	108+08	67.6', LT	54213680

**SCHEDULE OF STORM SEWER PIPES**

UPSTREAM STATION	DOWNSTREAM STATION	ITEM	
[A]	107+57 32' LT	107+91 25' LT	542A0247
[B]	108+08 60' LT	108+08 46' LT	542A0220

**SCHEDULE OF CONTROLLED LOW-STRENGTH MATERIAL**

STATION	STRUCTURE	LENGTH	CU YD
107+91	PIPE CULVERT 42"	35'	13.0
108+08	PIPE CULVERT 15"	13'	6.0
TOTAL			19.0

**DETAIL OF PAVEMENT REMOVAL AND REPLACEMENT**

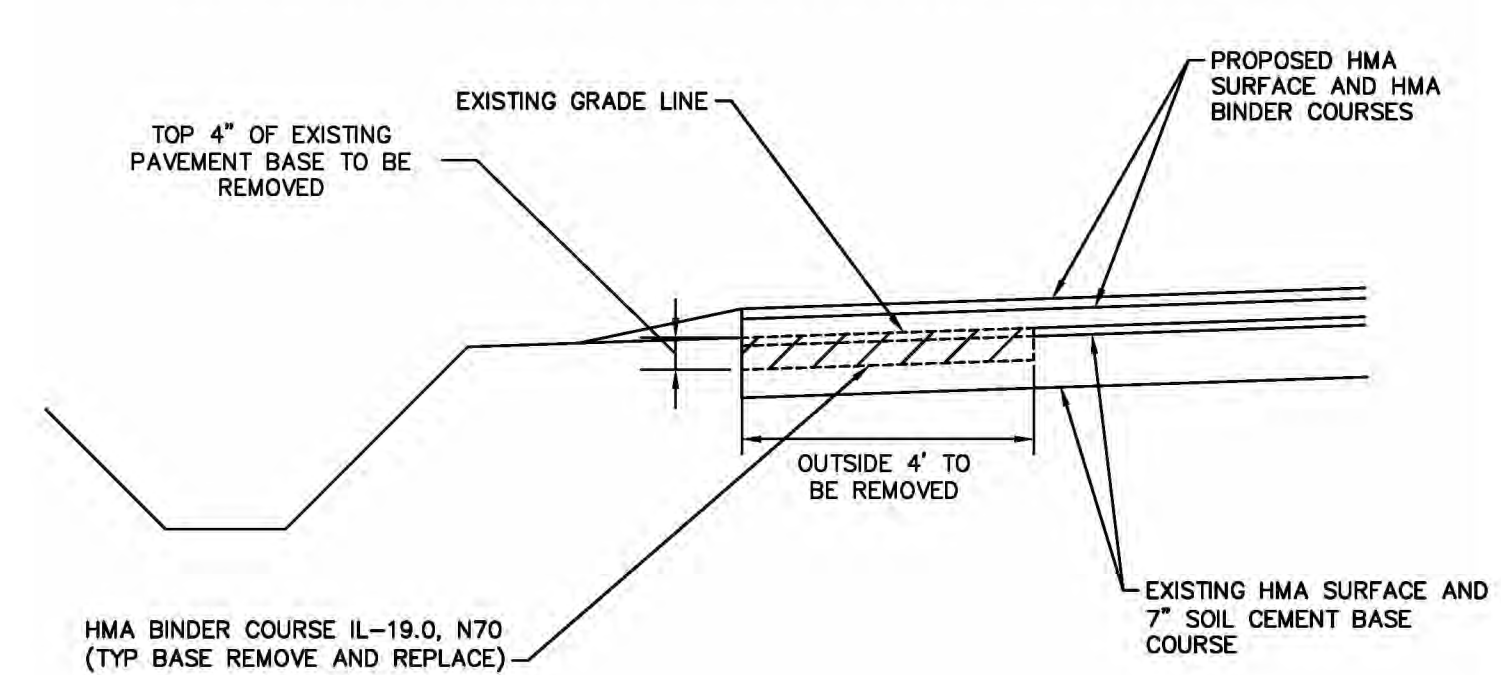

**SCHEDULE OF PAVEMENT REMOVAL AND REPLACEMENT (SPECIAL)**

STATION	TO	STATION	LOCATION	SQ YD	TON
25+96		26+08	RT	5.3	2.1
82+85		82+93	RT	3.6	1.4
83+90		84+00	LT	4.4	1.7
TOTAL				5.2	

THE ABOVE QUANTITY IS INCLUDED IN THE QUANTITY FOR PAVEMENT REMOVAL AND REPLACEMENT (SPECIAL).

- NOTES:
1. THE COLLAR SHALL BE CONSTRUCTED ENTIRELY OF CLASS SI CONCRETE IN ACCORDANCE WITH THE APPLICABLE PORTIONS OF SECTION 503 OF THE STANDARD SPECIFICATIONS. REINFORCEMENT BARS SHALL CONFORM TO SECTION 50B.
  2. THIS WORK SHALL BE PAID FOR BY THE CUBIC YARD FOR CONCRETE COLLAR AND BY THE POUND FOR REINFORCEMENT BARS.

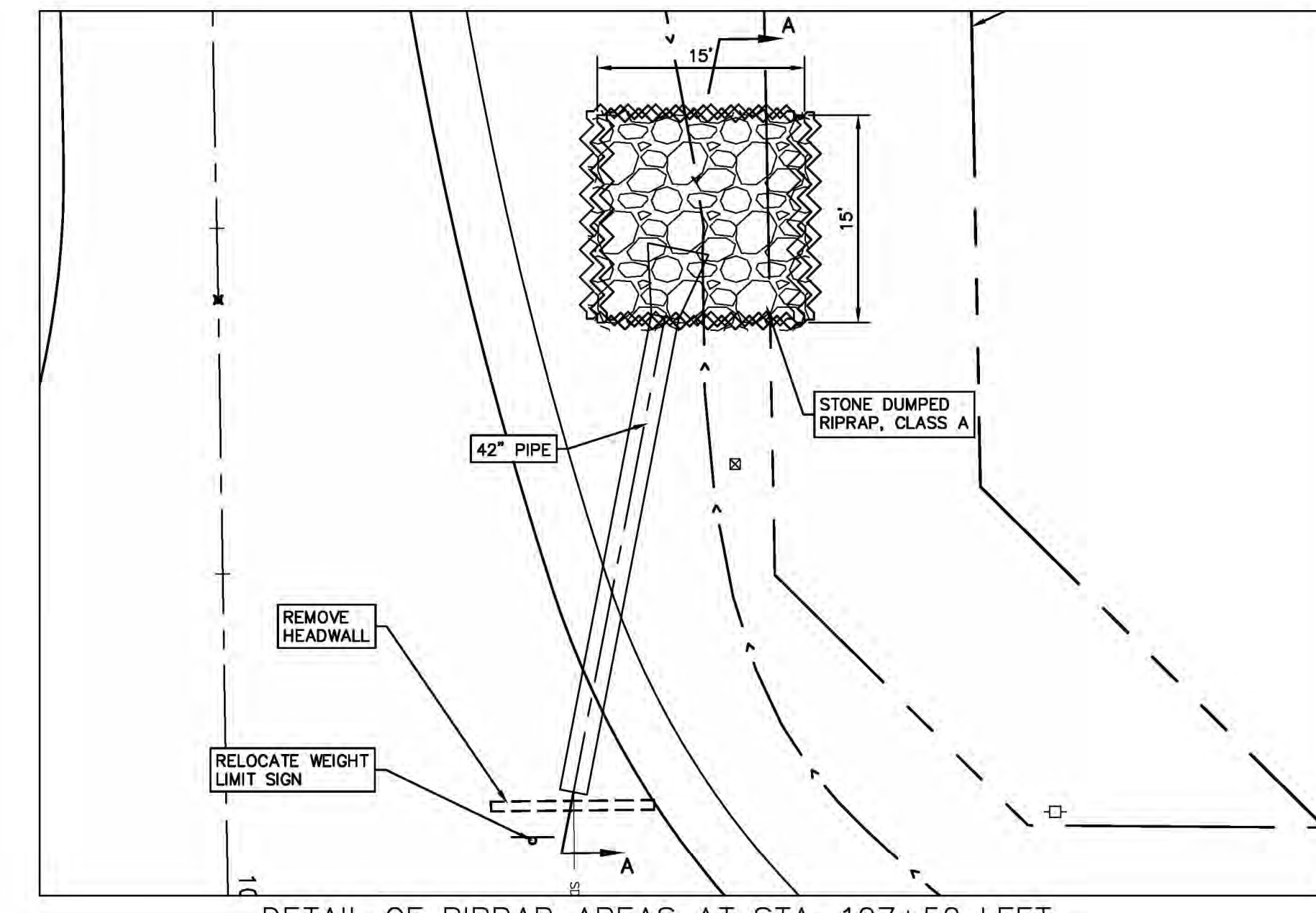

DETAIL OF RIPRAP AREAS AT STA. 107+52 LEFT

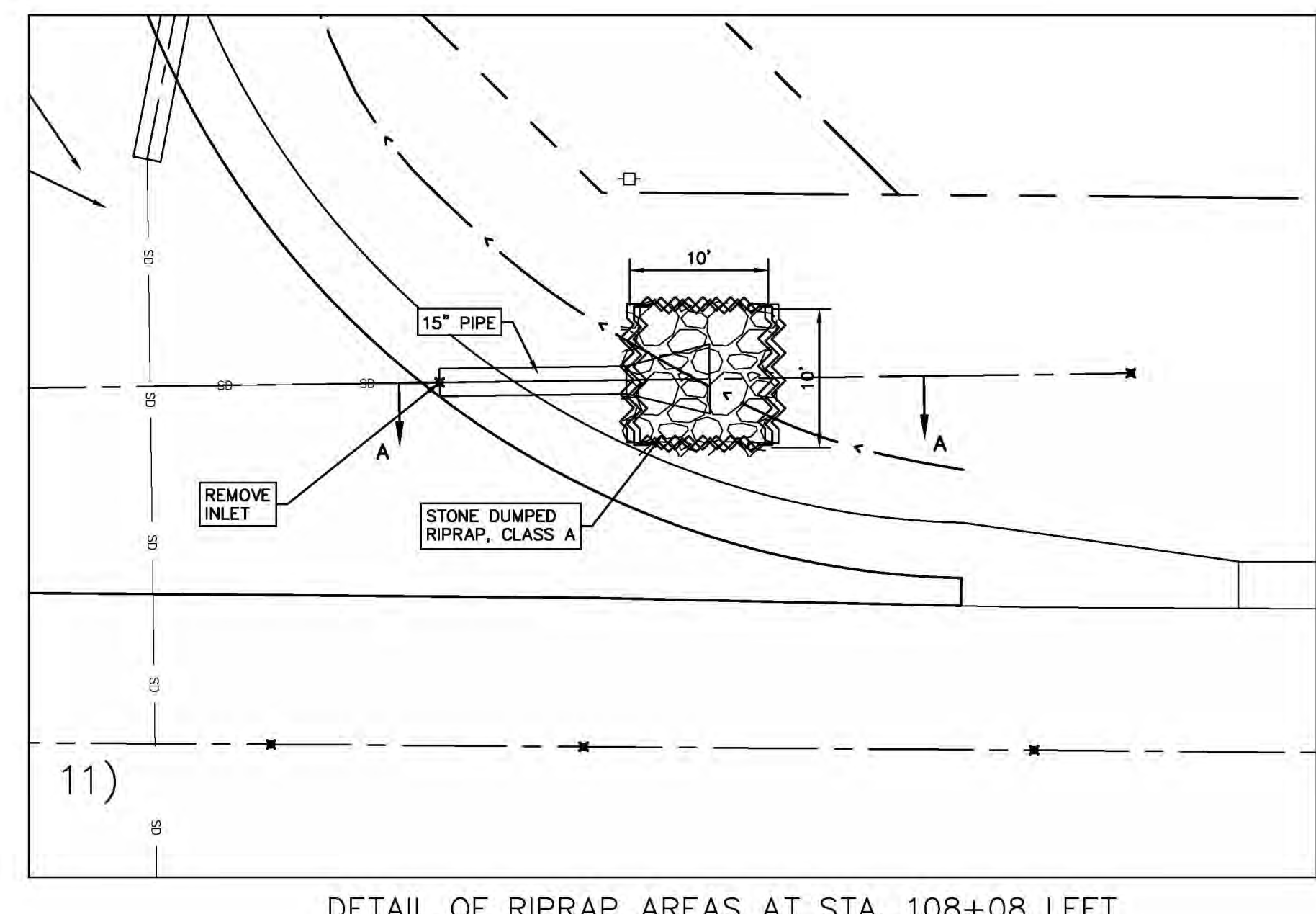

DETAIL OF RIPRAP AREAS AT STA. 108+08 LEFT

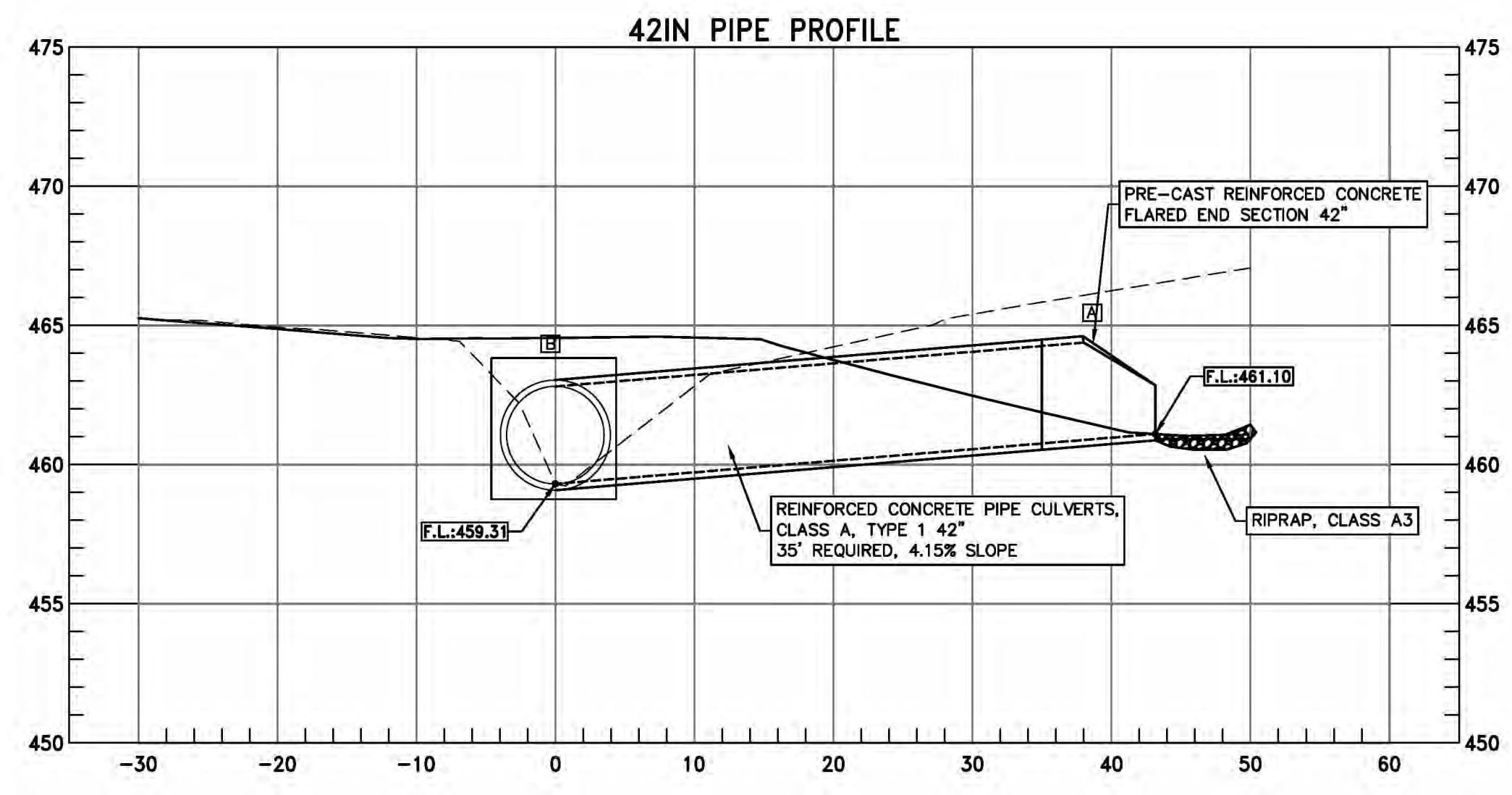

42IN PIPE PROFILE

SECTION A-A STA 107+52 LEFT PIPE CULVERTS, CLASS A TYPE 1

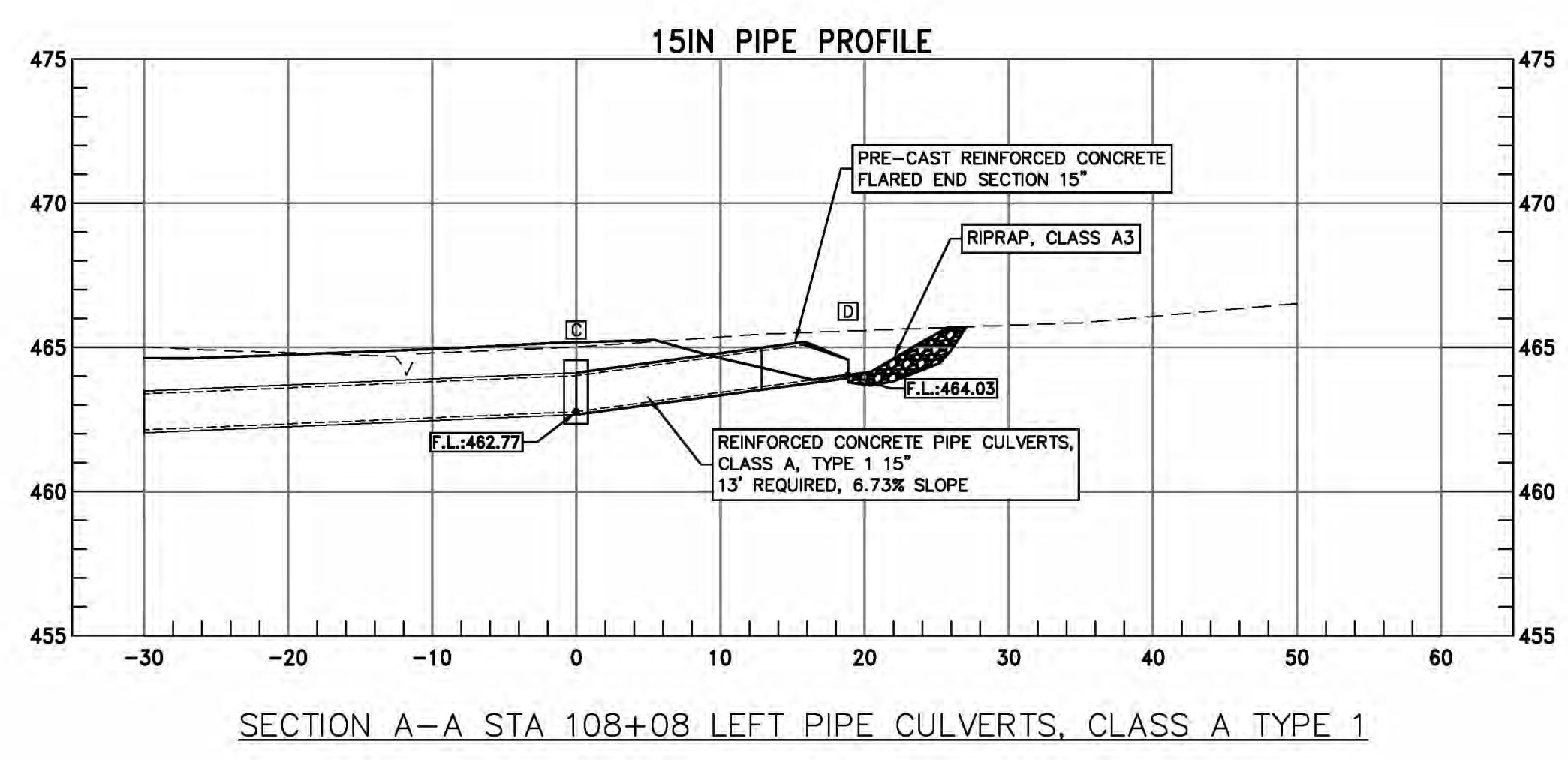

15IN PIPE PROFILE

SECTION A-A STA 108+08 LEFT PIPE CULVERTS, CLASS A TYPE 1

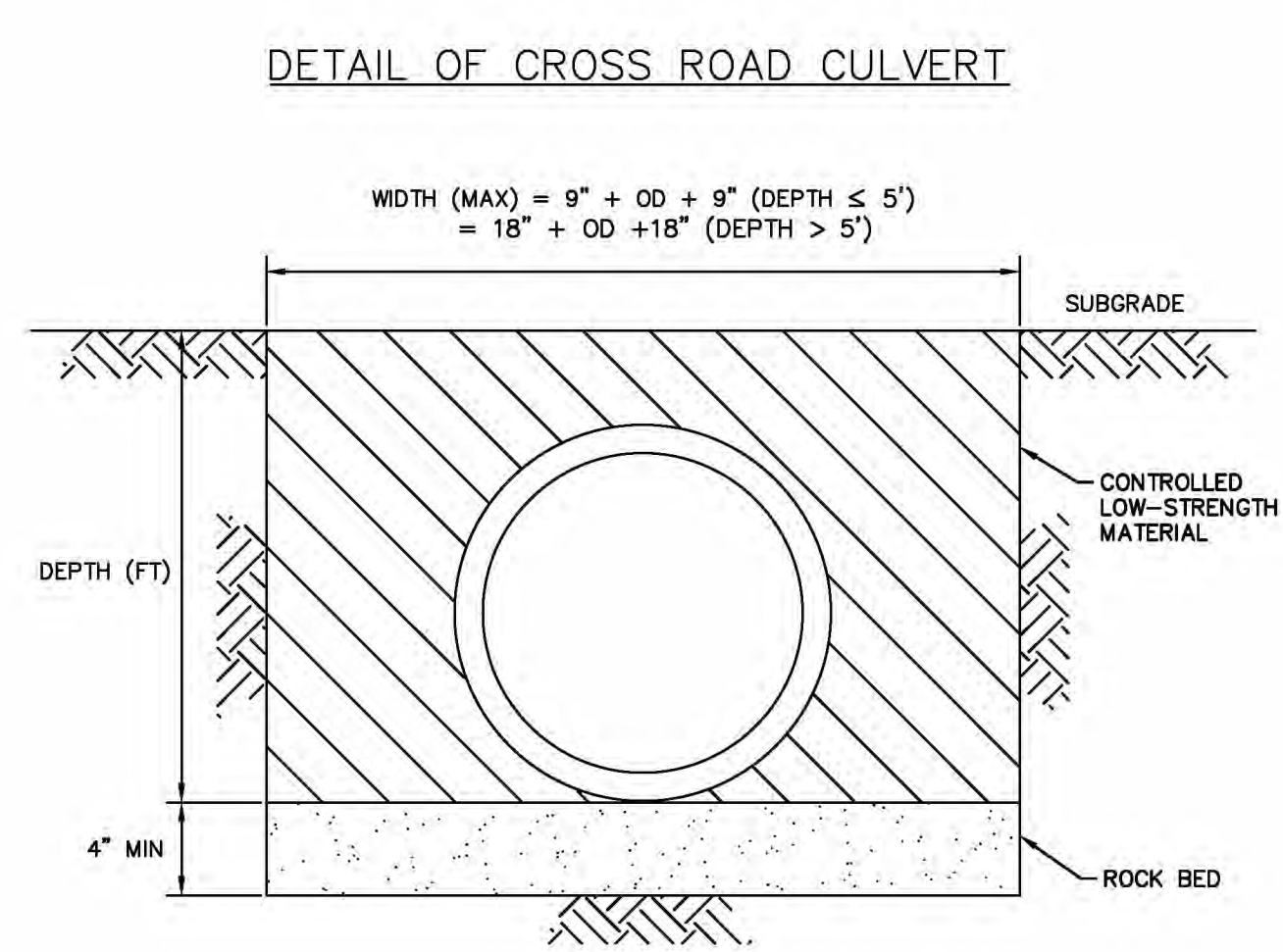

DETAIL OF CROSS ROAD CULVERT

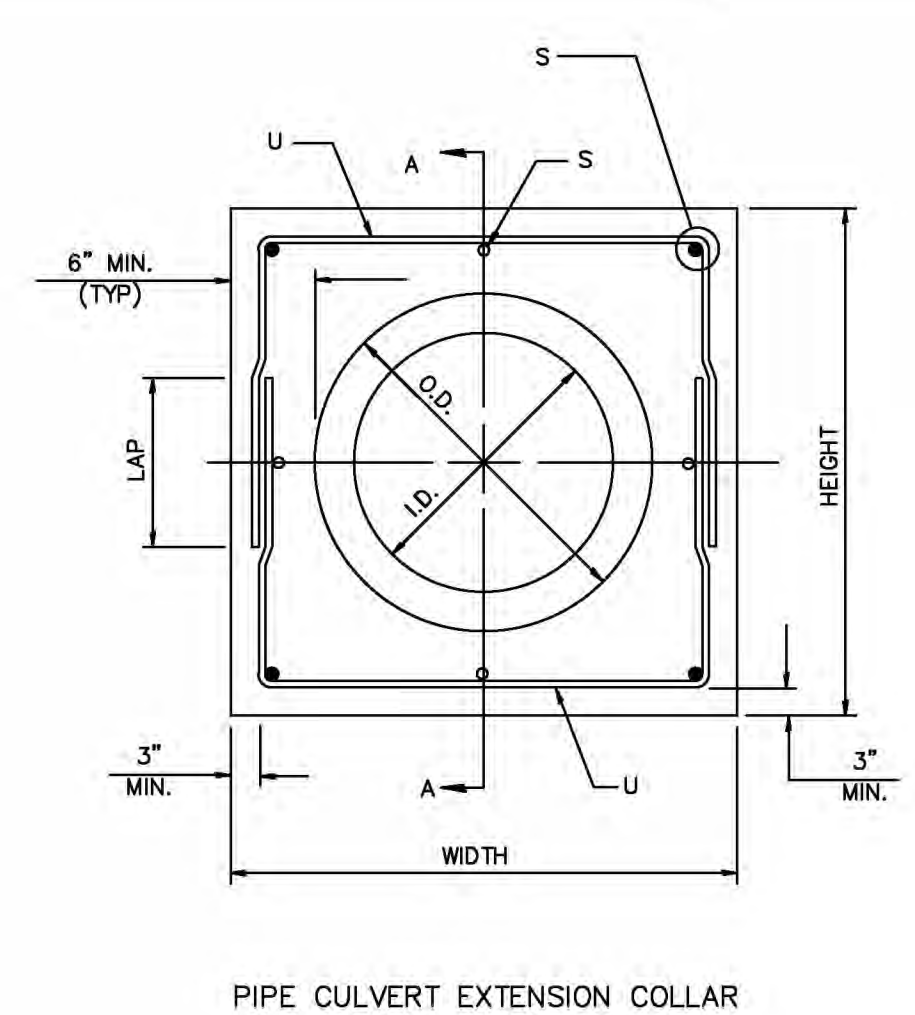

PIPE CULVERT EXTENSION COLLAR

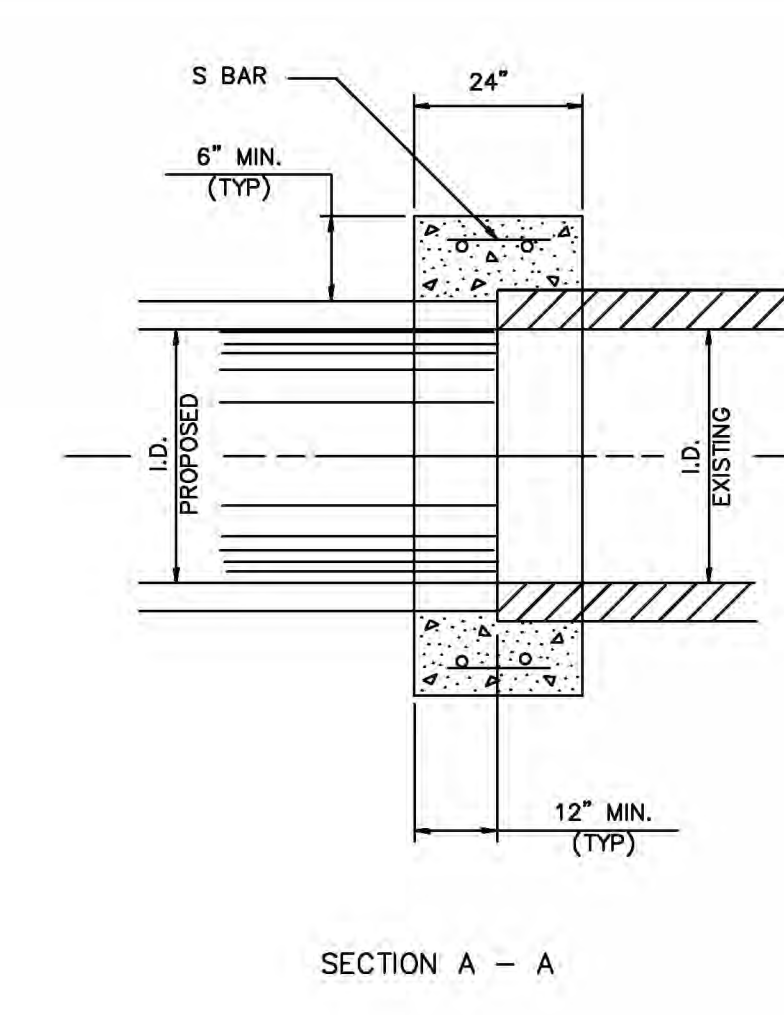

SECTION A - A

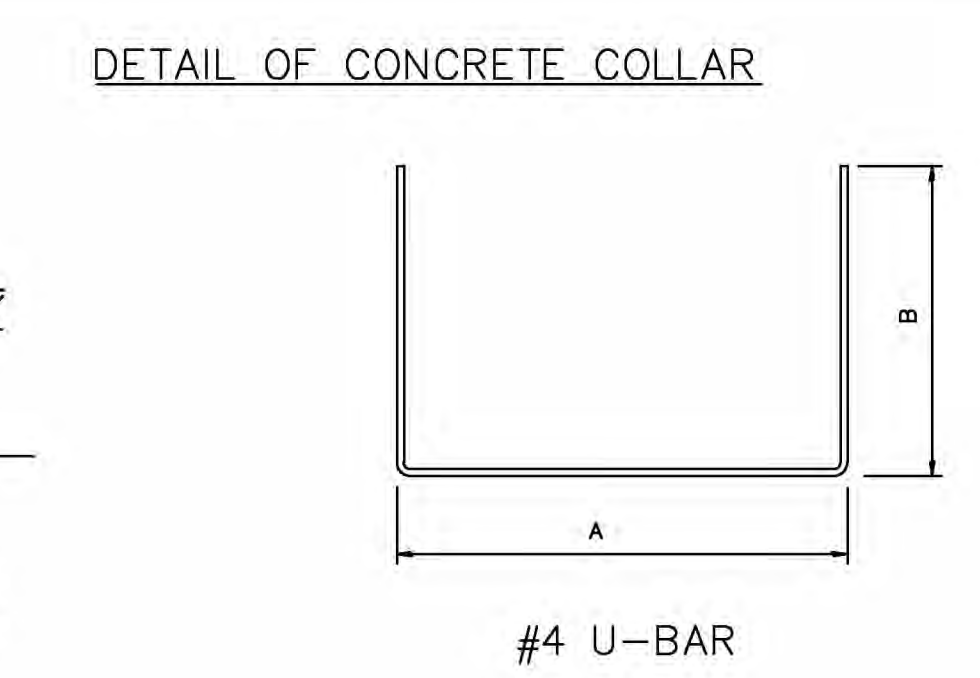

DETAIL OF CONCRETE COLLAR

STATION	SKEW	EXISTING CULVERT SIZE	PROPOSED CULVERT I.D.	PROPOSED CULVERT O.D.	COLLAR HEIGHT	COLLAR WIDTH	REINFORCEMENT BARS						CLASS SI CONCRETE COLLAR YD <sup>3</sup>				
							S BAR		U BAR		LAP			LB			
							NO.	SIZE	NO.	SIZE	A	B	LENGTH				
108+08 46' RT	0'	15" RCP	15"	19.5" RCP	2'-8"	2'-8"	8	4	1'-6"	8	4	2'-2"	1'-9"	16"	5'-8"	23.0	0.4
107+91 25' RT	0'	42" RCP	42"	51" RCP	5'-3"	5'-3"	8	4	1'-6"	8	4	4'-9"	3'-1"	16"	10'-11"	37.0	1.0
TOTAL													60.0	1.4			

PROFILE

DATE	
BY	
DESIGNED	
PLOTTED	
CHECKED	
NOTED	
NO.	

PROFILE

DATE	
BY	
DESIGNED	
PLOTTED	
CHECKED	
NOTED	
NO.	

**HAMPTON, LENZI AND RENWICK, INC.**  
 323 WEST THIRD STREET, P.O. BOX 180  
 MT. CARMEL, ILLINOIS 62863  
 ILLINOIS PROFESSIONAL DESIGN FIRM  
 LS / PE / SE CORP. 184.000959

PROJECT NO. - 17.0903.330  
 FILE NAME - 170903.dwg  
 PLOT SCALE - 1"=1"  
 PLOT DATE - 04/16/2020

DESIGNED - PJG  
 DRAWN - SEK  
 CHECKED - PJG  
 DATE - 04/16/2020

REVISED -  
 REVISED -  
 REVISED -  
 REVISED -

**STATE OF ILLINOIS**  
**DEPARTMENT OF TRANSPORTATION**

**PIPE CULVERT DETAILS AND MISCELLANEOUS SCHEDULES**

SCALE: NONE SHEET 4 OF 5 SHEETS STA. TO STA.

F.A.S.	SECTION	COUNTY	TOTAL SHEETS	SHEET NO.
806	17-00084-00-RS	WABASH	5	4
CONTRACT NO.: 95856				
ILLINOIS FEDERAL AID PROJECT:				



		C.H. 4 & C.H. 11			
POINT NUMBER	POINT ELEVATION	C.H. 4		C.H. 11	
		STA. M.L.	OFF. M.L.	STA. M.L.	OFF. M.L.
500	461.68	108+16.41	138.99 RT.	156+62.41	12.51 LT.
501	461.91	108+16.52	129.16 RT.	156+72.24	12.69 LT.
502	462.13	108+16.32	119.33 RT.	156+82.06	13.19 LT.
503	462.35	108+15.79	109.51 RT.	156+91.85	14.00 LT.
504	462.58	108+14.94	99.72 RT.	157+01.62	15.14 LT.
505	462.75	108+13.78	89.96 RT.	157+11.34	16.6 LT.
506	462.93	108+12.29	80.24 RT.	157+21.01	18.37 LT.
507	463.11	108+10.48	70.58 RT.	157+30.68	20.46 LT.
508	463.29	108+08.36	60.98 RT.	157+40.22	22.84 LT.
509	463.47	108+05.43	51.76 RT.	157+49.35	26.01 LT.
510	463.64	108+01.15	43.08 RT.	157+57.92	30.51 LT.
511	463.82	107+95.65	35.13 RT.	157+65.72	36.24 LT.
512	464.05	107+89.01	28.08 RT.	157+72.59	43.05 LT.
513	464.38	107+81.41	22.1 RT.	157+78.36	50.81 LT.
514	464.71	107+73.00	17.32 RT.	157+82.93	59.35 LT.
515	465.04	107+63.97	13.83 RT.	157+86.17	68.46 LT.
516	465.37	107+54.48	11.72 RT.	157+88.03	77.95 LT.
517	465.70	107+44.84	11.00 RT.	157+88.45	87.62 LT.
518	466.23	107+15.87	11.00 RT.	157+87.57	116.57 LT.
519	466.69	106+90.84	11.00 RT.	157+86.42	141.55 LT.

		C.H. 4 & C.H. 11			
POINT NUMBER	POINT ELEVATION	C.H. 4		C.H. 11	
		STA. M.L.	OFF. M.L.	STA. M.L.	OFF. M.L.
520	466.58	108+22.40	83.54 LT.	158+85.10	12.40 LT.
521	466.30	180+21.24	73.57 LT.	158+75.10	13.31 LT.
522	466.03	108+18.57	63.90 LT.	158+65.37	15.75 LT.
523	465.73	108+14.44	54.75 LT.	158+56.12	19.66 LT.
524	465.26	108+08.95	46.35 LT.	158+47.59	24.95 LT.
525	464.79	108+02.23	38.90 LT.	158+39.97	31.48 LT.
526	464.46	107+94.45	32.56 LT.	158+33.55	39.12 LT.
527	464.58	107+85.78	27.50 LT.	158+28.30	47.67 LT.
528	464.69	107+76.44	23.84 LT.	158+24.44	56.94 LT.
529	464.95	107+67.15	21.16 LT.	158+21.56	66.16 LT.
530	465.22	107+57.79	18.79 LT.	158+18.98	75.47 LT.
531	465.49	107+48.41	16.74 LT.	158+16.71	84.86 LT.
532	465.75	107+38.91	15.01 LT.	158+14.74	94.32 LT.
533	465.98	107+29.35	13.59 LT.	158+13.07	103.84 LT.
534	466.15	107+19.75	12.48 LT.	158+11.71	113.41 LT.
535	466.33	107+10.12	11.67 LT.	158+10.66	123.01 LT.
536	466.51	107+00.47	11.18 LT.	158+09.92	132.65 LT.
537	466.69	106+90.84	11.00 LT.	158+09.49	142.30 LT.

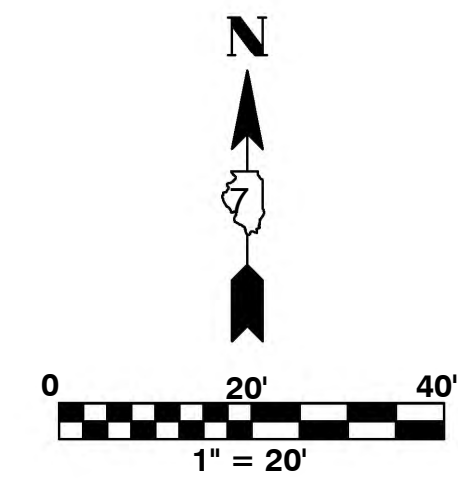
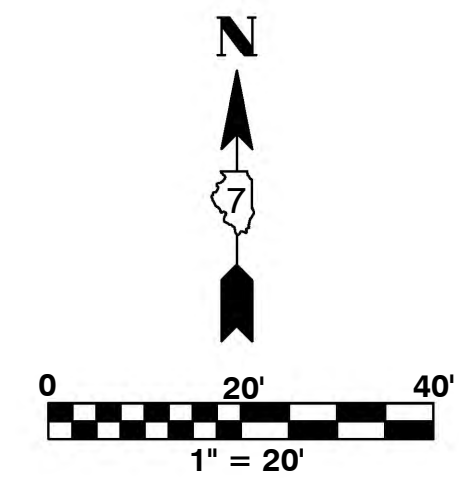

**GENERAL NOTES:**

FULL DEPTH SAW CUT EDGE OF EXISTING PAVEMENT TO ESTABLISH A VERTICAL CONSTRUCTION JOINT AND REMOVE THE SHOULDER IN THE PROPOSED PAVED AREA. THIS WORK SHALL BE CONSIDERED IN THE COST OF PORTLAND CEMENT CONCRETE PAVEMENT 8" (JOINTED).

THE QUANTITY SHOWN FOR EARTH EXCAVATION IS FOR GRADING AND SHAPING OF INTERSECTION SUBGRADE AND ROADSIDE DITCHES.

THE RELOCATION OF EXISTING SIGNS SHALL BE INCLUDED IN THE COST OF PORTLAND CEMENT CONCRETE PAVEMENT 8" (JOINTED).

THE PROPOSED INTERSECTION IMPROVEMENT WILL TIE INTO THE PROPOSED HOT-MIX ASPHALT SURFACE COURSE, MIX "C", N70. FOR THE TEMPORARY RAMP DETAIL SEE DETAIL SHEET 3.

DATE	
BY	
PROF. SURVEYED	
GRADES CHECKED	
NOTE BOOK	
STRUCTURE NOTATIONS CHECKED	
NO.	

DATE	
BY	
PROF. SURVEYED	
GRADES CHECKED	
NOTE BOOK	
STRUCTURE NOTATIONS CHECKED	
NO.	

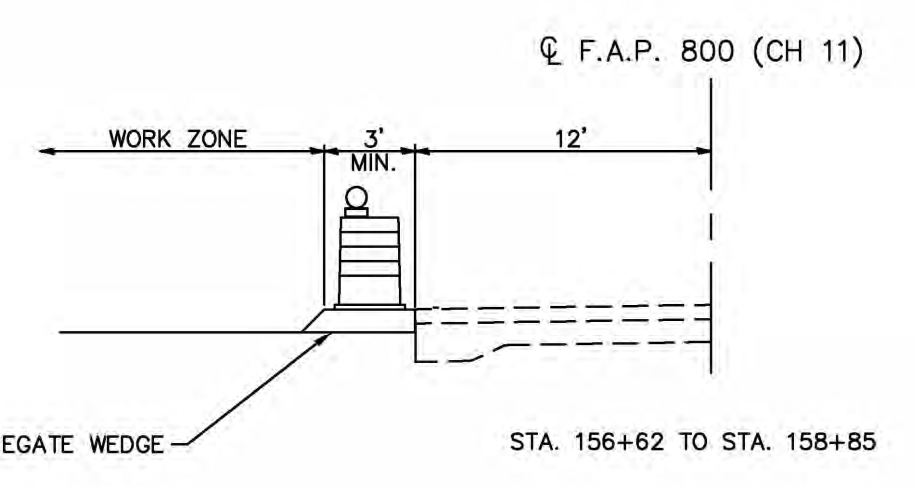
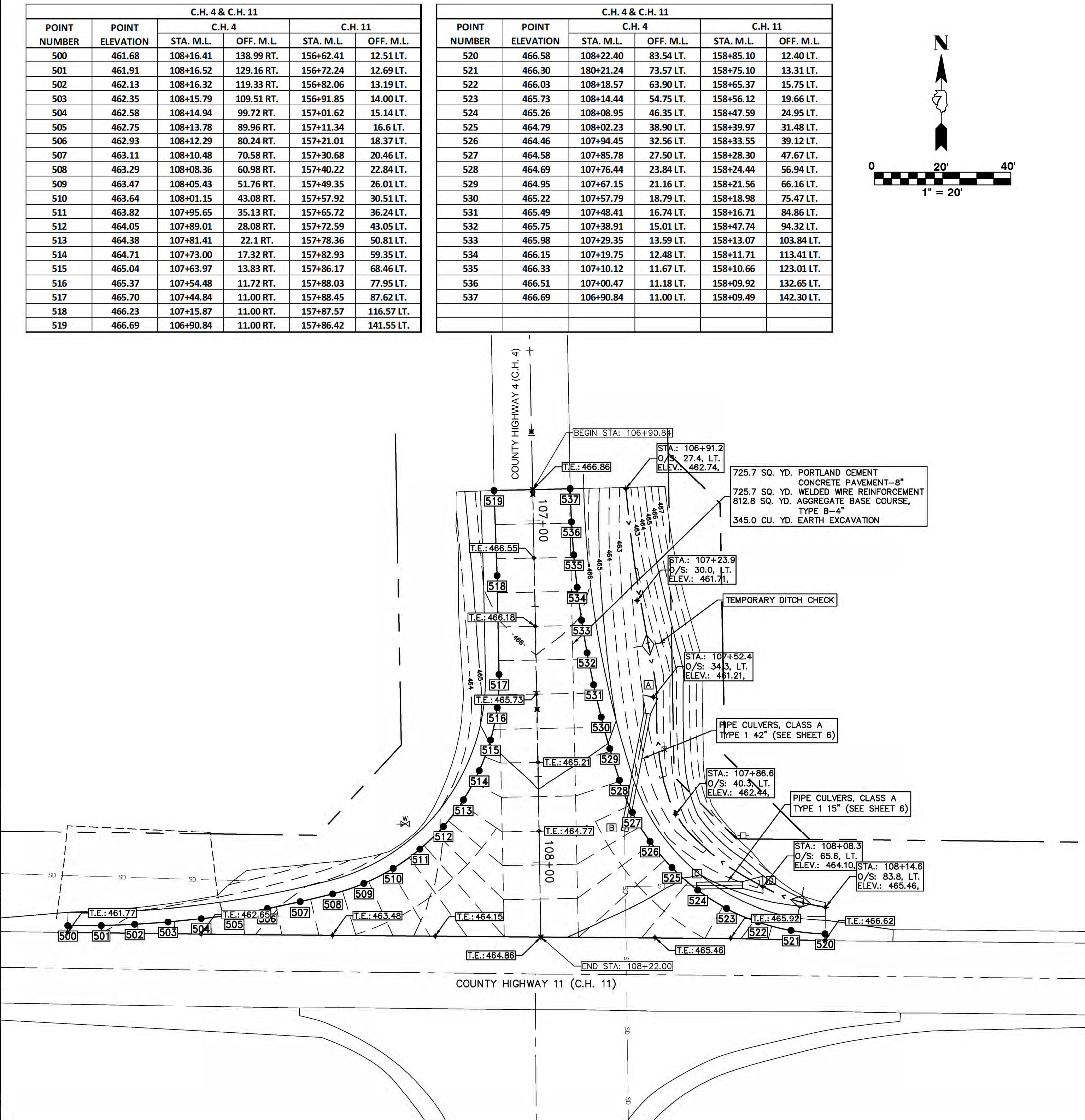
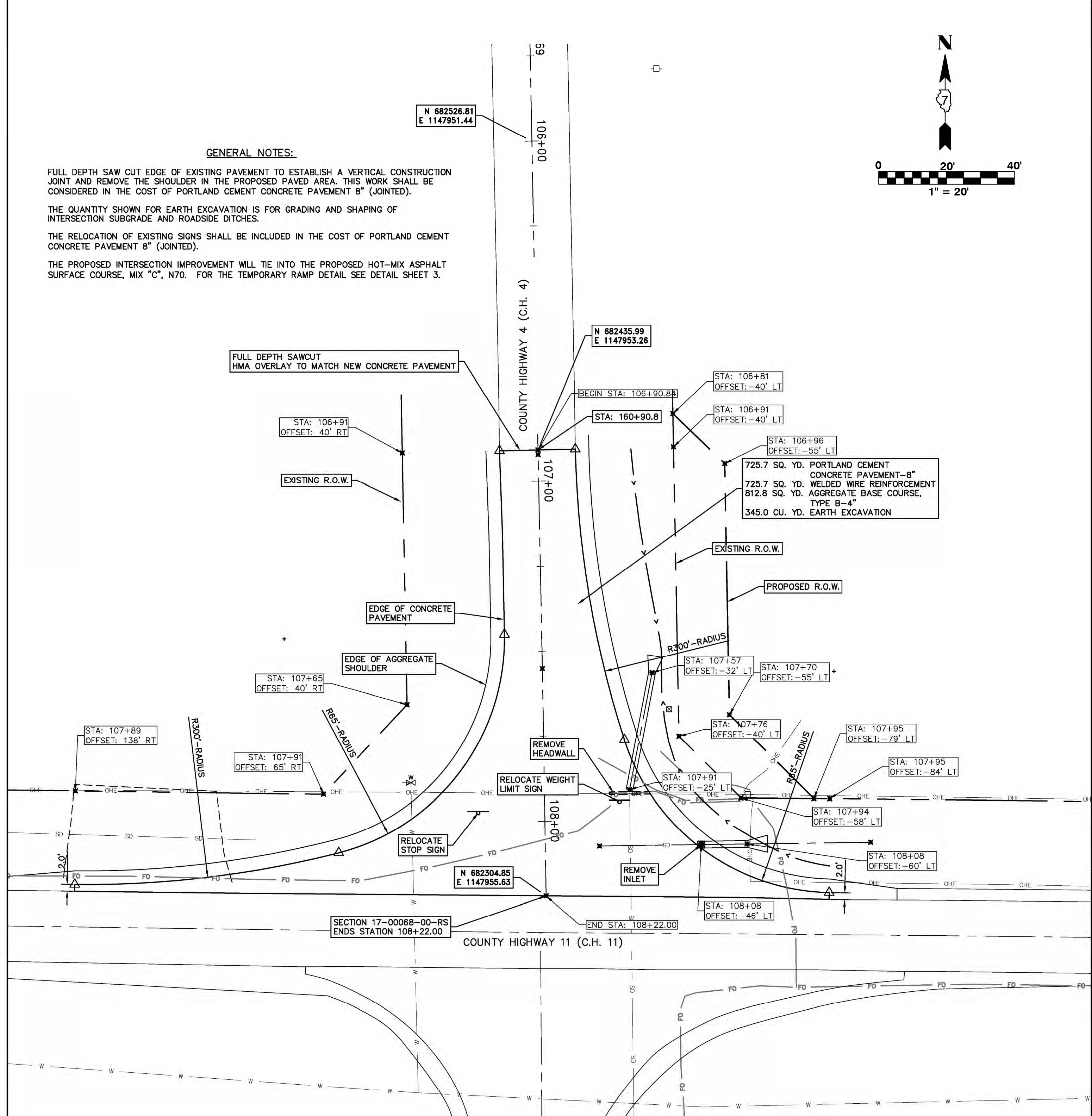

SCHEDULE OF STRUCTURES TO BE REMOVED

STATION	LOCATION	STRUCTURE TYPE	ITEM
107+91	25' LT	CONCRETE HEADWALL	50104400
108+08	46' LT	INLET	60500060

SCHEDULE OF TEMPORARY DITCH CHECKS

STATION	LOCATION	FEET
107+37	33' LT	25.0'
108+13	77' LT	25.0'
TOTAL		50.0'