

F.A.P. RTE.	SECTION	COUNTY	TOTAL SHEETS	SHEET NO.
346	*	LAKE	469	601
STA.	TO STA.			
FED. ROAD DIST. NO. D-91-404-99	ILLINOIS	FED. AID PROJ. NO.		
* 125X-HB-(1&2) R-1		CONTRACT * 608		

PLAN	SURVEYED	DATE
	PLOTTED	
	NOTED	
	BY	
	NO.	

PROFILE	SURVEYED	DATE
	PLOTTED	
	NOTED	
	BY	
	NO.	

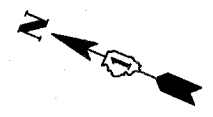
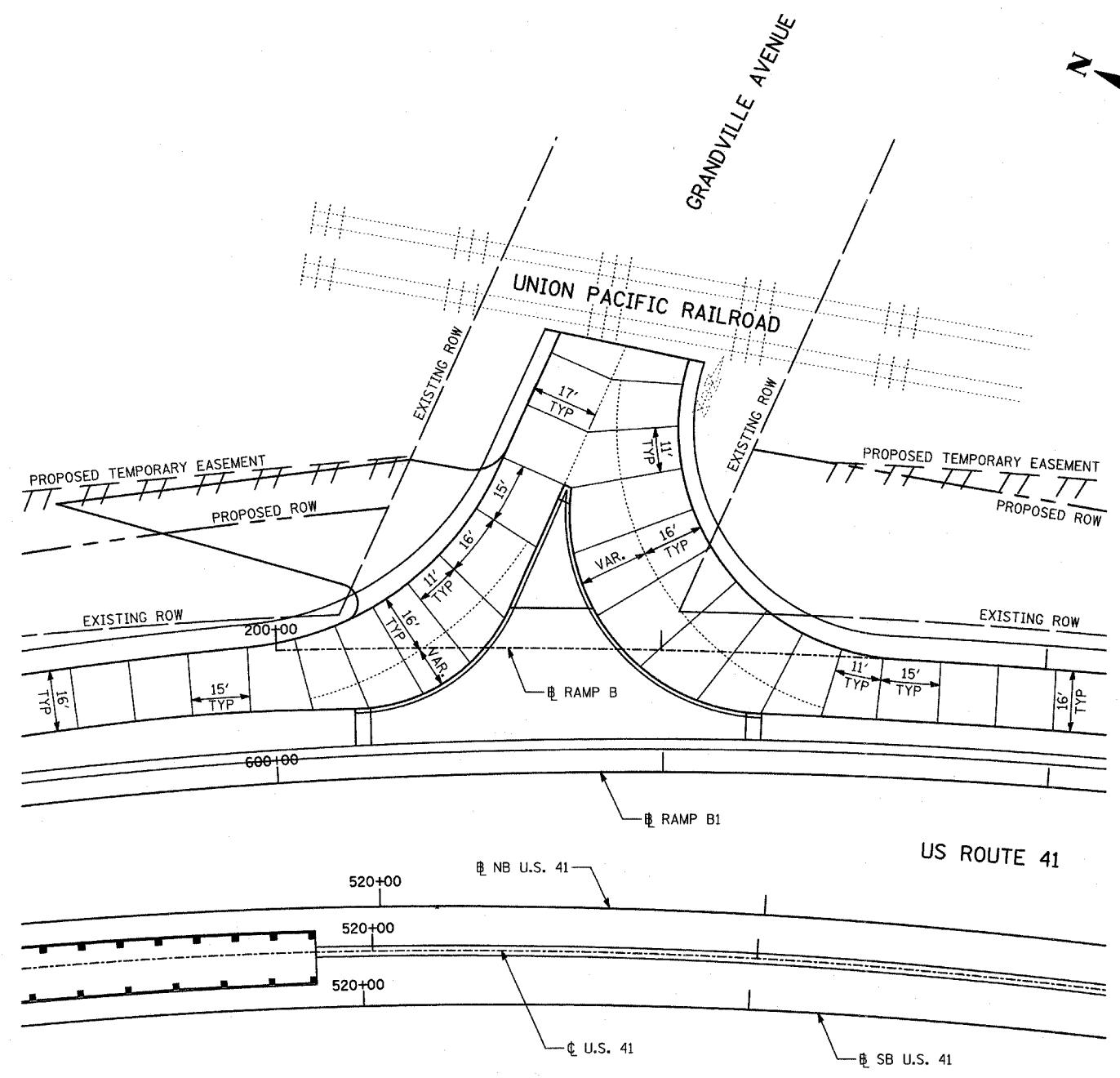

LEGEND:

- Ⓞ ROADWAY, Ⓜ RAMP
- PAVEMENT SEPARATION JOINT (IDOT DISTRICT 1 STANDARD DETAIL BD52)
- SAWED LONGITUDINAL JOINT (IDOT 420001)
- LONGITUDINAL CONSTRUCTION JOINT GROUTED-IN-PLACE TIE BAR (IDOT 420001)
- SAWED CONSTRUCTION JOINT (IDOT 420001)

NOTES:

1. SEE INTERSECTION DETAIL PLAN FOR PAVEMENT GRADING, STATIONS AND OFFSETS.
2. CONTRACTION AND EXPANSION JOINTS IN PCC SHOULDERS, CURBS AND SOLID MEDIANS SHALL BE EXTENSIONS OF CONTRACTION AND EXPANSION JOINTS IN THE ADJACENT PAVEMENT.

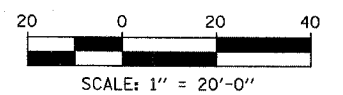
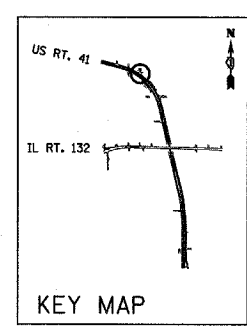

REVISIONS	
NAME	DATE

ILLINOIS DEPARTMENT OF TRANSPORTATION
 U.S. 41 (SKOKIE HIGHWAY)
 AT IL ROUTE 132
INTERSECTION JOINTING PLAN
 GRANDVILLE AVE.
 SCALE: 1"=20'
 DATE: MAY 12, 2008
 DRAWN BY: BK
 CHECKED BY: AB