

F.A.P. RTE.	SECTION	COUNTY	TOTAL SHEETS	SHEET NO.
346	*	LAKE	469	44
STA.		TO STA.		
FED. ROAD DIST. NO. D-91-404-99		ILLINOIS		FED. AID PROJ. NO.
• 125X-HB-(1&2) R-1				CONTRACT # 608



NOTE:
CONTRACTOR SHALL MAINTAIN ACCESS TO ALL DRIVEWAYS AND SIDE STREETS DURING CONSTRUCTION. TEMPORARY ACCESS CLOSURES WILL BE ALLOWED ONLY AT THE DIRECTION OF THE ENGINEER.

LEGEND:

- WORK AREA
- 10" TEMPORARY PAVEMENT
- 4" TEMPORARY SIDEWALK
- TEMPORARY CONCRETE BARRIER
- DIRECTION OF TRAFFIC FLOW
- DRUM WITH STEADY BURN MONODIRECTIONAL LIGHT
- DIRECTION INDICATOR BARRICADE WITH STEADY BURN MONODIRECTIONAL LIGHT
- VERTICAL PANEL (BACK TO BACK)
- TYPE III BARRICADE WITH FLASHING LIGHTS
- FLEXIBLE DELINEATOR
- TEMPORARY IMPACT ATTENUATOR
- ARROW BOARD

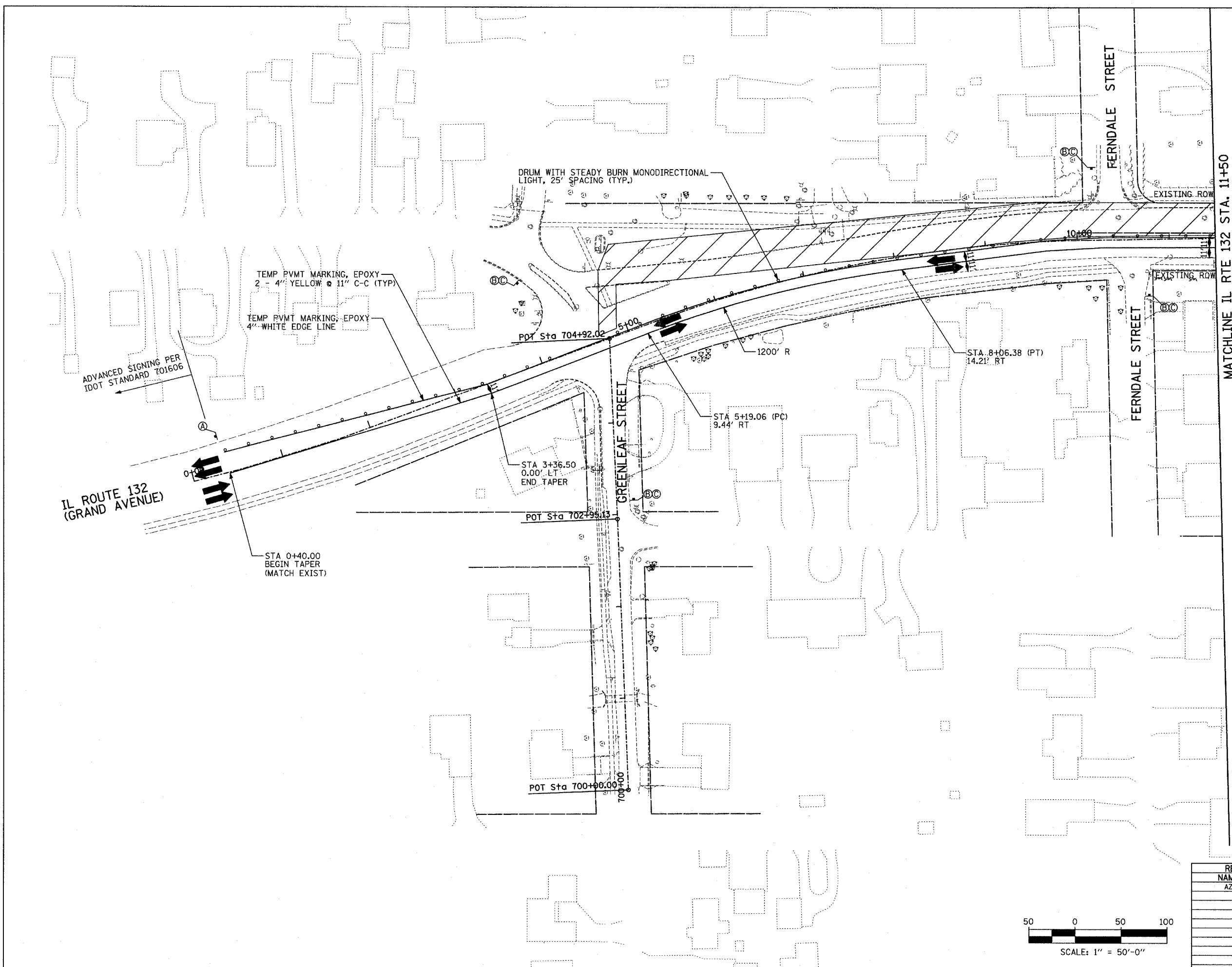
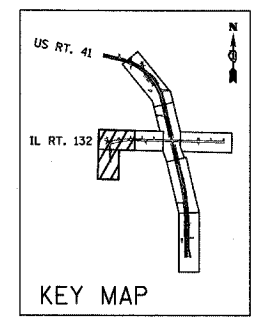

PLAN	SURVEYED	DATE
	NOTED	
	BY	
	DATE	
	PLANNED	
	BY	
	DATE	
	NOTED	
	BY	
	DATE	

PROFILE	SURVEYED	DATE
	NOTED	
	BY	
	DATE	
	PLANNED	
	BY	
	DATE	
	NOTED	
	BY	
	DATE	

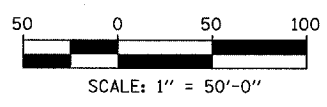

REVISIONS		
NAME	DATE	
AZ	6/17/08	

ILLINOIS DEPARTMENT OF TRANSPORTATION
U.S. 41 (SKOKIE HIGHWAY)
 AT IL ROUTE 132
TRAFFIC CONTROL STAGING (STAGE 1)
 SHEET 4 OF 5
 GREENLEAF STREET
 IL 132 - STA. 4+25.12 TO STA. 11+50
 SCALE: 1"=50' DRAWN BY:
 DATE: MAY 12, 2008 CHECKED BY: