

F.A.P. RTE.	SECTION	COUNTY	TOTAL SHEETS	SHEET NO.
346	.	LAKE	469	93
STA.		TO STA.		
FED. ROAD DIST. NO. D-91-404-99		ILLINOIS	FED. AID PROJ.	
• 125X-HB-(1&2) R-1		CONTRACT • 60		



LEGEND

- PERIMETER EROSION BARRIER
- ROADWAY DITCH FLOW ARROW
- TEMPORARY DITCH CHECKS
- EROSION CONTROL BLANKET
- TEMPORARY EROSION CONTROL SEEDING
- INLET AND PIPE PROTECTION
- INLET FILTERS
- RIP RAP
- AGGREGATE FOR TEMPORARY ACCESS
- EXISTING WETLAND
- IMPACTED WETLAND

NOTES:

1. PGE, SUBGRADE (12" DEPTH) TO BE PLACED IN WETLAND AREAS IMPACTED BY CONSTRUCTION.
2. PERIMETER EROSION BARRIER SHALL BE PAID FOR AS SEDIMENT CONTROL, SILT FENCE AND SEDIMENT CONTROL, SILT FENCE MAINTENANCE.

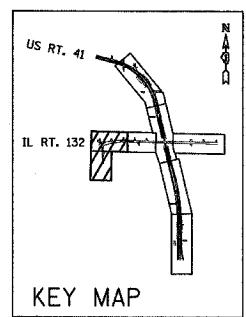

PLAN	DATE
BY	
REVISIONS	
NO.	
DATE	
BY	
REVISIONS	
NO.	
DATE	
BY	

PROFILE	DATE
BY	
REVISIONS	
NO.	
DATE	
BY	
REVISIONS	
NO.	
DATE	
BY	

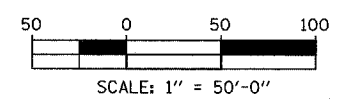
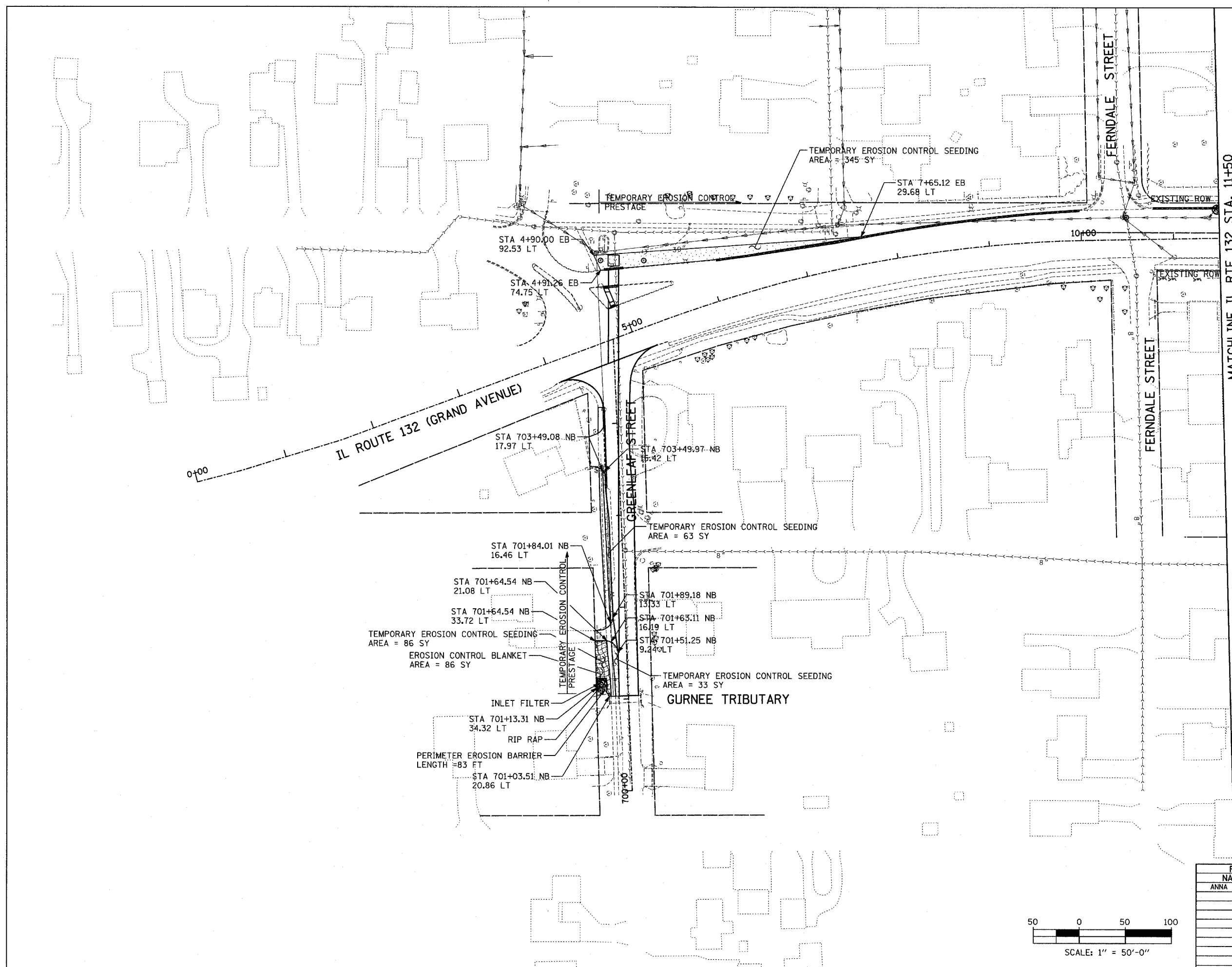

REVISIONS		
NAME	DATE	
ANNA ZYSMAN	6-17-08	

ILLINOIS DEPARTMENT OF TRANSPORTATION
 U.S. 41 (SKOKIE HIGHWAY)
 AT IL ROUTE 132

EROSION CONTROL PLAN
 SHEET 3 OF 4
 GREENLEAF STREET
 IL 132 - STA. 4+25.12 TO STA. 11+50
 SCALE: 1"=50'
 DATE: MAY 12, 2008
 DRAWN BY:
 CHECKED BY: