

F.A.P. RTE.	SECTION	COUNTY	TOTAL SHEETS	SHEET NO.
120	*	LAKE	469	157
STA.	TO STA.			
FED. ROAD DIST. NO. D-91-404-99		ILLINOIS	FED. AID PROJECT	
* 125X-HB-(1&2) R-1				

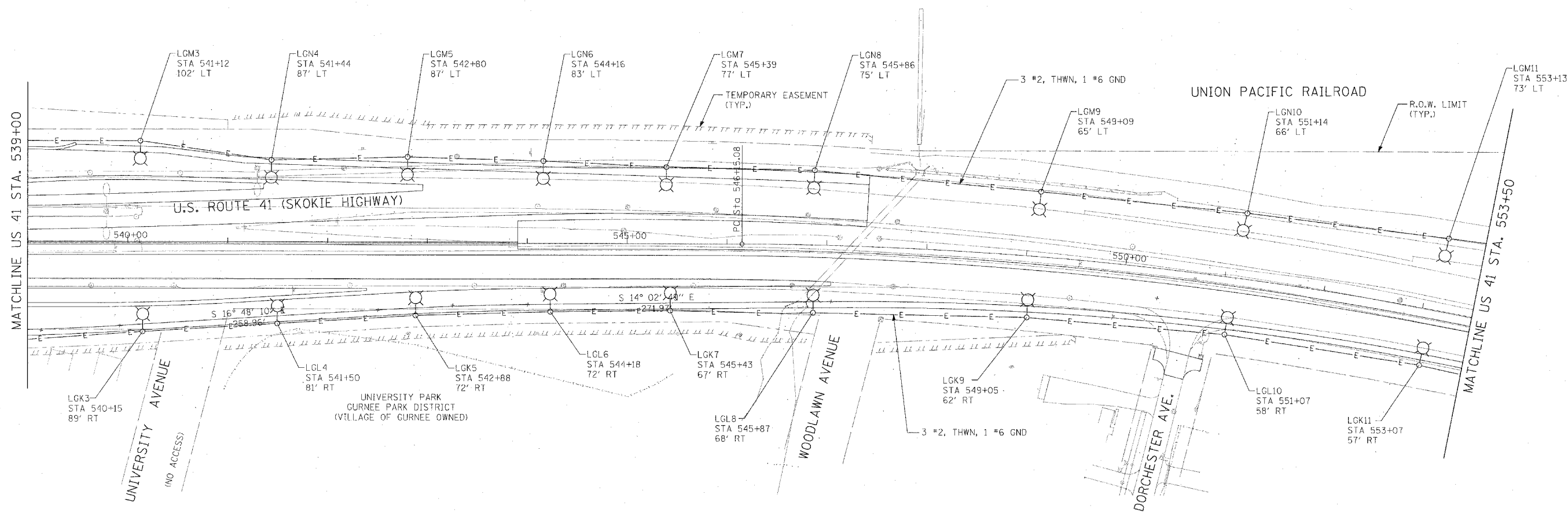

P. AN	DATE
REVISIONS	BY
NOTED	
BY	
DATE	

PROFILE	DATE
BY	
NOTED	
BY	
DATE	

PLOT DATE = 5/14/2008  
 FILE NAME = SATY\_10154295 - US 41 - IL - 125X-HB-1&2-157-3.dwg



REVISIONS	
NAME	DATE

ILLINOIS DEPARTMENT OF TRANSPORTATION  
 U.S. 41 (SKOKIE HIGHWAY)  
 AT IL ROUTE 132  
 PROPOSED ROADWAY LIGHTING PLAN  
 SHEET 3 OF 6  
 US 41 - STA. 539+00 TO STA. 553+50  
 SCALE: 1"=50'-0"  
 DATE: 05/07/08  
 DRAWN BY: FO  
 CHECKED BY: DEM