

F.A.P. RTE.	SECTION	COUNTY	TOTAL SHEETS	SHEET NO.
120	LAKE	LAKE	469	140
STA.	TO STA.			
FED. ROAD DIST. NO. D-91-101-99		ILLINOIS	FED. AID PROJECT	
• 125X-HB-(1&2) R-1				

PLAN	DATE
NO.	
BY	
DATE	
NO.	
BY	
DATE	

PROFILE	DATE
NO.	
BY	
DATE	
NO.	
BY	
DATE	

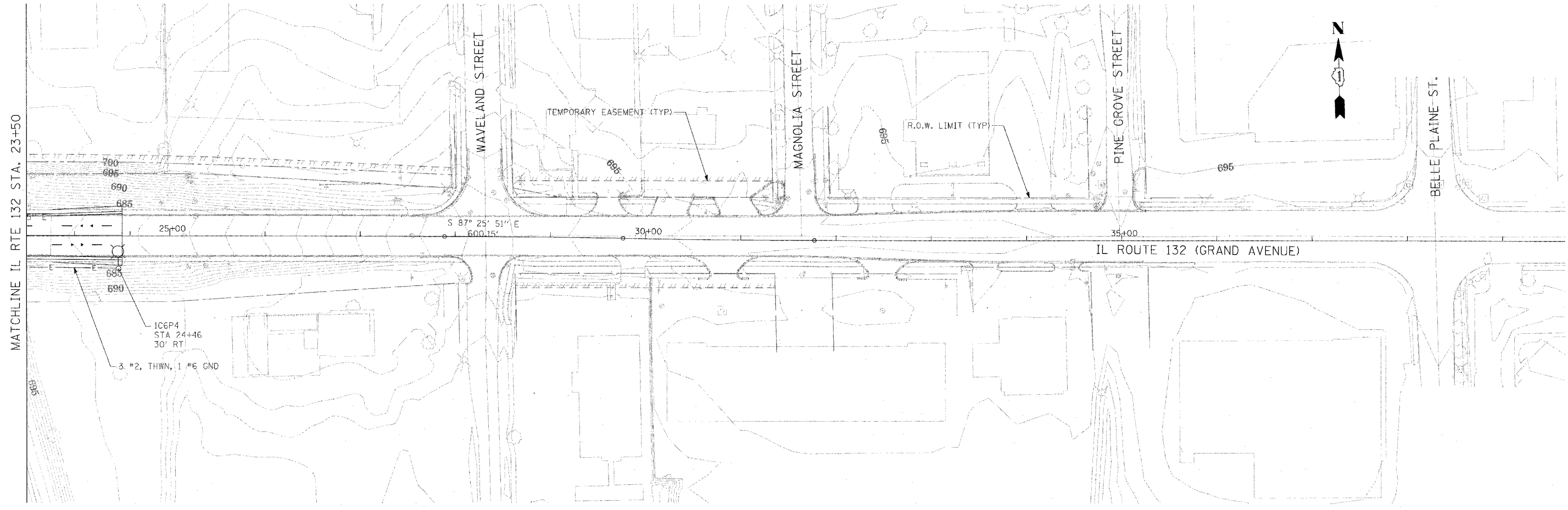

PLOT DATE = 9/14/2008
 FILE NAME = BATTY L:\3242\15 - US 41 at IL 132\ACAD\15\41FERM\TG.mxd



REVISIONS	
NAME	DATE

ILLINOIS DEPARTMENT OF TRANSPORTATION
 U.S. 41 (SKOKIE HIGHWAY)
 AT IL ROUTE 132
 PROPOSED ROADWAY LIGHTING PLAN
 SHEET 6 OF 6
 IL 132 - STA. 23+50 TO EOP
 SCALE: 1"=50'-0"
 DATE: 05/07/08
 DRAWN BY: FO
 CHECKED BY: DEM