

STATE OF ILLINOIS
DEPARTMENT OF TRANSPORTATION

ROUTE NO.	SECTION	COUNTY	SHEET NO.	SHEET NO.	SHEET NO. - S-1
346	•	LAKE	469	170	S-66 - SHEETS
FED. ROAD DIST. NO.		ILLINOIS	FED. AID PROJECT		
• 125X-HB-(1&2) R-1		CONTRACT # 60826			

US 41 Bridge Over IL Route 132 - 690'-0"

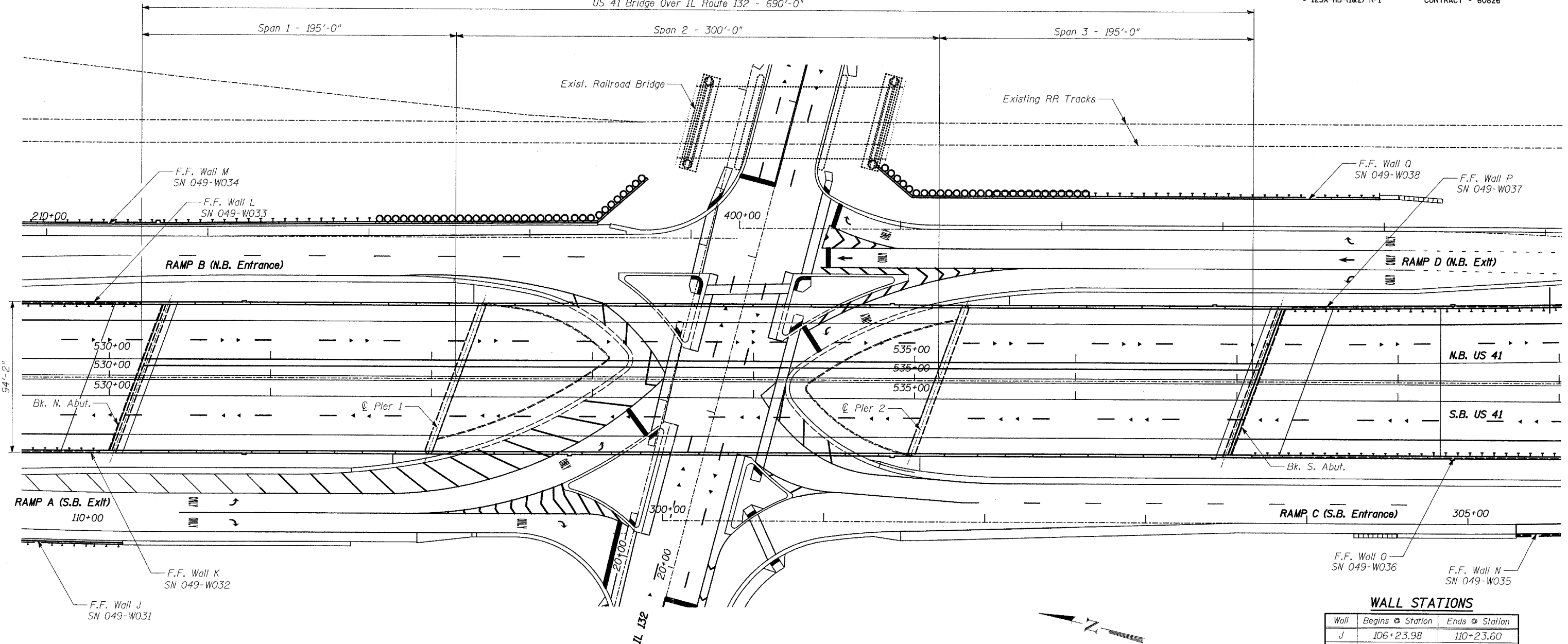

OVERALL PLAN

CONSTRUCTION STAGING

Stage 1 - Divert traffic to existing N.B. bridge. Close existing S.B. bridge and existing entrance and exit ramps. Remove existing S.B. bridge. Construct portion of new bridge and retaining walls J, K, N, and O.

Stage 2 - Divert traffic to constructed portion of new bridge. Close and remove existing N.B. bridge. Construct remaining portion of new bridge and retaining walls L, M, Q, and P.

DESIGN SPECIFICATIONS

2002 AASHTO Standard Specifications For Highway Bridges

LOADING HS20-44

Allow 50 psf for future wearing surface

DESIGN STRESSES

FIELD UNITS

$f'_c = 3,500$ psi
 $f_y = 60,000$ psi (reinforcement)
 $f_y = 50,000$ psi (structural steel M270 Grade 50)
 $f_y = 36,000$ psi (structural steel M270 Grade 36)

SEISMIC DATA

Seismic Performance Category (SPC) = A
 Bedrock Acceleration Coefficient (A) = 0.035g
 Site Coefficient (S) = 1.0

WALL STATIONS

Wall	Begins @ Station	Ends @ Station
J	106+23.98	110+23.60
K	527+76.95	529+93.95
L	527+91.28	530+19.78
M	209+34.09	213+73.11
N	305+29.91	312+64.94
O	537+09.57	540+88.57
P	537+34.42	539+54.74
Q	400+84.81	403+97.09

TYLIN INTERNATIONAL

DESIGNED	- SP
CHECKED	- AD
DRAWN	- CM
CHECKED	- AD

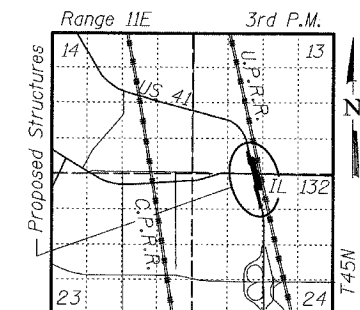
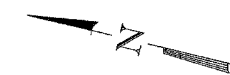

LOCATION SKETCH

OVERALL GENERAL PLAN

FAP 346 (U.S. ROUTE 41 - SKOKIE HIGHWAY) OVER ILLINOIS ROUTE 132
 SECTION 125X-HB-(1&2)R-1
 LAKE COUNTY
 S.N. 049-0209