

STATE OF ILLINOIS  
DEPARTMENT OF TRANSPORTATION

ROUTE NO.	SECTION	COUNTY	SOUTH SHEETS	SHEET NO.
346	*	LAKE	469	184
FED. ROAD DIST. NO.	ILLINOIS	FED. AID PROJECT		
			* 125X-HB-(1&2) R-1	

SHEET NO. - S-15  
S-66 SHEETS

CONTRACT # 60826

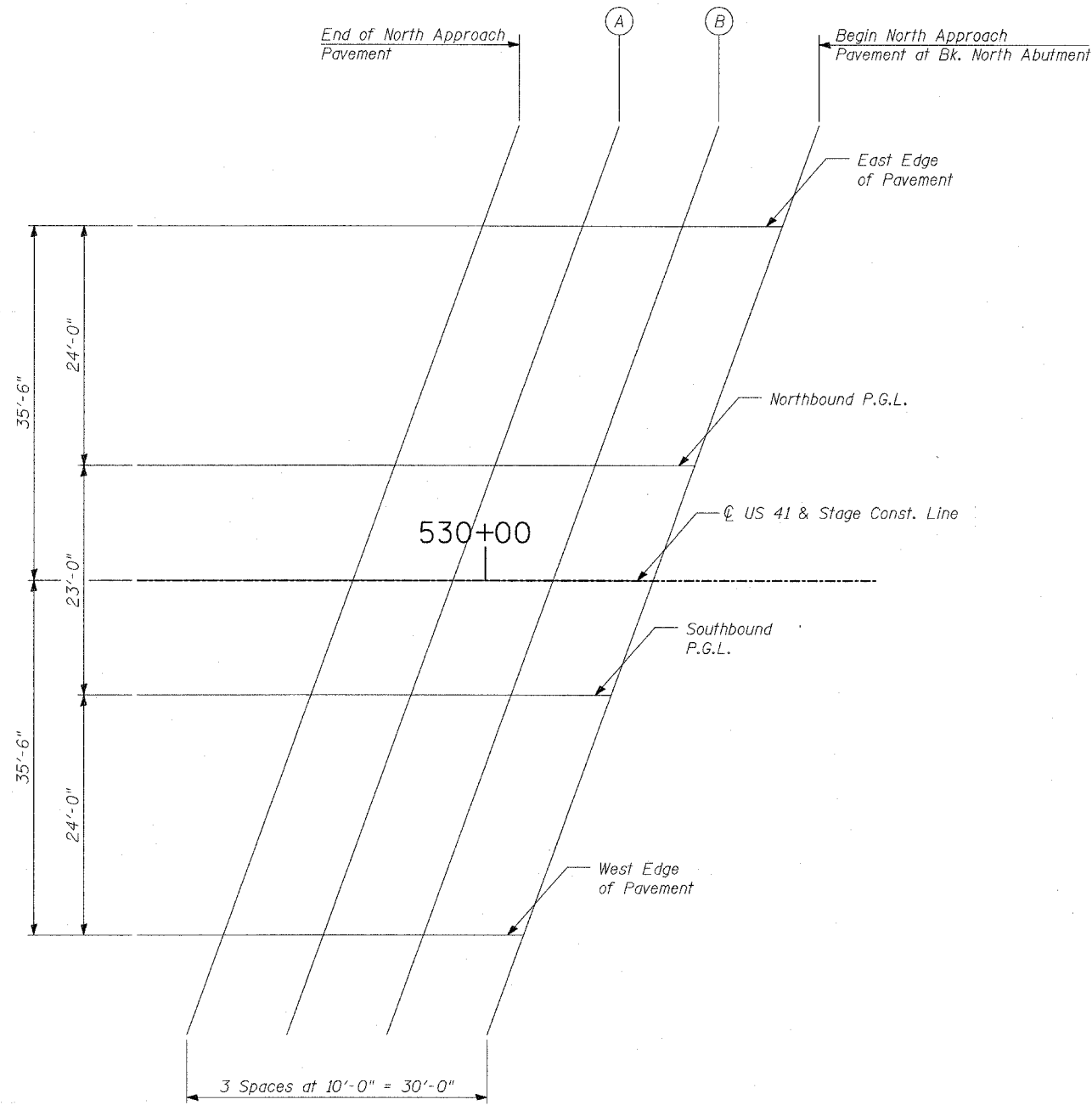
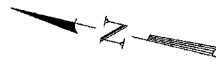

PLAN

**EAST EDGE OF PAVEMENT**

Location	Station	Offset	Theoretical Grade Elevations
End N. Appr. Pav't	529+99.71	-35.50'	700.90
A	530+09.71	-35.50'	701.10
B	530+19.71	-35.50'	701.29
Begin N. Appr. Pav't	530+29.71	-35.50'	701.49

**NORTHBOUND P.G.L.**

Location	Station	Offset	Theoretical Grade Elevations
End N. Appr. Pav't	529+90.97	-11.50'	700.73
A	530+00.97	-11.50'	700.93
B	530+10.97	-11.50'	701.12
Begin N. Appr. Pav't	530+20.97	-11.50'	701.32

**Centerline of US 41 & STAGE CONSTRUCTION LINE**

Location	Station	Offset	Theoretical Grade Elevations
End N. Appr. Pav't	529+86.78	00.00'	700.19
A	529+96.78	00.00'	700.39
B	530+06.78	00.00'	700.58
Begin N. Appr. Pav't	530+16.78	00.00'	700.78

**SOUTHBOUND P.G.L.**

Location	Station	Offset	Theoretical Grade Elevations
End N. Appr. Pav't	529+82.60	11.50'	700.57
A	529+92.60	11.50'	700.77
B	530+02.60	11.50'	700.96
Begin N. Appr. Pav't	530+12.60	11.50'	701.15

**WEST EDGE OF PAVEMENT**

Location	Station	Offset	Theoretical Grade Elevations
End N. Appr. Pav't	529+73.86	35.50'	700.40
A	529+83.86	35.50'	700.60
B	529+93.86	35.50'	700.79
Begin N. Appr. Pav't	530+03.86	35.50'	700.99

TYLIN INTERNATIONAL

DESIGNED	- MAF
CHECKED	- AD
DRAWN	- MAF
CHECKED	- AD

**TOP OF NORTH APPROACH  
SLAB ELEVATIONS**

FAP 346 (U.S. ROUTE 41 - SKOKIE  
HIGHWAY) OVER ILLINOIS ROUTE 132  
SECTION 125X-HB-(1&2)R-1  
LAKE COUNTY  
S.N. 049-0209