

STATE OF ILLINOIS
DEPARTMENT OF TRANSPORTATION

ROUTE NO.	SECTION	COUNTY	TOTAL SHEETS	SHEET NO.	SHEET NO. - S-22 S-66 SHEETS
346	*	LAKE	469	191	
FED. ROAD DIST. NO.		ILLINOIS	FED. AID PROJECT-		

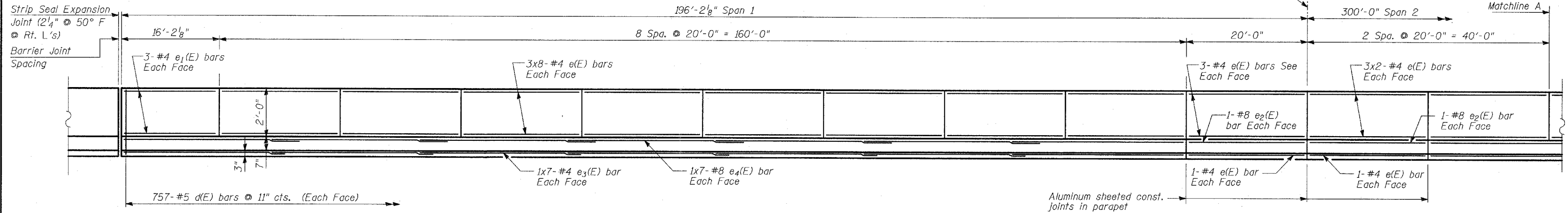

INSIDE ELEVATION OF PARAPET

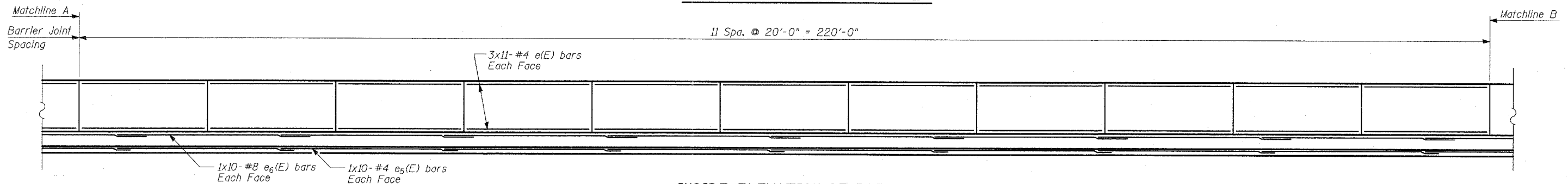

INSIDE ELEVATION OF PARAPET

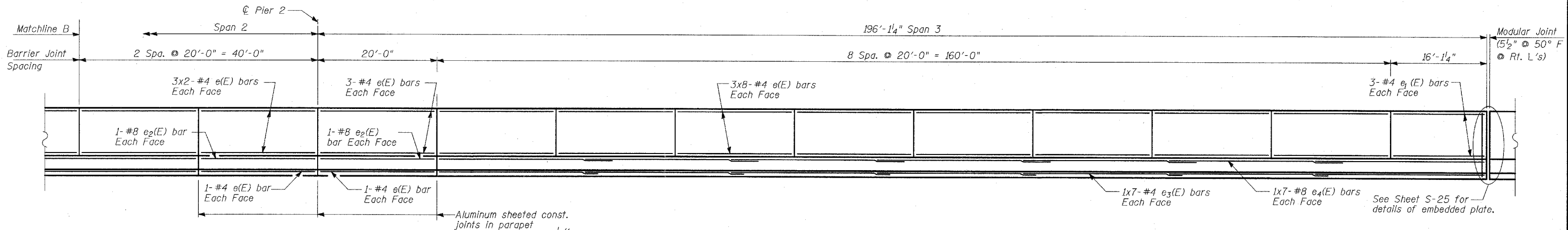

INSIDE ELEVATION OF PARAPET

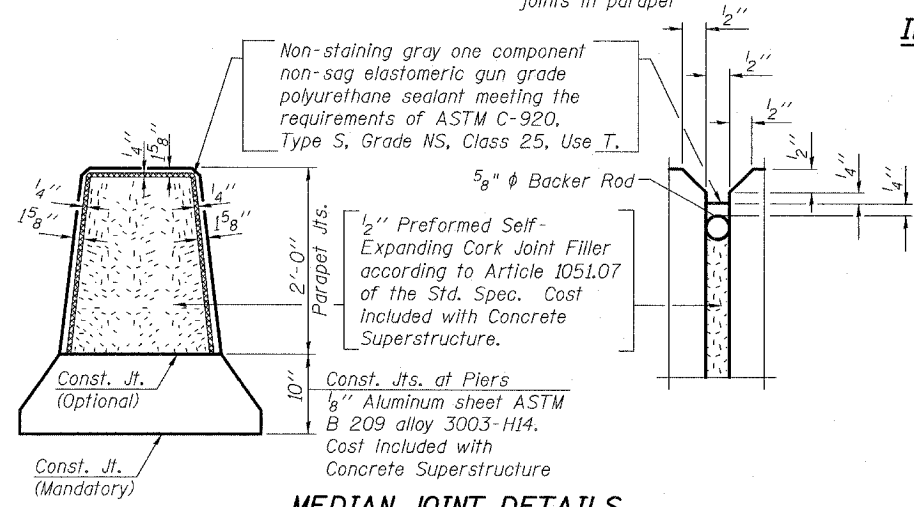

MEDIAN JOINT DETAILS

LAP SPLICES

Bar	Lap
#4	1'-8"
#8	4'-6"

SUPERSTRUCTURE
DETAILS III

FAP 346 (U.S. ROUTE 41 - SKOKIE
HIGHWAY) OVER ILLINOIS ROUTE 132
SECTION 125X-HB-(1&2)R-1
LAKE COUNTY
S.N. 049-0209

NOTES

Bars indicated thus 1x2-#5 etc. indicates 1 line of bars with 2 lengths per line.

TYLIN INTERNATIONAL

DESIGNED	- SP
CHECKED	- AD
DRAWN	- SNB
CHECKED	- MAF, AD