

STATE OF ILLINOIS
DEPARTMENT OF TRANSPORTATION

ROUTE NO.	SECTION	COUNTY	TOTAL SHEETS	SHEET	SHEET NO. -S-39A
346	*	LAKE	469	208A	S-66 SHEETS
FED. ROAD DIST. NO.	ILLINOIS	FED. AID PROJECT			
			CONTRACT # 60826		

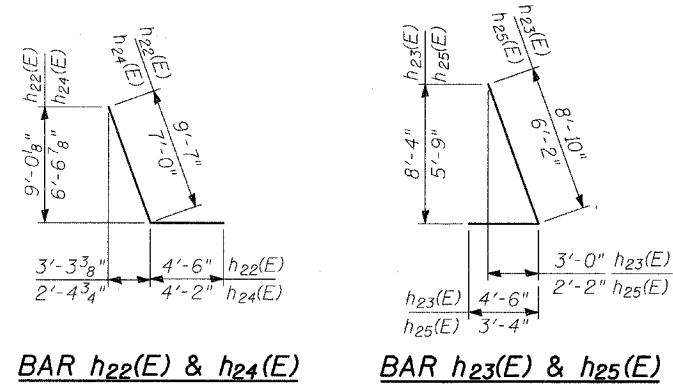

BAR h22(E) & h24(E)

BAR h23(E) & h25(E)

MARK TABLE

Bar	A	B	C
n20(E)	7'-3"	11"	8"
n21(E)	5'-3"	7"	5"

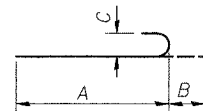

BAR n20(E) & n21(E)

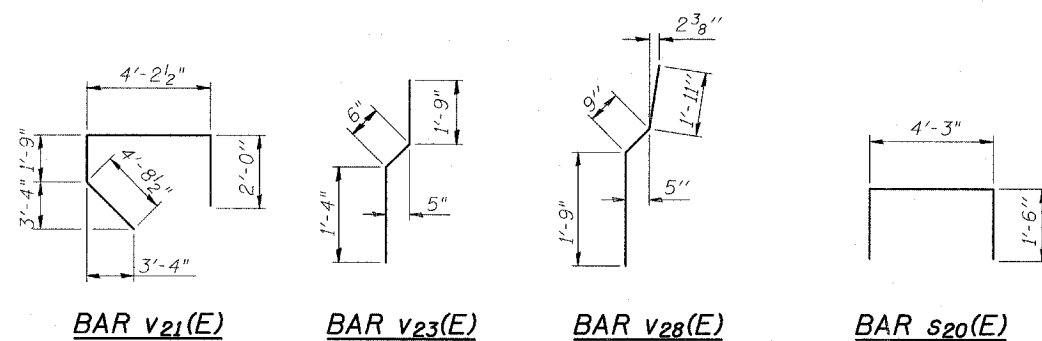

BAR v21(E)

BAR v23(E)

BAR v28(E)

BAR s20(E)

BILL OF MATERIAL

Bar	No.	Size	Length	Shape
h20(E)	74	#5	31'-8"	—
h21(E)	74	#5	20'-4"	—
h22(E)	18	#7	14'-1"	—
h23(E)	18	#7	13'-4"	—
h24(E)	20	#5	11'-2"	—
h25(E)	20	#5	9'-6"	—
h26(E)	8	#6	31'-5"	—
h27(E)	8	#6	21'-0"	—
h28(E)	18	#5	13'-0"	—
h29(E)	20	#5	15'-5"	—
h30(E)	6	#4	15'-5"	—
h31(E)	6	#4	7'-0"	—
h32(E)	5	#5	20'-7"	—
n20(E)	244	#8	8'-2"	—
n21(E)	123	#5	5'-10"	—
s20(E)	21	#5	7'-3"	—
t20(E)	230	#7	11'-8"	—
t21(E)	14	#7	12'-5"	—
t22(E)	13	#9	11'-11"	—
t23(E)	9	#5	11'-11"	—
t24(E)	14	#7	14'-2"	—
t25(E)	4	#7	6'-0"	—
v20(E)	298	#5	8'-0"	—
v21(E)	100	#5	12'-8"	—
v22(E)	200	#5	11'-0"	—
v23(E)	98	#5	3'-7"	—
v24(E)	98	#5	3'-8"	—
v25(E)	23	#5	17'-0"	—
v26(E)	46	#5	17'-5"	—

BILL OF MATERIAL (CONT.)

v27(E)	23	#5	4'-2"	—
v28(E)	46	#5	4'-5"	—
w20(E)	48	#5	33'-11"	—
w21(E)	48	#5	22'-10"	—
w22(E)	24	#5	12'-8"	—
w23(E)	8	#5	6'-3"	—
Reinforcement Bars, Epoxy Coated			POUND	32,920
Porous Granular Embankment, (Special)			CU YD	1,066
Structure Excavation			CU YD	2,699
Concrete Structures			CU YD	332
Protective Coat			SQ YD	10
Pipe Underdrain For Structures, 6"			FOOT	131
Furnishing Metal Pile Shells 14"x3/8"			FOOT	3,996
Driving Piles			FOOT	3,996
Test Pile Metal Shells			EACH	1
Concrete Sealer			SQ FT	251
Bar Splicers			EACH	163
Geocomposite Wall Drain			SQ YD	185
Pile Extraction			EACH	6

TYLIN INTERNATIONAL

DESIGNED	- SP
CHECKED	- AD
DRAWN	- SP, MAF
CHECKED	- AD

**NORTH ABUTMENT
DETAILS III**

FAP 346 (U.S. ROUTE 41 - SKOKIE
HIGHWAY) OVER ILLINOIS ROUTE 132
SECTION 125X-HB-(1&2)R-1
LAKE COUNTY
S.N. 049-0209