

Benchmark: BM #6 - Square cut in base of L.P. at N.E. corner of IL Route 132 and Magnolia (Speedway) 45.14' LT, Sta. 32+13.24 (IL 132 E.B. B), Elev. 696.47.

Existing Structure: None

STATE OF ILLINOIS  
DEPARTMENT OF TRANSPORTATION

ROUTE NO.	SECTION	COUNTY	TOTAL SHEETS	SHEET NO.	SHEET NO. - 1
346	*	LAKE	469	236	15 SHEETS
FED. ROAD DIST. NO.		BUILDING	FED. AID PROJECT		
125X-HB-(1&2) R-1		CONTRACT # 60826			

TOTAL BILL OF MATERIAL

ITEM	UNIT	TOTAL
Structure Excavation	CU YD	385
Concrete Structures	CU YD	143
Anti-Graffiti Coating	SQ FT	3,075
Rustication Finish	SQ FT	1,423
Stud Shear Connectors	EACH	450
Untreated Timber Lagging	SQ FT	1,886
Reinforcement Bars, Epoxy Coated	POUND	13,900
Furnishing Soldier Piles (W Section)	FOOT	1,635
Geocomposite Wall Drain	SQ YD	232
Pipe Underdrains for Structures, 4"	FOOT	400
Drilling and Setting Soldier Piles (in Soil)	CU FT	8,992
Chain Link Fence, 42" Attached to Structure (Special)	FOOT	400

DESIGN SPECIFICATIONS

2002 AASHTO Standard Specifications  
For Highway Bridges

DESIGN STRESSES

FIELD UNITS

$f'_c = 3,500$  psi  
 $f_y = 60,000$  psi (reinforcement)  
 $f_y = 36,000$  psi (structural steel M270 Grade 36)

NOTES:

- Wall stations and offsets are given to the front face of the concrete facing, and are measured from Ramp A Baseline.
- Existing utilities in conflict with soldier pile wall construction shall be abandoned or relocated according to direction given in roadway plans.
- Reinforcement bars shall conform to the requirements of ASTM A 706 Gr. 60 (IL Modified). See Special Provisions.
- Reinforcement bars designated (E) shall be epoxy coated.
- All exposed concrete edges shall be chamfered  $\frac{3}{4}$ " except as noted.
- Anti-Graffiti Coating shall be applied to exposed surfaces of the concrete facing.
- All construction joints shall be bonded.

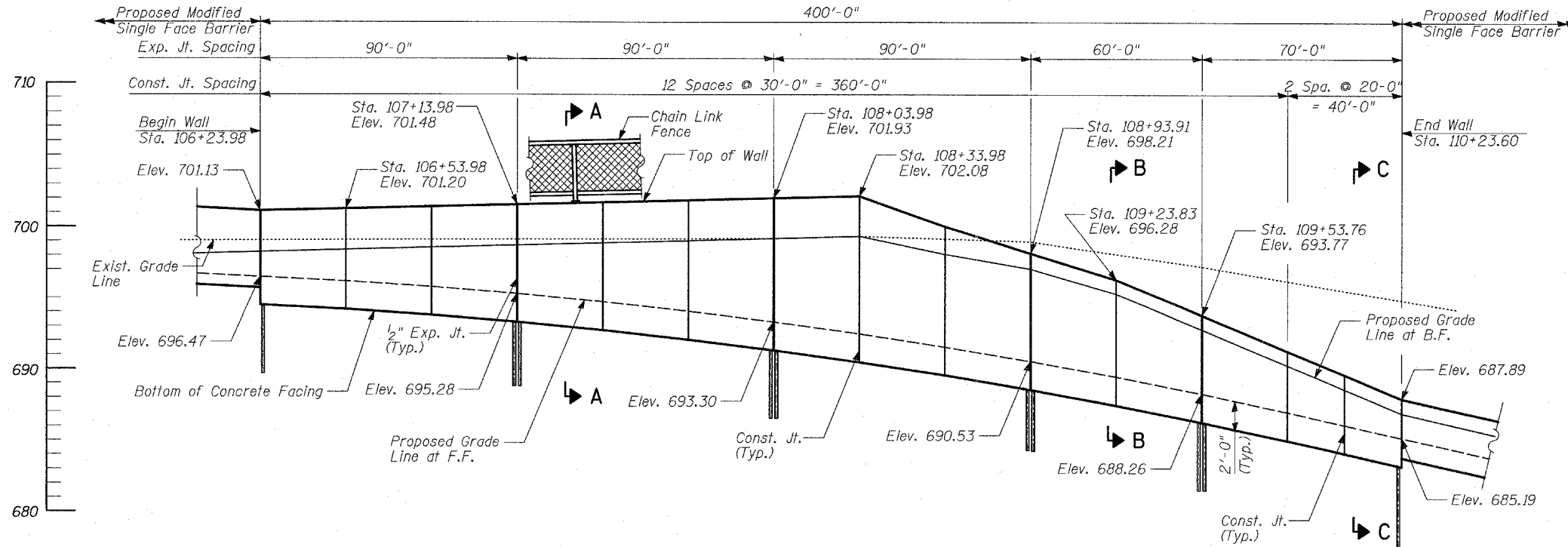

- LEGEND
- ⊙ - Manhole
  - - Catch Basin
  - ⊕ - Soil Boring
  - ▶ - Prop. Storm Sewer
  - ⋯ - Exist. Drain Pipe
  - ⊣ - Proposed Drainage Swale

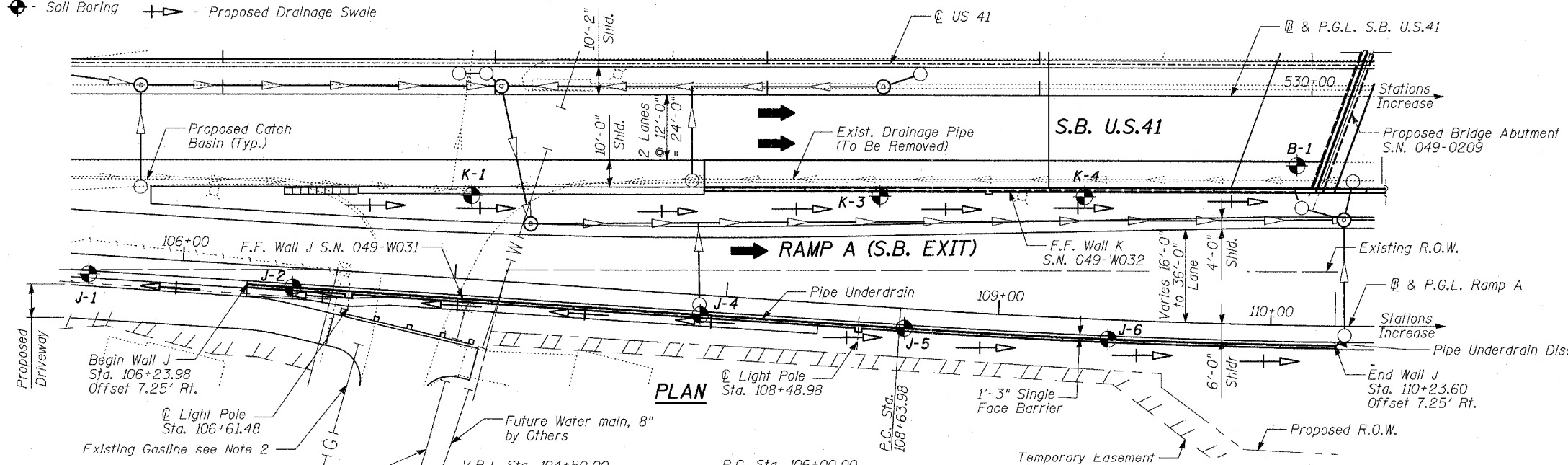

Signed: *[Signature]*  
Spiros Pantazis, S.E. II, Lic. No. 081-006448  
Expires 11-30-2008.  
Date: 5/14/08  
For drawings 1 thru 15 of 15

APPROVED  
FOR STRUCTURAL ADEQUACY ONLY  
*[Signature]*  
ENGINEER OF BRIDGES AND STRUCTURES

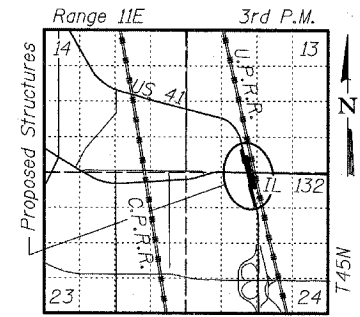

TYLIN INTERNATIONAL HORIZONTAL CURVE DATA

DESIGNED - MB	Prop. Curve RAMP A-2
CHECKED - CM/AD	PI Sta. 109+61.45
DRAWN - DE	= 3° 42' 07" (LT)
CHECKED - CM/AD	D = 1° 53' 59"
	T = 97.47'
	R = 3,016.00'
	L = 194.87'
	E = 1.57'
	PC Sta. 108+63.98
	PT Sta. 110+58.85

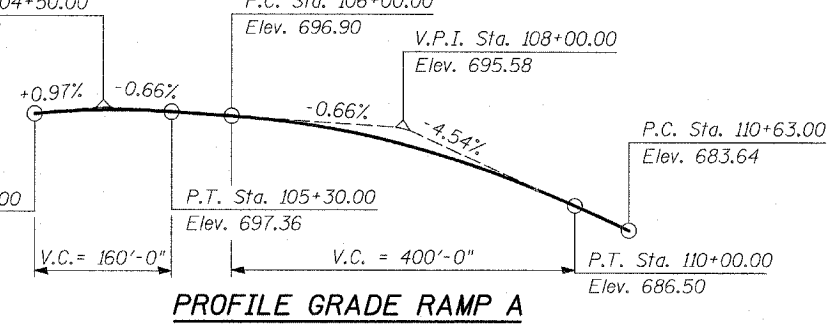

INDEX OF SHEETS

- WALL J GENERAL PLAN AND ELEVATION, STA 106+23.98 TO STA 110+23.60
- WALL J PLAN AND ELEVATION, STA 106+23.98 TO 107+13.98
- WALL J PLAN AND ELEVATION, STA 107+13.98 TO 108+03.98
- WALL J PLAN AND ELEVATION, STA 108+03.98 TO 108+93.91
- WALL J PLAN AND ELEVATION, STA 108+93.91 TO 109+53.76
- WALL J PLAN AND ELEVATION, STA 109+53.76 TO 110+23.60
- WALL J DETAILS (1 OF 2)
- WALL J DETAILS (2 OF 2)
- RUSTICATION FINISH
- CHAIN LINK FENCE, 42" ATTACHED TO STRUCTURE (SPECIAL)
- BORING LOG J-1
- BORING LOG J-2
- BORING LOG J-4
- BORING LOG J-5
- BORING LOG J-6

WALL J  
GENERAL PLAN  
STA 106+23.98 TO STA 110+23.60

FAP 346 (U.S. ROUTE 41 - SKOKIE  
HIGHWAY) OVER ILLINOIS ROUTE 132  
SECTION 125X-HB-(1&2)R-1  
LAKE COUNTY  
S.N. 049-W031