

STATE OF ILLINOIS
DEPARTMENT OF TRANSPORTATION
217'-0" End to End of Barrier

ROUTE NO.	SECTION	COUNTY	TOTAL SHEETS	SHEET NO.	SHEET NO. - 8
346		LAKE	469	258	15 SHEETS
FED. ROAD DIST. NO.	ILLINOIS	FED. AID PROJECT	CONTRACT # 60826		

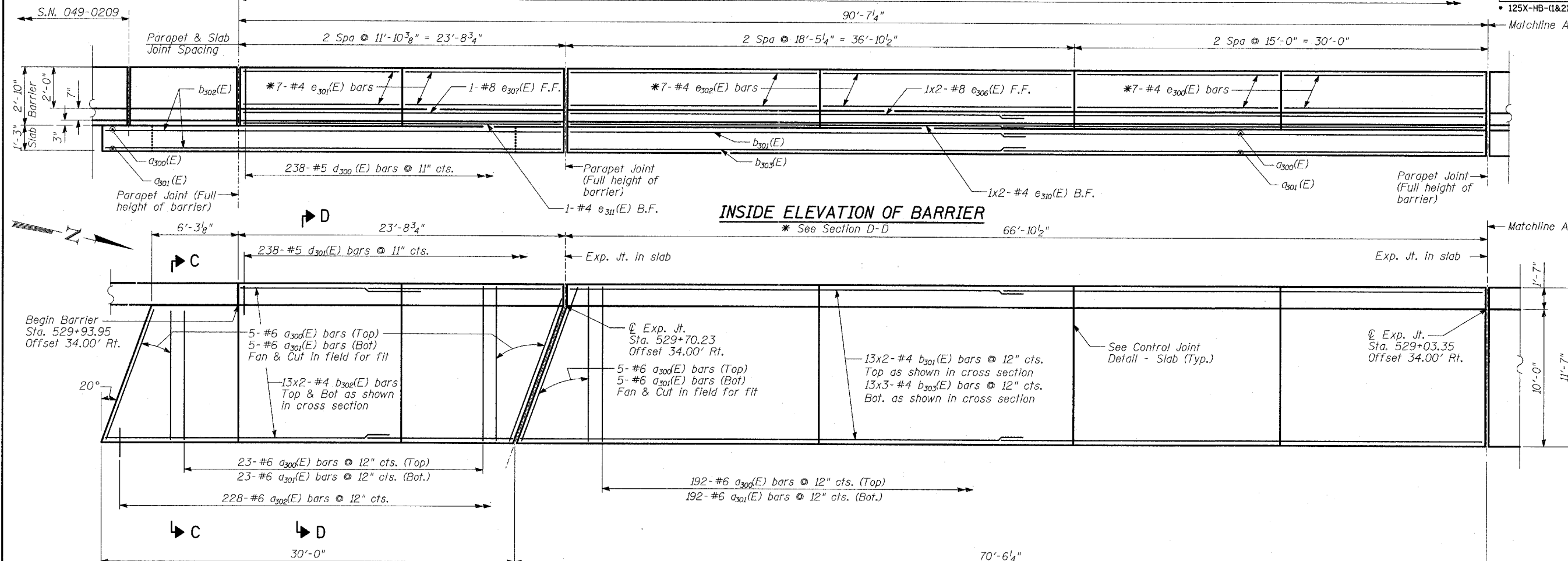

BILL OF MATERIAL

Bar	No.	Size	Length	Shape
a ₃₀₀ (E)	230	#6	12'-8"	
a ₃₀₁ (E)	230	#6	11'-3"	
a ₃₀₂ (E)	228	#6	2'-6"	
b ₃₀₀ (E)	39	#4	31'-0"	
b ₃₀₁ (E)	52	#4	36'-1"	
b ₃₀₂ (E)	52	#4	15'-9"	
b ₃₀₃ (E)	39	#4	24'-7"	
b ₃₀₄ (E)	52	#4	23'-8"	
d ₃₀₀ (E)	238	#5	5'-7"	
d ₃₀₁ (E)	238	#5	7'-5"	
d ₃₀₂ (E)	3	#6	4'-5"	
d ₃₀₃ (E)	5	#6	8'-11"	
e ₃₀₀ (E)	56	#4	14'-9"	
e ₃₀₁ (E)	14	#4	11'-6"	
e ₃₀₂ (E)	21	#4	18'-1"	
e ₃₀₃ (E)	7	#4	17'-6"	
e ₃₀₄ (E)	1	#8	36'-1"	
e ₃₀₅ (E)	3	#8	32'-11"	
e ₃₀₆ (E)	2	#8	35'-7"	
e ₃₀₇ (E)	1	#8	23'-5"	
e ₃₀₈ (E)	1	#4	36'-1"	
e ₃₀₉ (E)	3	#4	31'-0"	
e ₃₁₀ (E)	2	#4	34'-2"	
e ₃₁₁ (E)	1	#4	23'-5"	
Concrete Superstructure		CU YD		149
Reinforcement Bars, Epoxy Coated		Pound		18,260
Protective Coat		SQ YD		332

PLAN

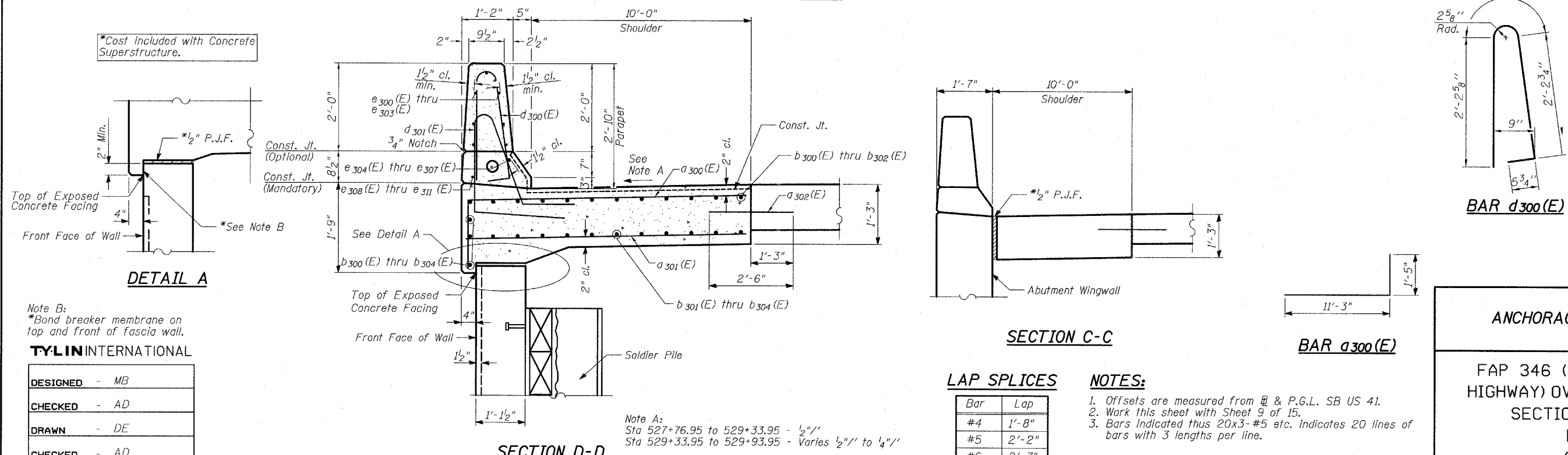

TYLIN INTERNATIONAL

DESIGNED	- MB
CHECKED	- AD
DRAWN	- DE
CHECKED	- AD

LAP SPLICES

Bar	Lap
#4	1'-8"
#5	2'-2"
#6	2'-7"
#8	4'-6"

- NOTES:**
- Offsets are measured from \mathbb{D} & P.G.L. SB US 41.
 - Work this sheet with Sheet 9 of 15.
 - Bars indicated thus 20x3-#5 etc. indicates 20 lines of bars with 3 lengths per line.

WALL K
ANCHORAGE SLAB AND PARAPET
(1 OF 2)

FAP 346 (U.S. ROUTE 41 - SKOKIE HIGHWAY) OVER ILLINOIS ROUTE 132
SECTION 125X-HB-(1&2)R-1
LAKE COUNTY
S.N. 049-W032