

STATE OF ILLINOIS
DEPARTMENT OF TRANSPORTATION

ROUTE NO.	SECTION	COUNTY	TOTAL SHEETS	SHEET NO.
346	*	LAKE	469	272
FED. ROAD DIST. NO.	ILLINOIS	FED. AID PROJECT		
			* 125X-HB-(1&2) R-1 CONTRACT # 60826	

SHEET NO. - 7
16 SHEETS

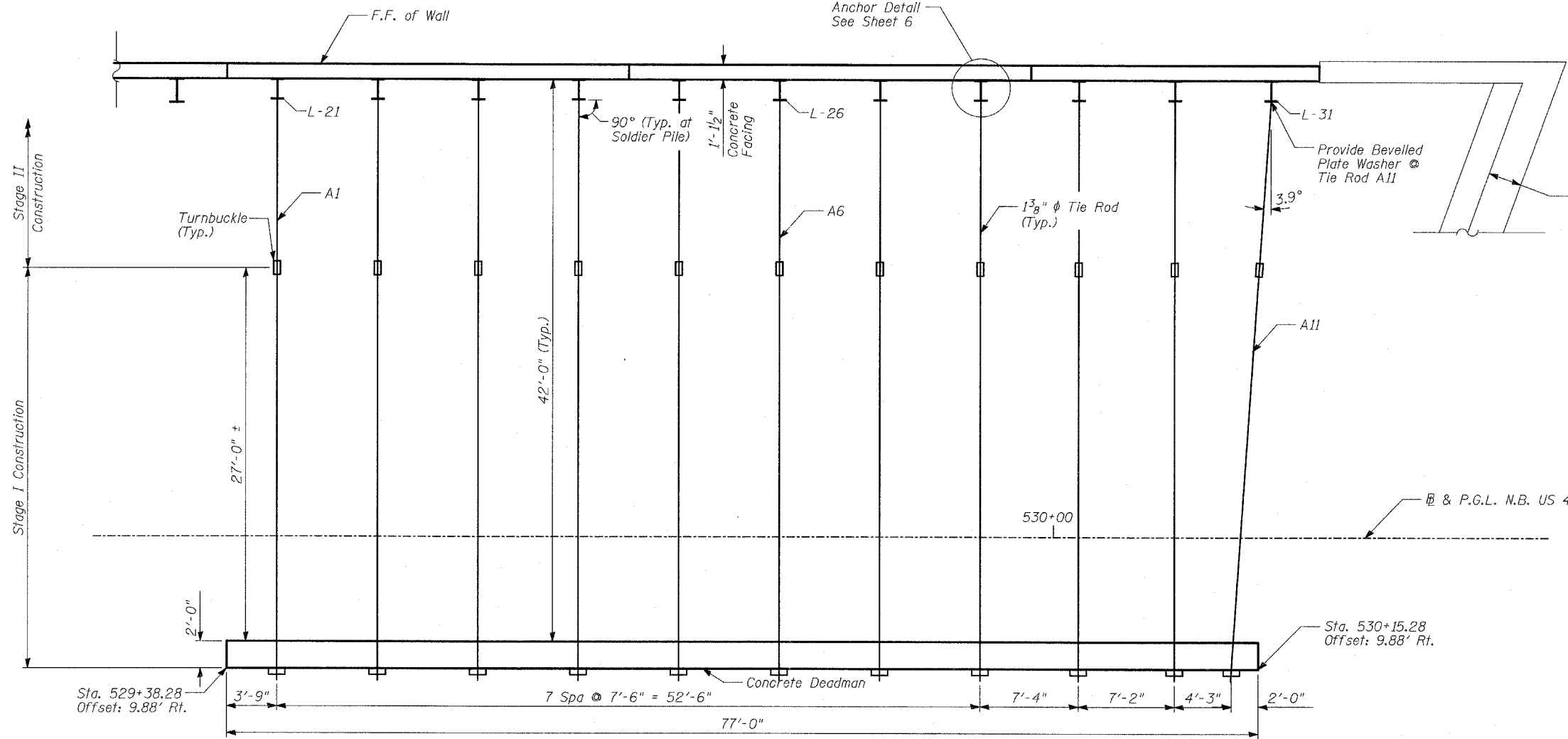

PLAN

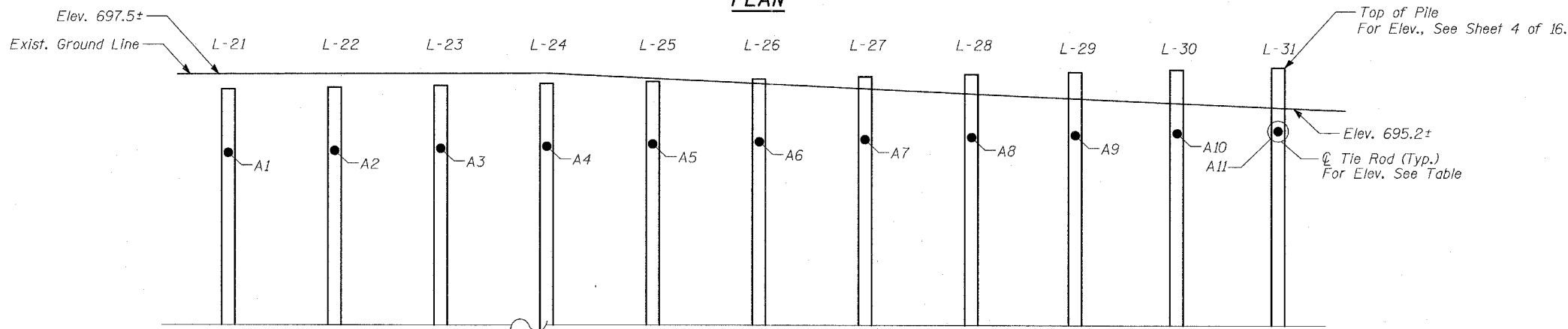

ELEVATION - SOLDIER PILES
(Looking West)

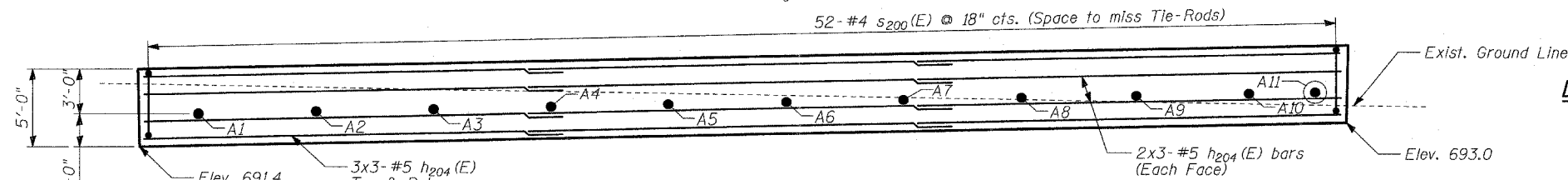

ELEVATION - CONCRETE DEADMAN
(Looking West)

ANCHOR TIE ROD

Anchor Tie Rod	Elevation
A1	693.4
A2	693.6
A3	693.7
A4	693.9
A5	694.0
A6	694.2
A7	694.4
A8	694.5
A9	694.7
A10	694.9
A11	695.0

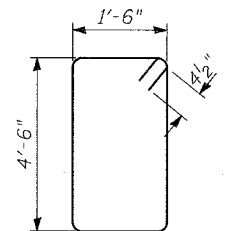

BAR S400 (E)

DEADMAN BAR LIST AND
BILL OF MATERIAL

Bar	No.	Size	Length	Shape
h204 (E)	30	#5	27'-0"	—
s200 (E)	52	#4	12'-9"	□
Reinforcement Bars, Epoxy Coated			POUND	1,290
Concrete Structures			CU YD	29
Furnishing and Erecting Structural Steel			POUND	4,220
Structure Excavation			CU YD	86

NOTES:

1. Install Concrete Deadman and portion of Tie Rod as indicated during Stage I Construction.
2. Install Turnbuckle and remaining section of Tie Rod along with Soldier Piles in Stage II Construction

WALL L
TIE BACK AND DEADMAN DETAILS

FAP 346 (U.S. ROUTE 41 - SKOKIE
HIGHWAY) OVER ILLINOIS ROUTE 132
SECTION 125X-HB-(1&2)R-1
LAKE COUNTY
S.N. 049-W033

LAP SPLICES

Bar	Lap
#4	1'-8"
#5	2'-2"
#6	2'-7"
#8	4'-6"

TYLIN INTERNATIONAL

DESIGNED	- MB
CHECKED	- AD
DRAWN	- CM
CHECKED	- AD